

ELEVATION
 Along & Bridge
 35'-5@45'-35' RC Cont. Slab Spans, 50° Skew Lt.
 Pile Bent Abutments, Pedestal Type Piers
 Repair Abutment Beams, Bearings, Pier Columns and
 Construct Approach Slabs w/ New Abutment Wingwalls

* See General Notes for more information.

CP#1 = Sta. 680+00.00 X=-1,657,540.5259 Y=-1,668,818.2038
 CP#2 = Sta. 685+00.00 X=-1,657,850.7025 Y=-1,668,426.0462
 CP#3 = Sta. 690+00.00 X=-1,658,161.1831 Y=-1,668,034.1317

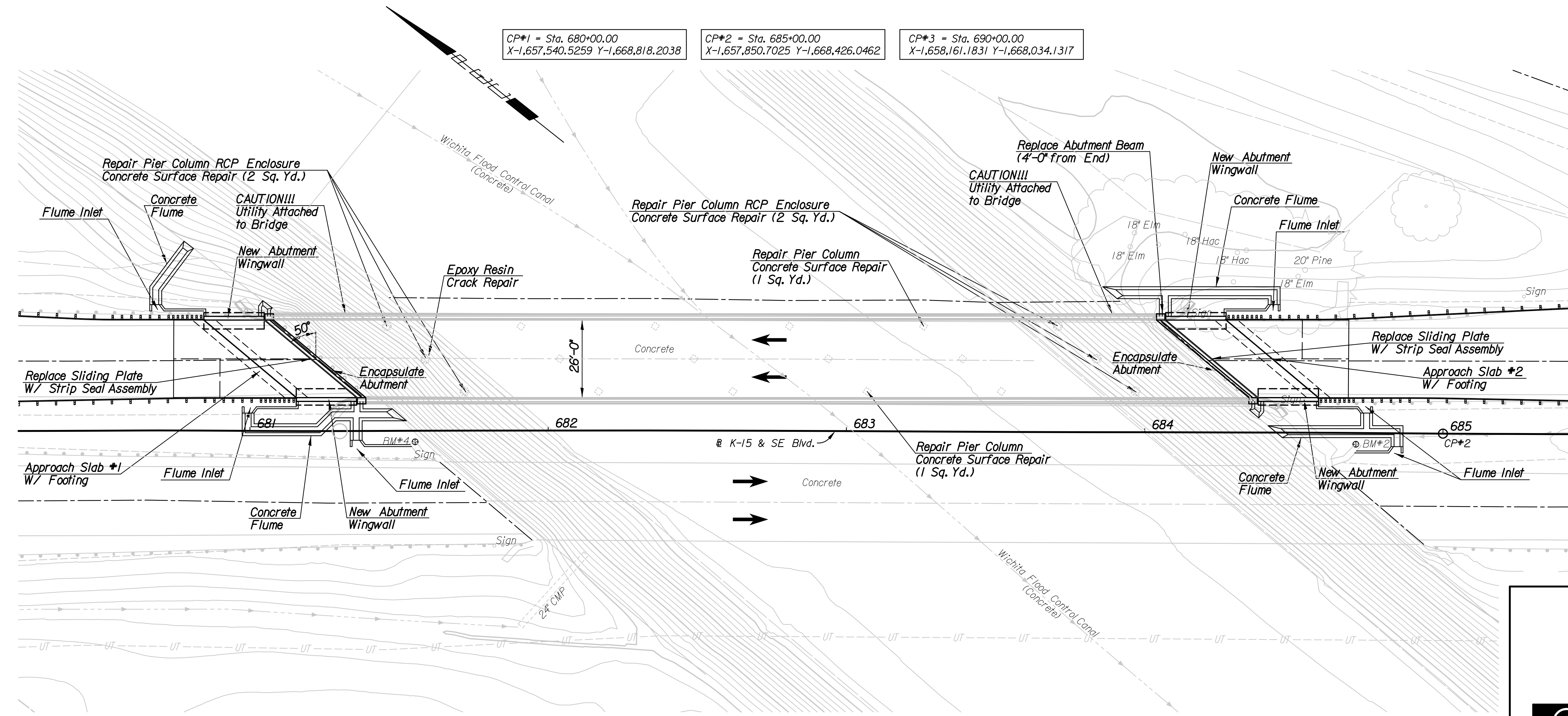

PLAN
 Scale: 1"=20'

B.M. #2 Chiseled "□" on N. Corner of E. Abut. Wingwall, S.B.
 3.77' Rt. & Sta. 684+70.81 Elev. = 1,285.88
 X=-1,657,829.7507 Y=-1,668,446.7189

B.M. #4 Chiseled "□" on N. Corner of E. Abut. Wingwall, S.B.
 3.72' Rt. & Sta. 681+55.38 Elev. = 1,285.85
 X=-1,657,634.3142 Y=-1,668,694.2509

Plotted By: op Date: 7/22/2011 10:43:26 AM
 FILE: I:\2010\10313\BRIDGE\10313-Construction\Layout.dgn

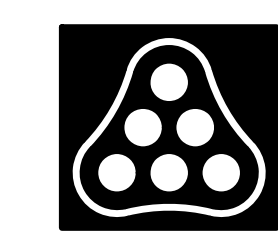

No.	Revision	By	Date
SOUTHEAST BLVD AT WICHITA FLOOD CONTROL CANAL CONSTRUCTION LAYOUT			
JAMES L. ARMOUR, P.E. - CITY ENGINEER CITY OF WICHITA PROJECT NO. 472-84923 Professional Engineering Consultants, P.A. 303 S. TOPEKA • WICHITA, KANSAS 67202 316-262-2691 • FAX 316-262-3003			
Designed by	RJM	Job No.	10313
Drawn by	RJM	Date	June, 2011
			Sht. 13 of 42