

Note:
 Special Concrete Bridge Approach shall be paid for as Sq. Yds. of Concrete Pavement (12"), Approach and includes all work and materials required to construct the Approach Slab as shown on this sheet. All work and materials required for installation of Expansion Joints shall be subsidiary to this bid item.
 All preformed joint material shall be installed perpendicular to pavement surface. Formed Joints shall be edged with a 1/4" radius tool for the length of the joint.
 At the Contractor's option #4 x 3'-0" Tie Bars @ 1'-3" centers may be substituted for the #6E Bars @ 2'-6" centers.
 All Reinforcing Steel shall be Epoxy Coated.
 See Std. No. RD712 for Joint Details.
 See Std. No. RD711 for Welded Wire Mesh and Joint Details
 Clearance for all reinforcing steel shall be 2".
 Standard reinforcing bar hooks in accordance with the latest A.C.I. Specifications shall be used throughout.

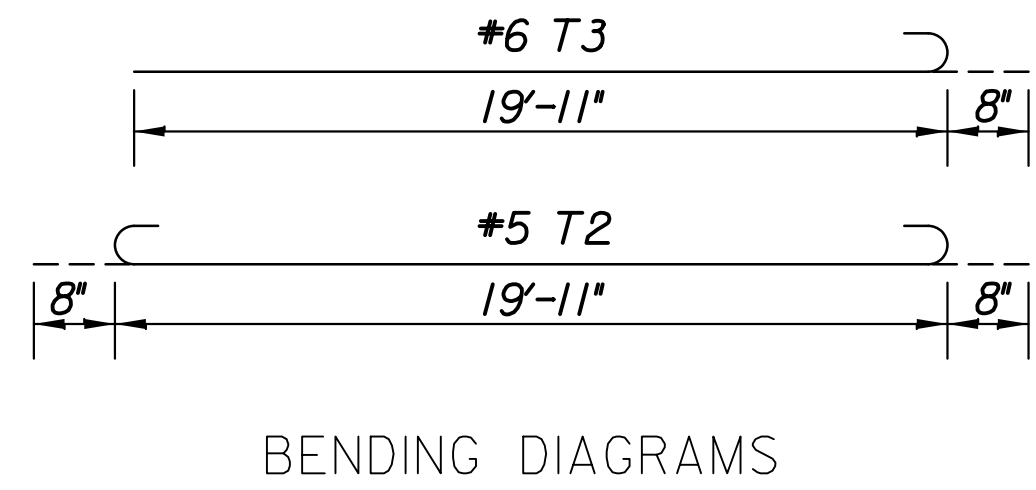

| *BILL OF MATERIALS | | | | | | |
|-------------------------------------------|---------|--------|--------|---------|-------|----------------|
| Bar Schedule | | | | | | |
| Bar No. | T1 | T2 | T3 | T4 | E1 | WWF (Epoxy) |
| 28 | 42 | 52 | 42 | 22 | | 1,326 Sq. Ft. |
| Size | #5 | #5 | #6 | #5 | #6 | 6x6-W4xW4 ** |
| Length | 19'-11" | 21'-3" | 20'-7" | 19'-11" | 3'-0" | 769 Lbs |
| Reinforcing Steel (Grade 60) Epoxy Coated | | | | | | 4,092 lbs. |
| Concrete Pavement 12", Approach | | | | | | 132.2 Sq. Yds. |
| Expansion Jt. Membrane Sealant | | | | | | 40.5 Lin. Ft. |

* Quantities shown for one Approach Slab only. (2 Req.)
 ** 58 lbs. per 100 Sq. Ft.
 *** For Information Only

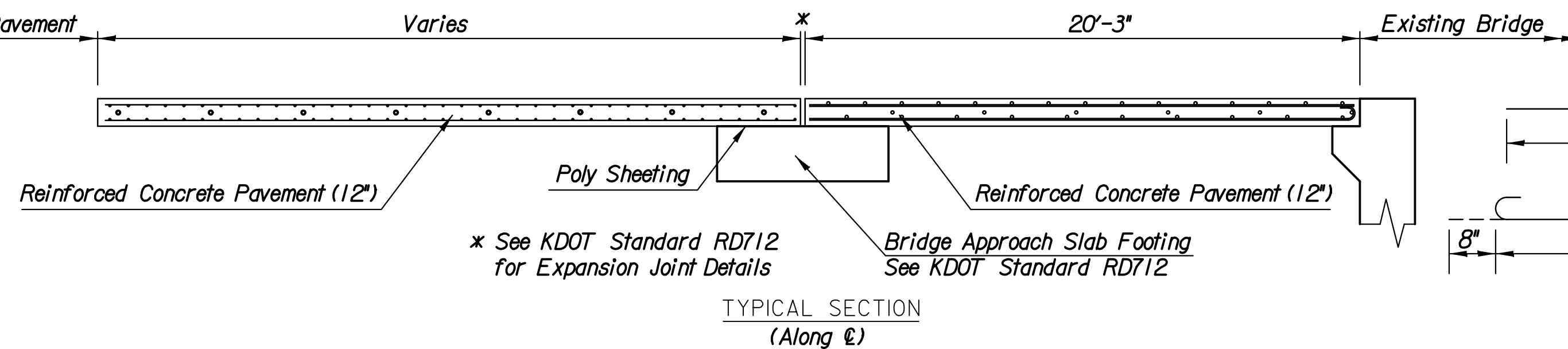
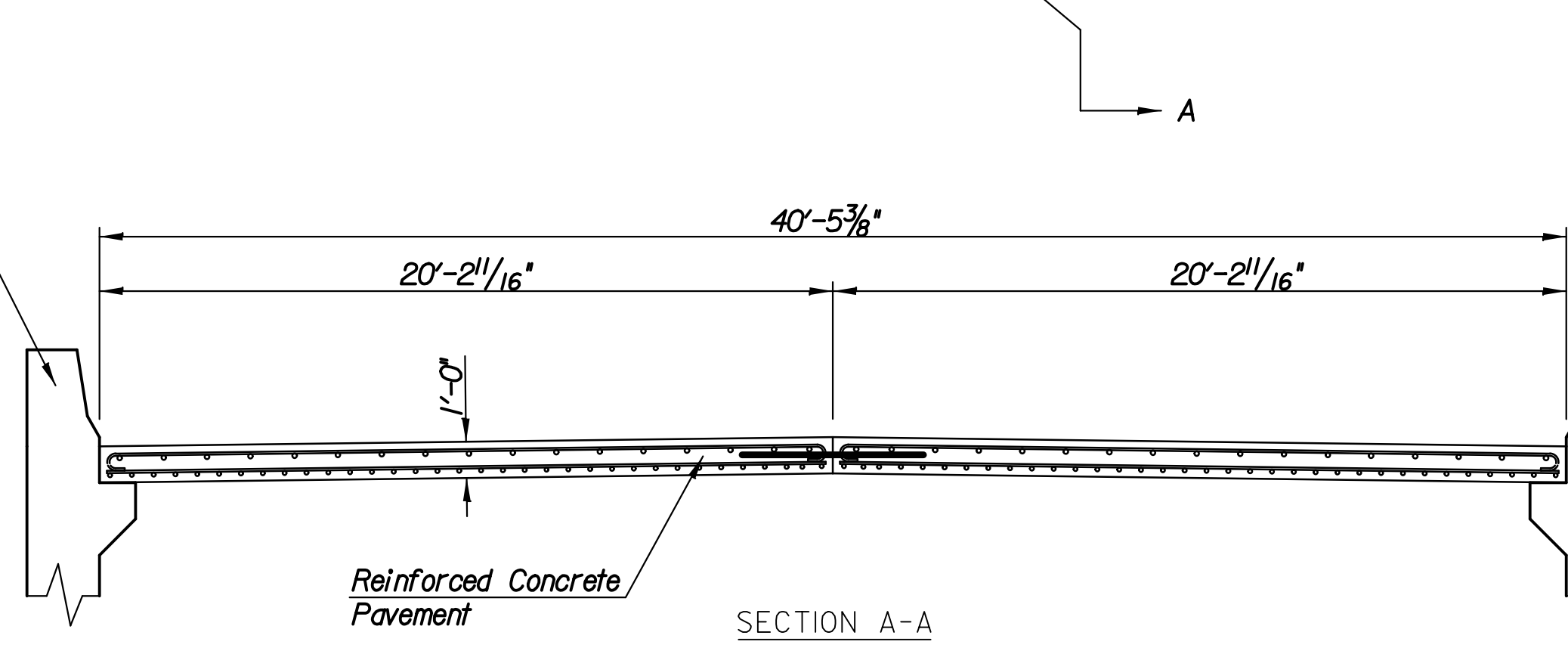
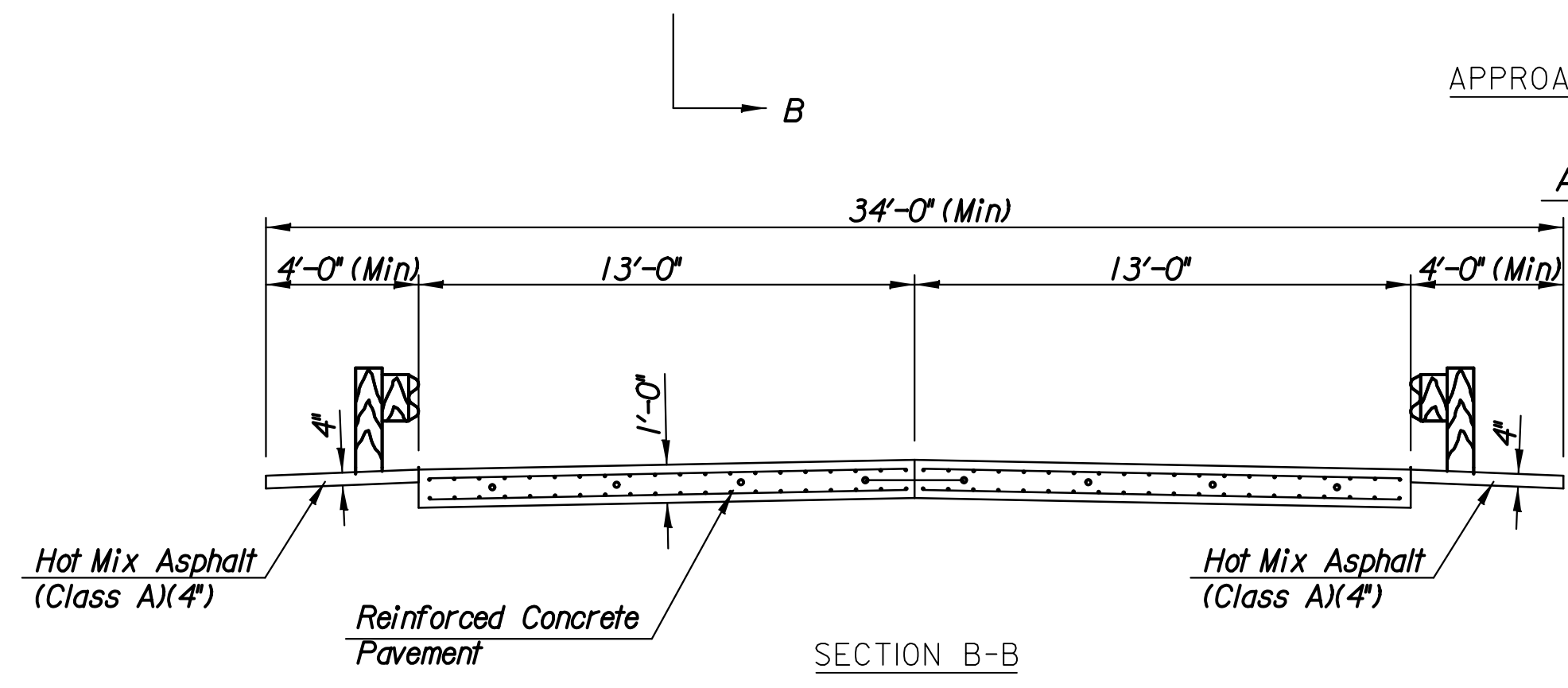
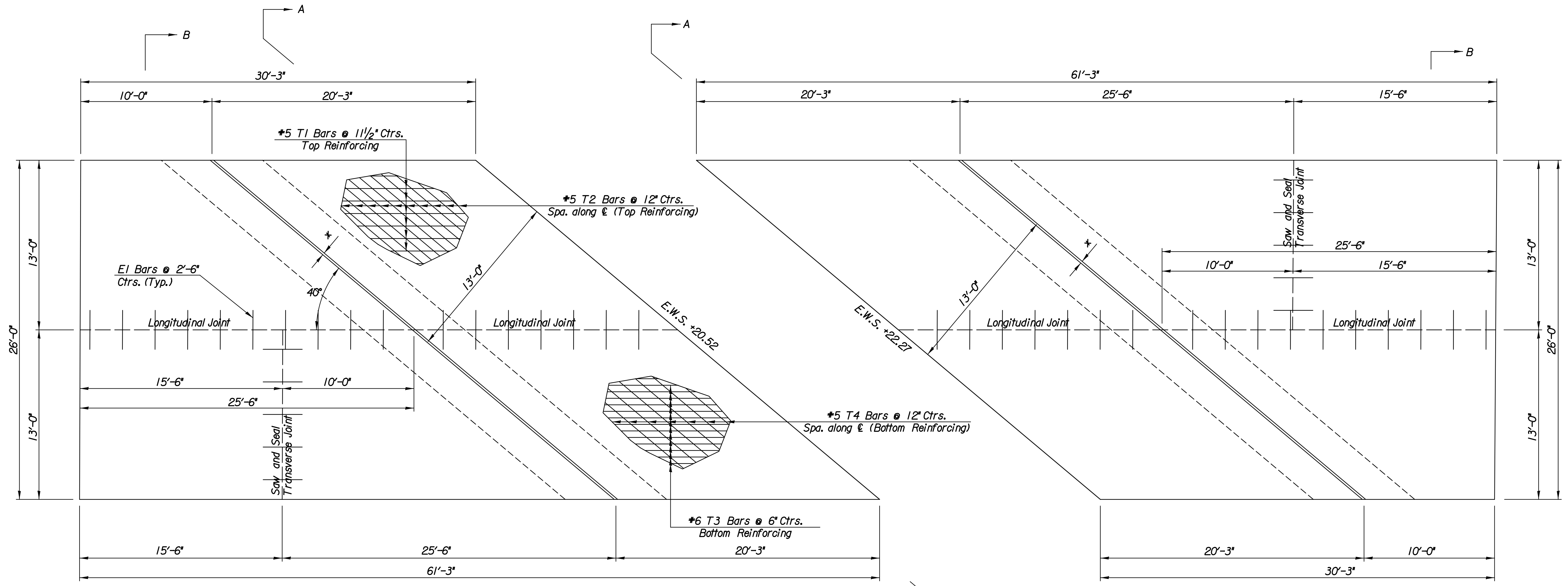

| | | | |
|-------------------------------------------------------------------------------------------------------------------------------|----------|---------|------------|
| No. | Revision | By | Date |
| SOUTHEAST BLVD AT WICHITA FLOOD CONTROL CANAL | | | |
| APPROACH SLAB DETAILS | | | |
| JAMES L. ARMOUR, P.E.-CITY ENGINEER CITY OF WICHITA PROJECT NO. 472-84923 | | | |
| Professional Engineering Consultants, P.A. 303 S. TOPEKA • WICHITA, KANSAS 67202 316-262-2691 • FAX 316-262-3003 | | | |
| Designed by | RJM | Job No. | 10313 |
| Drawn by | RJM | Date | June, 2011 |

Plotted By: op Date: 7/22/2011 10:43:29 AM
 FILE: I:\2010\10313\Bridges\10313-AppSlabs.dgn