

**STATE OF KANSAS**  
**DEPARTMENT OF TRANSPORTATION**  
**PLAN AND PROFILE OF PROPOSED**  
**SENECA STREET**  
**I-235 TO 31ST STREET SOUTH**

| STATE                         | PROJECT NO.  | YEAR | SHEET NO. | TOTAL SHEETS |
|-------------------------------|--------------|------|-----------|--------------|
| KANSAS                        | 87 N-0243-01 | 2005 | 1         | 169          |
| Federal Aid No. STP N024(301) |              |      |           |              |

CITY OF WICHITA PROJECT NUMBERS:

|                | PROJECT # | OCA#   |
|----------------|-----------|--------|
| WATERLINE      | 448-90511 | 636247 |
| SANITARY SEWER | 468-84730 | 620572 |

**CONCRETE PAVEMENT SURFACING**  
**TRAFFIC SIGNALIZATION**  
**SIGNING AND PAVEMENT MARKINGS**

INDEX OF SHEETS

- 1 TITLE SHEET
- 2-6 TYPICAL SECTIONS
- 7-16 PLAN SHEETS
- 17-25 INTERSECTION DETAILS
- 26-32 PAVEMENT DETAILS
- 33-42 JOINT PLAN
- 43-50 INLET & MANHOLE DETAILS
- 51-62 STORM SEWER PLAN & PROFILE
- 63 SCHEDULE OF INLETS AND MANHOLES
- 64-65 SUMMARY OF QUANTITIES
- 66-82 EROSION CONTROL
- 83-90 TRAFFIC SIGNALS
- 91-97 PAVEMENT MARKING & SIGNING
- 98 CONSTRUCTION SEQUENCE
- 99-124 TRAFFIC CONTROL
- 125-133 TRAFFIC CONTROL DETAILS
- 134-164 CROSS SECTIONS
- 165-168 WATERLINE DETAILS
- 169 SANITARY SEWER

**FEDERAL AID PROJECT**  
**SEDGWICK COUNTY**  
**CITY OF WICHITA**  
**POPULATION 355,000**  
**CITY OF WICHITA PROJECT #472-84006**  
**OCA #706892**

Sta. 90+17.08, END PROJECT  
 PROJ: 87 N-0243-01

Sta. 22+16.52, BEGIN CONSTRUCTION  
 PROJ: 87 N-0243-01

**SENECA AVENUE DESIGN DESIGNATION**

|             |         |
|-------------|---------|
| AADT (2003) | 21,955  |
| AADT (2023) | 24,260  |
| DHV         | 11%     |
| D           | 65%     |
| T           | 7%      |
| V           | 40 mph  |
| C of A      | Partial |
| Clear Zone  | 6 ft.   |

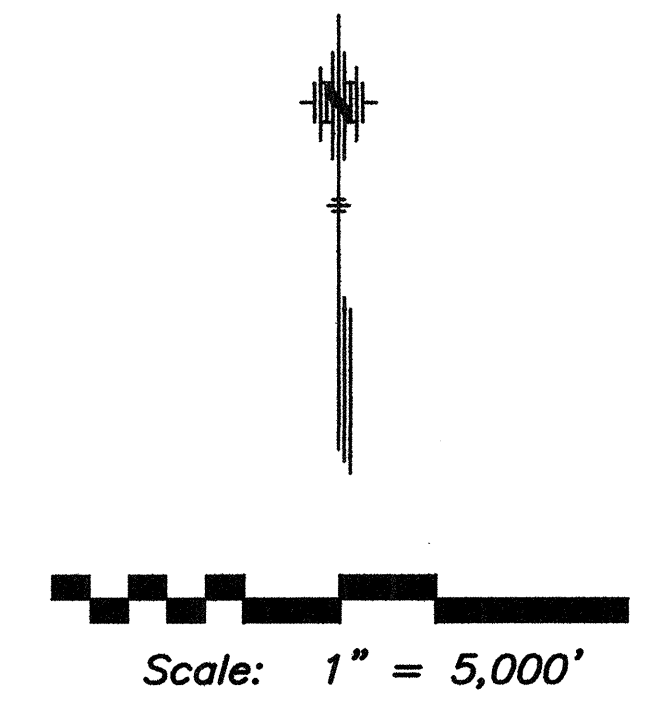
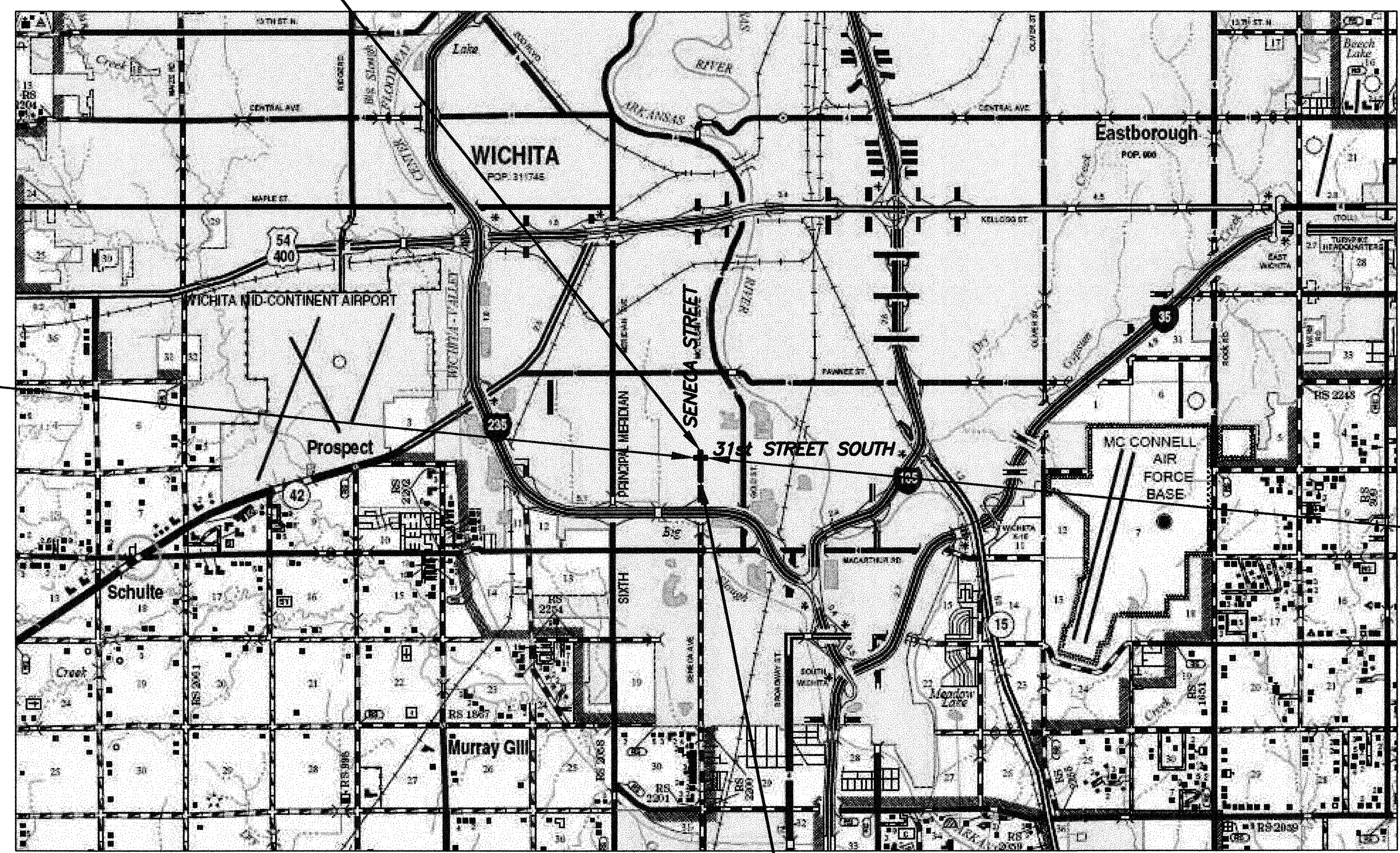

NOTE:  
 Traffic to be carried through construction.

Sta. 30+81.83, END CONSTRUCTION  
 PROJ: 87 N-0243-01

Sta. 55+50.00, BEGIN PROJECT  
 PROJ: 87 N-0243-01

CONVENTIONAL SIGNS

|                                 |       |                          |         |
|---------------------------------|-------|--------------------------|---------|
| COUNTY LINE                     | ---   | CENTER LINE OF PROJECT   | —+—+—+— |
| CITY LIMITS                     | ----  | TERRACE                  | =====   |
| STATE OR NATIONAL LINE          | ----- | CULVERTS                 | —+—+—+— |
| TOWNSHIP, SECTION or GRANT LINE | ----- | DROP INLET & STORM SEWER | —+—+—+— |
| PROPERTY LINE                   | ----- | ACCESS CONTROL           | —+—+—+— |
| HIGHWAY FENCE                   | ----- | POWER POLE               | —+—+—+— |
| EXISTING FENCE                  | ----- | TELEPHONE POLE           | —+—+—+— |
| GUARD FENCE                     | ----- | MARSH                    | —+—+—+— |
| CONSTRUCTION LIMITS             | ----- | HEDGE                    | —+—+—+— |
| RIGHT OF WAY LINE               | ----- | TREES                    | —+—+—+— |
| TRAVELED WAY                    | ----- | PROFILE ELEVATION        | —+—+—+— |
| RAILROADS                       | ----- | STREAM or CREEK          | —+—+—+— |

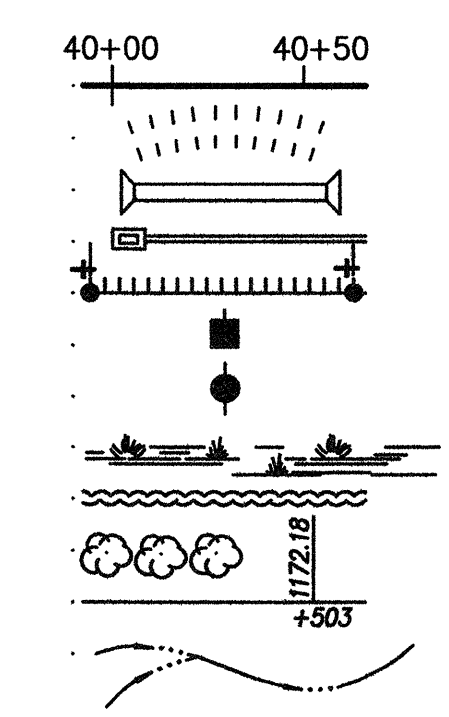

|                         |             |
|-------------------------|-------------|
| GROSS LENGTH OF PROJECT | 3,467.08 ft |
| EXCEPTIONS              | 0.000 ft    |
| NET LENGTH OF PROJECT   | 3,467.08 ft |
| NET LENGTH OF BRIDGES   | 0.000 ft    |
| NET LENGTH OF ROAD      | 3,467.08 ft |

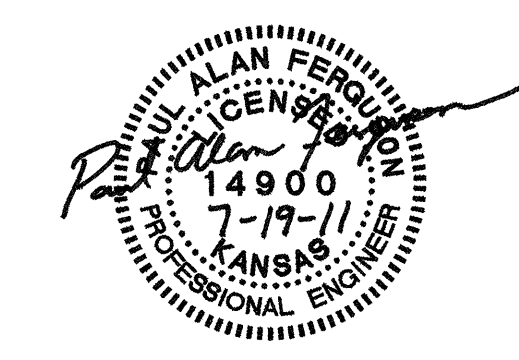

APPROVED - DATE 7-20-2011  
 James L. Armour  
 JAMES L. ARMOUR, P.E., L.S.  
 CITY ENGINEER  
 CITY OF WICHITA