

North Quarter Section Corner
Sec 7-T28S-R1E

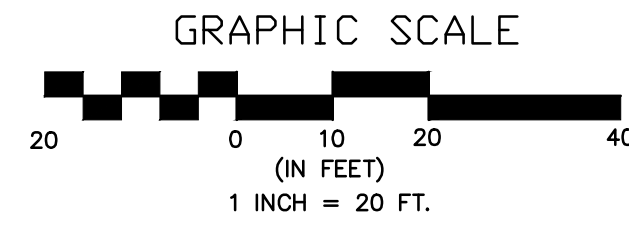

1. Found a 1" Rebar 8" below road surface in a Thimble 4" below road surface.
2. "+ cut on top at East end of hubguard handrail of RCB, 40.15' (NNW).
3. "PK" Nail & MKEC CLS 39 Washer in NW face of Power Pole, 45.85' (NE).
4. "PK" Nail & MKEC CLS 39 Washer in NW face of Power Pole, 94.15' (SW).

STATE	PROJECT NO.	YEAR	SHEET NO.	TOTAL SHEETS
KANSAS	87 N-0243-01	2005	15	169

Federal Aid No. STP N024(301)

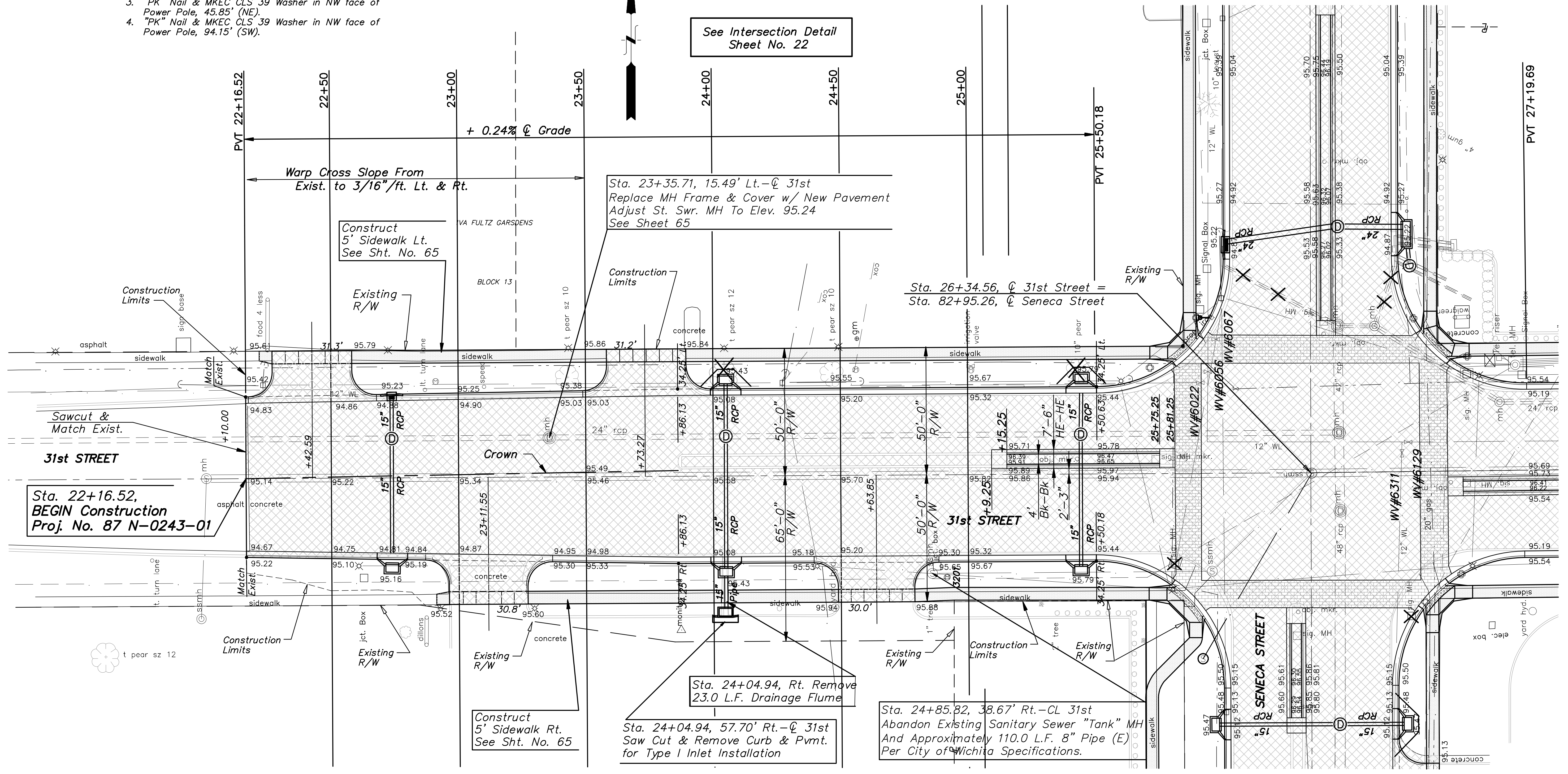

No.	Date	By	Approved	Revision

SENeca STREET
1-235 TO 31ST STREET
31st STREET SOUTH
CITY OF WICHITA, KANSAS
STA. 22+16.52 TO STA. 27+00

POE & ASSOCIATES, INC.
CONSULTING ENGINEERS
5940 E. Central, Suite 200 Wichita, KS
67208-4242
Phone: 316/685-4114 FAX: 316/685-4444

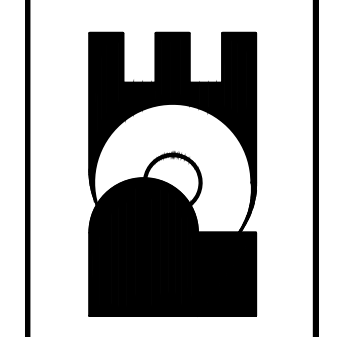

Engineer: P. FERGUSON
Designer: J. UNRUH
KDOT Job No.: 87 N-0243-01 Poe Job No.: 1794
Date: JANUARY 2010