

| | | | | |
|-------------------------------|--------------|------|-----------|--------------|
| STATE | PROJECT NO. | YEAR | SHEET NO. | TOTAL SHEETS |
| KANSAS | 87 N-0243-01 | 2005 | 167A | 169 |
| Federal Aid No. STP N024(301) | | | | |

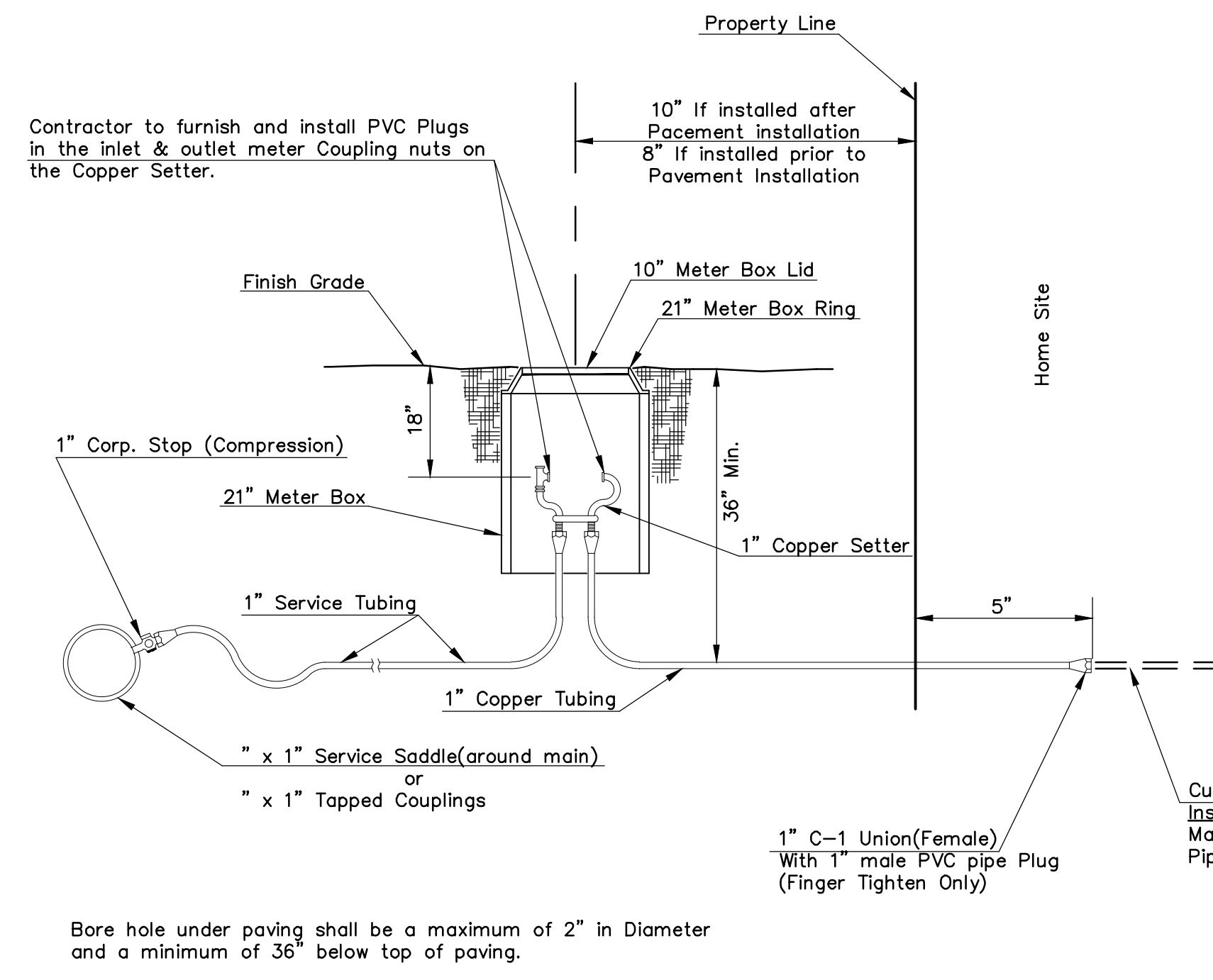

Note: Service Saddles are not required on top of 8" mains or larger

Meter boxes will be located on each lot to be served, as indicated in the SPECIAL PROVISIONS

**TYPICAL METER SETTING
LONG SERVICE 1"**

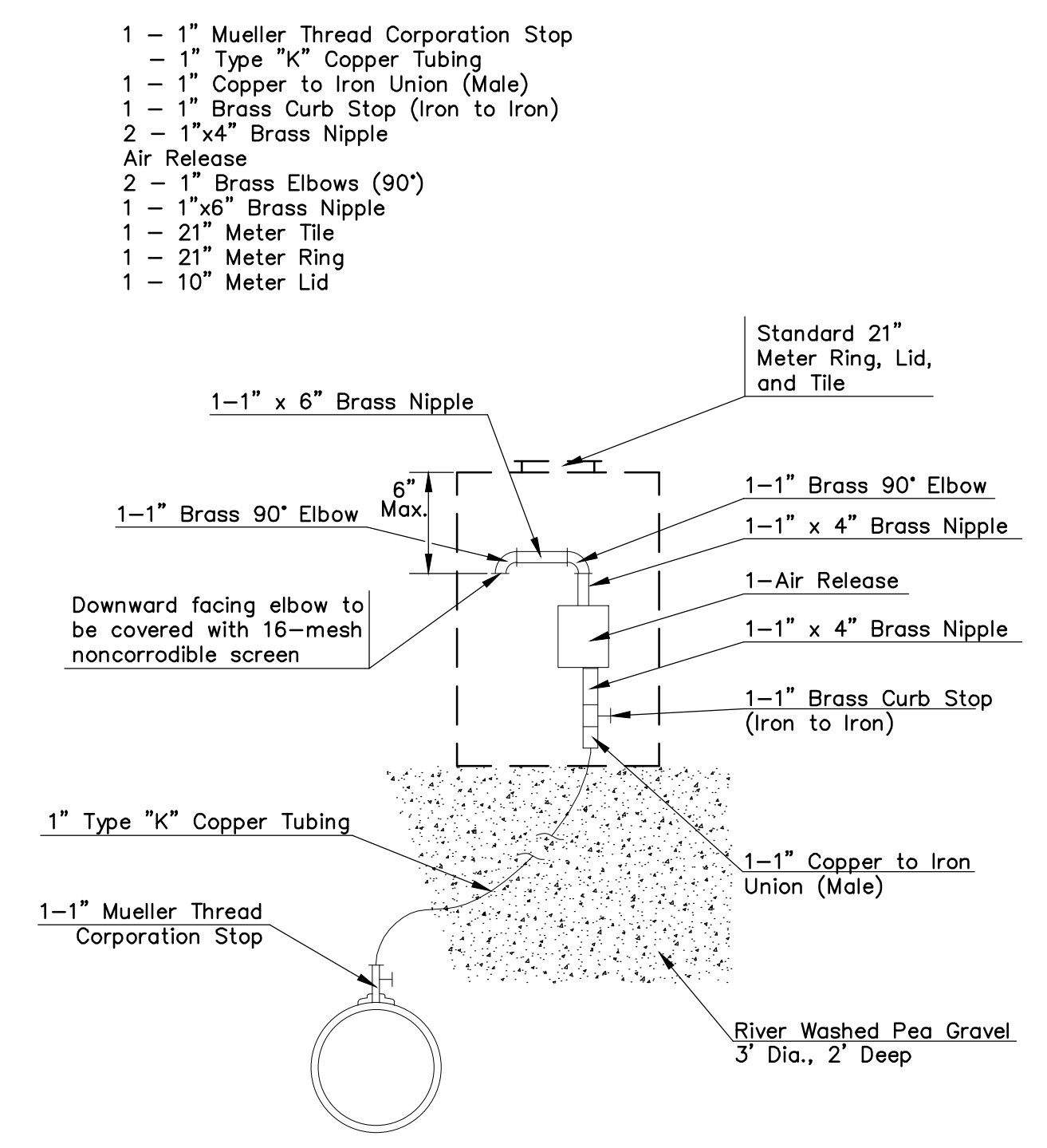

MATERIALS FOR AIR RELEASE ASSEMBLY

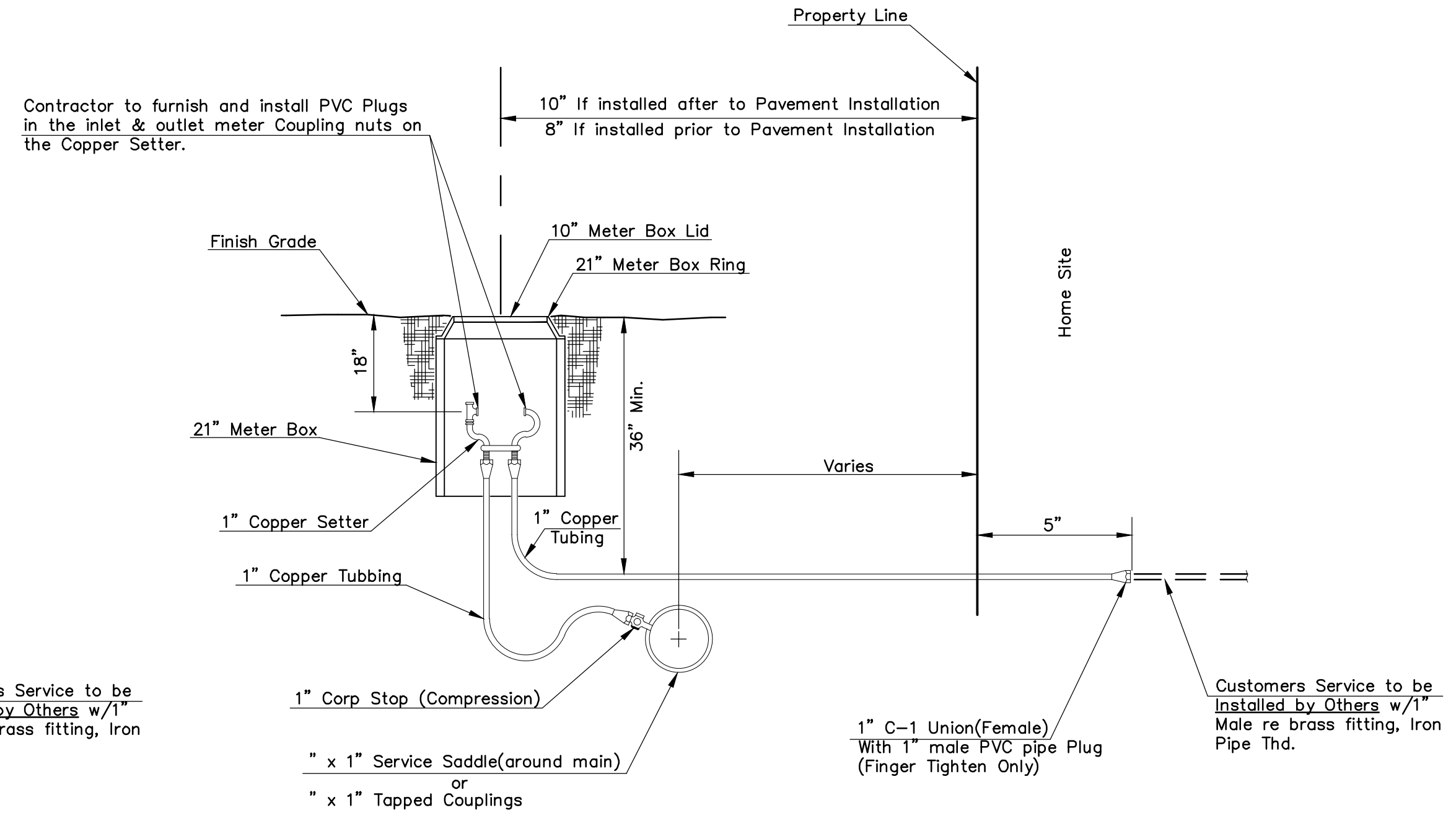

Note: Service Saddles are not required on top of 8" mains or larger

Meter boxes will be located on each lot to be served, as indicated in the SPECIAL PROVISIONS

**TYPICAL METER SETTING
SHORT SERVICE 1"**

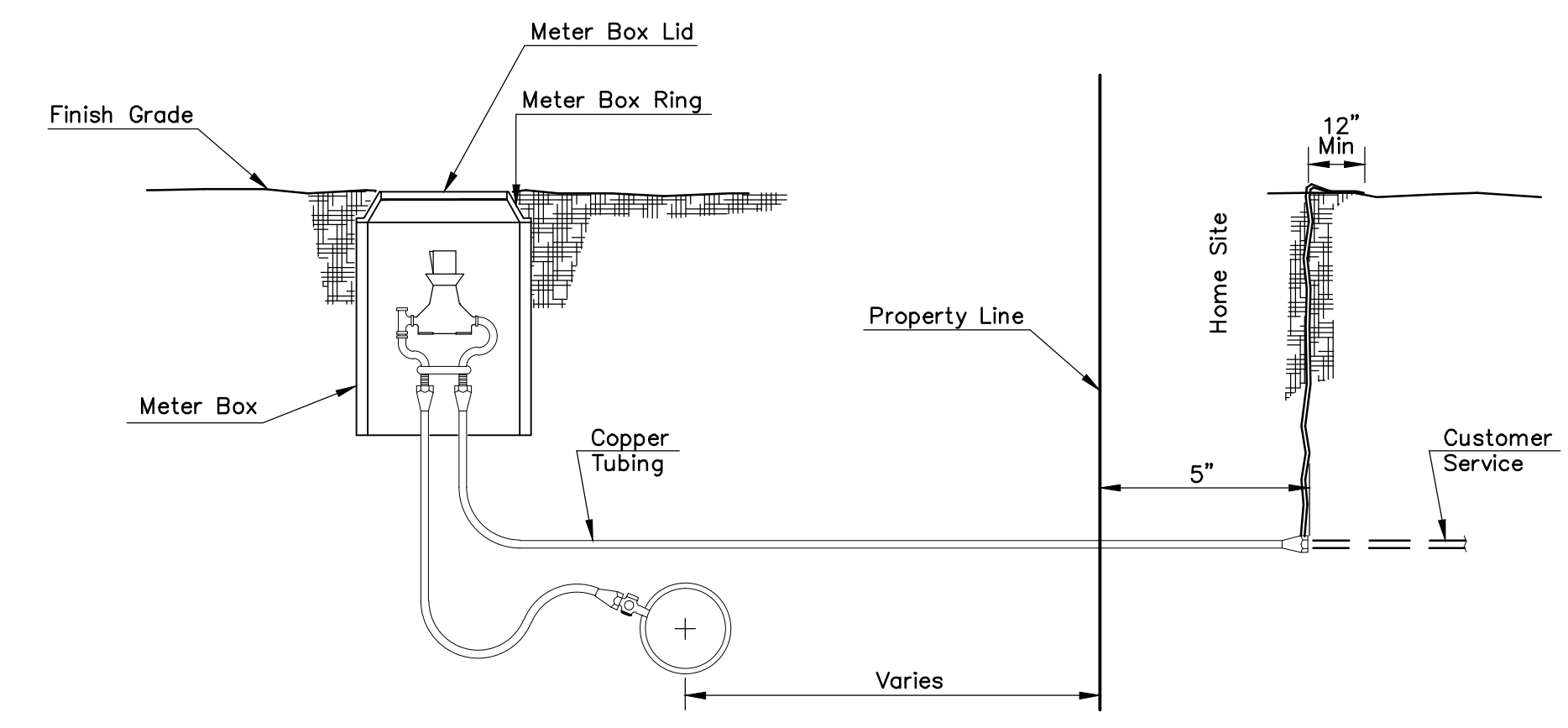

**TYPICAL METER SETTING
PLASTIC FLAGGING**

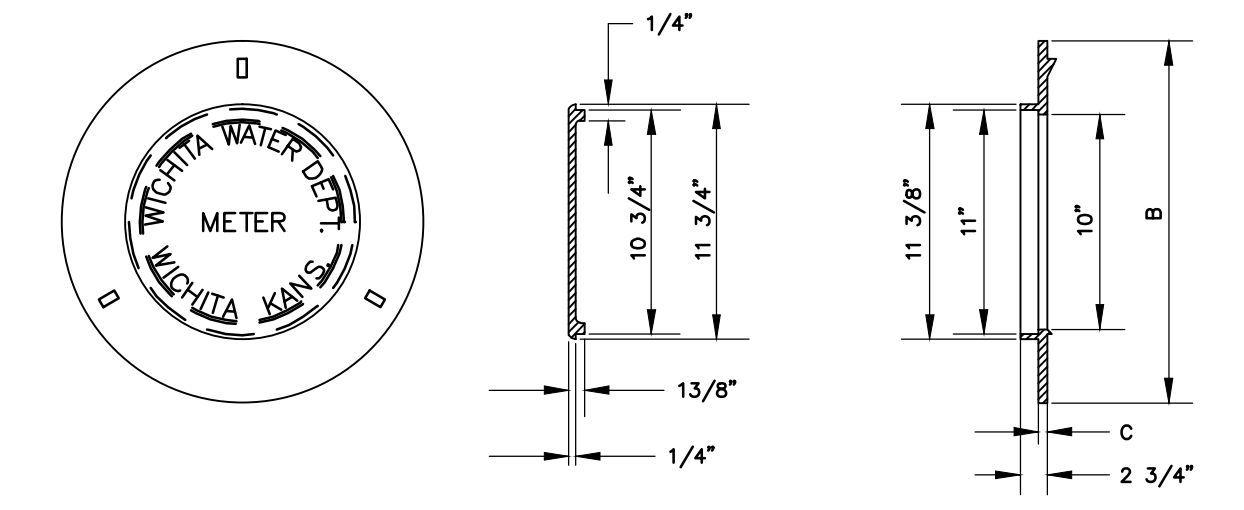

| TITLE SIZE | Dimensions | | |
|------------|------------|-----|-------|
| | A | B | C |
| 21" | 20 1/2" | 25" | 7/16" |

Other Approved Ring And Lids: Ford Meter Box Co. Inc. 21" Ring & Lid Catalog No. C-4

RING & LID FOR METER VAULTS

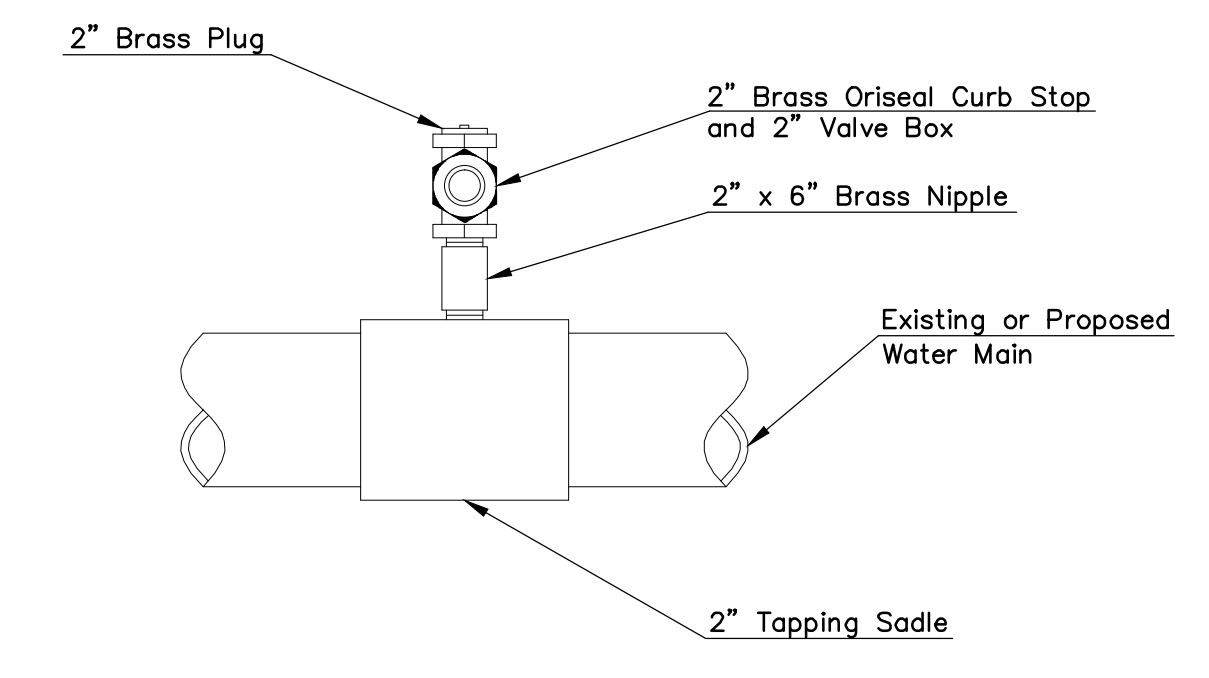

Note: Where the 2" service outlet assembly is to be used to connect a 2" main to another main, the 2" valve shall be a 2" IPT Gate Valve. 2" Ball or Globe valve shall not be approved for this use.

2" SERVICE OUTLET ASSEMBLY



**STANDARD
WATER SERVICE
DETAILS**

SENECA STREET
1-235 TO 31ST STREET
CITY OF WICHITA, KANSAS
STANDARD DETAILS - WATER SERVICE

POE & ASSOCIATES, INC.
CONSULTING ENGINEERS
5940 E. Central, Suite 200 | Wichita, KS
67208-4242
Phone 316/685-4114 | FAX 316/685-4444

ENGINEER: P. FERGUSON
DESIGNER: J. UNRUH
KDOT Job No.: 87 N-0243-01
Date: JANUARY 2010

Sheet
167A of 169