

PROJECT NUMBER	Sheet No.	Total Sheets
87N-0494-01	1	69

HSIP-N049 (401)

GRADING  
PAVEMENT  
STORM SEWER  
PAVEMENT MARKINGS

STATE OF KANSAS  
CITY OF WICHITA  
SEDGWICK COUNTY  
**E. HARRY ST. & WOODLAWN ST.  
INTERSECTION**  
CITY OF WICHITA PROJECT NO. 472-84882  
OCA NO. 707015



FEDERAL AID PROJECT

Sta. 58+28.70 End Construction

**INDEX OF SHEETS**

1	TITLE SHEET
2-4	TYPICAL SECTIONS
5	GENERAL NOTES
6-9	PLAN SHEETS
10-13	ENTRANCE PROFILES
14	INTERSECTION DETAIL
15	JOINT DETAIL PLAN
16-20	PAVING STANDARDS
21-22	SUMMARY OF QUANTITIES
23	STORM SEWER PLAN & PROFILE
24-28	CURB INLET & MANHOLE STANDARDS
29	SCHEDULE OF INLETS & MANHOLES
30-33	CONSTRUCTION SEQUENCE PLANS
34-41	TRAFFIC CONTROL STANDARDS
42-44	PAVEMENT MARKING PLANS
45-46	PAVEMENT MARKING STANDARDS
47	PAVEMENT MARKING QUANTITIES
48	SIGNAL PLAN
49	SIGNAL WIRING PLAN
50	SIGNAL QUANTITIES
51-53	TRAFFIC SIGNAL STANDARDS
54-57	EROSION CONTROL STANDARDS
58	PROJECT CONSTRUCTION SIGN STANDARD
59-69	CROSS SECTIONS

Sta. 106+09.65; BEGIN  
PROJ. NO. 87N-0494-01

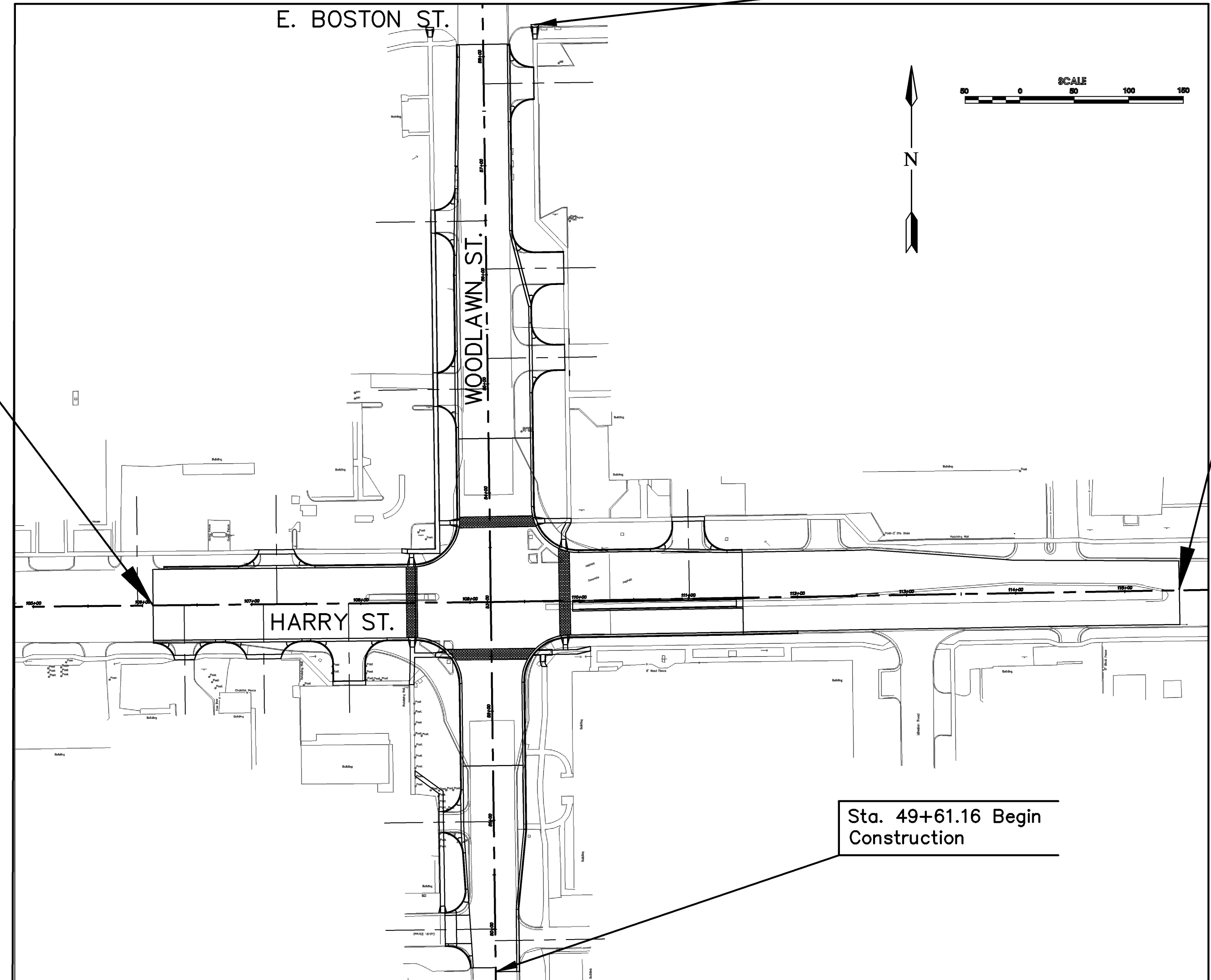

Sta. 115+50.00; END  
PROJ. NO. 87N-0494-01

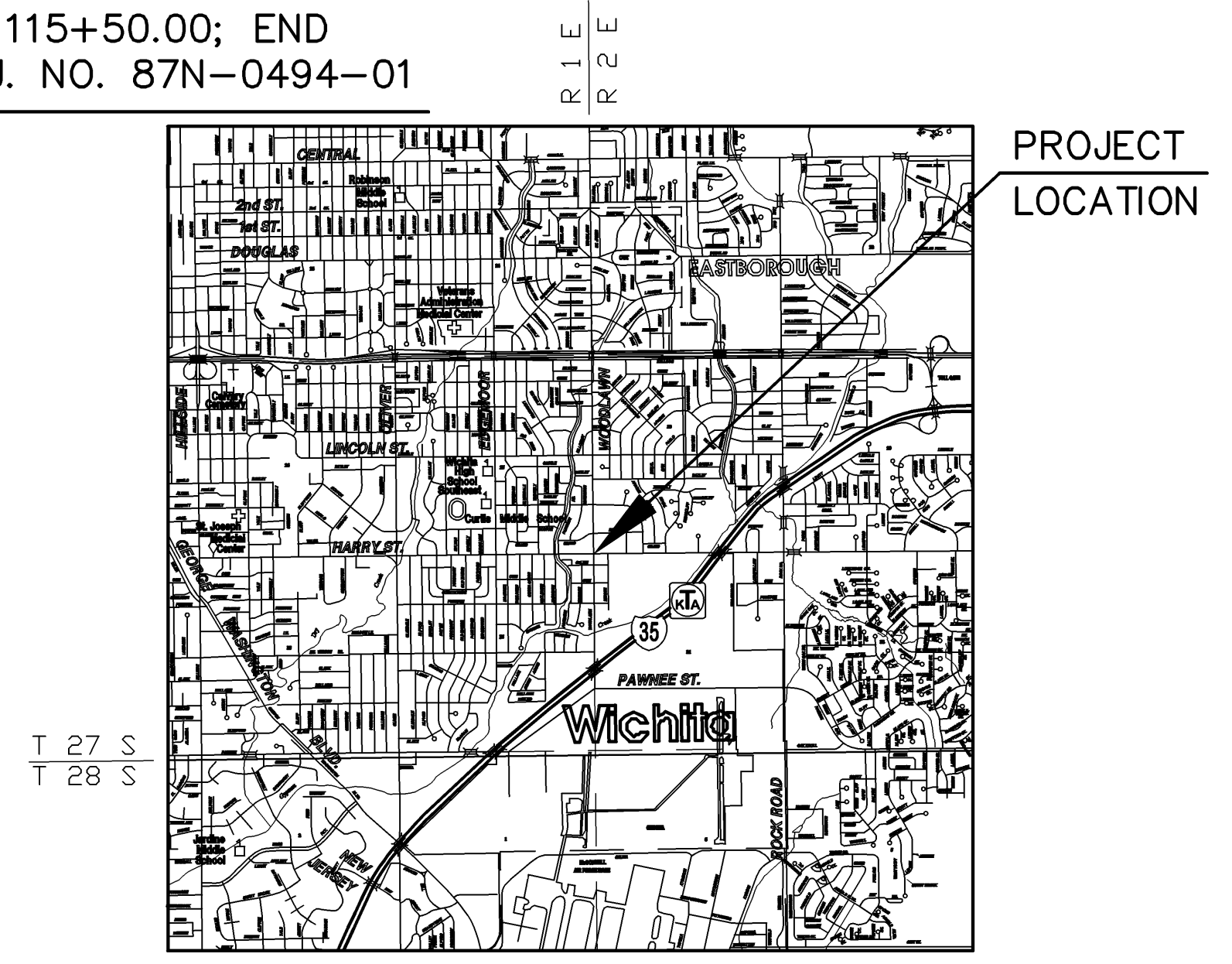

Population: 382,368 (2010)

**DESIGN DESIGNATION**

AADT (2010)	= 28,155
AADT (2035)	= 40,867
DHV	= 1,290
D	= 50%
DL	= 90%
T	= 6%
V	= 40 M.P.H.
C of A	= None
Clear Zone	= 6 feet

NOTE:  
TRAFFIC SHALL BE CARRIED THROUGH CONSTRUCTION. ACCESS TO ADJACENT PROPERTY SHALL BE MAINTAINED DURING CONSTRUCTION.

Sta. 49+61.16 Begin Construction

COUNTY LINE	CONVENTIONAL SIGNS	CENTER LINE OF PROJECT	
CITY LIMITS		TERRACE	
STATE OR NATIONAL LINE		CULVERTS	
TOWNSHIP, SECTION or GRANT LINE		DROP INLET & STORM SEWER	
PROPERTY LINE		ACCESS CONTROL	
HIGHWAY FENCE		POWER POLE	
EXISTING FENCE		TELEPHONE POLE	
GUARD FENCE		MARSH	
CONSTRUCTION LIMITS		HEDGE	
RIGHT OF WAY LINE		TREES	
TRAVELED WAY		PROFILE ELEVATION	
RAILROADS		STREAM or CREEK	

GROSS LENGTH OF PROJECT (HARRY ST.)	940.35	ft.
GROSS LENGTH OF PROJECT (WOODLAWN ST.)	717.54	ft.
EXCEPTIONS	0.00	ft.
NET LENGTH OF PROJECT	1,657.89	ft.
NET LENGTH OF BRIDGES	0.00	ft.
NET LENGTH OF ROAD	1,657.89	ft.

**GENERAL NOTE**

ALL CONSTRUCTION METHODS AND MATERIALS USED IN THE CONSTRUCTION OF THE IMPROVEMENTS COVERED BY THESE PLANS SHALL BE IN ACCORDANCE WITH THE STANDARD TECHNICAL SPECIFICATIONS AND CURRENT REVISIONS ON FILE IN THE OFFICE OF THE CITY ENGINEER, CITY OF WICHITA, KANSAS. THE CITY ENGINEERS DECISIONS ON QUESTIONS REGARDING THESE PLANS SHALL GOVERN.

RELEASED FOR CONSTRUCTION \_\_\_\_\_ DATE \_\_\_\_\_  
JAMES ARMOUR CITY ENGINEER

PLANS PREPARED BY:  
**CFS** Cook, Flatt & Strobel  
ENGINEERS, P. A.

