

**LAKE EDGE TREATMENT
HAMPTON SQUARE SECOND
& PRAIRIE POINTE ADDITION**

**EMBANKMENT
PROTECTION-POND 1**

SHEET TITLE
468-84762
PROJECT NUMBER

LH JWC GJA
DESIGNED DRAWN CHECKED

ISSUED
November 2011
REVISED

SHEET NO.
2 of 11

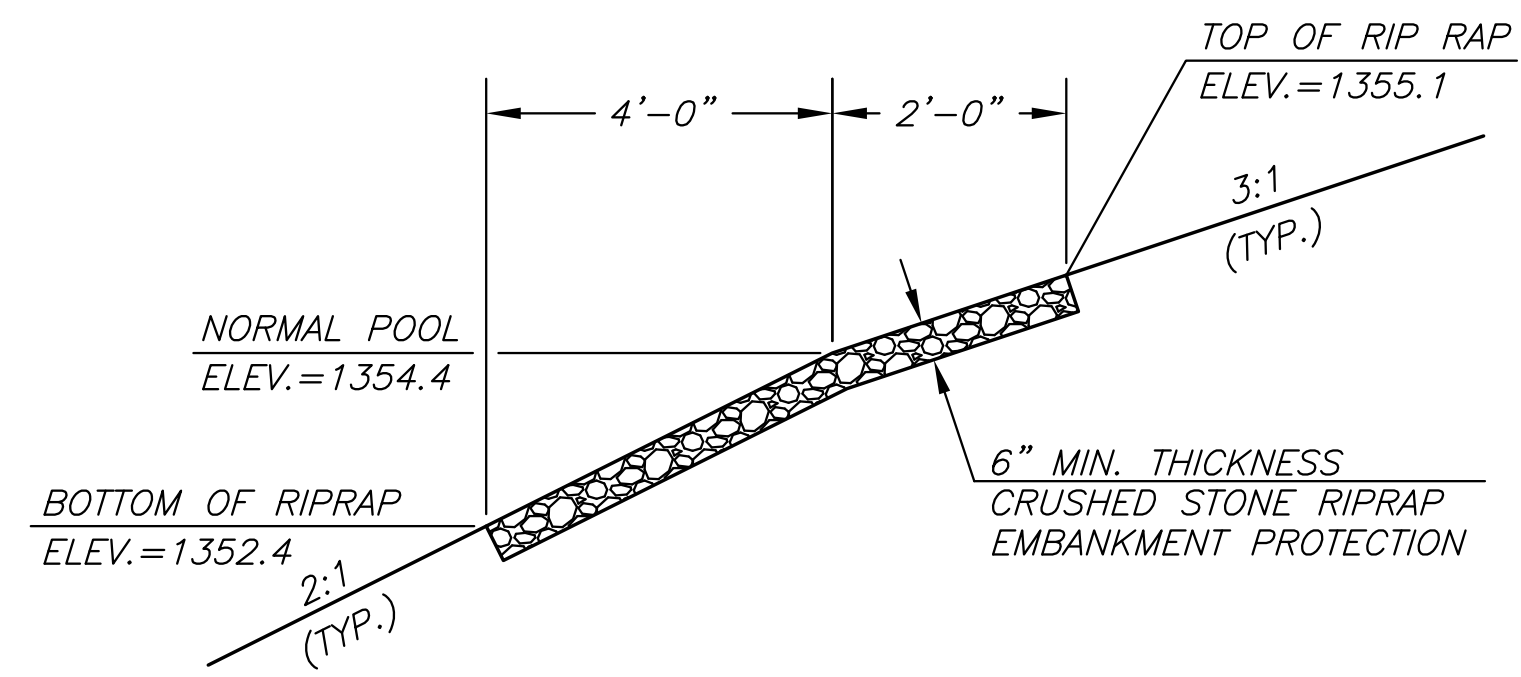
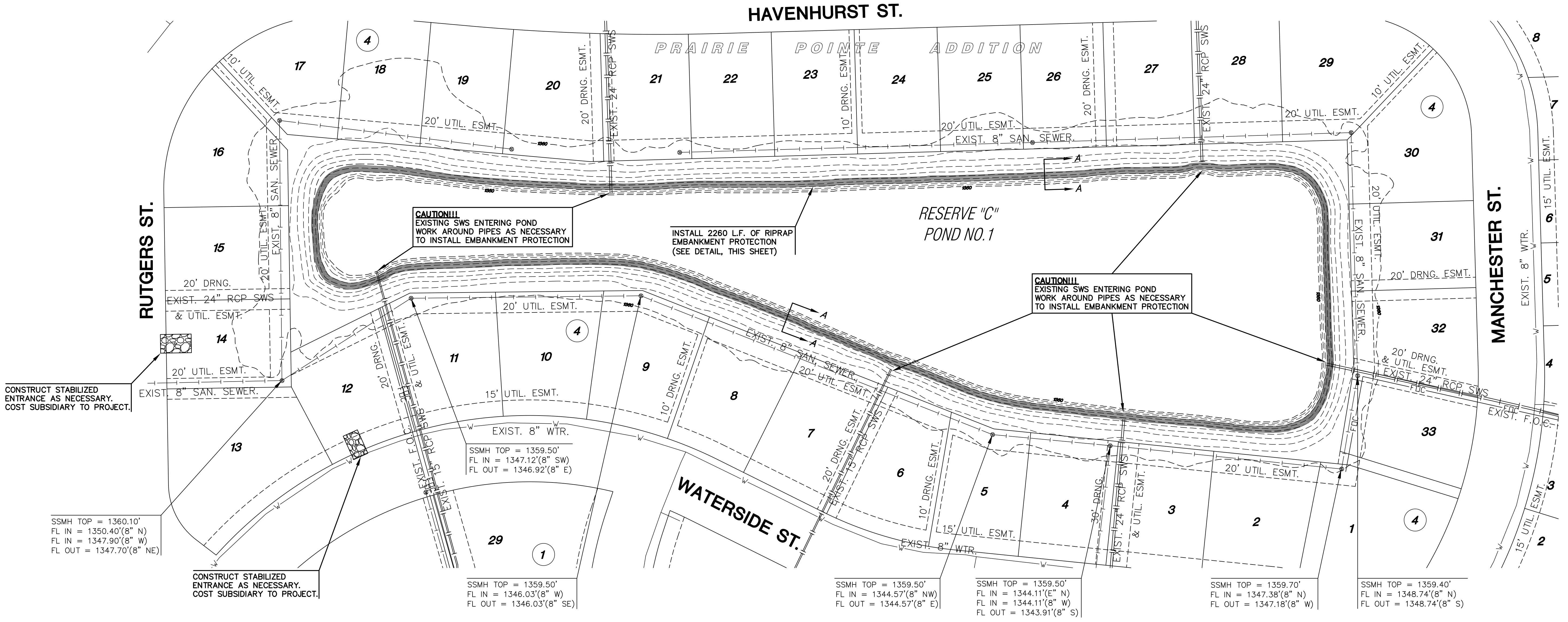

NOTE: CRUSHED STONE FOR THE RIPRAP EMBANKMENT PROTECTION SHALL BE COMMERCIALY AVAILABLE 5" x 9" CRUSHED LIMESTONE RIPRAP. MATERIALS SHALL MEET REQUIREMENTS FOR QUALITY AND DELETERIOUS SUBSTANCES AS SET FORTH IN SUBSECTION 1105.2 ROAD AND BRIDGE CONSTRUCTION, KANSAS DEPARTMENT OF TRANSPORTATION, 2007 EDITION. CRUSHED CONCRETE SHALL NOT BE ALLOWED.

* EARTHWORK FOR RIPRAP EMBANKMENT PROTECTION AND BANKLINE RESHAPING SHALL BE SUBSIDIARY TO PROJECT.

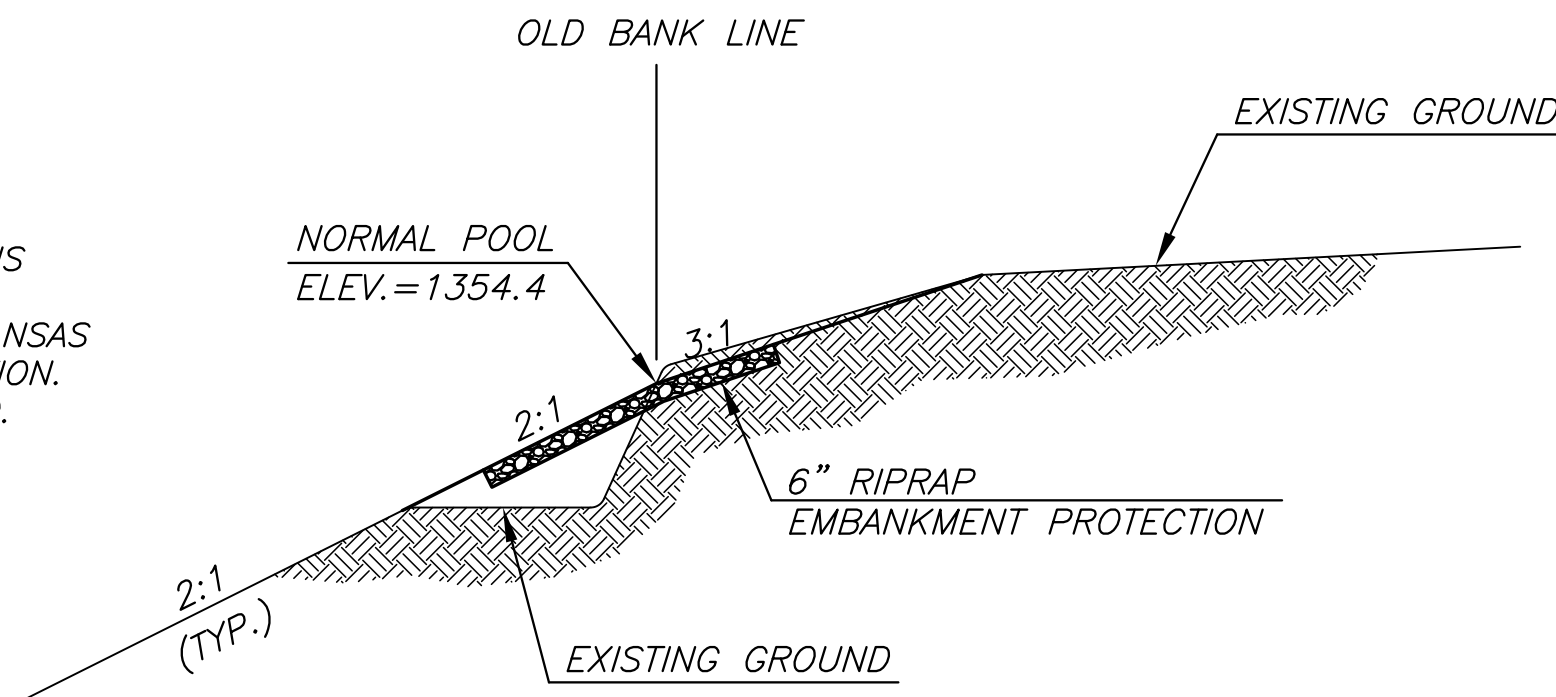

NOTE:
ACCESS TO SITE MAY BE THROUGH LOT 12 AND/OR LOT 14, BLOCK 4, PRAIRIE POINTE ADDITION. ACCESS AND TIMING TO BE COORDINATED WITH OWNER PRIOR TO CONSTRUCTION.

LEGEND

- W — EXISTING WATERLINE
- UGT — EXISTING UNDERGROUND TELEPHONE
- OHE — EXISTING OVERHEAD ELECTRICAL
- G — EXISTING GAS LINE
- SS — EXISTING SANITARY SEWER
- FOC — EXISTING FIBER OPTIC CABLE
- — — EXISTING SWS
- ▬ PROPOSED RIP RAP
- ◻ STABILIZED ENTRANCE

