

Existing Storm Sewer to be Abandoned in place per City of Wichita Specifications where not in conflict with construction of proposed Storm Sewer or Sanitary Sewer.

NOTE: LINE 2 FROM STA 0+00 TO STA 1+59.44 SHALL BE BID AND BUILT AS PART OF THE URBAN PARK PROJECT. LINE IS SHOWN IN THIS SET FOR INFORMATION ONLY. CONTRACTOR SHALL COORDINATE BETWEEN PROJECTS.

NOTE: CONTRACTOR SHALL INCLUDE PROVISION TO TEMPORARILY PUMP STORM WATER IF STORM LINE TO BE CONSTRUCTED WITH PARK PROJECT IS NOT IN PLACE WHEN PARKING STRUCTURE SWS IS CONSTRUCTED.

### BENCHMARKS

BENCHMARK #1: CHISELED SQUARE ON THE TOP OF CURB ON THE SOUTH SIDE OF ALLEY ON WEST SIDE OF TOPEKA, 1/2 BLOCK BETWEEN DOUGLAS AND WILLIAM ELEVATION = 1297.01 (NAVD88)

BENCHMARK #2: CHISELED SQUARE ON TOP OF CURB ON THE WEST CURB RETURN AT THE SOUTHWEST CORNER OF TOPEKA AND WILLIAM ELEVATION = 1296.32 (NAVD88)

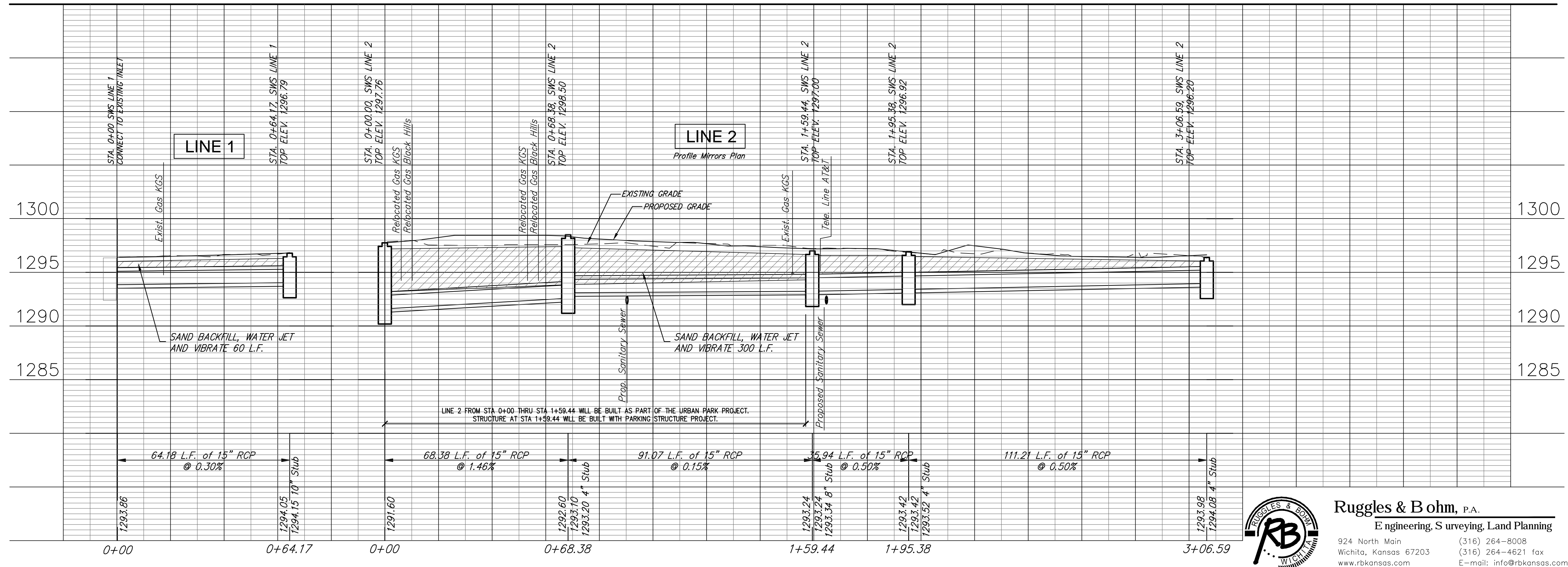

# DOUGLAS BLOCK PARKING STRUCTURE



WDM Architects P.A.  
105 North Washington  
Wichita, KS 67202-2815  
T 316.262.4700  
F 316.262.0002  
wdmarchitects.com

we do more

PRINTS ISSUED  
09.02.11 - PRICING SET  
10.28.11 - FOR BID

WDM No. drawn: BDT  
checked: KWL/B  
SWS P&P

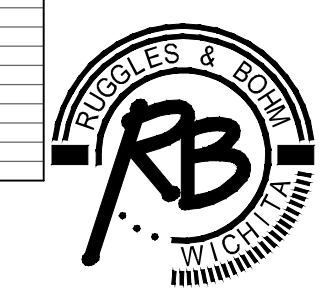

Ruggles & Bohm, P.A.  
Engineering, Surveying, Land Planning  
924 North Main (316) 264-8008  
Wichita, Kansas 67203 (316) 264-4621 fax  
www.rbkansas.com E-mail: info@rbkansas.com

# C2.1