

BENCHMARK:
 □ Top of curb, north
 return, Northwest corner of
 43rd and Hydraulic.
 Elev. = 82.33

Small Railroad Spike in West
 face of Power Pole, East of
 44th and Hydraulic.
 Elev. = 82.84

Railroad Spike in Light Pole,
 Southwest corner of 45th and
 Victoria.
 Elev. = 84.74

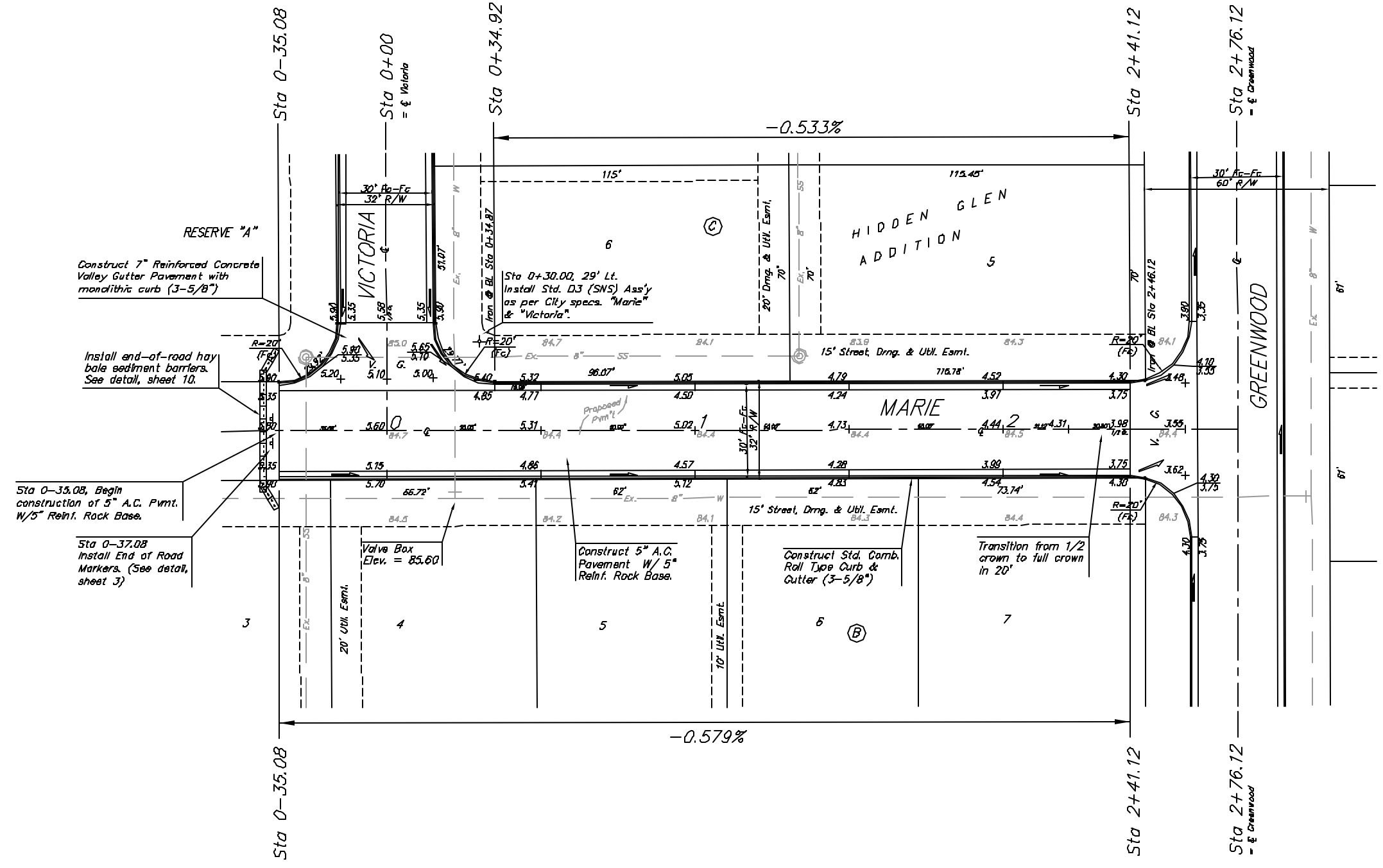
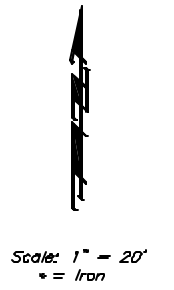

Subdivision Bench Marks

Street & Station	Location Description	Elevation
Greenwood 1+00.98, 15.25' RI.	Adjacent to Fire Hydrant between Lots 1-2, Block A	
Greenwood 5+85.44, 15.25' RI.	Adjacent to Fire Hydrant at S. End of E. Curb Return of Greenwood and 44th St. S.	
Victoria 3+83.49, 15.25' RI.	Adjacent to Fire Hydrant at S. End of E. Curb Return of Victoria and 44th St. S.	

Contact Mike Tallman with the City of Wichita Engineering
 Department and request street numbers prior to installation
 of Street Name Signs.

NOTE: ROLL TYPE CURB & GUTTER TO
 BE CONSTRUCTED ON THE
 PAVEMENT SHOWN ON THIS SHEET.
 TOP OF CURB ELEVATIONS ARE
 GIVEN FOR FULL HEIGHT CURB.

Baughman		HIDDEN GLEN ADDITION	
472-83625		Marie Street Paving	
PROJECT NO.	DATE	DESIGNER	DATE
472-83625	07/04	MAS	07/04
REVISION	BY	DATE	
	Noted		
	MSR		
		8 of 19	