

BENCHMARKS:

"□" Cut in Headwall east side of driveway South R/W Maple, 245' West of centerline of City View. Elev. = 201.41 (City Datum)

"□" Cut center of north Headwall of RCBC in N. R/W of Maple 570' East of centerline of City View. Elev. = 187.91 (City Datum)

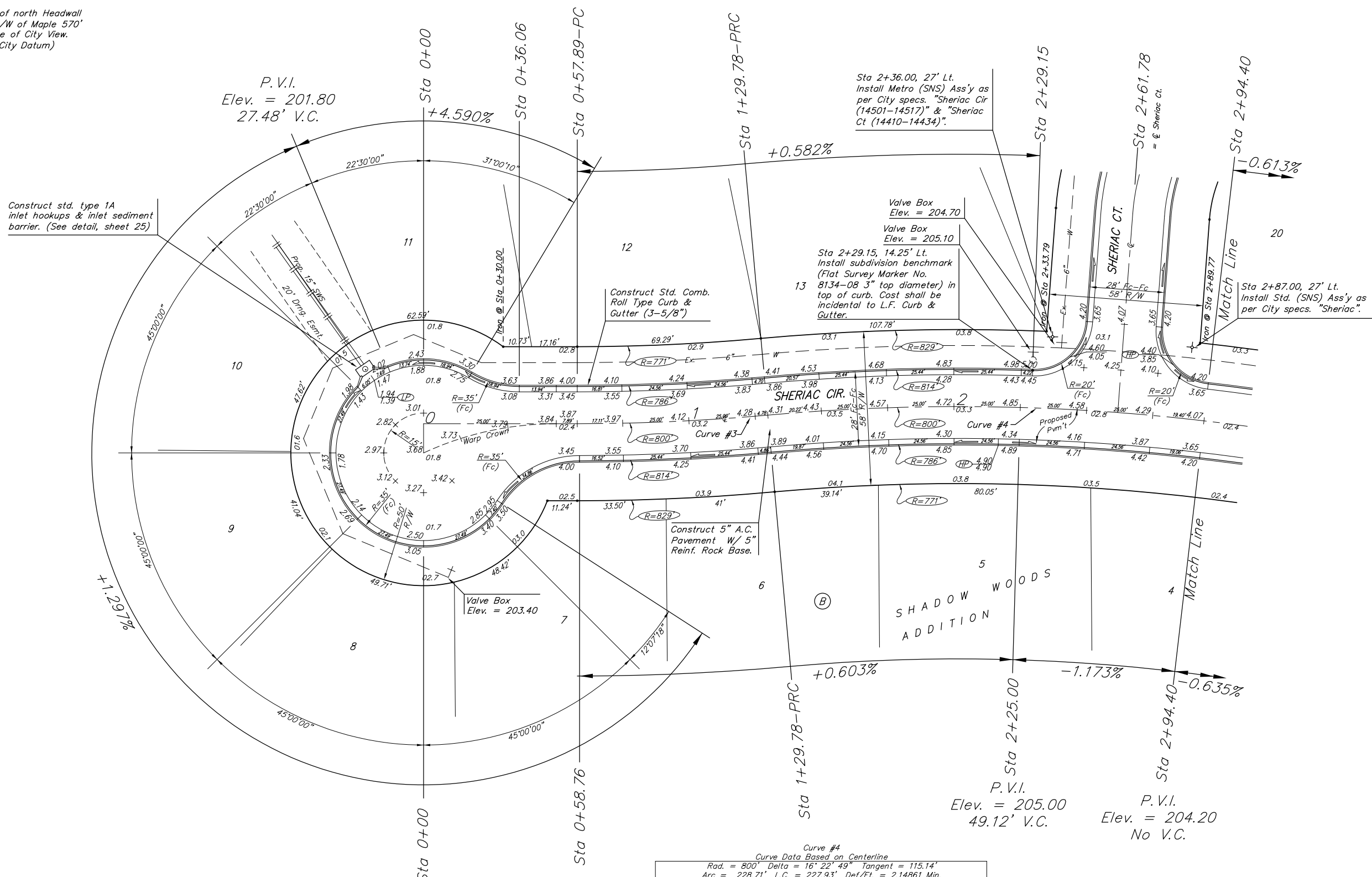
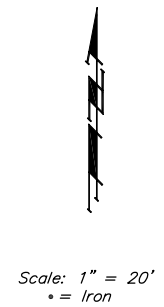

Curve #3
Curve Data Based on Centerline
Rad. = 800' Delta = 50° 56' Tangent = 35.97'
Arc = 71.89' L.C. = 71.87' Def/Ft. = 2.14865 Min.

Station	Arc	FACE CHORD LENGTHS		Defl.	T. Defl.
		8' Lt.	8' Rt.		
0+57.89	-	-	-	0°00'00"	0°00'00"
0+75.00	17.11'	16.64'	17.58'	0°36'46"	0°36'46"
1+00.00	25.00'	24.31'	25.69'	0°53'43"	1°30'29"
1+25.00	25.00'	24.31'	25.69'	0°53'43"	2°24'12"
1+29.78	4.78'	4.65'	4.91'	0°10'16"	2°34'28"

Curve #4
Curve Data Based on Centerline
Rad. = 800' Delta = 16° 22' 49" Tangent = 115.14'
Arc = 228.71' L.C. = 227.93' Def/Ft. = 2.14861 Min.

Station	Arc	FACE CHORD LENGTHS		Defl.	T. Defl.
		8' Lt.	8' Rt.		
1+29.78	-	-	-	0°00'00"	0°00'00"
1+50.00	20.22'	20.78'	19.66'	0°43'26"	0°43'26"
1+75.00	25.00'	25.69'	24.31'	0°53'43"	1°37'09"
2+00.00	25.00'	25.69'	24.31'	0°53'43"	2°30'52"
2+25.00	25.00'	25.69'	24.31'	0°53'43"	3°24'35"
2+29.15	4.15'	4.26'	4.04'	0°08'55"	3°33'30"
2+61.78	32.63'	33.63'	31.73'	1°10'06"	4°43'37"
2+94.40	32.62'	33.51'	31.72'	1°10'05"	5°53'42"
3+00.00	5.60'	5.75'	5.45'	0°12'02"	6°05'44"
3+25.00	25.00'	25.69'	24.31'	0°53'43"	6°59'27"
3+50.00	25.00'	25.69'	24.31'	0°53'43"	7°53'10"
3+58.49	8.49'	8.72'	8.26'	0°18'14"	8°11'24"

NOTE: ROLL TYPE CURB & GUTTER TO BE CONSTRUCTED ON THE PAVEMENT SHOWN ON THIS SHEET. TOP OF CURB ELEVATIONS ARE GIVEN FOR FULL HEIGHT CURB.

Baughman
ENGINEERING | SURVEYING | PLANNING | LANDSCAPE ARCHITECTURE

SHADOW WOODS ADD. - PH IV
SHERIAC CIR.
STA 0+00 TO STA 2+94.40

<p>PROJECT NUMBER 472-83759</p> <p>REVISIONS:</p>	<p>DESIGN DRAWN TMS</p> <p>APPROVED DATE 07/04</p> <p>SCALE Noted</p> <p>SHEET 8 OF 32</p>
---	---

ShadowWoods/Str2 04-04-E873