

**BENCHMARK:**

#1. "X" Cut in Sidewalk 519.7 ft. East & 34.0 ft. South of SW Cor. SE 1/4, Sec. 28, Twp. 27-S, R-2, E. Elevation = 154.50 City Datum (1341.90 NGVD29)

#2. "X" Cut in Sidewalk 536.4 ft. East of Smithmoor & 45.6 ft. South of Harry St. Elevation = 155.14 City Datum (1342.54 NGVD29)

P.V.I. Elev. = 157.50  
30' V.C.

**CRYSTAL CREEK ADDITION**

Street & Station	Location Description	Elevation
Shiloh 2+25.00, 17.25' Lt.	Adjacent to Fire Hydrant between Lots 2 & 3, Block A, Crystal Creek Addition	
Shiloh Ct. 0+35.18, 15.25' Rt.	Adjacent to Fire Hydrant near northwest curb return of Shiloh & Shiloh Ct.	
Shiloh Ct. 6+31.00, 15.25' Rt.	Adjacent to Fire Hydrant between Lots 20 & 21, Block A, Crystal Creek Addition	
Boston 8+85.50, 17.25' Lt.	Adjacent to Fire Hydrant between Lots 13 & 14, Block C, Crystal Creek Addition	
Zimmerly 17+03.12, 17.25' Lt.	Adjacent to Fire Hydrant near southeast curb return of Shiloh & Zimmerly	
Boston Ct. 0+37.21, 14.25' Rt.	Adjacent to Fire Hydrant near southeast curb return of Boston & Boston Ct.	

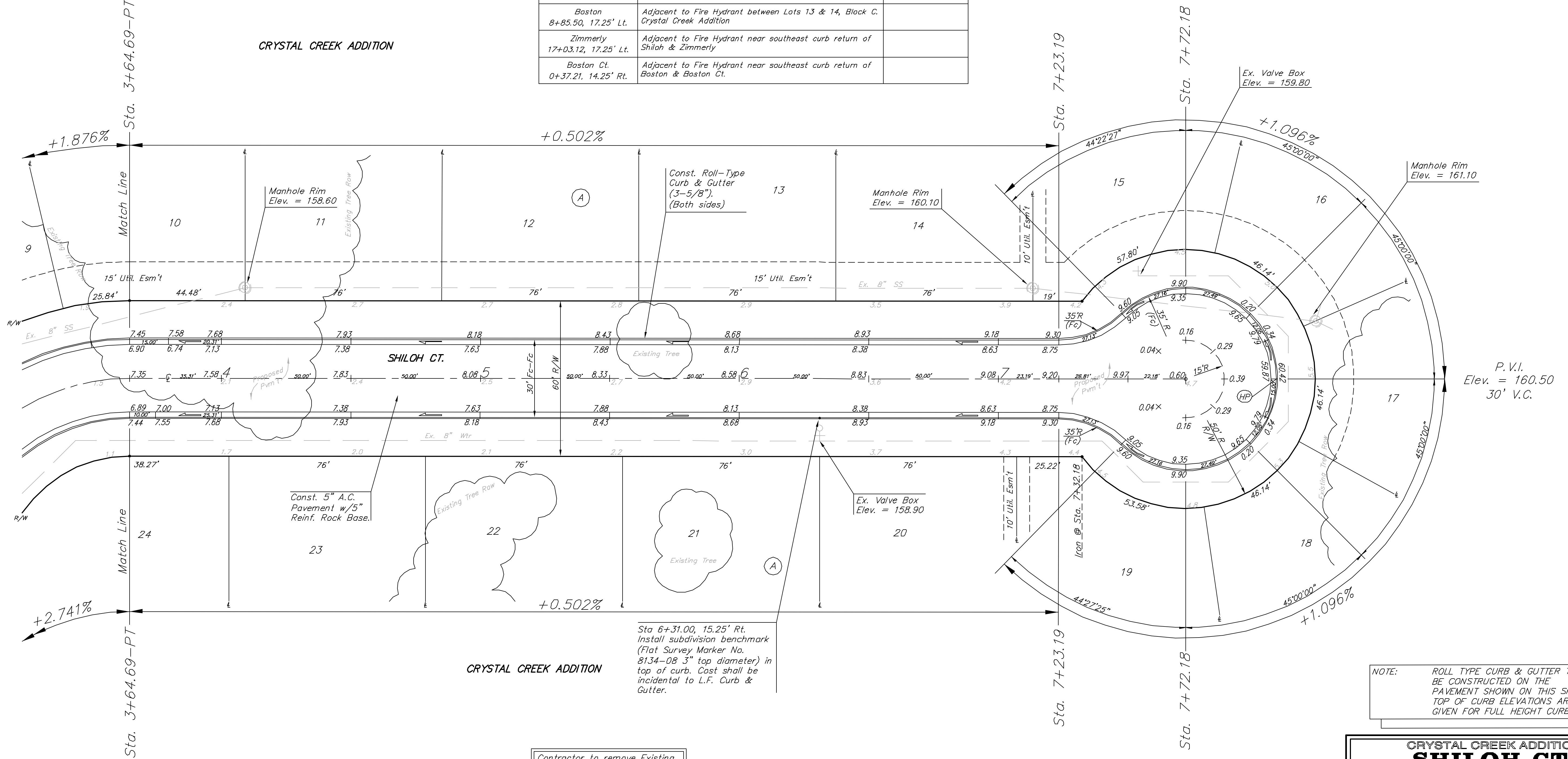
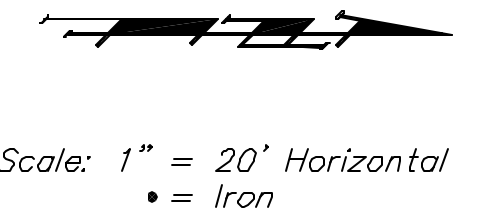

P.V.I. Elev. = 160.50  
30' V.C.

**CRYSTAL CREEK ADDITION**

Sta 6+31.00, 15.25' Rt. Install subdivision benchmark (Flat Survey Marker No. 8134-08 3" top diameter) in top of curb. Cost shall be incidental to "Site Clearing & Restoration."

Contractor to remove Existing Trees as necessary for project construction. Cost to be incidental to "Site Clearing & Restoration."

NOTE: ROLL TYPE CURB & GUTTER TO BE CONSTRUCTED ON THE PAVEMENT SHOWN ON THIS SHEET. TOP OF CURB ELEVATIONS ARE GIVEN FOR FULL HEIGHT CURB.

**CRYSTAL CREEK ADDITION**  
**SHILOH CT.**  
STA. 3+64.69 TO STA. 7+72.18

**BAUGHMAN COMPANY P.A.**  
ENGINEERING, SURVEYING, & PLANNING  
316-262-7271 • 315 ELLIS • WICHITA, KANSAS 67211

PROJECT NUMBER: **472-83818** SHEET OF **12**

DESIGN: NBW	DRAWN: GNX	APPROVED:	DATE: 1/04	SCALE: NOTED
-------------	------------	-----------	------------	--------------

CrystalCreek 15175 03-07-1624