

BENCHMARK:

- #1. "X" Cut in Sidewalk 519.7 ft. East & 34.0 ft. South of SW Cor. SE 1/4, Sec. 28, Twp. 27-5, R-2, E. Elevation = 154.50 City Datum (1341.90 NGVD29)
- #2. "X" Cut in Sidewalk 536.4 ft. East C of Smithmoor & 45.6 ft. South C of Harry St. Elevation = 155.14 City Datum (1342.54 NGVD29)

Scale: 1" = 20' Horizontal
• = Iron

CRYSTAL CREEK ADDITION

Curve #9
Curve Data Based on Centerline
Rad. = 100' Delta = 84° 24' 14" Tangent = 90.68'
Arc = 147.31' L.C. = 134.35' Del/Ft. = 17.18904 Min.

Station	Arc	FACE CHORD LENGTHS		Defl	T. Defl.
		B' Lt.	B' Rt.		
5+07.05	-	-	-	0'00"00"	0'00"00"
5+25.00	17.95'	13.44'	22.41'	5'08"32"	5'08"32"
5+50.00	25.00'	18.70'	31.17'	7'09"44"	12'18"16"
5+75.00	25.00'	18.70'	31.17'	7'09"43"	19'27"59"
6+00.00	25.00'	18.70'	31.17'	7'09"44"	26'37"43"
6+25.00	25.00'	18.70'	31.17'	7'09"43"	33'47"26"
6+50.00	25.00'	18.70'	31.17'	7'09"44"	40'57"10"
6+54.36	4.36'	3.27'	5.45'	1'14"57"	42'12"07"

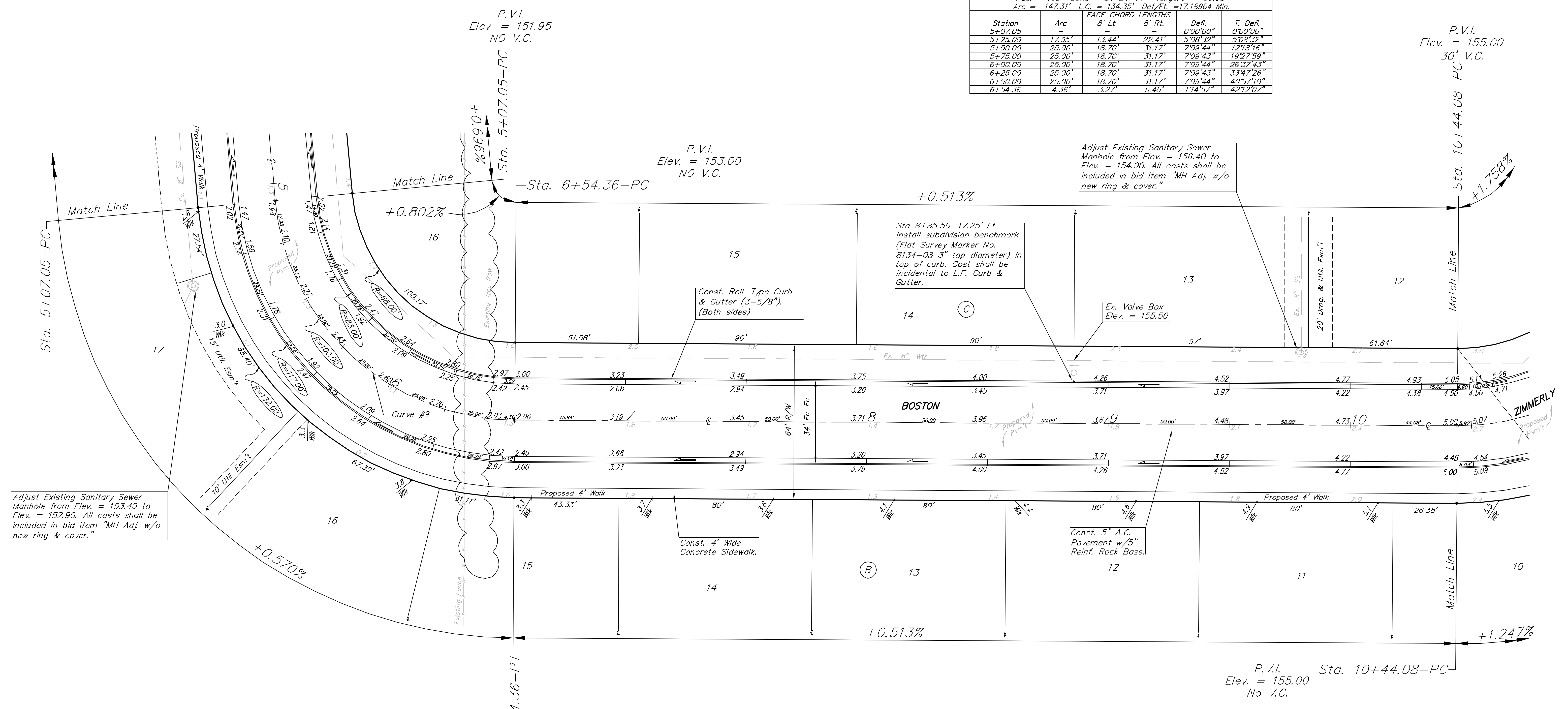

Adjust Existing Sanitary Sewer Manhole from Elev. = 152.90 to Elev. = 153.40 to Elev. = 152.90. All costs shall be included in bid item "MH Adj. w/o new ring & cover."

Adjust Existing Sanitary Sewer Manhole from Elev. = 156.40 to Elev. = 154.90. All costs shall be included in bid item "MH Adj. w/o new ring & cover."

Contractor to remove Existing Trees as necessary for project construction. Cost to be incidental to "Site Clearing & Restoration."

NOTE: ROLL TYPE CURB & GUTTER TO BE CONSTRUCTED ON THE PAVEMENT SHOWN ON THIS SHEET. TOP OF CURB ELEVATIONS ARE GIVEN FOR FULL HEIGHT CURB.

CRYSTAL CREEK ADDITION

CRYSTAL CREEK ADDITION
BOSTON
STA. 5+07.05 TO STA. 10+44.08

BAUGHMAN COMPANY P.A.
ENGINEERING, SURVEYING, & PLANNING
316-262-7271 • 318 ELLIS • WICHITA, KANSAS 67211

PROJECT NUMBER: **472-83818**

DESIGN: NBW DRAWN: GNX APPROVED: [Signature] DATE: 1/04 SCALE: NOTED

SHEET **14** OF **57**

Crystalcreek Str. 03-07-EB24