

BENCHMARK:

- #1. "X" Cut in Sidewalk 519.7 ft. East & 34.0 ft. South of SW Cor. SE 1/4, Sec. 28, Twp. 27-S, R-2, E. Elevation = 154.50 City Datum (1341.90 NGVD29)
- #2. "X" Cut in Sidewalk 536.4 ft. East & 45.6 ft. South of Smithmoop & 1/4 of Harry St. Elevation = 155.74 City Datum (1342.74 NGVD29)

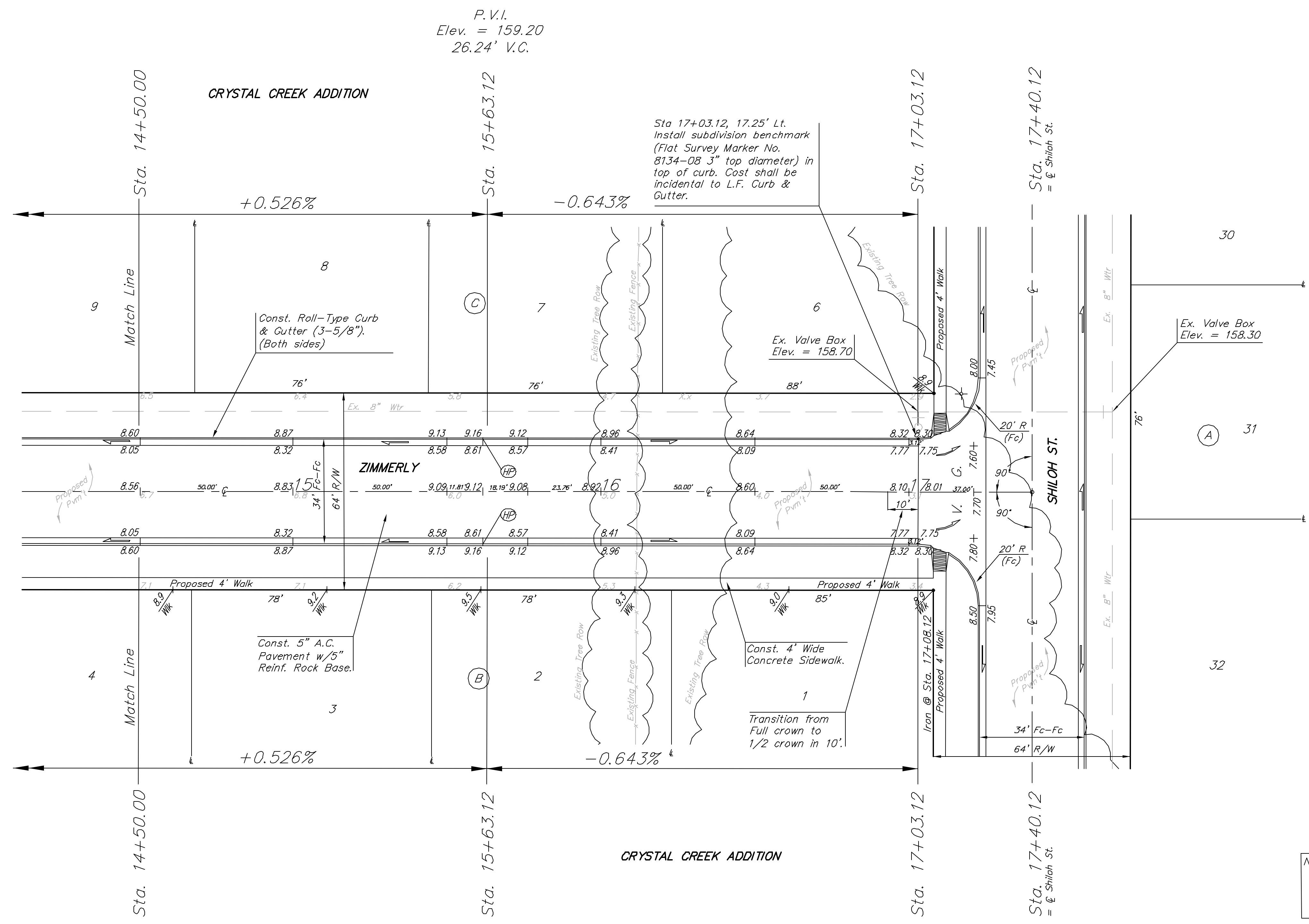
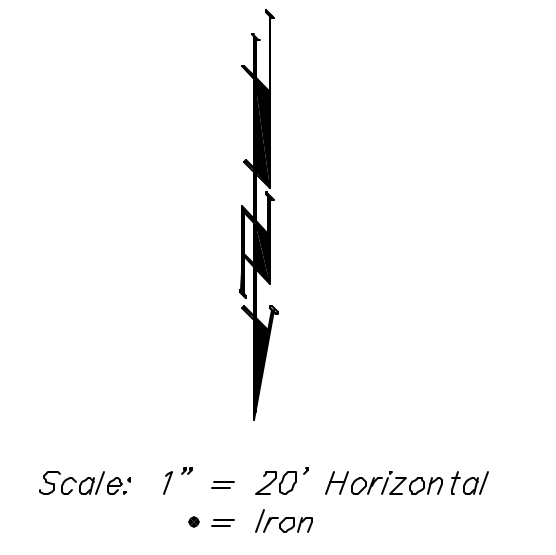

P.V.I.
Elev. = 159.20
26.24' V.C.

P.V.I.
Elev. = 159.20
26.24' V.C.

Contractor to remove Existing Trees & Fence as necessary for project construction. Cost to be incidental to "Site Clearing & Restoration."

NOTE: ROLL TYPE CURB & GUTTER TO BE CONSTRUCTED ON THE PAVEMENT SHOWN ON THIS SHEET. TOP OF CURB ELEVATIONS ARE GIVEN FOR FULL HEIGHT CURB.

CRYSTAL CREEK ADDITION
ZIMMERLY
STA. 14+50.00 TO STA. 17+03.12

BAUGHMAN COMPANY P.A.
ENGINEERING, SURVEYING, & PLANNING
316-262-7271 • 315 ELLIS • WICHITA, KANSAS 67211

PROJECT NUMBER 472-83818		SHEET 16	
DESIGN NEW	DRAWN GNX	APPROVED	DATE 1/04
		SCALE NOTED	
		OF 57	

CrystalCreek STP 02-07-EG24