

LEGEND

- | | | | |
|----|--|------|---------------------------------------|
| KV | LIGHT POLE AND FIXTURE TYPE (REF: SITE PLAN FOR DETAILS) | IRR | IRRIGATION WATER LINE |
| FV | FLOOD LIGHT | UGE | POWER UNDERGROUND BY CONTRACTOR |
| + | 3 WAY FIRE HYDRANT | UGT | TELEPHONE UNDERGROUND (PER CITY STDS) |
| + | W.L. TEE | G | GAS LINE |
| + | W.L. GATE VALVE (G.V.) | CATV | CABLE TV |
| + | W.L. BENDS | U/E | UTILITY EASEMENT |
| + | STORM SEWER INLET | SS | SANITARY SEWER |
| + | STORM SEWER CURB INLET | W.L. | WATER LINE |
| + | STORM SEWER MANHOLE (SSMH) | DS | DOWNSPOUT |
| | | PP | POWER POLE |
| | | M&M | MEET & MATCH |
| | | TP | TOP OF PAVEMENT |
| | | TC | TOP OF CURB |

CAUTION - NOTICE TO CONTRACTOR
 THE CONTRACTOR IS SPECIFICALLY CAUTIONED THAT THE LOCATION AND/OR ELEVATION OF EXISTING UTILITIES AS SHOWN ON THESE PLANS IS BASED ON RECORDS OF THE VARIOUS UTILITY COMPANIES AND, WHERE POSSIBLE, MEASUREMENTS TAKEN IN THE FIELD. THE INFORMATION IS NOT TO BE RELIED ON AS BEING EXACT OR COMPLETE. THE CONTRACTOR MUST CALL THE APPROPRIATE UTILITY COMPANY AT LEAST 48 HOURS BEFORE ANY EXCAVATION TO REQUEST EXACT FIELD LOCATION OF UTILITIES. IT SHALL BE THE RESPONSIBILITY OF THE CONTRACTOR TO RELOCATE ALL EXISTING UTILITIES WHICH CONFLICT WITH THE PROPOSED IMPROVEMENTS SHOWN ON THE PLANS.

NOTE: THE GENERAL CONTRACTOR IS RESPONSIBLE FOR MAKING ALL ADJUSTMENTS OF EXISTING UTILITIES TO ALLOW THE DESIGN TO BE BUILT.

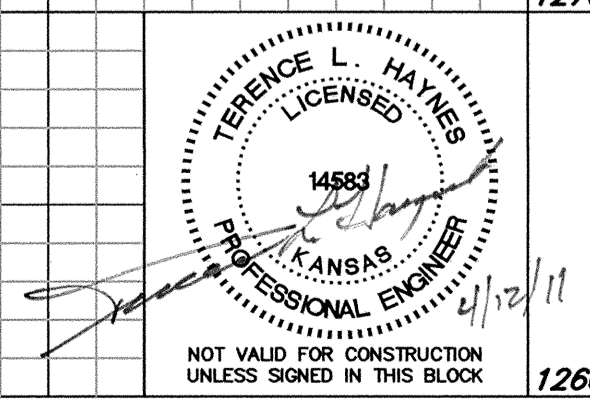
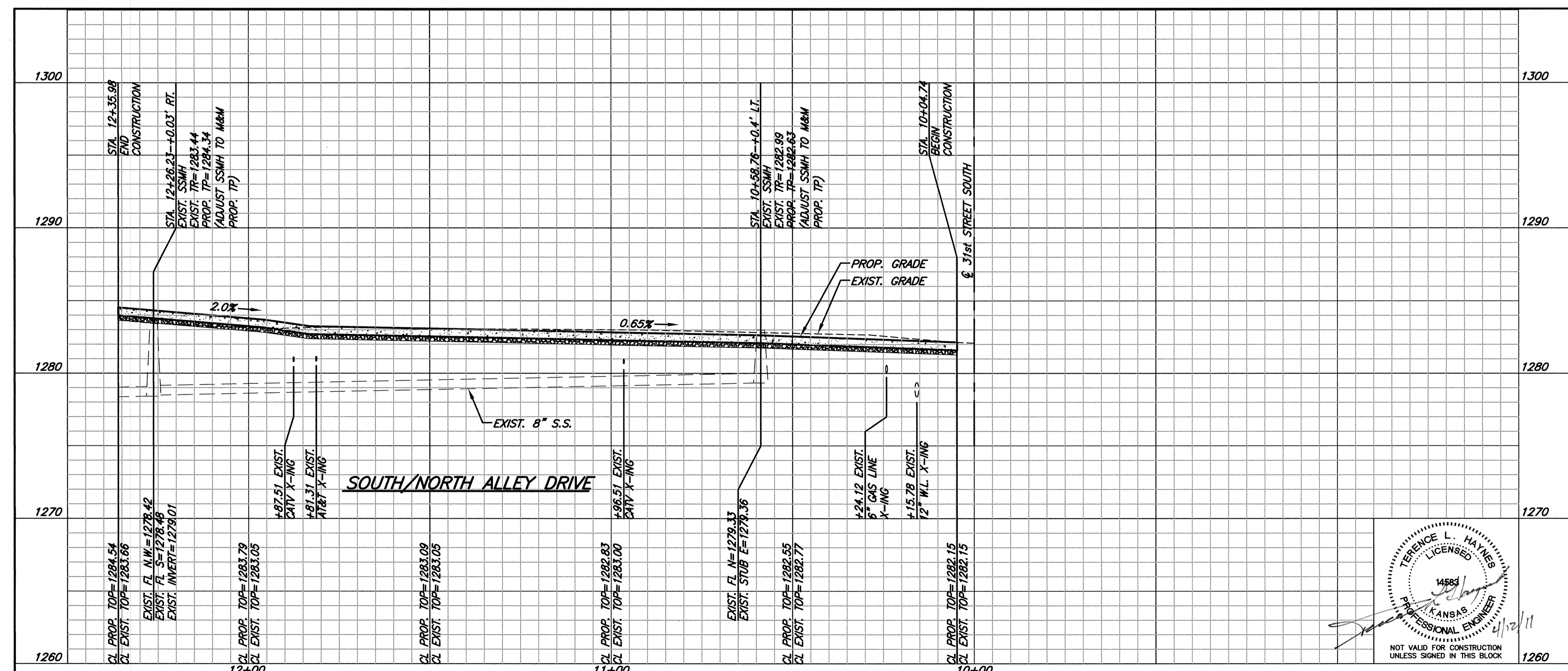
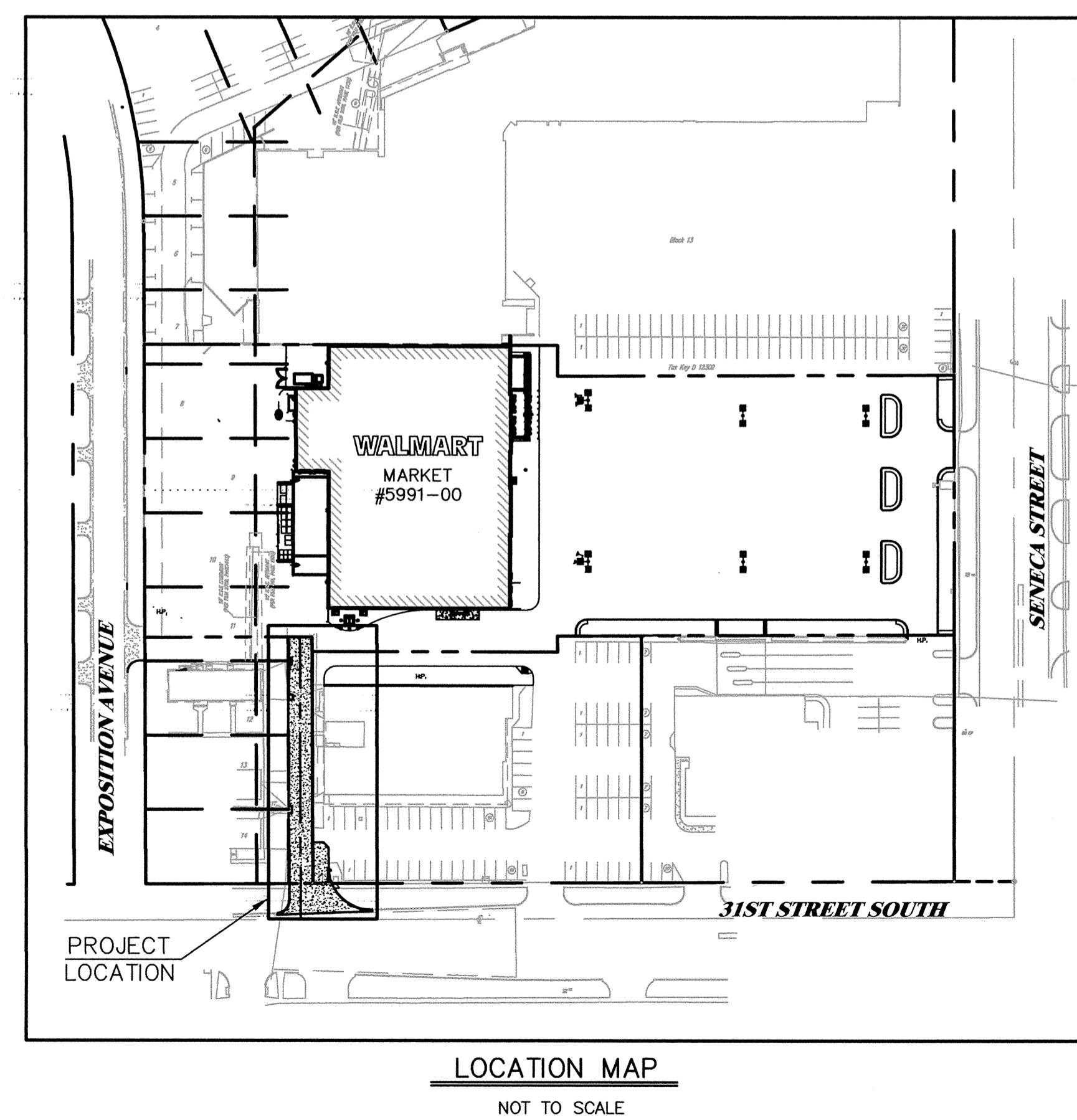

C:\48861\Alley Drive Plans\48861.dwg Apr. 13, 2011 - 9:10am mikemth