



STREET IMPROVEMENTS FOR
135th Street West
from 13th Street to 21st Street North

TRAFFIC CONTROL PLAN
PHASE 2A
SHEET TITLE
MKEC PROJ #10265
PROJECT NUMBER

JRA
DESIGN BY
WNU
DRAWN BY
JRA
CHECKED BY

ISSUED
February 2012
REVISED

SHEET NO.
153 of 231

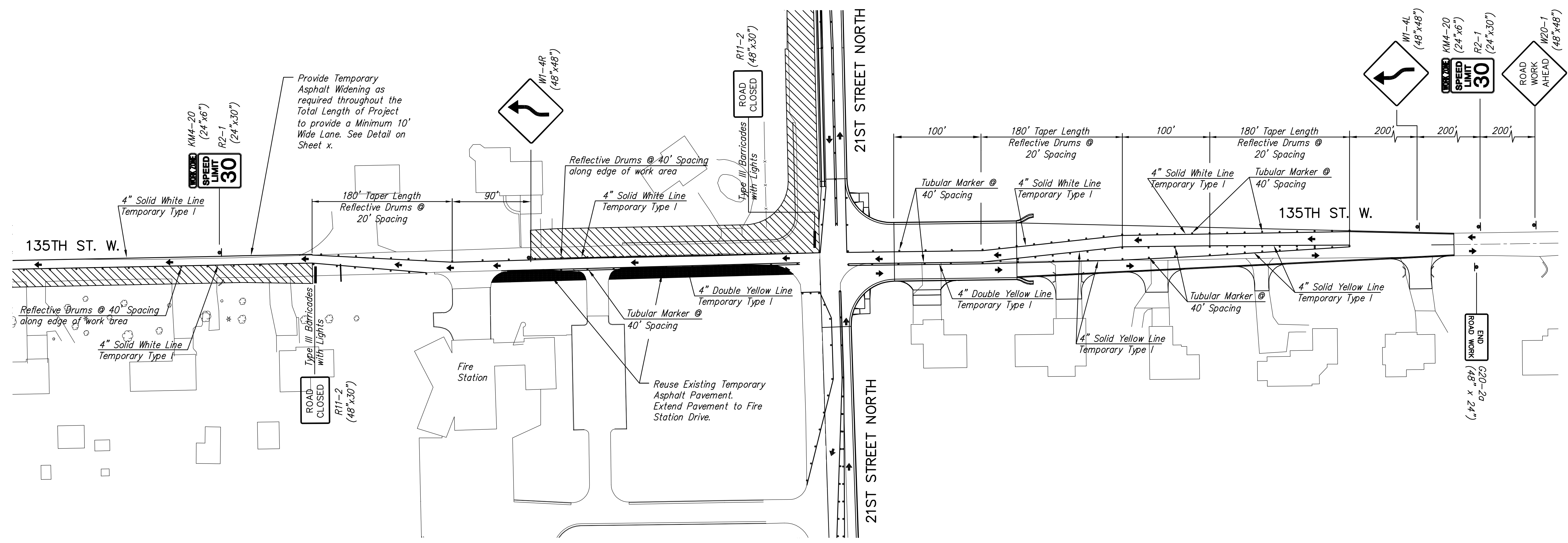
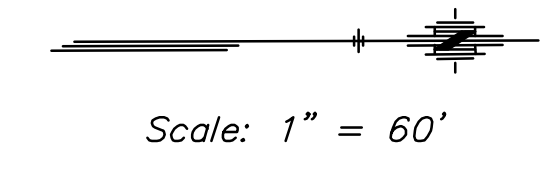

Provide Temporary Asphalt Widening as required throughout the Total Length of Project to provide a Minimum 10' Wide Lane. See Detail on Sheet x.

Reflective Drums @ 40' Spacing along edge of work area

Reuse Existing Temporary Asphalt Pavement. Extend Pavement to Fire Station Drive.

PHASE 2A - 135TH STREET

LEGEND

- Type III Barricades with lights
- Mount On Type III Barricade
- One Post Sign
- Two Post Sign
- Traffic Flow
- Work Space
- Channelizing Device
- Temporary Asphalt Pavement