

**STREET IMPROVEMENTS FOR
135th Street West
from 13th Street to 21st Street North**

**ASPHALT DRIVE
ENTRANCE
LAYOUT**
SHEET TITLE
MKEC PROJ #10265
PROJECT NUMBER

DETAILS
DESIGN BY
DPG
DRAWN BY
JRA
CHECKED BY

ISSUED
February 2012
REVISED

SHEET NO.
63 of 231

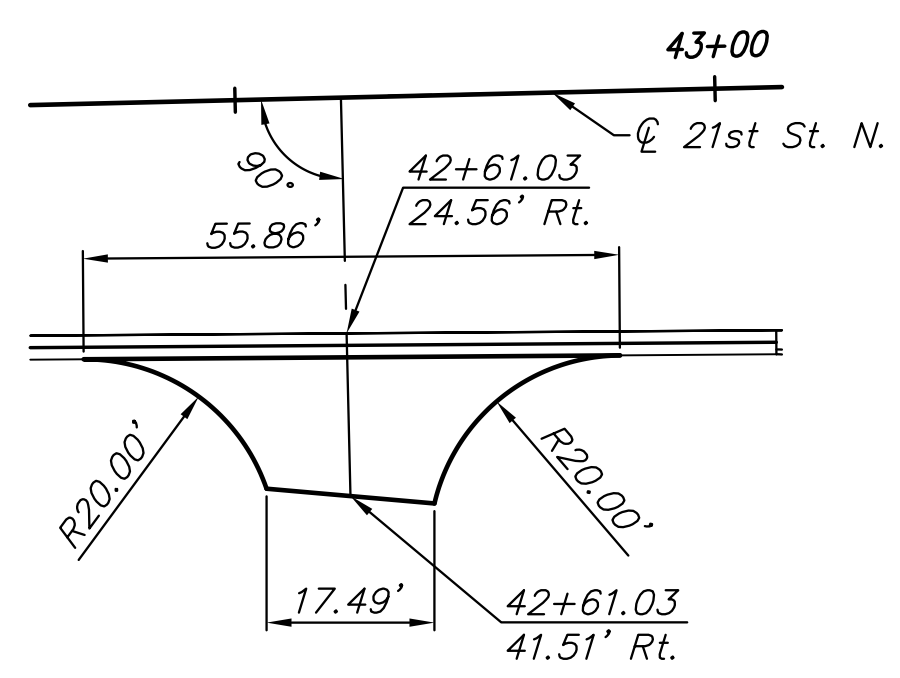

21ST STREET ENTRANCE PLAN
Sta. 42+61.03, Rt.

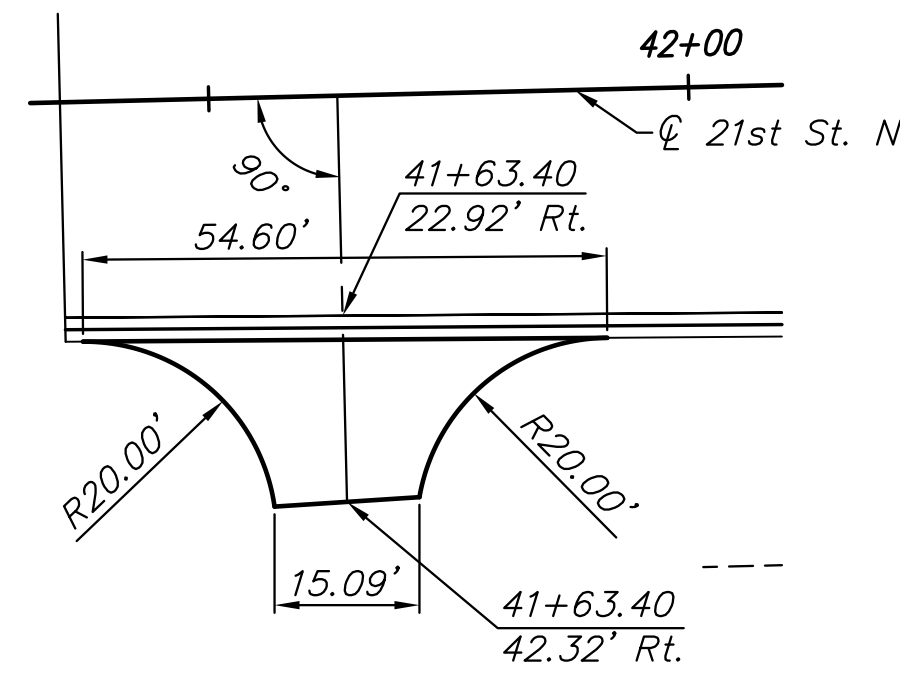

21ST STREET ENTRANCE PLAN
Sta. 41+63.40, Rt.

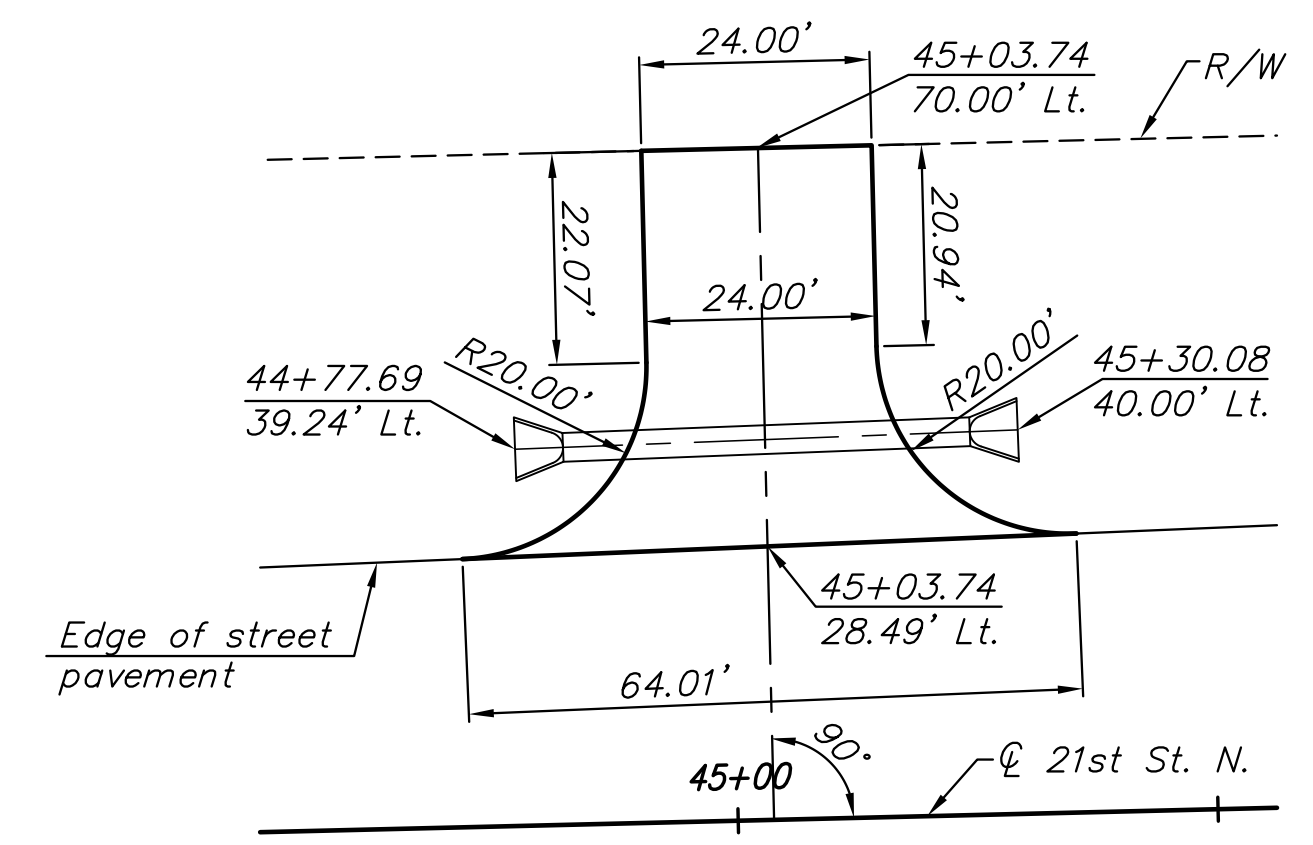

21ST STREET ENTRANCE PLAN
Sta. 45+03.74, Lt.

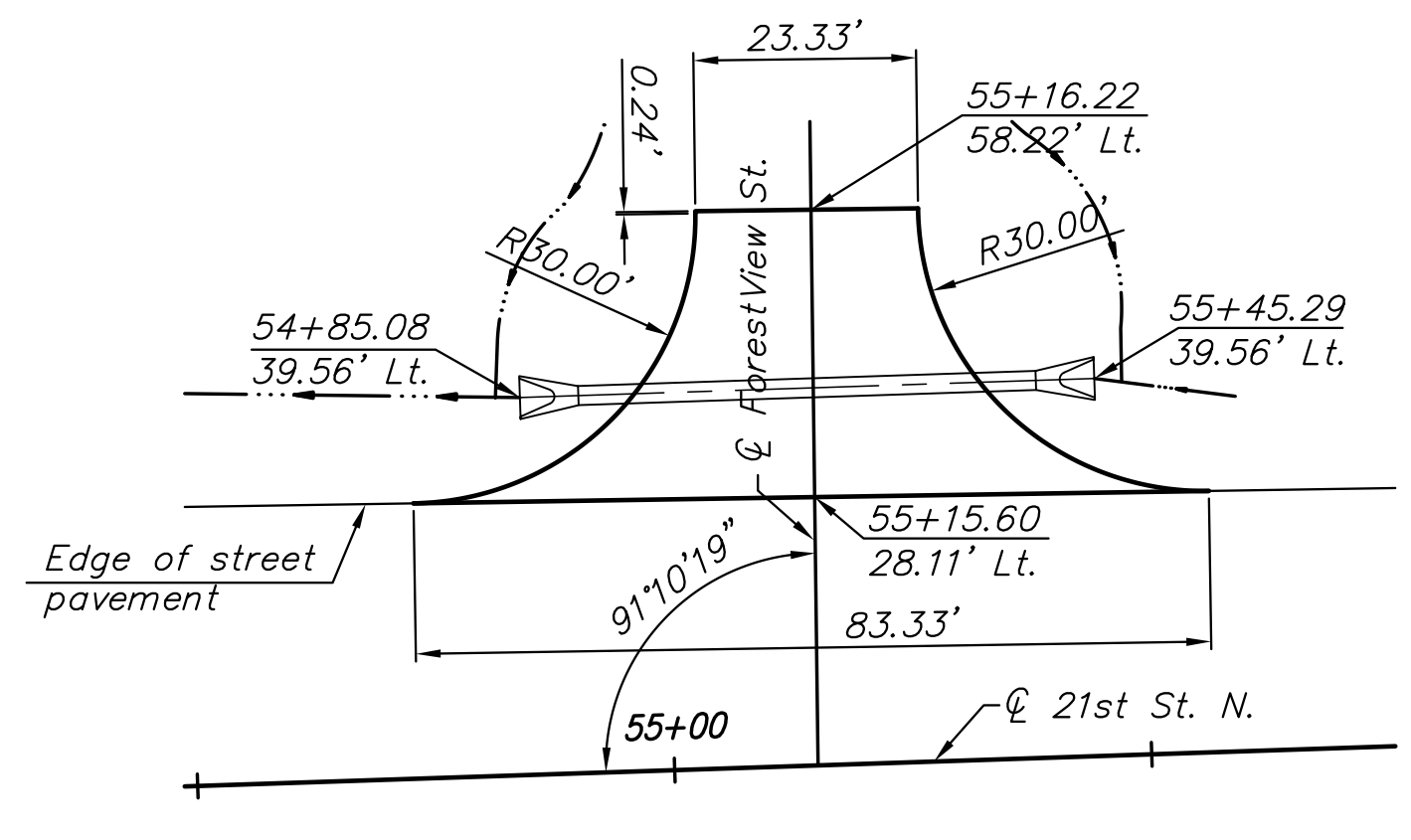

21ST STREET @ FOREST VIEW ST. PLAN
Sta. 55+15.60, Lt.

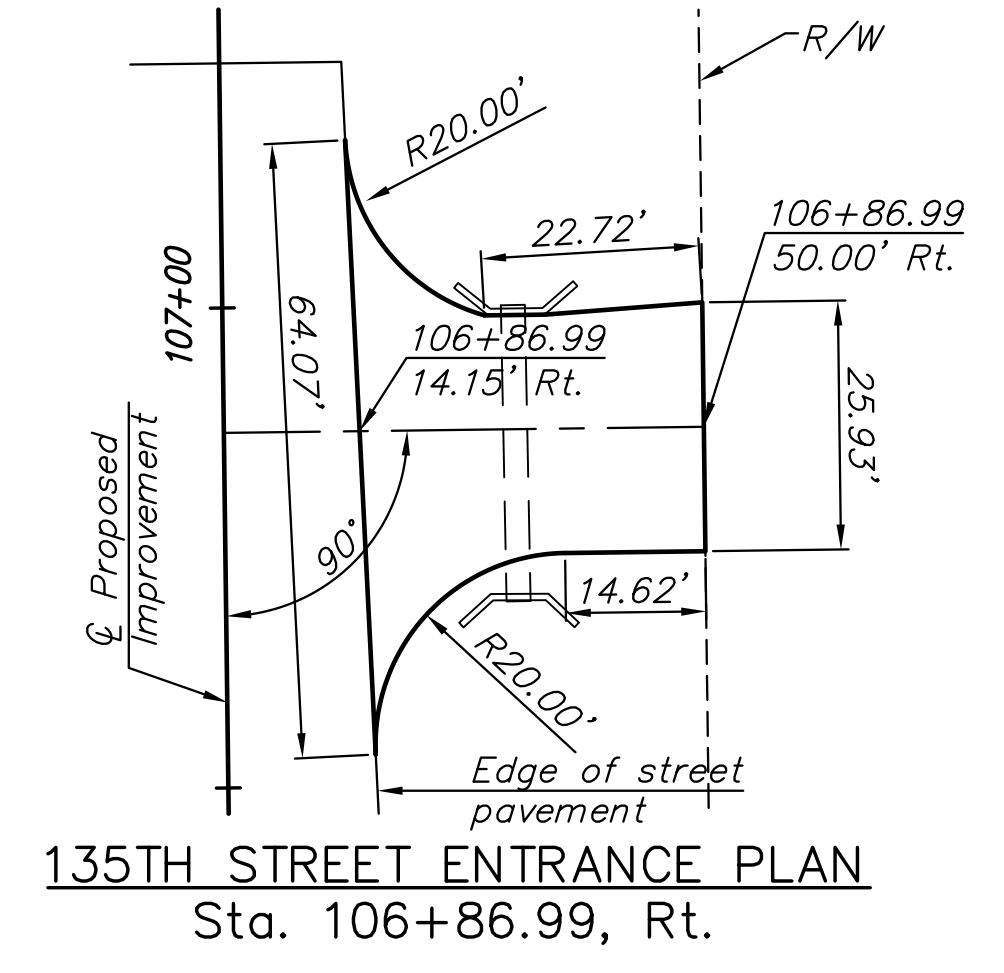

135TH STREET ENTRANCE PLAN
Sta. 106+86.99, Rt.

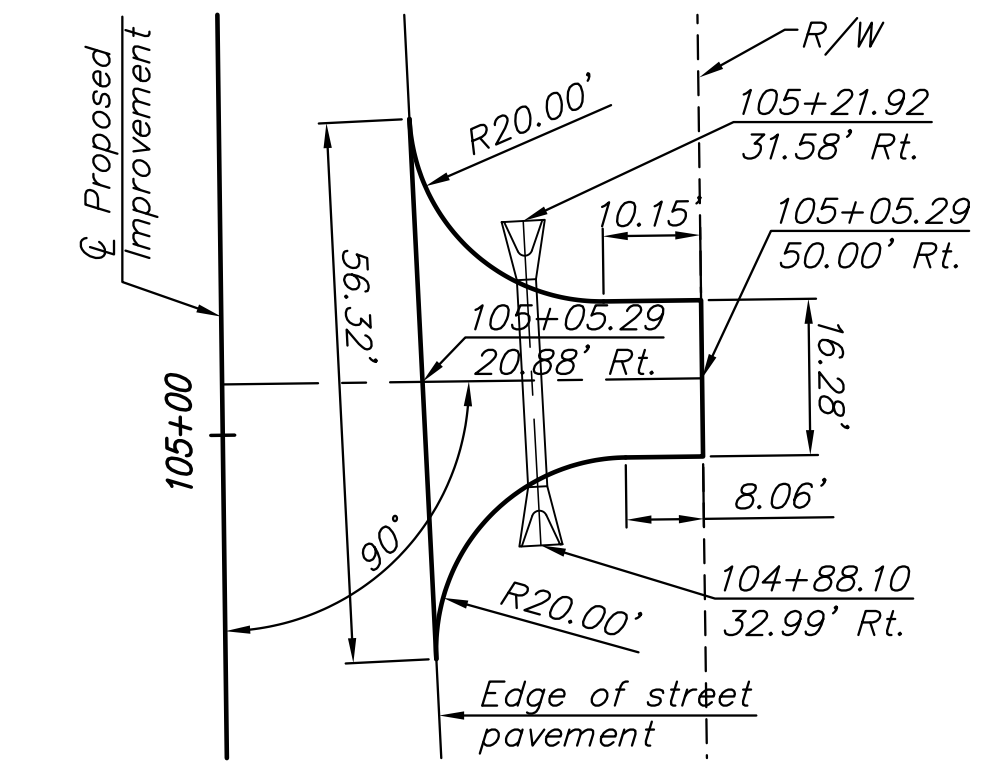

135TH STREET ENTRANCE PLAN
Sta. 105+05.29, Rt.

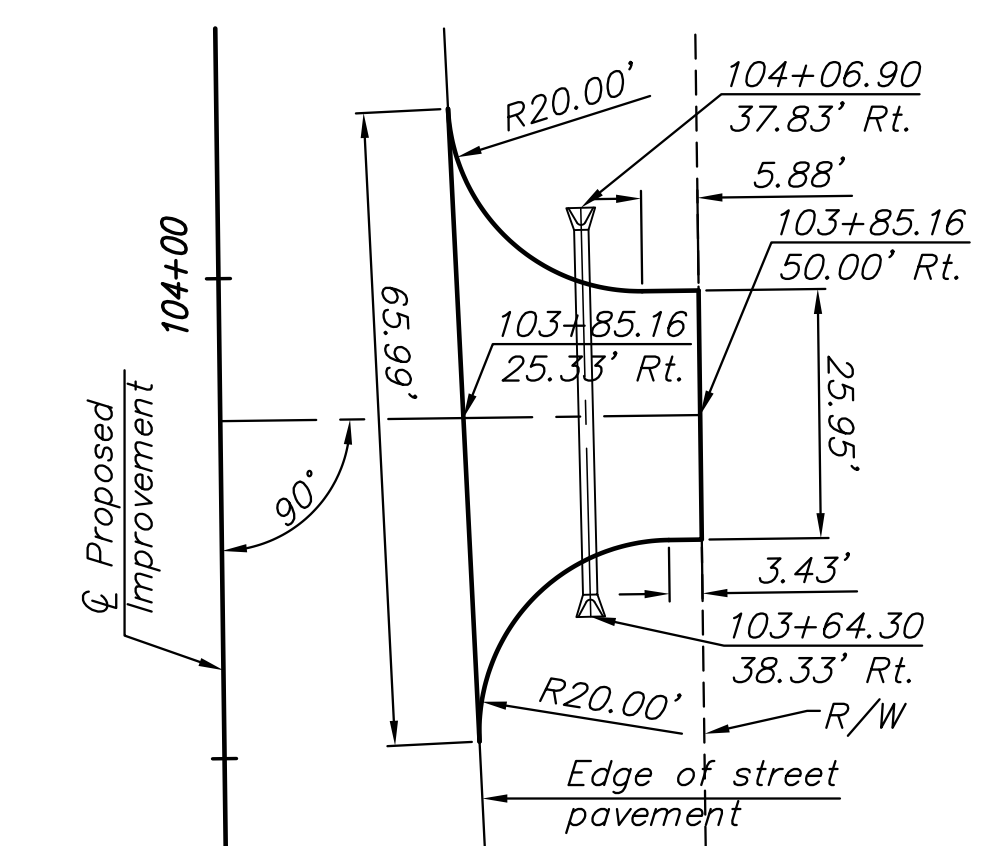

135TH STREET ENTRANCE PLAN
Sta. 103+85.16, Rt.

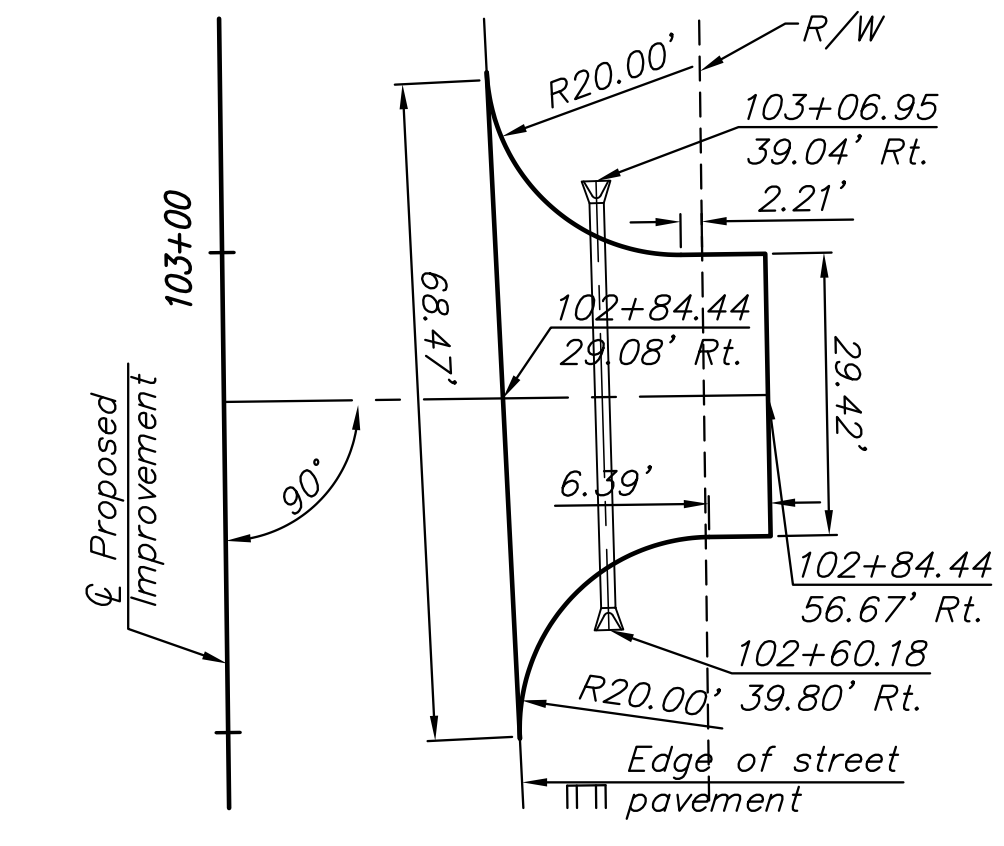

135TH STREET ENTRANCE PLAN
Sta. 102+84.44, Rt.

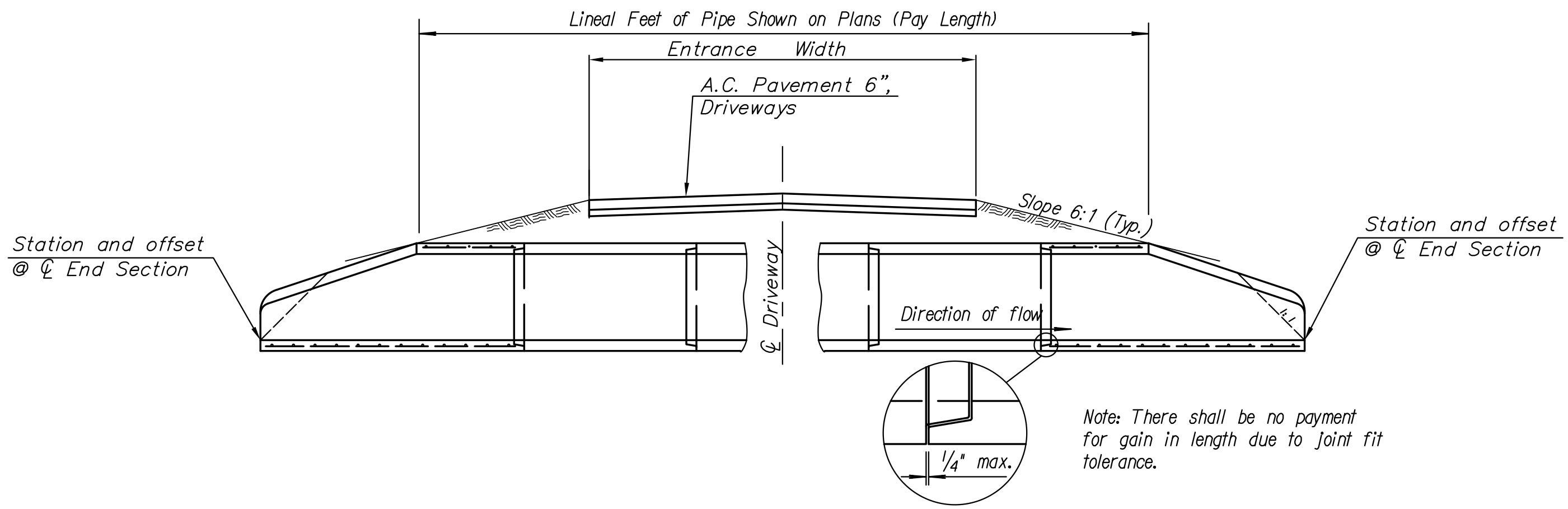

TYPICAL ENTRANCE SECTION WITH CULVERT

ENTRANCE PIPE AND ASPHALT DRIVEWAY APPROACH SUMMARY TABLE												
Driveway Station	Side	Culvert Type	Size or Bid Designation Sq. Ft.	Lin. Ft. of Pipe	# of End Sections	End Section Location (See Detail)						A.C. Pavement 6", Driveways (Sq. Yds.)
						Station	Offset	Flow	Station	Offset	Flow	
135TH ST. WEST												
102+84.44	Rt.	RCP	Pipe, SWS, 18", Entrance	41.61'	2	102+60.18	39.80 R	1352.36	103+06.95	39.04 R	1352.03	109.36
103+85.16	Rt.	RCP	Pipe, SWS, 18", Entrance	37.44'	2	103+64.30	38.33 R	1351.63	104+06.90	37.83 R	1351.33	90.30
105+05.29	Rt.	RCP	Pipe, SWS, 24", Entrance	28.68'	2	104+88.10	32.99 R	1351.19	105+21.92	31.58 R	1351.33	71.81
106+86.99	Rt.	None										120.66
21ST ST. NORTH												
41+63.40	Rt.	None										46.43
42+61.03	Rt.	None										44.25
45+03.74	Lt.	RCP	Pipe, SWS, 36", Entrance	42.40'	2	44+77.69	39.24 L	1355.43	45+30.08	40.00 L	1355.21	129.78
55+15.60	Lt.	RCP	Pipe, SWS, 24", Entrance	50.20'	2	54+85.08	39.56 L	1354.23	55+45.29	39.56 L	1354.42	121.00

See Sh. No. 77 for RCP Details

PLOTTED: Tuesday, February 21, 2012 @ 03:03PM

J:\Civil\10265\DWG\Details\Asphalt Drive DTI