

Sta. 10+00.0
 Exist. MH A (See detail, sheet no. 13)
 Plug and Vent 60" Pipe (N)
 (See detail this sheet)
 Abandon approx. 435.0 L.F. Existing 60" RCP Pipe (N)
 (Maintain Waste Water flows through manhole.)

N: 1,673,389.3880, E: 1,656,394.7809
 Sta. 14+34.3 (approx. 48.9' Lt.)
 Exist. Access MH and Accessway
 (See sheet no. 11, & 13-14 for Existing MH &
 Accessway details)
 Abandon Siphon MH and Accessway
 (Access MH from Swan Avenue)
 (See Abandonment Details, sheet no. 17)

Sta. 14+34.3
 Exist. MH B (See sheet no. 11, & 13-14 for Existing
 MH & Accessway details)
 Plug 30" VCP and 42" RCP (E) (See Sheet no. 14)
 Seal 60" Pipe (S)
 (See Abandonment Details, sheet no. 17)
 Abandon approx. 218.9 L.F. Existing 42" RCP Pipe (NE)
 Abandon approx. 218.9 L.F. Existing 30" VCP Pipe (NE)

Sta. 16+53.2
 Exist. MH C (See sheet no. 11, & 13-14 for Existing MH &
 Accessway details)
 Plug 24" Pipe (E) (See Sheet no. 14)
 Seal 60" Pipe (N)
 Abandon approx. 34.7 L.F. of 24" CIP SS (E)
 Abandon approx. 514.2 L.F. Existing 60" RCP Pipe (N)
 Abandon Siphon MH and Accessway
 (See Abandonment Details, sheet no. 17)

Sta. 21+67.4
 Exist. MH D (See Typical MH Section, sheet 12)
 Seal 60" opening (N&S)
 Abandon approx. 562.1 L.F. Existing 60" RCP Pipe (N)
 Abandon MH and Accessway
 (See Abandonment Details, sheet no. 17)

Sta. 14+00.9
 Abandon Existing Siphon MH

N: 1,673,566.6623, E: 1,656,627.3648
 Exist. Access MH
 (See sheet no. 11, & 13-14 for Existing MH &
 Accessway details)

N: 1,673,563.7119, E: 1,656,635.4782
 Existing MH Removed and
 Plug Installed with Vent Pipe in Phase 2
 Existing 24" Sanitary Sewer (W).

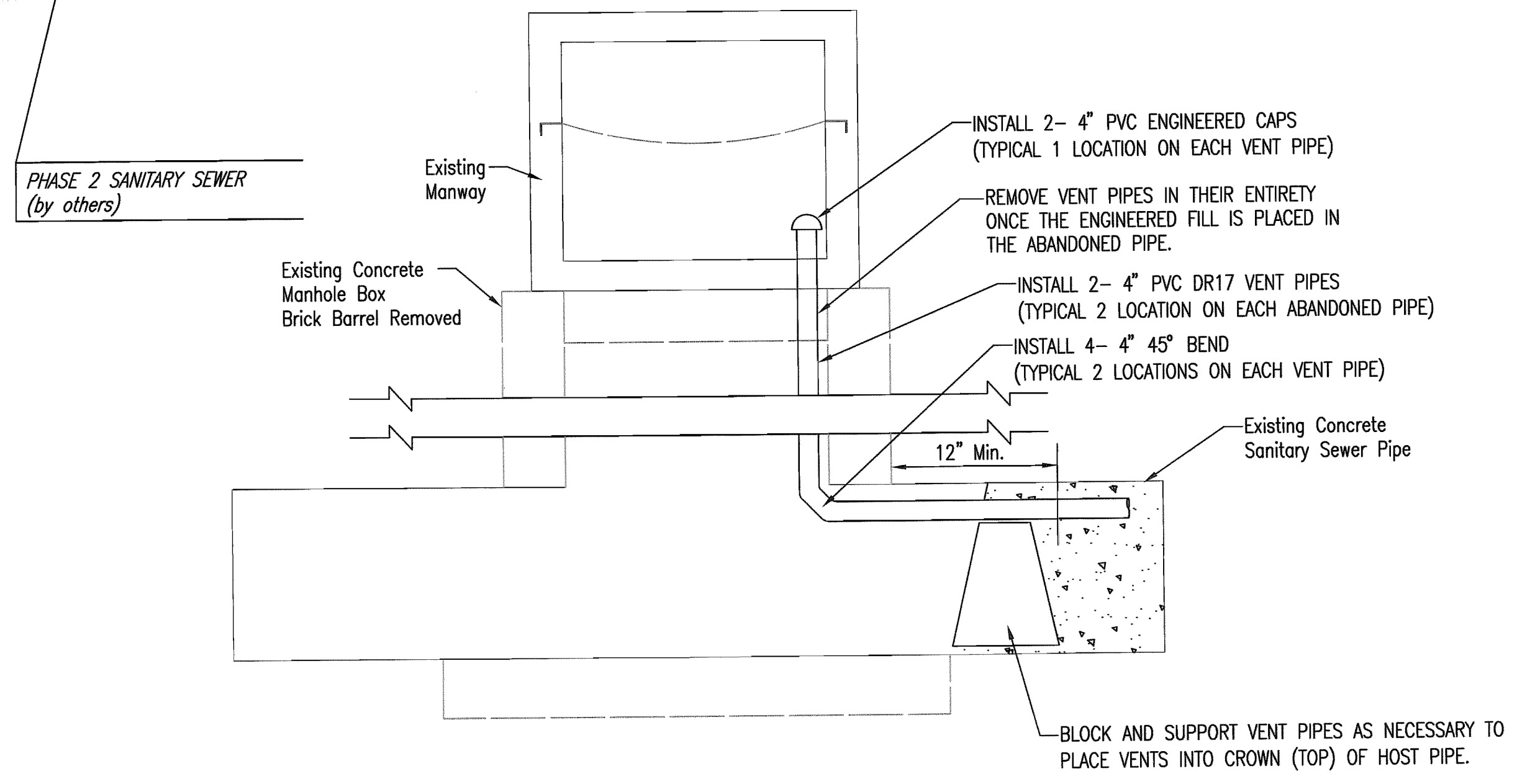
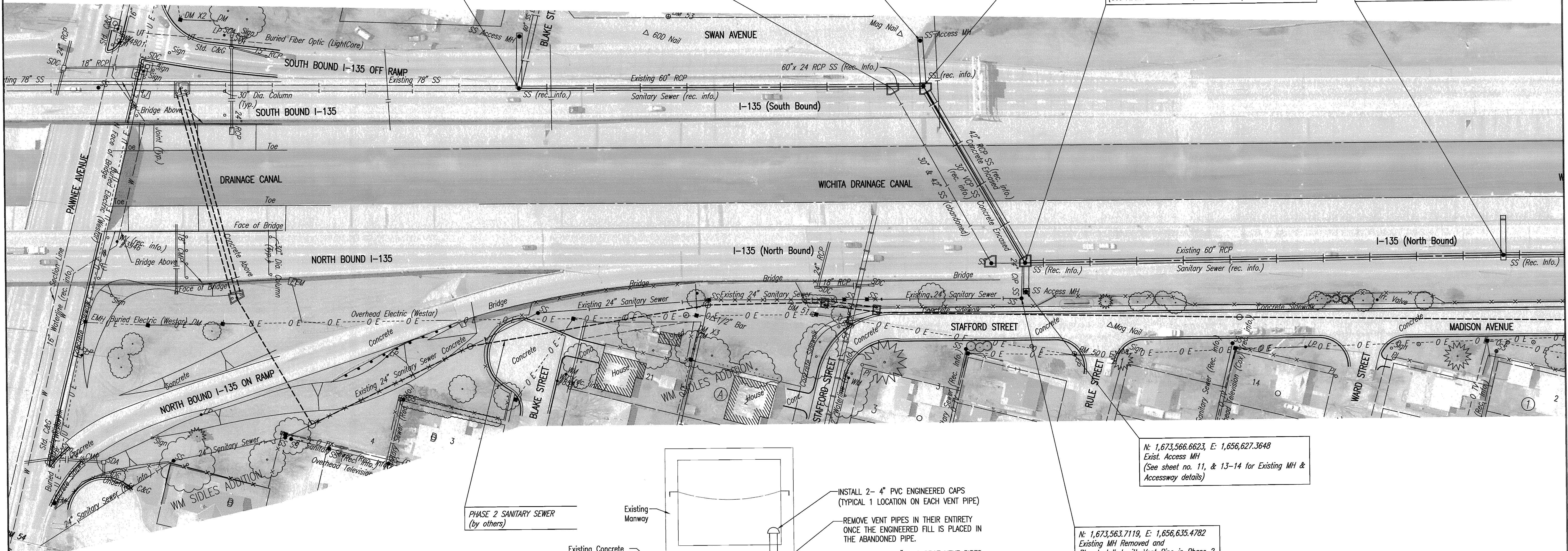

PLUG AND VENT PIPE DETAIL
 (NOT TO SCALE)

Sheet 01-13-2012 9:37:08 AM by CSI
 Plot Scale: 1/50 01-13-2012 9:38:02 AM by CATHY S. LINK
 CA:\2007\07600\001\Phase 3\07600-001-C04-Demo plot01

	Revision	By	Date
	RELOCATION OF SANITARY SEWER NO. 23 PHASE 3: ABANDONMENT PLANS		
	SANITARY SEWER ABANDONMENT PLAN		
	JAMES L. ARMOUR, P.E. - CITY ENGINEER CITY OF WICHITA PROJECT NO. 468-84375b		
		PROFESSIONAL ENGINEERING CONSULTANTS, P.A. 303 SOUTH TOPEKA WICHITA, KS 67202 316-262-2691 www.pec1.com	
Designed by	MDK, SAD	Job No.	35-07600-001
Drawn by	CSL, JAN	Date	SEPTEMBER 2011
			Sht. 4 of 20