

UTILITY STATEMENT & CAUTION:
 THE CONTRACTOR IS SPECIFICALLY CAUTIONED THAT THE LOCATION AND/OR ELEVATION OF EXISTING UTILITIES AS SHOWN ON THESE PLANS IS BASED ON A COMBINATION OF FIELD SURVEY INFORMATION, EXISTING DRAWINGS AND RECORDS OF THE VARIOUS UTILITY COMPANIES. THE ENGINEER MAKES NO GUARANTEE THAT THE UNDERGROUND UTILITIES SHOWN COMPRISE ALL SUCH UTILITIES IN THE AREA, EITHER IN SERVICE OR ABANDONED. THE ENGINEER FURTHER DOES NOT WARRANT THAT THE UNDERGROUND UTILITIES SHOWN ARE IN THE EXACT LOCATION INDICATED ALTHOUGH HE DOES CERTIFY THAT THEY ARE LOCATED AS ACCURATELY AS POSSIBLE FROM INFORMATION AVAILABLE. THE ENGINEER HAS NOT PHYSICALLY LOCATED THE UNDERGROUND UTILITIES. THE CONTRACTOR MUST CALL THE APPROPRIATE UTILITY COMPANY AT LEAST 48 HOURS BEFORE ANY EXCAVATION TO REQUEST EXACT FIELD LOCATION OF UTILITIES. IT SHALL BE THE RESPONSIBILITY OF THE CONTRACTOR TO RELOCATE ALL EXISTING UTILITIES WHICH CONFLICT WITH THE PROPOSED IMPROVEMENTS SHOWN ON THE PLANS.

EMERGENCY OVERFLOW RELIEF LOCATION FOR DA1 FOR RUNOFF HIGHER THAN 100 YEAR

PROP. STORMWATER SUBMERSIBLE SUMP PUMP
 DISCHARGE RATE = ±130 GPM (EQ.29 CFS)
 TOTAL DYNAMIC HEAD = 112.5' FT
 SUMP PUMP DISCHARGE PIPE ELEV = 1366.75
 CONCRETE FLUME CREST ELEVATION AT SUMP PUMP DISCHARGE PIPE = 1396.44
 SUMP PUMP ON ELEV = 1396.00
 SUMP PUMP OFF ELEV = 1380.00
 SUMP PUMP INTAKE ELEV = 1377.00
 WET WELL BOTTOM ELEV = 1374.00
 10" DRAIN FROM POND, FL=1389.91

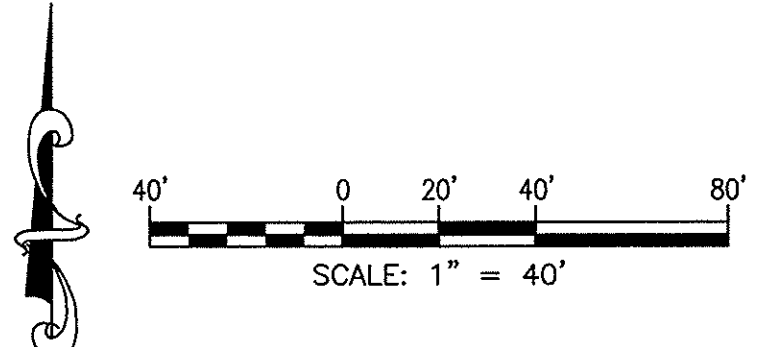

DRAINAGE SURFACE SUMMARY

	TOTAL AREA	PERVIOUS	IMPERVIOUS	EMERGENCY OVERFLOW LOCATION
DRAINAGE AREA DA1	± 1.121 AC.	± 0.174 A.C.	± 0.947 A.C.	AS SHOWN
DRAINAGE AREA DA2	± 0.33 AC.	± 0.065 A.C.	± 0.265 A.C.	AS SHOWN
DRAINAGE AREA DA3	± 1.489 AC.	± 0.190 A.C.	± 1.299 A.C.	AS SHOWN
DRAINAGE AREA DA4	± 0.229 AC.	± 0.018 A.C.	± 0.211 A.C.	AS SHOWN

DRAINAGE INTERCEPTION LOCATION (REFER STORM SEWER PROFILES)

DRAINAGE AREA I.D.	INTERCEPTION LOCATION
DA1 FLUME	= BUILDING DOWNSPOUTS, COMPACTOR PAD AND PAVING AREA TO CURB
DA2	= CURB FLUME
DA3	= CURB FLUME AND DES 7-4 INLET STA. 10+86.00 SWS LINE "A"
DA4	= DES 6 INLET, STA. 10+00.00 SWS LINE "A"

- NOTES:**
- REFER ARCH. PLANS FOR LOCATION AND SIZE OF TRUCK WELL DRAIN.
 - CONTRACTOR SHALL MEET AND MATCH TOP OF JUNCTION BOXES/MANHOLES OR CLEAN OUTS WITH FINISHED PAVING GRADES.
 - STORM SEWERS LABELED AS "SWS" MAY BE OF HDPE (SMOOTH LINER)/ALUMINIZED CSP OR RCP MATERIAL AND SHALL MEET WALMART'S SITEWORK SPECIFICATIONS. CONTRACTOR SHALL SUBMIT STORM PIPE PRODUCT DATA TO SMC CONSULTING ENGINEERS, P.C. FOR APPROVAL. CONTRACTOR SHALL SUBMIT PRECAST SHOP DRAWINGS OF THE STORM MANHOLES AND INLETS TO ENGINEER FOR VERIFICATION OF THE PIPE CONNECTION TO THESE STRUCTURES. ALUMINIZED CORRUGATED STEEL PIPES SHALL BE ULTRA FLOW OR W/ MANNINGS ROUGHNESS COEFFICIENT OF 0.013 OR BETTER.
 - THE SPOT ELEVATIONS AND CONTOUR ANNOTATIONS ARE BASED ON A F.F.E.=1398.25. THE SPOT ELEVATIONS AND CONTOUR ANNOTATIONS ARE PROTRACTED TO DOUBLE DIGITS FOR PLAN CLARITY.
 - REFER ERU PLAN FOR PERVIOUS AND IMPERVIOUS AREAS WITHIN PROPERTY LINE.

ANY STORM DRAINAGE SYSTEM LESS THAN 12" IN SIZE SHALL BE INSPECTED BY THE CITY OF WICHITA OFFICE OF CENTRAL INSPECTION



LEGEND

—	SIGN (i.e. STOP, YIELD, etc...)
+	LIGHT POLE AND FIXTURE TYPE
TC	TOP OF CURB
TP	TOP OF PAVEMENT
TW	TOP OF WALK
BW	BOTTOM OF WALL
FL	FLOW LINE
—	STORM SEWER INLET
—	PROPOSED STORM SEWER AREA INLET
—XX—	PROPOSED CONTOUR & CONTOUR ELEVATION
TCXXX/TPXXX	SPOT ELEVATION
—	FLOW DIRECTION
TG	TOP OF GRATE
SW	SIDEWALK
H.P.	HIGH POINT
DS	DOWNSPOUT

PROPOSED DRAINAGE PLAN

WALMART MARKET #5873-01

13TH STREET NORTH & OLIVER AVENUE
WICHITA, KANSAS

SMC Consulting Engineers, P.C.
 815 West Main - Oklahoma City, OK 73106
 PH: 405-232-7715 FAX: 405-232-7859
 KANSAS CERTIFICATE OF AUTHORIZATION NO. E-335 EXP. Dec. 31, 2011

No.	Revision	By	Date
1	City review comments	MDS	06/28/11
2	City & SMC review comments	MDS	07/20/11
3	City review comments	MDS	08/12/11
4	Addendum #1 - SMC & City review comments	MDS	08/26/11

DATE: 05/04/11 SCALE: 1"=40' SHEET NO. C-9.3

DRAWN BY: MDS PROJECT NO: 4936.30 ENGINEER: TERENCE L. HAYNES, P.E. #14583

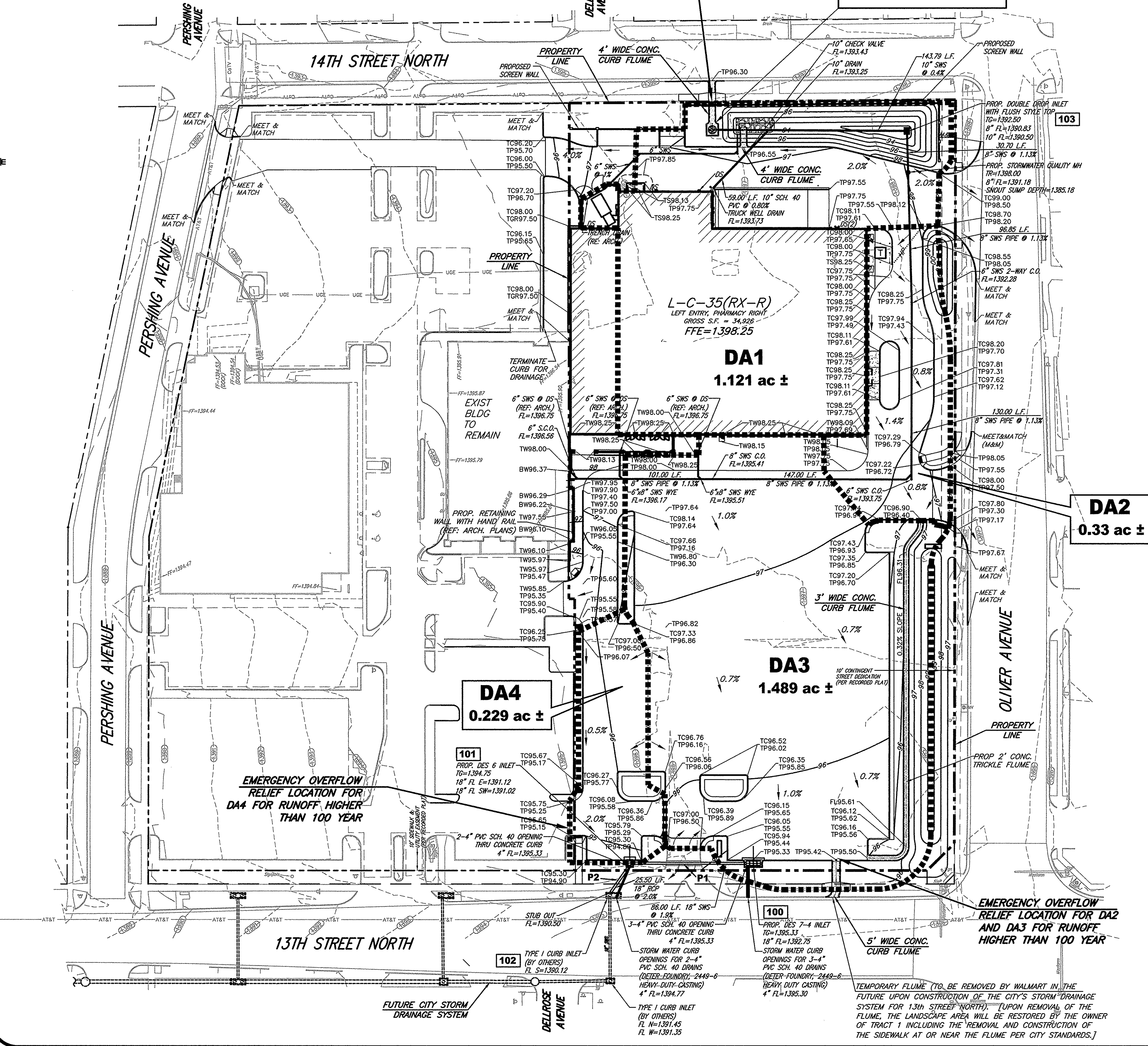

EMERGENCY OVERFLOW RELIEF LOCATION FOR DA2 AND DA3 FOR RUNOFF HIGHER THAN 100 YEAR

EMERGENCY OVERFLOW RELIEF LOCATION FOR DA4 FOR RUNOFF HIGHER THAN 100 YEAR

EMERGENCY OVERFLOW RELIEF LOCATION FOR DA2 AND DA3 FOR RUNOFF HIGHER THAN 100 YEAR

TEMPORARY FLUME (TO BE REMOVED BY WALMART IN THE FUTURE UPON CONSTRUCTION OF THE CITY'S STORM DRAINAGE SYSTEM FOR 13th STREET NORTH); UPON REMOVAL OF THE FLUME, THE LANDSCAPE AREA WILL BE RESTORED BY THE OWNER OF TRACT 1 INCLUDING THE REMOVAL AND CONSTRUCTION OF THE SIDEWALK AT OR NEAR THE FLUME PER CITY STANDARDS.