

EROSION CONTROL NOTES

1. EROSION CONTROL IS TO MEET ALL FEDERAL, STATE, COUNTY & LOCAL CODE STANDARDS.
2. CONTRACTOR SHALL PROVIDE AND PRESERVE EROSION PROTECTION THROUGHOUT PROJECT CONSTRUCTION. THE PLAN PROVIDED HERE IS FOR FINAL PROTECTION, VARIOUS PHASES OF THIS PLAN SHALL BE IMPLEMENTED OR MODIFIED TO CONTROL EROSION. MODIFICATIONS OF THE PLAN SHALL BE APPROVED BY THE OWNERS REPRESENTATIVE.
3. CONTRACTOR IS RESPONSIBLE FOR MAINTAINING AND IMPLEMENTING ALL EROSION CONTROL.
4. CONTRACTOR SHALL INSTALL AND MAINTAIN A STABILIZED CONSTRUCTION ENTRANCE AT A LOCATION DETERMINED BY THE ENGINEER.
5. EROSION CONTROL MAT SHALL BE NORTH AMERICAN GREEN SC-150 OR APPROVED EQUAL. INSTALL PER MANUFACTURER'S RECOMMENDATIONS.



CRIMPING NOTES

1. ONCE TOPSOIL HAS BEEN PLACED, DISC/SCARIFY SOIL PRIOR TO SPREADING PRAIRIE HAY.
2. SPREAD PRAIRIE HAY (2 TONS/AC.) AND IMMEDIATELY CRIMP INTO TOPSOIL WITH SUITABLE MECHANICAL EQUIPMENT.

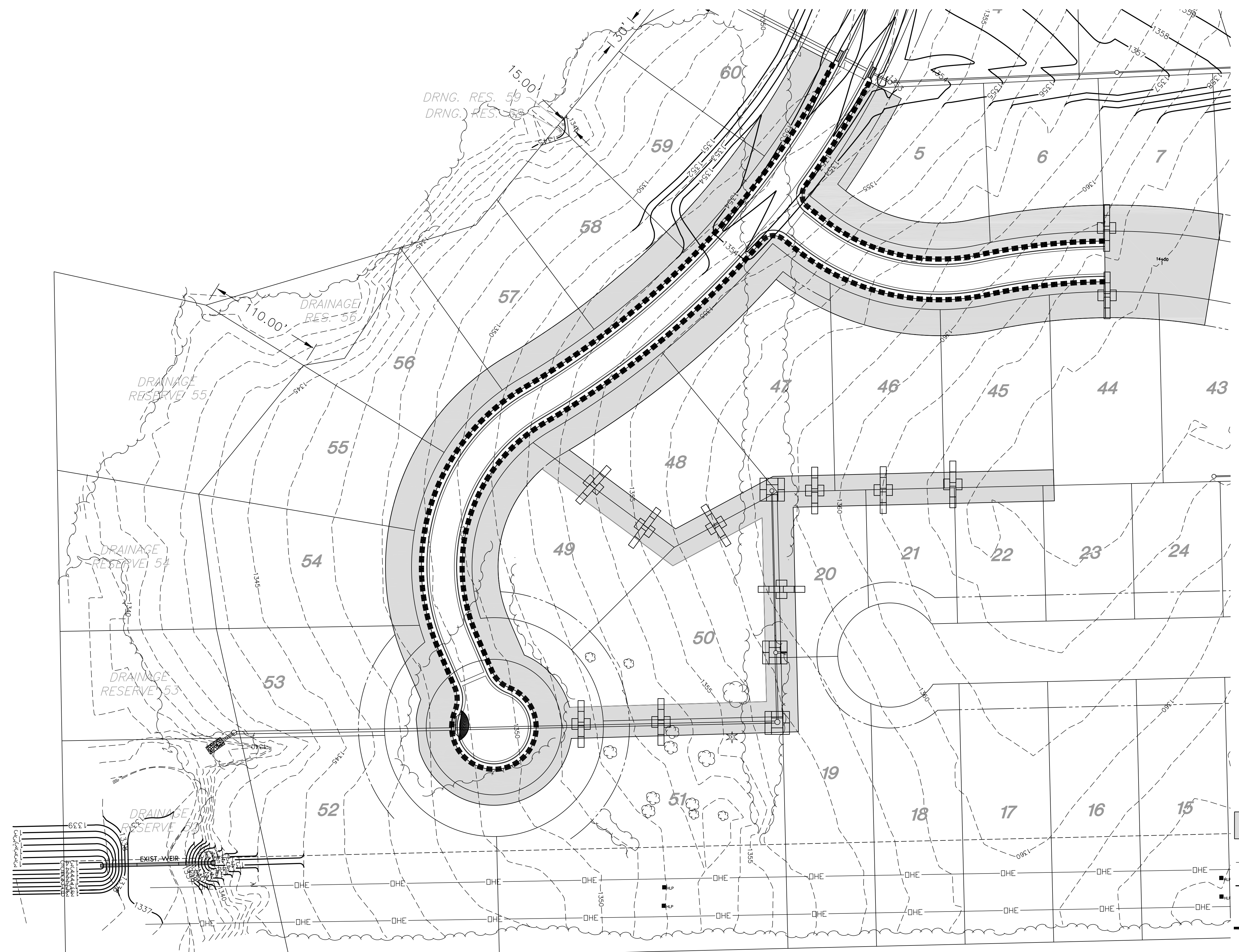
PAVING PLANS
KRUG SOUTH ADDITION
PHASE 2

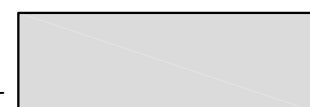
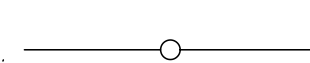
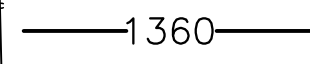

EROSION CONTROL LEGEND

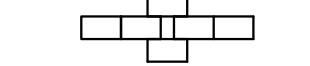
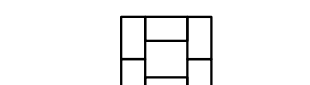
-  SEEDING LIMITS
ANNUAL RYE (3.7 AC.) 200 LBS/ACRE
FERTILIZE 10-20-10 @ 1.50 LBS/ACRE
(QUANTITIES GIVEN FOR INFORMATION ONLY)
-  PROPOSED STORM SEWER LINE
-  PROPOSED CONTOURS
-  CURB INLET FILTER (1)
-  BACK OF CURB PROTECTION (2333 L.F.)
-  TEMPORARY SWALE PROTECTION (11)
-  INLET PROTECTION (3)

EROSION CONTROL & SEEDING PLAN

SCALE: 1"=50'

PLOT: Tuesday, April 24, 2012 @ 02:28PM

EROSION & SEEDING PLAN
SHEET TITLE
PROJ 472-84522
PROJECT NUMBER

DFL / KKL / GJA
DESIGNED / DRAWN / CHECKED

ISSUED
April 2012

REVISED

SHEET NO.

J:\CIVIL\05291\DWG\PAV\PHASE 2\05291_EROSION.DWG