

SEDGWICK COUNTY
COLEMAN PARKING LOT
WICHITA, KANSAS

LawKington Architecture
 Engineering · Planning · Interiors · Landscapes

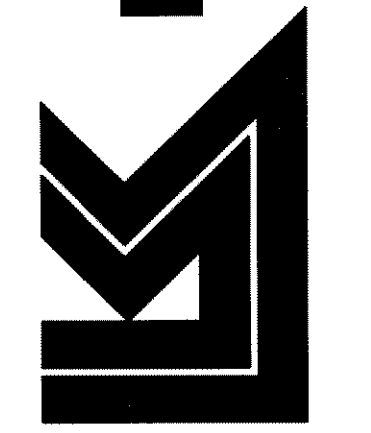

LawKington Architecture ©
 345 RIVERVIEW, WICHITA, KS 67203
 Phone (316) 268-0230 Fax (316) 268-0205

PROJECT NUMBER:
10422
 SHEET TITLE:
SITE GRADING PLAN
 SHEET NUMBER:
C1.3

SCALE:

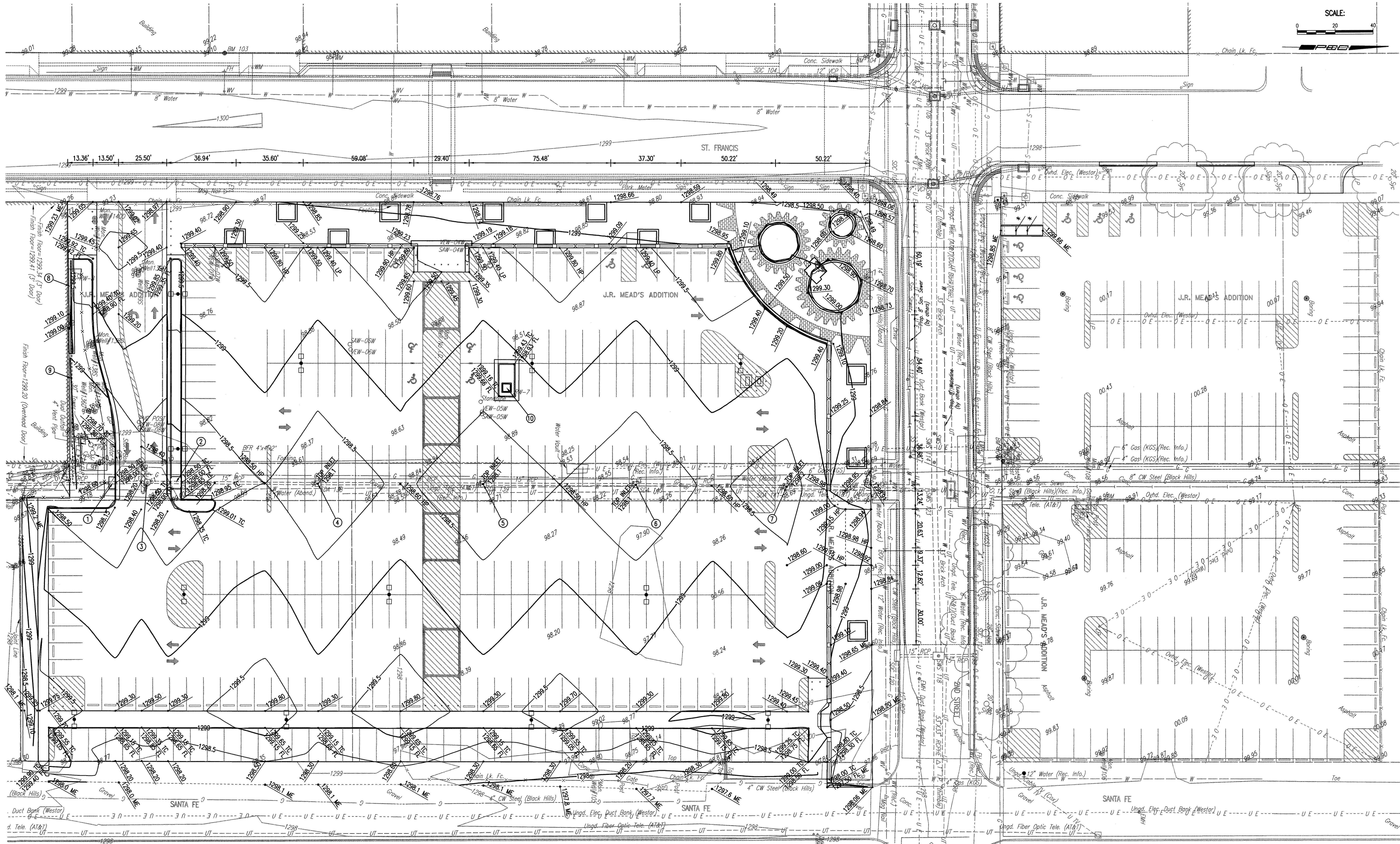
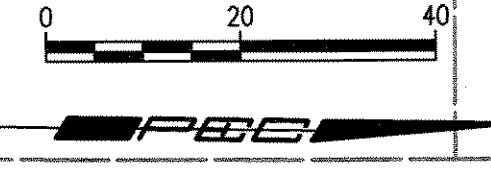

- ① N: 1,686,560.9535, E: 1,650,591.7123
 CONST. STD. TYPE 1 CURB INLET
 L=5'-0", W=3'-0"
 TOP ELEV.= 1298.6
 1" RCP= 1295.25 (N&S)
 4" SDR 35 PIPE= 1297.19 (S)
 SEE DETAIL, SHEET NO. C2.3
 REMOVE EXISTING 1" RCP THRU INLET.
 SEAL EXISTING 1" RCP (N&S)
 IN PLACE WITH NON-SHRINK GROUT.
 ANY ADDITIONAL LABOR OR MATERIALS NECESSARY
 TO COMPLETE THE CONNECTION SHALL BE
 CONSIDERED SUBSIDIARY TO THE PROJECT.
- ② N: 1,686,594.4472, E: 1,650,591.0503
 CONST. STD. THROAT TYPE 1 CURB INLET
 L=5'-0", W=5'-0"
 TOP ELEV.= 1298.5
 1" RCP= 1295.07 (N)
 1" RCP= 1295.14 (S)
 SEE DETAIL, SHEET NO. C2.4
 REMOVE EXISTING 1" RCP THRU INLET.
 SEAL EXISTING 1" RCP (N&S)
 IN PLACE WITH NON-SHRINK GROUT.
 ANY ADDITIONAL LABOR OR MATERIALS NECESSARY
 TO COMPLETE THE CONNECTION SHALL BE
 CONSIDERED SUBSIDIARY TO THE PROJECT.
- ③ N: 1,686,579.0781, E: 1,650,591.1388
 EXISTING AREA INLET TO BE MODIFIED.
 ADJUST EXISTING AREA INLET TOP FROM
 ELEV. 1298.61 TO ELEV. 1298.2
 SEE DETAIL, SHEET NO. C2.2
- ④ N: 1,686,669.6980, E: 1,650,590.3588
 EXISTING AREA INLET
 ADJUST EXISTING AREA INLET TOP FROM
 ELEV. 1298.57 TO ELEV. 1298.1
 SEE DETAIL, SHEET NO. C2.2
- ⑤ N: 1,686,669.6980, E: 1,650,590.3588
 EXISTING AREA INLET
 ADJUST EXISTING AREA INLET TOP FROM
 ELEV. 1298.60 TO ELEV. 1298.1
 SEE DETAIL, SHEET NO. C2.2
- ⑥ N: 1,686,839.3077, E: 1,650,588.1801
 EXISTING AREA INLET
 ADJUST EXISTING AREA INLET TOP FROM
 ELEV. 1298.63 TO ELEV. 1298.1
 SEE DETAIL, SHEET NO. C2.2
- ⑦ N: 1,686,919.3482, E: 1,650,587.8942
 EXISTING AREA INLET
 ADJUST EXISTING AREA INLET TOP FROM
 ELEV. 1298.53 TO ELEV. 1298.2
 SEE DETAIL, SHEET NO. C2.2
- ⑧ CONSTRUCT 48.0 L.F. TRENCH DRAIN
 (AST POLYDRAIN OR APPROVED EQUAL)
 WITH DUCTILE IRON SLOTTED GRATE.
 SEE DETAIL, SHEET NO. C2.2
 E= 1298.77 (N. END)
 E= 1298.48 (S. END)
 SLOPE= 0.60%
- ⑨ INSTALL 90 L.F. 4" PIPE
 (SDR 35) @ 1.44% SLOPE
- ⑩ N: 1,686,769.4505, E: 1,650,537.2997
 CONSTRUCT WELL VAULT
 TOP ELEV.= 1299.3
 SEE DETAIL, SHEET NO. C2.2
 WATER EXTRACTOR RW-7 WILL BE
 RELOCATED BY OTHERS.

NOTES:
 CONTRACTOR SHALL MAINTAIN, OR INSTALL, INLET PROTECTION
 ON ALL INLETS. MAINTAIN PERIMETER SILT FENCE PROTECTION,
 AND INSTALL STABILIZED CONSTRUCTION ENTRANCES AT
 LOCATIONS SPECIFIED BY THE PROJECT INSPECTOR. THE
 MAINTENANCE OF EXISTING BMP'S AND INSTALLATION OF NEW
 BMP'S SHALL BE PAID FOR IN THE LUMP SUM BID ITEM
 "EROSION CONTROL"

* 6' LANDING AREA, FLAT SET AT MID-WAY
 HEIGHT IN RAMP.

LEGEND

- 1300.50 TC TOP OF CURB ELEVATION
- 1300.00 FL FLOWLINE OF CURB ELEVATION
- 1300.60 PAVEMENT ELEVATION
- 1300.3 GROUND ELEVATION
- 99.90 EXISTING SPOT ELEVATION
- 1300 EXISTING MAJOR CONTOUR
- 1299 EXISTING MINOR CONTOUR
- 1300 MAJOR CONTOUR (1.0')
- 1299.5 MINOR CONTOUR (0.5')
- ME = MATCH EXISTING
- CONTRACTOR SHALL VERIFY ALL EXISTING
 ELEVATION AND REPORT ALL
 DISCREPANCIES TO THE ENGINEER
 PRIOR TO CONSTRUCTION.
- HP = HIGH POINT ELEVATION
- LP = LOW POINT ELEVATION

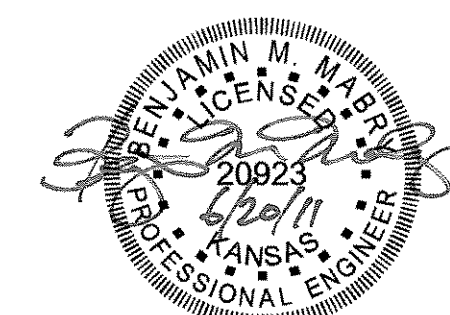

Scale: 06/20/2011 2:23:45 PM by JLM
 01/20/2011 10:45:02 AM 10422-C-SITE GRADING PLAN