

13th STREET – Bituminous

Sta. 3+70.00 to Sta. 24+94.97
 Sta. 28+06.03.00 to Sta. 46+06.87
 Sta. 50+20.06 to Sta. 51+14.63
 Sta. 54+76.50 to Sta. 75+61.36
 Sta. 77+30.05 to Sta. 102+10.68

Cross-Slope Varies from Exist. to 3.12% from Sta. 0+44.19 to 1+70.00 (See Plan)
 Cross-Slope Varies from 3.12% to 2.08% from Sta. 1+70.00 to 2+53.67 (See Plan)
 Cross-Slope Varies from 2.08% to 3.12% from Sta. 2+53.67 to 3+70.00 (See Plan)
 Cross-Slope Varies from 3.12% to 2.34% from Sta. 24+94.97 to 25+45.78 (See Plan)
 Cross-Slope Varies from 2.34% to 3.12% from Sta. 27+56.03 to 28+06.03 (See Plan)
 Cross-Slope Varies from 3.12% to 2.34% from Sta. 51+14.63 to 51+64.63 (See Plan)
 Cross-Slope Varies from 2.34% to 3.12% from Sta. 54+24.63 to 54+76.50 (See Plan)
 Cross-Slope Varies from 3.12% to Exist. from Sta. 102+10.68 to 103+72.98 (See Plan)

**
 Chautauqua Ave. to Lorraine Ave.
 Sta. 46+06.87 to Sta. 50+20.06 (Lt. ONLY):
 10'-6" – Driving Lane
 29'-0" – Back of Curb to CL
 59'-6" – Back to Back

TEMPORARY ASPHALT PAVEMENT

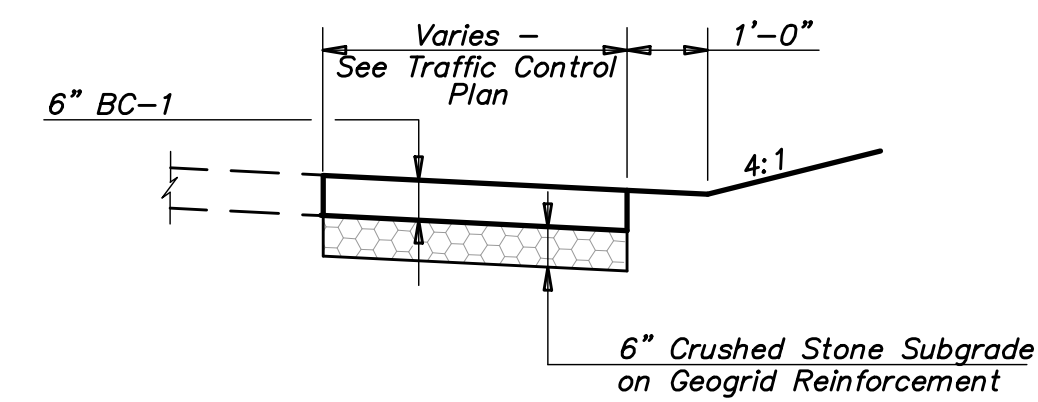

CONCRETE INTERSECTION PAVEMENT – 9" (Reinf.)(AE)

Hydraulic @ 13th CL Sta. -0+46.14 to Sta. 0+44.19
 Grove @ 13th CL Sta. 24+94.97 to Sta. 28+06.03
 Hillside @ 13th CL Sta. 51+14.63 to Sta. 54+76.50
 Lavan/Roosevelt @ 13th CL Sta. 75+61.36 to Sta. 77+30.05 (Longitudinal Centerline Joint – Keyed Only)

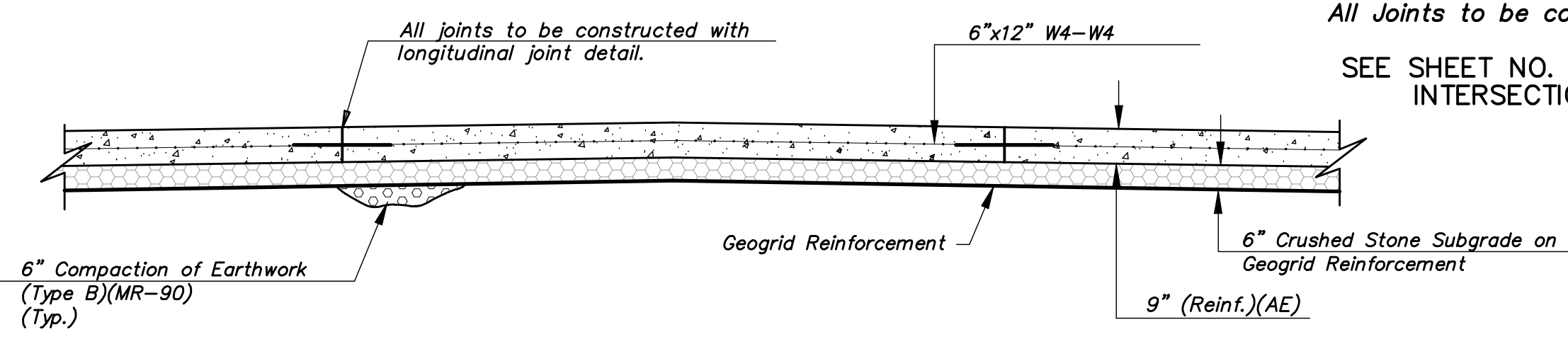

UTILITY PATCH (Reinf.)(AE)

SWS Line 78 (C18 to C21)
 SWS Line 77 (C19 to C20)

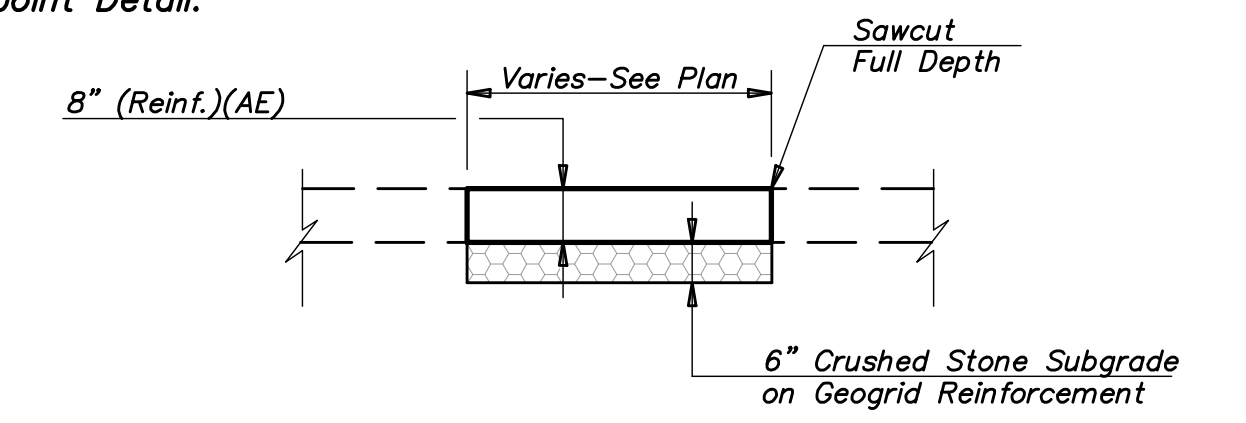

UTILITY PATCH – Bituminous

SWS Line 78 (C22 to C23)

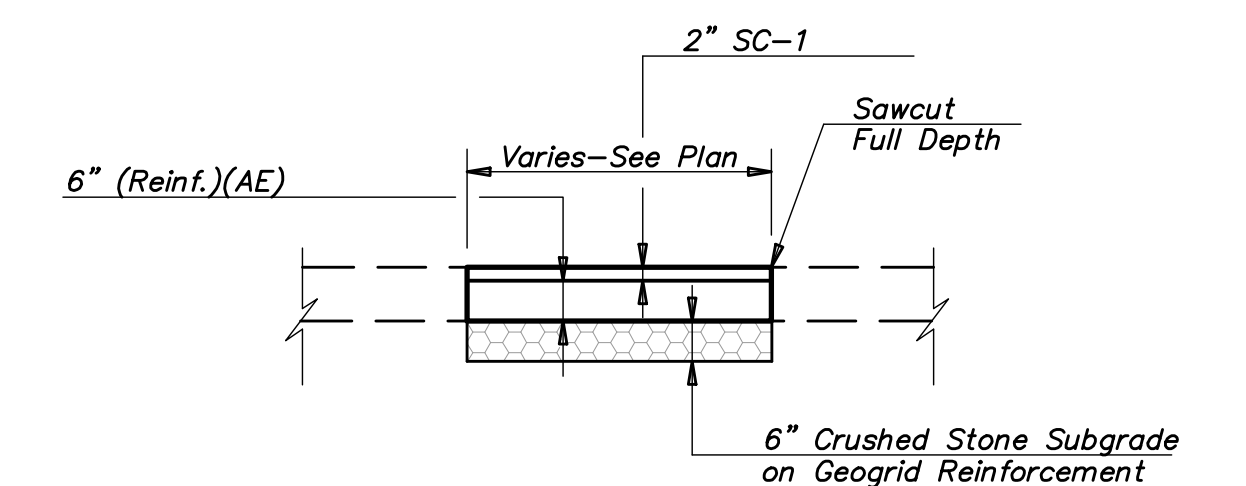

REINF. CONCRETE TRANSITION – Parking Lots

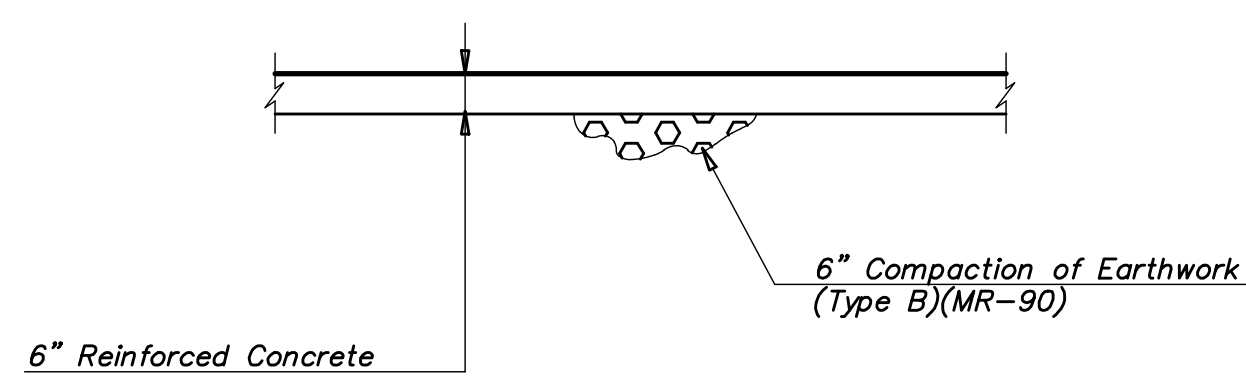

ASPHALT TRANSITION – Parking Lots

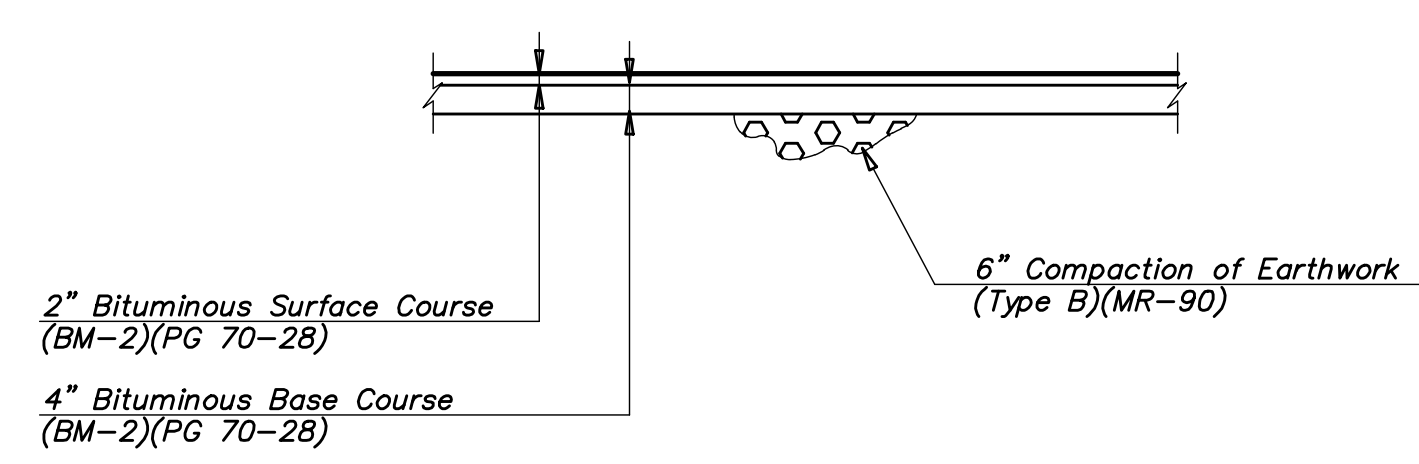

TRANSVERSE CONSTRUCTION JOINTS

TRANSVERSE CONSTRUCTION JOINTS SHALL BE CONSTRUCTED IN FLEXIBLE BASE PAVEMENTS AT LOCATIONS WHERE PAVEMENT JOINTS EXISTING FLEXIBLE BASE PAVEMENT AS SHOWN BY THE DETAIL. ALL COSTS ASSOCIATED WITH THE CONSTRUCTION OF THE TRANSVERSE JOINT SHALL BE INCLUDED IN THE BID PRICE FOR SQUARE YARDS 5" ASPHALTIC CONCRETE PAVEMENT (3" BITUMINOUS BASE)

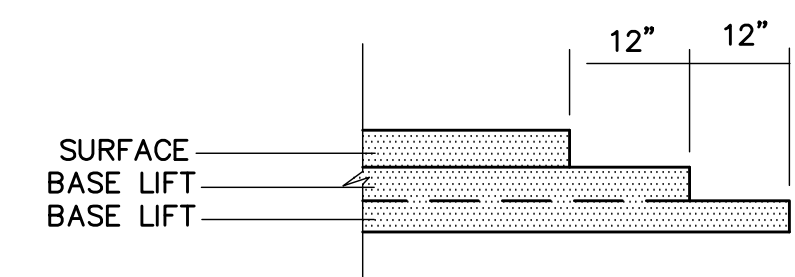

ENGINEER : P. Ferguson ENG. TECH : J. Unruh CAD TECH : J. Unruh DATE : SHEET : 2 OF 374	
13th STREET TYPICAL SECTIONS CITY OF WICHITA, KANSAS	
PROJECT NO. 472-84320	