

**NOTES**

- Contractor shall notify Traffic Engineering Department two weeks prior to start of construction.
- Temporary signals will be provided by Contractor.
- Traffic to be carried through construction. See Construction Traffic Control Plan.
- Contractor shall contact all utility companies which may be affected by this construction prior to beginning of construction.
- Service Box, Junction Box, poles, mast arms and conduit runs are existing.
- The Video Detection System shall be complete and the Contractor shall furnish and install all equipment necessary for the satisfactory operation of electrical apparatus and for the complete operation of traffic signal system whether specifically mentioned or not.
- Remove the existing loop wires from the conduits and remove all un-used junction boxes.

**DETECTION\_ZONE**

AREA NO.	SIZE	CAMERA	MOVEMENT CALLED
1	6' X 50'	1	6
2	6' X 50'	1	6
3	6' X 50'	1	1
4	6' X 50'	3	2
5	6' X 50'	3	2
6	6' X 50'	3	5
7	6' X 50'	2	4
8	6' X 50'	4	8

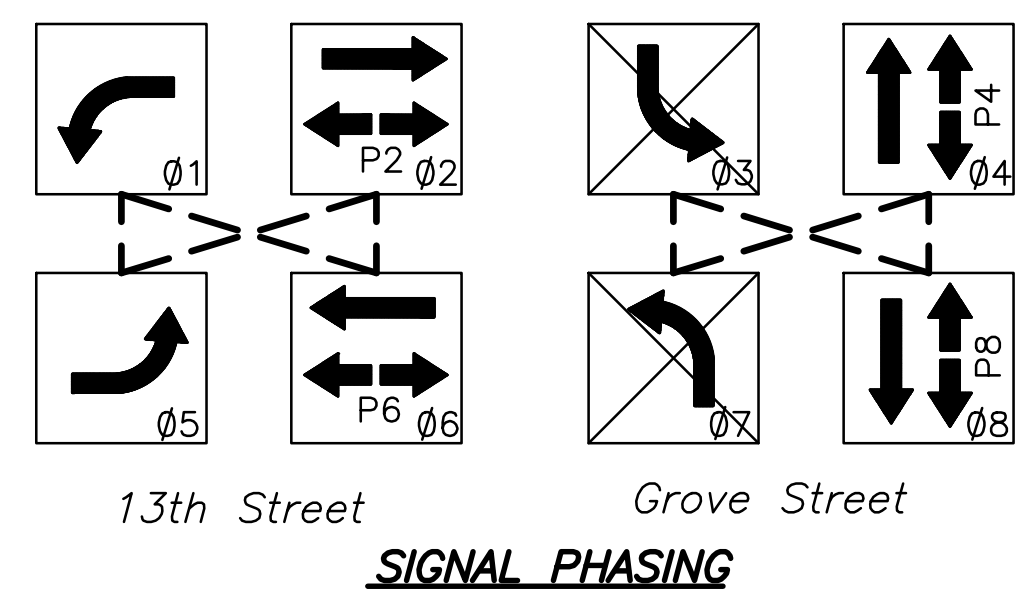
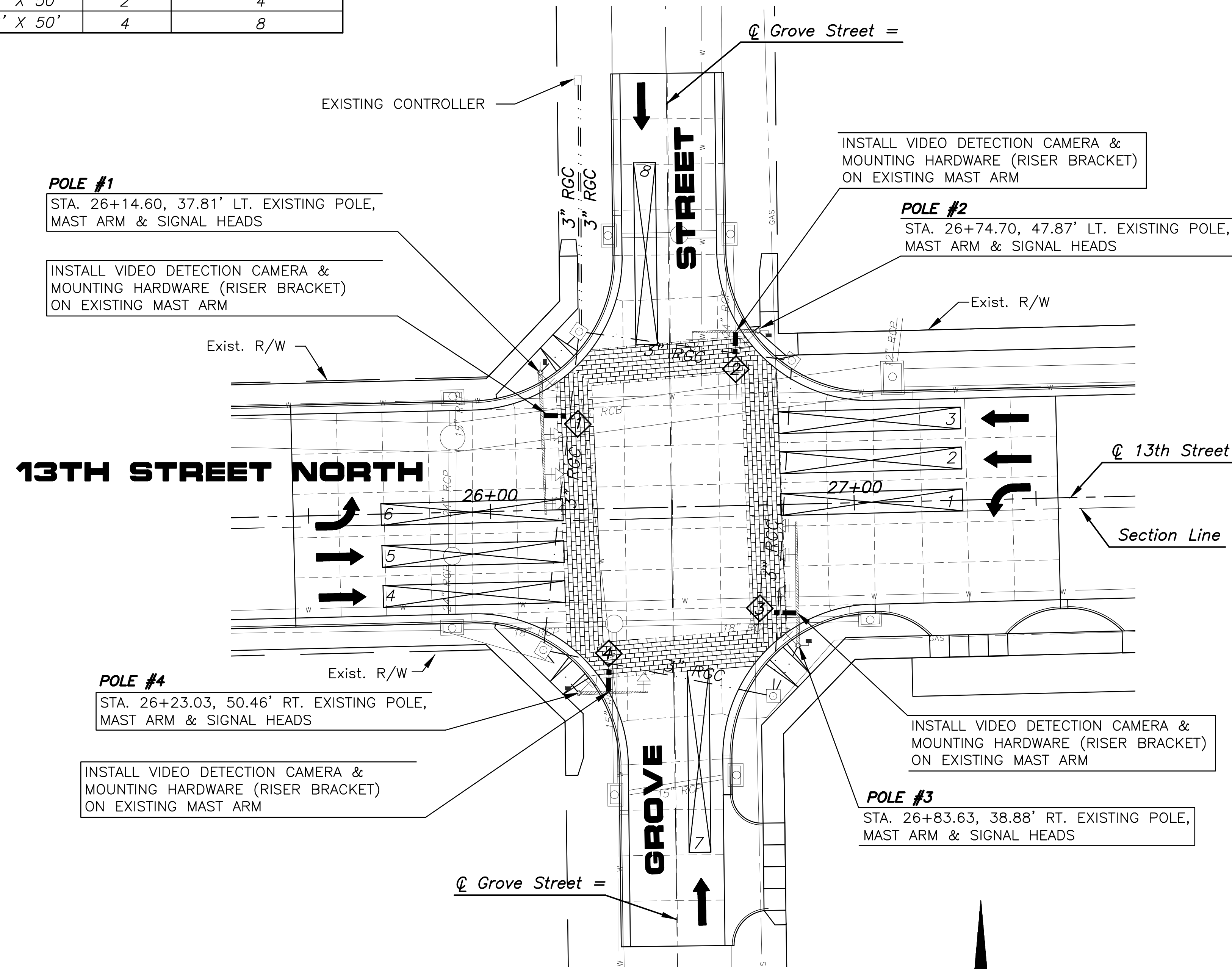

--- Indicates that Phases may Time Concurrently

**LEGEND**

- |  |                                   |  |  |
|--|-----------------------------------|--|--|
|  | Video Detection Camera            |  | Pad Mounted Controller                                       |
|  | Street Name Sign with Designation |  | Pedestrian Signal and Push Button                            |
|  | R10-12 (Left Turn Yield on Green) |  | Service Box  |
|  | Detection Zone                    |  | Power Supply   |
|  | Existing Conduit                  |  | Mast Arm Mounted Signal Head (with back plate)               |
|  | Traffic Signal Pole with Mast Arm |  | Vertical Bracket Mounted Signal Head (with type designation) |

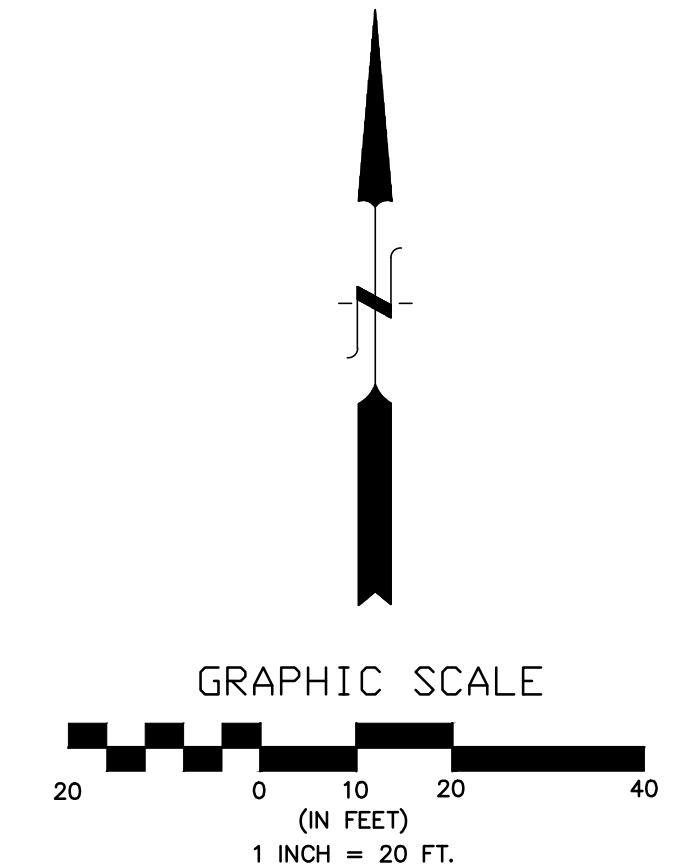

13TH STREET NORTH FROM KANSAS TO OLIVER  
 CITY OF WICHITA, KANSAS  
 TRAFFIC SIGNAL PLAN  
 13TH STREET NORTH AND GROVE STREET VIDEO DETECTION SYSTEM  
 POE & ASSOCIATES, INC.  
 CONSULTING ENGINEERS  
 5940 E. Central, Suite 200 • Wichita, KS 67208-4242  
 Phone 316/685-4114 • FAX 316/685-4444  
 P. FERGUSON  
 P. FERGUSON  
 CITY Job No.: 472-84320  
 Poe Job No.: 1871  
 Date: March, 2012  
 Sheet  
 162 of 374