

**NOTES**

- Contractor shall remove and deliver to 1801 S. McLean existing signals, signal poles, controller, cabinet and manhole covers. Contractor shall notify Traffic Engineering Department two weeks prior to start of construction.
- Traffic to be carried through construction. See Construction Traffic Control Plan.
- Contractor shall contact all utility companies which may be affected by this construction prior to beginning of construction.
- Service Box and conduit runs are typical only and should be adjusted during installation to clear obstructions and facilitate wiring as approved by the Engineer.
- The traffic signal system shall be complete and the Contractor shall furnish and install all equipment necessary for the satisfactory operation of electrical apparatus and for the complete operation of traffic signal system whether specifically mentioned or not.
- Signal equipment (mast arms, poles, cabinet, etc...) shall be black.
- The Contractor shall contact Westar to coordinate the power hook-up.
- Rigid steel conduit shall be installed under all roadways.

FUNCTION	PHASE TIMING							
	1	2	3	4	5	6	7	8
MAX. I	40	30	40	30	40	30		
MAX. II/HFDW	40	30	40	30				
WALK			7				7	
FLASH DW			18					18
MAX. INITIAL	30				30			
MIN. GREEN	30				30			
TBR								
TTR								
CITY OF WICHITA TO PROVIDE								
OBSERVE GAP								
PASSAGE								
MIN. GAP								
ADD ACTUATION								
YELLOW	4.0				4.0			
RED CLEAR	2.0				2.0			
RED REVERT								
WALK II								

FUNCTION	FUNCTION TABLE							
	1	2	3	4	5	6	7	8
VEHICLE RECALL								
PEDESTRIAN RECALL								
RED LOCK								
YELLOW LOCK								
PERMIT		X					X	
PED. PHASES				X				
LEAD PHASES	X	X	X	X				
DOUBLE ENRTY								
SEQUENTIAL TIMING								
STARTUP YELLOW								
OVERLAP A								
OVERLAP B								
OVERLAP C								
OVERLAP D								
EXCLUSIVE								
SIMULTANEOUS GAP								

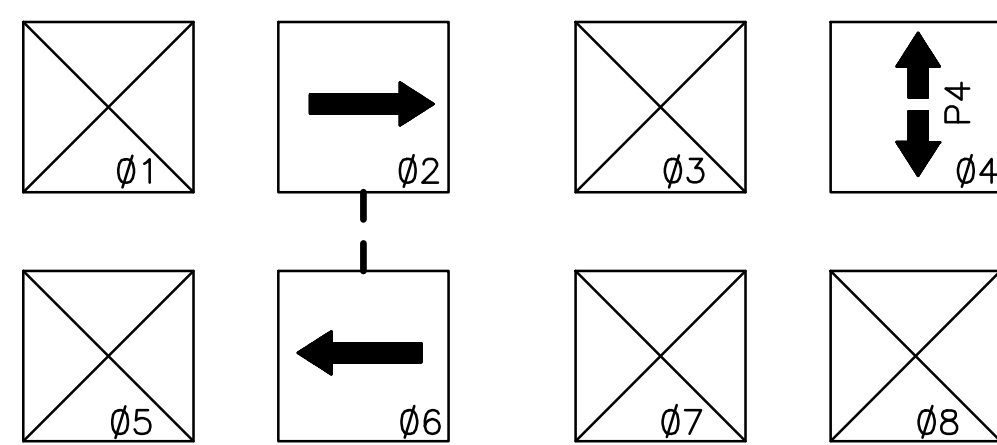

13th Street North  
**SIGNAL PHASING**

--- Indicates that Phases may Time Concurrently

**LEGEND**

- Pedestrian Signal and Push Button
- Service Box
- 3" Conduit
- Traffic Signal Pole with Mast Arm
- Pole Mounted Controller
- Junction Box
- Mast Arm Mounted Signal Head (with back plate)
- Vertical Bracket Mounted Signal Head (with type designation)

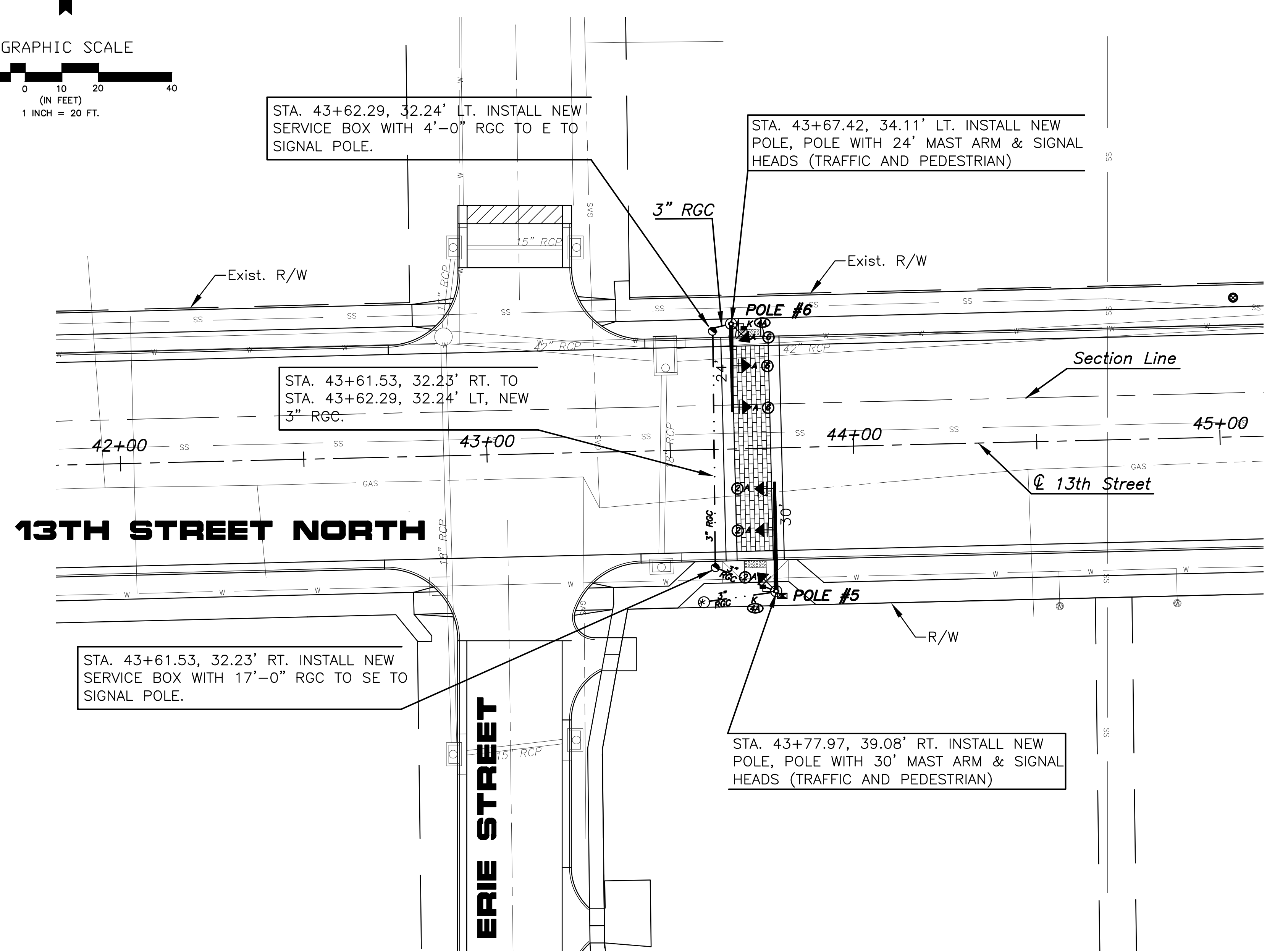
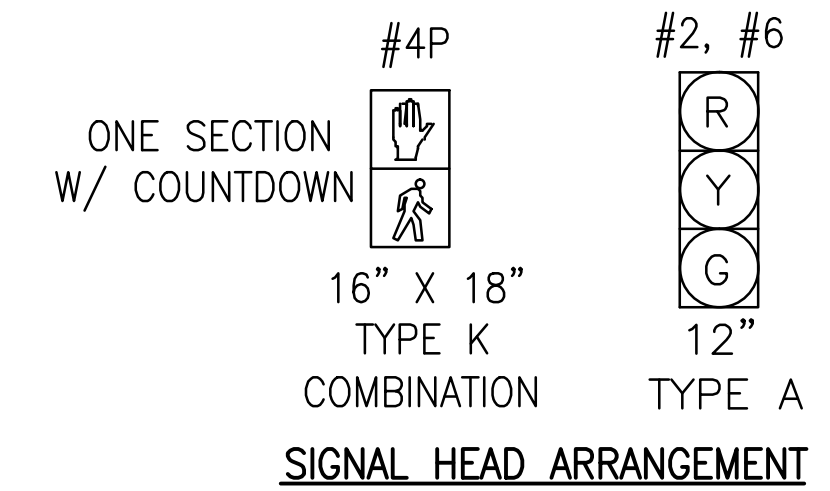
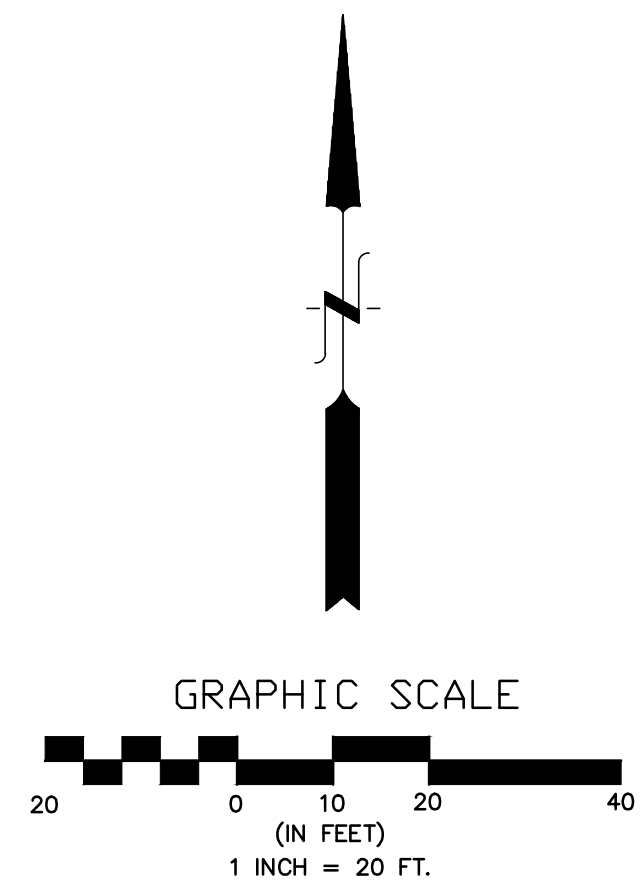

13TH STREET NORTH FROM KANSAS TO OLIVER  
 CITY OF WICHITA, KANSAS  
 TRAFFIC SIGNAL PLAN  
 13TH STREET NORTH ERE PEDESTRIAN TRAFFIC SIGNALS

POE & ASSOCIATES, INC.  
 CONSULTING ENGINEERS  
 5940 E. Central, Suite 200 • Wichita, KS 67208-0242  
 Phone 316/605-4114 • FAX 316/605-4444

**POE**

**FINAL**

Engineer: P. FERGUSON  
 Designer: P. FERGUSON  
 CITY Job No.: 472-84320  
 Date: March, 2012

Sheet 164 of 374