

NOTES

- Contractor shall notify Traffic Engineering Department two weeks prior to start of construction.
- Traffic to be carried through construction. See Construction Traffic Control Plan.
- Contractor shall contact all utility companies which may be affected by this construction prior to beginning of construction.
- Service Box, Junction Box and conduit runs are typical only and should be adjusted during installation to clear obstructions and facilitate wiring as approved by the Engineer.
- The traffic signal system shall be complete and the Contractor shall furnish and install all equipment necessary for the satisfactory operation of electrical apparatus and for the complete operation of traffic signal system whether specifically mentioned or not.
- Signal equipment (mast arms, poles, cabinet, etc...) shall be black.
- The Contractor shall contact Westar to coordinate the power hook-up.
- Rigid steel conduit shall be installed under all roadways.

FUNCTION	PHASE TIMING							
	1	2	3	4	5	6	7	8
MAX. I	20	60		20	20	60		20
MAX. II/HFDW	20	60		20	20	60		20
WALK		8		8		8		8
FLASH DW		10		17		10		17
MAX. INITIAL	6	10		6	10			
MIN. GREEN	5	10		5	10			
TBR	1	15		1	15			
TTR	1	25		1	25			
CITY OF WICHITA TO PROVIDE								
OBSERVE GAP								
PASSAGE								
MIN. GAP								
ADD ACTUATION								
YELLOW	3.0	4.0		3.0	3.0	4.0		3.0
RED CLEAR	1.0	1.5		1.0	1.0	1.5		1.0
RED REVERT								
WALK II								

FUNCTION	PHASE							
	1	2	3	4	5	6	7	8
VEHICLE RECALL		X						X
PEDESTRIAN RECALL								
RED LOCK								
YELLOW LOCK	X			X	X			X
PERMIT	X	X		X	X	X	X	X
PED. PHASES	X	X		X	X	X	X	X
LEAD PHASES	X	X		X	X	X	X	X
DOUBLE ENRTY								
SEQUENTIAL TIMING								
STARTUP YELLOW				X				X
OVERLAP A								
OVERLAP B								
OVERLAP C								
OVERLAP D								
EXCLUSIVE								
SIMULTANEOUS GAP								

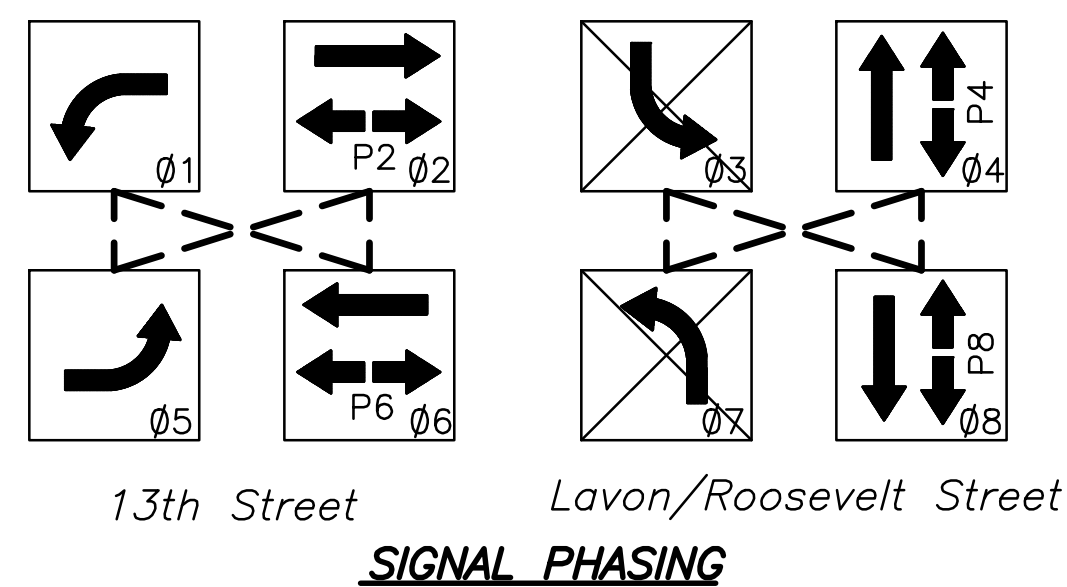

--- Indicates that Phases may Time Concurrently

DETECTION_ZONE

AREA NO.	SIZE	CAMERA	MOVEMENT CALLED
1	6' X 50'	7	6
2	6' X 50'	7	6
3	6' X 50'	7	1
4	6' X 50'	9	2
5	6' X 50'	9	2
6	6' X 50'	9	5
7	6' X 50'	8	4
8	6' X 50'	10	8

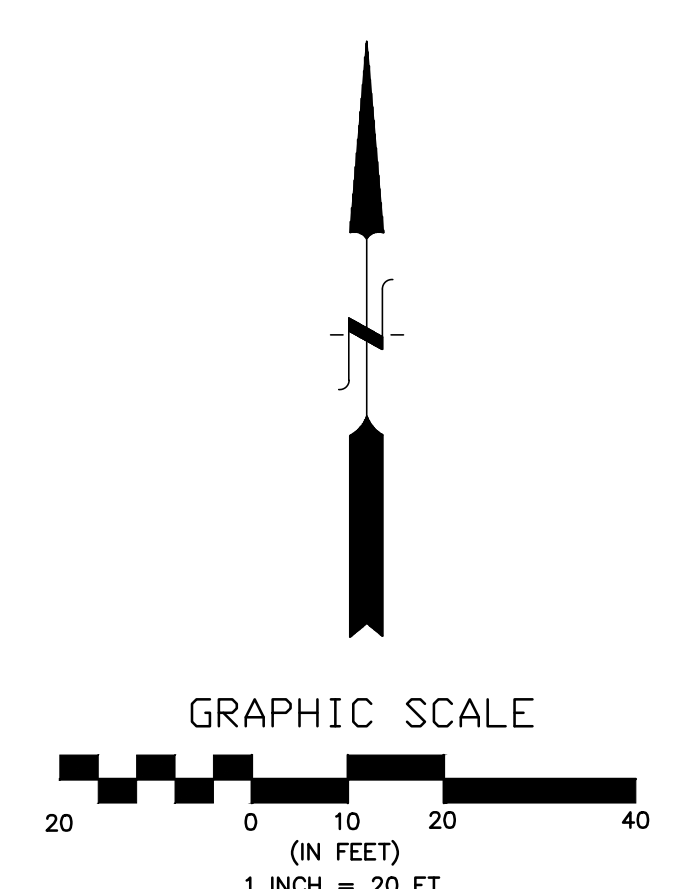
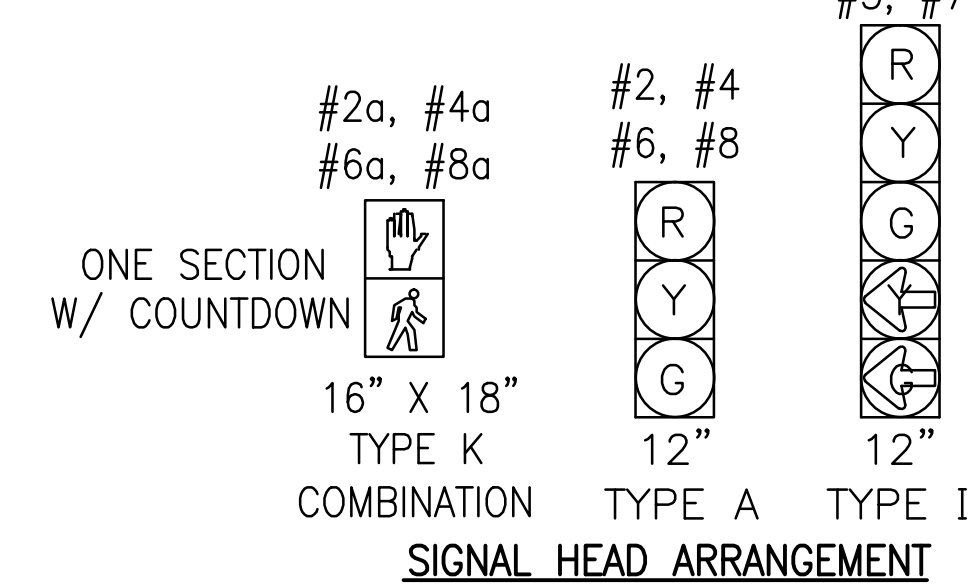
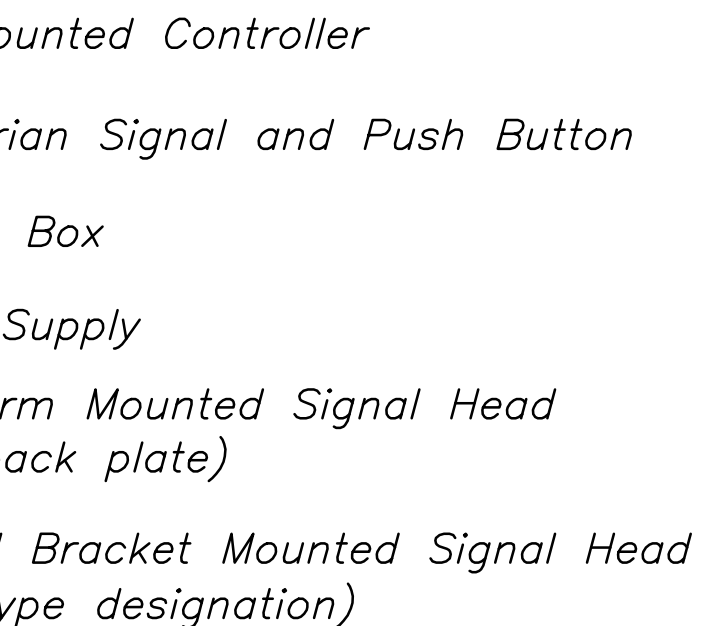
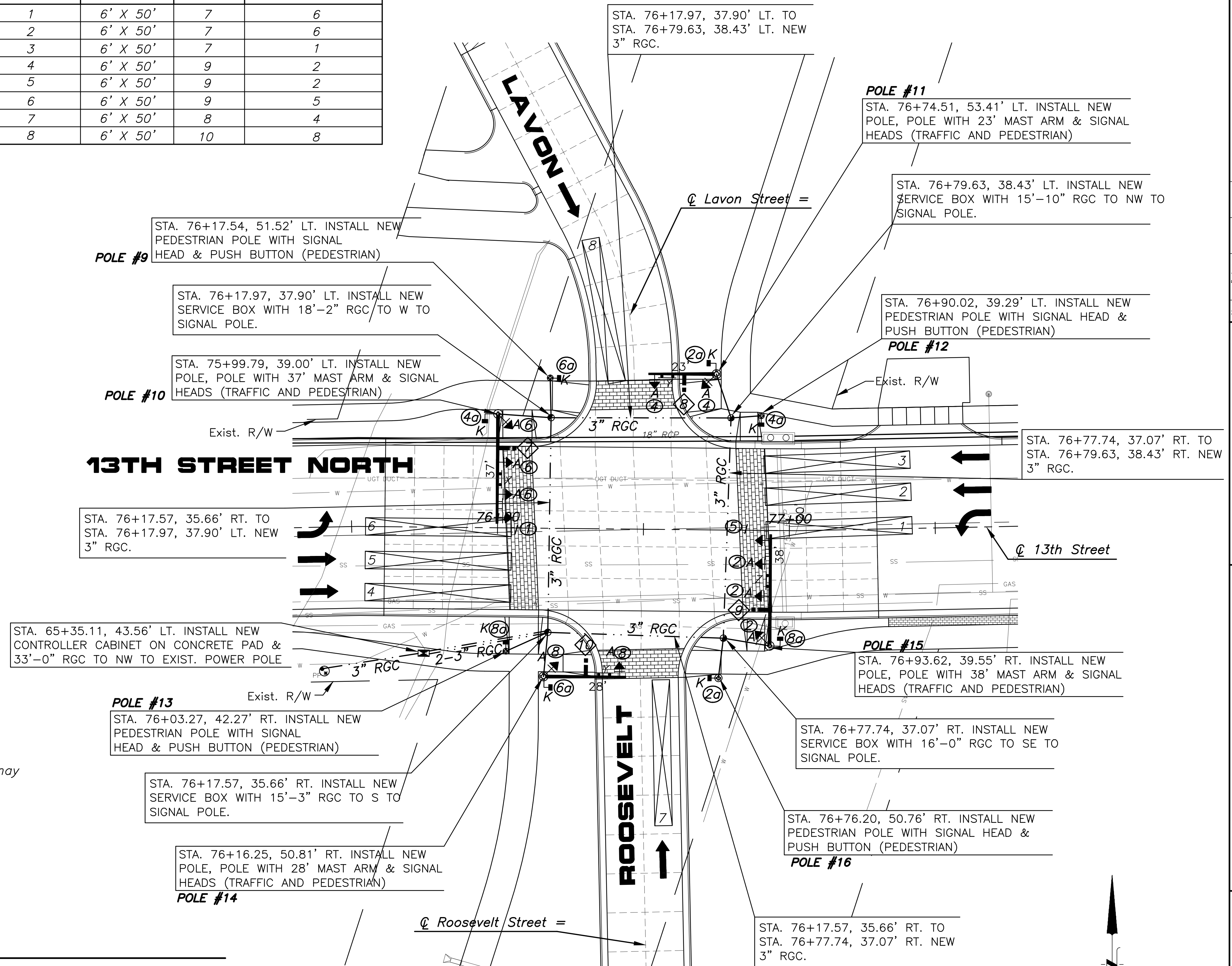

13TH STREET NORTH FROM KANSAS TO OLIVER
 CITY OF WICHITA, KANSAS
 TRAFFIC SIGNAL PLAN
 13TH STREET NORTH AND LAVON/ROOSEVELT TRAFFIC SIGNALS
 POE & ASSOCIATES, INC.
 CONSULTING ENGINEERS
 5940 E. Central, Suite 200 • Wichita, KS 67208-0242
 Phone 316/605-4114 • FAX 316/605-4444
 Engineer: P. FERGUSON
 Designer: P. FERGUSON
 CITY Job No.: 472-84320
 POE Job No.: 1871
 Date: March, 2012
 Sheet 168 of 374