

Fire Hydrants Required						
Line #	Station	Length (offset and direction)	Bury Line Elevation	Top of Pipe Elevation	Fire Hydrant Bury Required	Valve Stem Extension Required
1	9+05.38	8' Rt.	1303.58	1299.07	5.5	1
1	13+58.95	8' Rt.	1304.72	1299.56	6.0	3
1	20+37.36	3' Lt.	1304.33	1299.87	5.5	2
1	40+31.84	3' Lt.	1328.52	1324.67	4.5	1
1	68+34.23	5' Lt.	1360.34	1357.19	4.0	1
1	73+24.84	4' Lt.	1366.06	1361.61	5.5	2
2	1+99.69	5' Rt.	1303.40	1299.52	5.0	1
3	0+65.06	4' Rt.	1303.04	1298.96	5.0	2
3	1+73.21	5' Rt.	1302.84	1298.67	5.0	2
12	0+43.89	4' Lt.	1307.55	1303.77	4.5	1
13	0+21.34	4' Rt.	1308.32	1304.44	5.0	1
13	1+98.88	4' Rt.	1309.29	1305.59	4.5	1
14	0+78.48	4' Rt.	1310.66	1307.18	4.5	1
19	1+81.82	20' Lt.	1332.60	1329.48	4.0	1
22	0+87.44	4' Lt.	1345.94	1342.75	4.0	1
23	0+87.44	16' Lt.	1360.09	1355.77	5.5	1
25	1+75.65	4' Rt.	1375.40	1372.20	4.0	1
31	0+79.11	4' Rt.	1389.17	1385.82	4.0	1
33	0+66.11	4' Rt.	1393.29	1390.00	4.0	1
34	0+54.26	8' Lt.	1389.05	1383.08	7.0	3
35	0+80.09	4' Rt.	1383.25	1380.90	3.0	0
36	1+30.74	5' Rt.	1385.24	1381.70	4.5	1
37	0+33.27	4' Lt.	1388.78	1384.12	5.5	2
42	0+03.50	4' Lt.	1380.55	1376.12	5.5	2

Valve Information for Water Line Shutoff and Construction									
Related Road	Valves (for North of 13th)	Size	Nearest Intersecting Road	Valves (for South of 13th)	Size	Nearest Intersecting Road	Other Valves	Size	Location
Pennsylvania	1380			33226	8	13th (NE)			
	377	2	14th (SW)	34317	8	11th (SE)			
	3560	2.5	15th (NW)						
	3381								
Hydraulic	3940	2.5	15th & New York (NE)						
	3559	2.5	15th (NW)						
	1811	8	13th (NW)	2977	8	13th (SE)			
	13134	8	15th (NW)	33237	8	11th (SW)			
Kansas				3670	8	11th (SW)			
	3428	2.5	13th (NW)	34322	8	13th (NW)	13935	8	13th & Kansas (NW)
	3427	2.5	15th (SW)				35918	8	13th & Kansas (NW)
Minneapolis							35919	8	13th & Kansas (NW)
	3219	8	13th (NW)	33246	8	13th (NW)	35920	8	13th & Minneapolis (NW)
Minnesota	4532	8	15th (NE)	34323	8	Rumsey (SW)			
	3126	2.5	13th (NW)	29580	8	13th (NW)			
Piatt	4526	2.5	15th (SW)	29582	2	12th (NW)			
	3125	8	13th (NW)	3406	8	13th (NE)			
Ash	4528	2	15th (NW)	4767	8	11th (SW)			
	4529	8	15th (NW)	3405	6	9th (NE)			
	1321	6	13th (NW)	33155	6	13th (NW)			
	1394	2	14th (SW)	34338	8	11th			

GENERAL NOTES:

- Contractor will be required to provide a minimum advance notice of twenty-four (24) hours to utility companies prior to starting any excavation as follows:
- All water mains and appurtenances shall be installed in accordance with City of Wichita, Kansas Standard Specifications for Water Mains.
- The Water main shall be constructed on the alignment shown by the plans. Trees and shrubs in public right-of-way which are in direct conflict with proposed new construction shall be removed by the Contractor with the Engineer's approval. Trees and shrubs which are not in direct conflict with proposed new construction shall be saved and protected from damage. The cost for any necessary tree trimming, clearing and/or grubbing shall be included in the price bid for site clearing and restoration.
- Opening and closing water valves shall be done slowly to prevent damage to the water distribution system from water hammer. All valves closed by the Contractor must be reopened as new construction permits. Project Inspector must ascertain that any valve closed by the Contractor is reopened. Contractor will be permitted to operate water valves only when THE PROJECT INSPECTOR assigned to the project IS PRESENT.
- Contractor shall not start work on the project until the Project Inspector is assigned to the project and is present on the site. Any work done without inspection will be required to be uncovered for inspection.
- The Contractor shall give all property owners and/or tenants of developed property directly abutting the construction of this project a minimum of ten (10) days advance notice prior to start of construction.
- The Contractor shall be responsible for preserving property irons. The contractor will be required to re-establish any property irons which are damaged or destroyed by his construction operations. Such irons shall be re-established by a licensed land surveyor in accordance with state laws. All costs for this work shall be subsidiary to site clearing and restoration.
- Interurban traffic generated outside the project area and local business or residential traffic generated within the project area are to be carried through construction as further promulgated by project special provisions.
- Contractor shall only abandon existing waterlines at such time to minimize time of service interruption while connecting new services.
- All Top Valve Box Elevations are called out as proposed elevations. Boxes located in existing roadway should temporarily be set to match existing pavement, and adjusted to permanent grade during street improvements.
- All Fire Hydrant Assemblies to be removed during construction shall be removed in good condition and returned to the City of Wichita Water Department.
- All Fire Hydrant Assemblies to be removed during construction shall be plugged no further from the existing water main than the hydrant valve.

NOTE:
Waterline Valves to be operated by Contractor ONLY if THE PROJECT INSPECTOR is ON SITE.
Contractor to Field Verify Location of all Existing Utilities Prior to Construction.

LEGEND

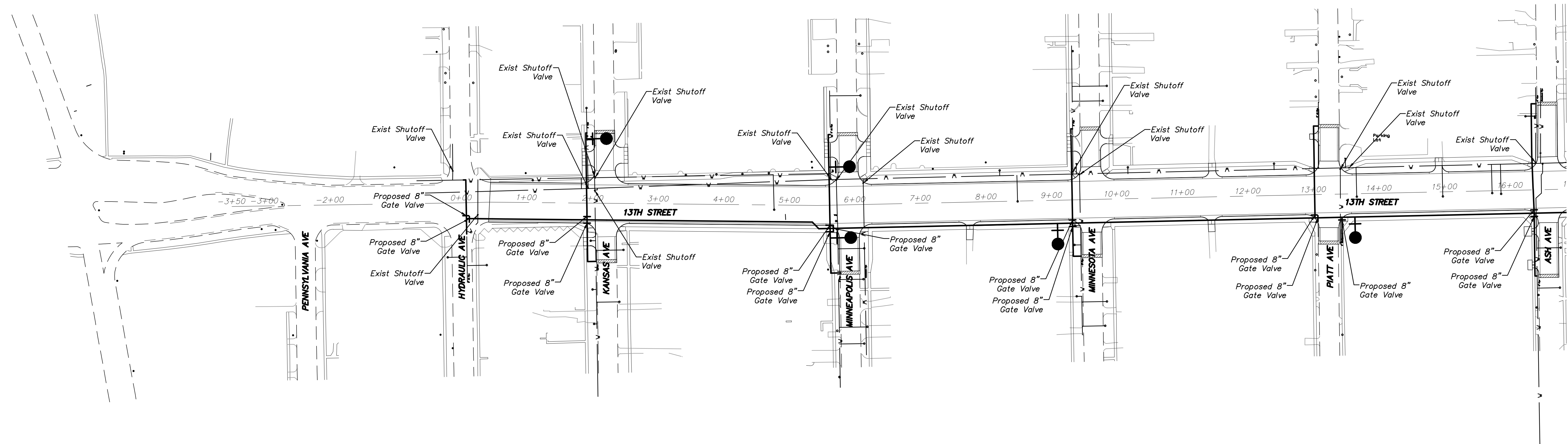
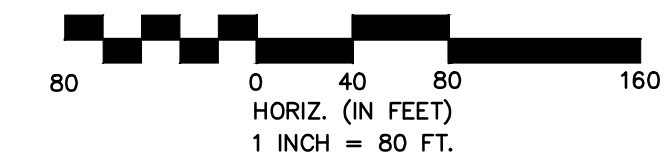
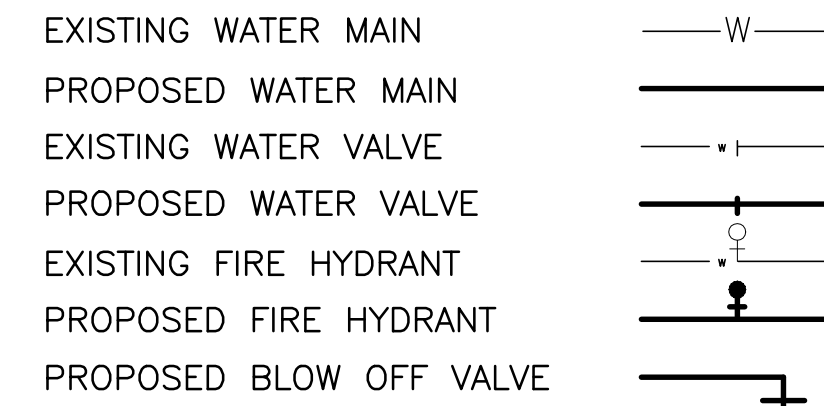

13th STREET NORTH FROM KANSAS TO OLIVER
 WATER SUPPLY IMPROVEMENTS
 WATER KEWAP & NOTES
 CITY OF WICHITA, KANSAS
 JAMES L. ARNDORFER, P.E. - CITY ENGINEER
 C.O.W. Proj. # 448-90551 O.C.A. # 639803

POE & ASSOCIATES, INC.
 CONSULTING ENGINEERS
 5940 E. Central, Suite 200 Wichita, KS 67208-4242
 Phone 316/685-4114 FAX 316/685-4444

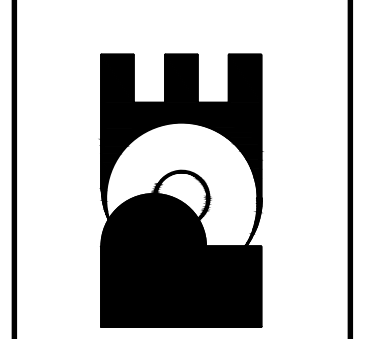

FINAL
 Engineer: J. DICKMAN
 Designer: M. TUCKER
 P.O. Job No.: 1871
 Date: MARCH 2012
 Sheet
 330 of 374