

SITE 5

SHEET 21 OF 55





Pipe Information

US Manhole 4848-185		DS Manhole 4848-184		Basin	
Shape Round	Dia/HT 8	Width	Length	Pipe Sec Length	Length Status TV Inspections
Material VCP	Liner N/A	Slope	Project Number 2012-005180	Index	Surface Rear Easement
Pipe Comment					

Inspection Information

Date Inspected 5/1/2012	Crew 694 MP	Weather Sunny	Surface Condition Trees & Fences	Dyed Test No	% Full
Purpose TV Existing Line	Flow Normal Flow	Direction Upstream	Tape ID DVD #0713	Start	Stop
Inspection Comment CONDITION 1 TELEVISED AGAINST FLOW AND ALSO TELEVISED PULLING CAMERA BACKWARDS					

Maintenance Prior to TV

Cleaned No	Root Cut No	Degrease No	Root Chem No	Point Repair No	MH Replaced No	Other
----------------------	-----------------------	-----------------------	------------------------	---------------------------	--------------------------	--------------



Video Inspection Master Report

2/23/2012

3:06 PM

US Structure: 4848-184 1032 N MURRAY CT Date Insp: 4/29/2009 Basin: W06A
 DS Structure: 4848-114 1143 N WESTFIELD ST Dir Televised: Downstream To Upstream

Pipe Information

Project No. : K-068 Dia: 8 Material: VCP Length: 321.0 Slope: 0.400 DVD #0484

Obs. #	VTR Counter	Distance	Location	Description	Rating	Obsrvd (gpm)	Ratings			Remain (gpm)
							Est. (gpm)	Struct	Clean	
1		0.0		TV against the flow	4848-114 DS Manhole	1	0.000	0	0	0.000
2		16.1		Wye Service Sealed Off		1	0.000	0	0	0.000
3		17.9	1143 S WESTFIELD AVE	Wye Service / roots		2	0.000	0	0	0.000
4		18.0		Roots		3	0.008	5	8	0.008
5		18.9		Crack-Horizontal		2	0.002	2	0	0.002
6		26.4		Roots		3	0.008	5	8	0.008
7		42.7		Roots		2	0.004	2	4	0.004
8		46.7	Joint	Offset		2	0.000	0	0	0.000
9		62.4		Roots		2	0.004	2	4	0.004
10		67.3		Roots		2	0.004	2	4	0.004
11		80.0		Roots		3	0.008	5	8	0.008
12		80.1	Joint	Offset		3	0.010	20	0	0.010
13		83.9	Joint	Offset		2	0.000	0	0	0.000
14		85.1	1040 S MURRAY COURT	Break-In Conn		3	0.004	2	0	0.004
15		88.3		Roots		3	0.008	5	8	0.008
16		88.3	Joint	Offset		3	0.010	20	0	0.010
17		92.1		Roots		3	0.008	5	8	0.008
18		96.0		Roots		3	0.008	5	8	0.008
19		99.6	1135 S WESTFIELD	Wye Service		1	0.000	0	0	0.000
20		124.6		Roots		3	0.008	5	8	0.008
21		128.6	Joint	Offset		3	0.010	20	0	0.010
22		138.0		Wye Service		1	0.000	0	0	0.000
23		143.0	Joint	Offset		2	0.000	0	0	0.000
24		147.9	Joint	Offset		3	0.010	20	0	0.010
25		151.7	Joint	Offset		3	0.010	20	0	0.010
26		159.1	Joint	Offset		2	0.000	0	0	0.000
27		163.8	Joint	Offset		4	0.030	60	0	0.030
28		167.5	Joint	Offset		2	0.000	0	0	0.000
29		168.3	Joint	Offset		3	0.010	20	0	0.010
30		178.5	1127 S WESTFIELD AVE	Wye Service / roots		2	0.000	0	0	0.000
31		178.5	Joint	Offset		3	0.010	20	0	0.010
32		183.5	Joint	Offset		3	0.010	20	0	0.010
33		187.2	Joint	Offset		3	0.010	20	0	0.010
34		190.8		Roots		3	0.008	5	8	0.008
35		190.8	Joint	Offset		3	0.010	20	0	0.010
36		195.3		Roots		3	0.008	5	8	0.008
37		195.3	Joint	Offset		2	0.000	0	0	0.000

Video Inspection Master Report

2/23/2012

3:06 PM

US Structure: 4848-184 1032 N MURRAY CT Date Insp: 4/29/2009 Basin: W06A
 DS Structure: 4848-114 1143 N WESTFIELD ST Dir Televised: Downstream To Upstream

38	199.2	Joint		Offset	3	0.010	20	0	0.010
39	203.4	Joint		Offset	3	0.010	20	0	0.010
40	207.1			Roots	3	0.008	5	8	0.008
41	207.1	Joint		Offset	3	0.010	20	0	0.010
42	211.0			Roots	3	0.008	5	8	0.008
43	211.0	Joint		Offset	2	0.000	0	0	0.000
44	215.7			Roots	3	0.008	5	8	0.008
45	215.7	Joint		Offset	2	0.000	0	0	0.000
46	219.3	Joint		Offset	3	0.010	20	0	0.010
47	223.9			Roots	3	0.008	5	8	0.008
48	227.1	1036 S MURRAY COURT	Break-In Conn / roots		3	0.004	2	0	0.004
49	228.1			Roots	3	0.008	5	8	0.008
50	228.1	Joint		Offset	3	0.010	20	0	0.010
51	232.8	Joint		Offset	2	0.000	0	0	0.000
52	240.4	Joint		Offset	3	0.010	20	0	0.010
53	252.4	Joint		Offset	2	0.000	0	0	0.000
54	252.8	Joint		Offset	2	0.000	0	0	0.000
55	259.5		Wye Service Sealed Off		1	0.000	0	0	0.000
56	263.2	Joint		Offset	2	0.000	0	0	0.000
57	267.5	Joint		Offset	2	0.000	0	0	0.000
58	271.7	Joint		Offset	3	0.010	20	0	0.010
59	275.8	Joint		Offset	3	0.010	20	0	0.010
60	279.6	Joint		Offset	2	0.000	0	0	0.000
61	282.3		Wye Service Sealed Off		1	0.000	0	0	0.000
62	282.3	Joint		Offset	2	0.000	0	0	0.000
63	290.5	Joint		Offset	3	0.010	20	0	0.010
64	294.6	Joint		Offset	3	0.010	20	0	0.010
65	298.2	1119 S WESTFIELD AVE	PVC Break-In Conn		1	0.001	0	0	0.001
66	303.2	Joint		Offset	2	0.000	0	0	0.000
67	311.3	Joint		Offset	2	0.000	0	0	0.000
68	315.3	Joint		Offset	2	0.000	0	0	0.000
69	319.6	Joint		Offset	2	0.000	0	0	0.000
71	322.1			Broken Pipe	0	0.000	0	0	0.000
70	322.7		4848-184 US Manhole		3	0.000	0	0	0.000

THE OFFSET JOINTS HAVE ROOT INTRUSION.

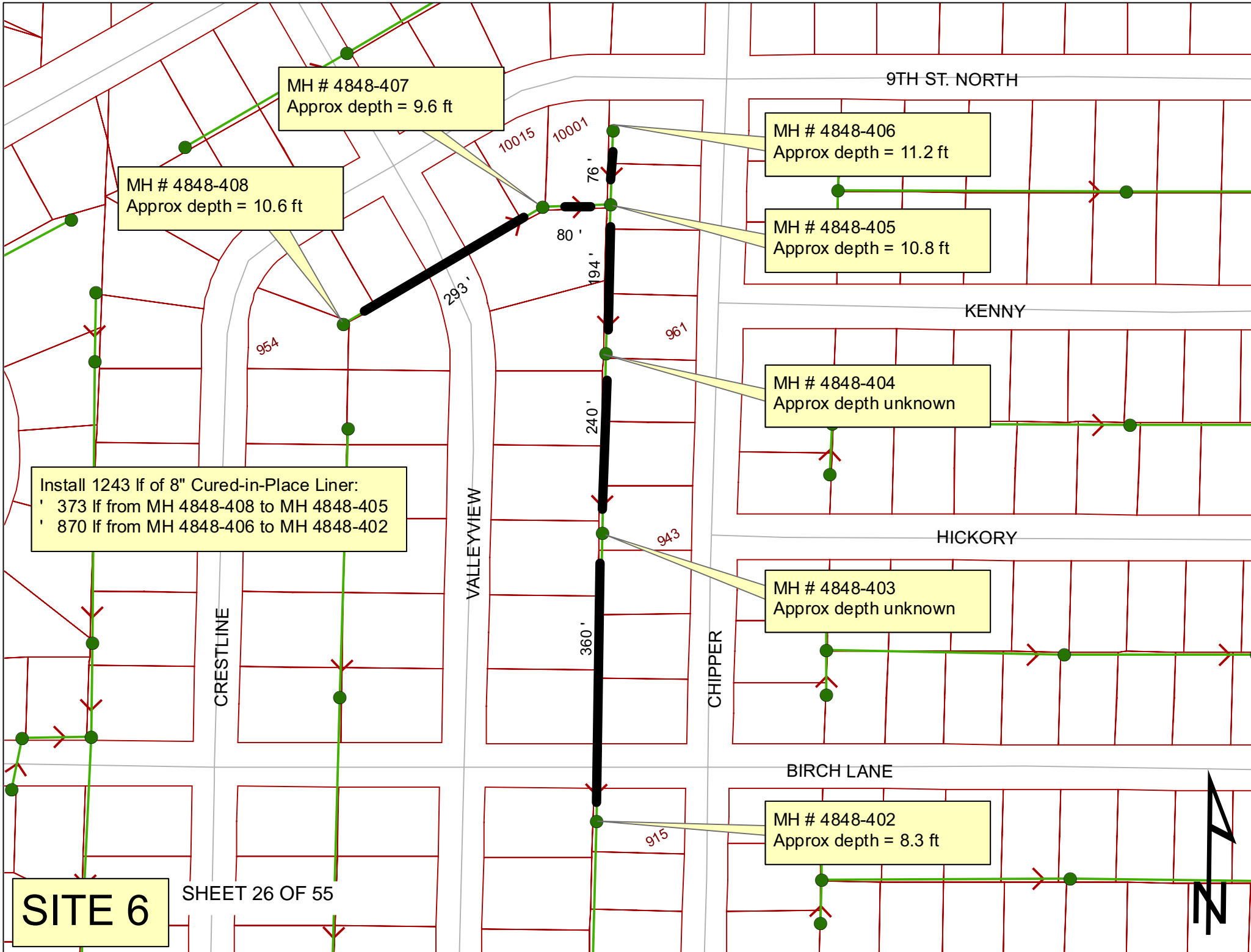

MH # 4848-407
Approx depth = 9.6 ft

MH # 4848-408
Approx depth = 10.6 ft

MH # 4848-406
Approx depth = 11.2 ft

MH # 4848-405
Approx depth = 10.8 ft

MH # 4848-404
Approx depth unknown

Install 1243 lf of 8" Cured-in-Place Liner:
 ' 373 lf from MH 4848-408 to MH 4848-405
 ' 870 lf from MH 4848-406 to MH 4848-402

MH # 4848-403
Approx depth unknown

MH # 4848-402
Approx depth = 8.3 ft

SITE 6

SHEET 26 OF 55





W 9TH ST N

10001 406

10015

407

405

360

359

361

358

W KENNY LN

464

408

404

961

364

424

954

434

363

365

403

943

W HICKORY LN

N CRESTLINE AVE

N VALLEYVIEW LN

N CHIPPER LN

369

368

370

367

N

W BIRCH LN

402

915

384

SHEET 27 OF 55

Television Inspection Master Report

10/26/2009

8:36 AM

US Structure: 4848-408 954 N CRESTLINE ST Date Insp: 7/13/2009 Basin: W06A
 DS Structure: 4848-407 10015 W 9TH ST N Dir Televised: Upstream To Downstream

Pipe Information

Shape: Round Length Status: Project No. : K-053
 Dia/Ht: 8 Material: VCP Index:
 Length: 292.0 Slope: 0.400 Surface: Rear Easement

Inspection Information

Crew: 692 Percent Full: DVD #0498
 Weather: Sunny Purpose: TV Existing Line Tape ID:
 Counter Start:

Obs. #	VTR Counter	Distance	Location	Description	Rating	Obsrvd (gpm)	Ratings			Remain (gpm)
							Est. (gpm)	Struct	Clean	
1		0.0		US Manhole	1	0.000	0	0	0.000	
954 N CRESTLINE										
2		6.0	S	Break-In Conn	1	0.001	0	0	0.001	
954 N CRESTLINE										
3		13.1		Roots	1	0.002	1	1	0.002	
4		13.9	N	Wye Service	1	0.000	0	0	0.000	
10105 W 9TH ST N										
5		37.3		Roots	1	0.002	1	1	0.002	
6		48.0		Broken Pipe	2	0.008	44	0	0.008	
7		52.7	S	Wye Service	1	0.000	0	0	0.000	
939 N VALLEYVIEW										
8		76.4	N	Wye Service / ROOTS	3	0.000	2	0	0.000	
951 N VALLEYVIEW										
9		90.3		Crack-Horizontal	2	0.002	2	0	0.002	
10		92.6		Crack-Horizontal	1	0.001	1	0	0.001	
11		105.9		Crack-Horizontal	1	0.001	1	0	0.001	
12		113.3		Crack-Radial	1	0.001	1	0	0.001	
13		130.1		Crack-Horizontal	1	0.001	1	0	0.001	
14		131.6		Crack-Radial	2	0.002	2	0	0.002	
15		143.6		Crack-Horizontal	1	0.001	1	0	0.001	
16		145.0		Broken Pipe	3	0.010	60	0	0.010	
17		147.4		Broken Pipe	1	0.004	30	0	0.004	
18		156.4		Roots	1	0.002	1	1	0.002	
19		160.9		Broken Pipe	2	0.008	44	0	0.008	
20		165.9		Roots	3	0.008	5	8	0.008	
21		168.4		Roots	1	0.002	1	1	0.002	
22		174.8		Roots	1	0.002	1	1	0.002	
23		177.7		Roots	1	0.002	1	1	0.002	
24		181.0		Roots	1	0.002	1	1	0.002	
25		183.7	Offset	Roots	1	0.002	1	1	0.002	

Television Inspection Master Report

10/26/2009

8:36 AM

US Structure: 4848-408 954 N CRESTLINE ST Date Insp: 7/13/2009 Basin: W06A
 DS Structure: 4848-407 10015 W 9TH ST N Dir Televised: Upstream To Downstream

26	193.7		Roots	1	0.002	1	1	0.002
27	195.7		Roots	1	0.002	1	1	0.002
28	198.4		Roots	1	0.002	1	1	0.002
29	199.5		Crack-Radial	2	0.002	2	0	0.002
30	208.5		Roots	1	0.002	1	1	0.002
31	218.7		Sealed Off Wye	1	0.000	0	0	0.000
32	223.1		Crack-Horizontal	1	0.001	1	0	0.001
33	228.2		Broken Pipe	1	0.004	30	0	0.004
34	234.0		Crack-Horizontal	1	0.001	1	0	0.001
35	236.3	N	Break-In Conn	1	0.001	0	0	0.001
970 W 9TH ST N								
36	257.1		Sealed Off Wye	1	0.000	0	0	0.000
37	276.2		Sealed Off Wye	1	0.000	0	0	0.000
38	280.0	Invert / Offset Joint	Broken Pipe	4	0.030	78	0	0.030
Might possibly be a slight hump in the invert but should be OK to line.								
39	287.6	N	Break-In Conn	1	0.001	0	0	0.001
10015 W 9TH ST N								
40	294.8		4848-407 / DS Manhole	1	0.000	0	0	0.000
10015 W 9TH ST N								

Television Inspection Master Report

10/26/2009

8:36 AM

US Structure: 4848-407 10015 W 9TH ST N Date Insp: 7/9/2009 Basin: W06A
 DS Structure: 4848-405 10001 W 9TH ST N Dir Televised: Downstream To Upstream

Pipe Information

Shape: Round Length Status: Project No. : K-053
 Dia/Ht: 8 Material: VCP Index:
 Length: 80.0 Slope: 0.400 Surface: Rear Easement

Inspection Information

Crew: 692 Percent Full: Tape ID: DVD #0498
 Weather: Sunny Purpose: TV Existing Line Counter Start:

Obs. VTR

Obs. #	Counter	Distance	Location	Description	Rating	Obsrvd (gpm)	Est. (gpm)	Ratings		Remain (gpm)
								Struct	Clean	
1		0.0		DS Manhole 4848-405	1	0.000	0	0	0.000	
			10001 W 9TH ST N	(outside drop manhole)						
2		28.8	N	Break-In Conn	1	0.001	0	0	0.001	
			10001 W 9TH ST N							
3		58.5		Crack-Radial	1	0.001	1	0	0.001	
4		78.2		US Manhole 4848-407	1	0.000	0	0	0.000	

Good condition.

Television Inspection Master Report

10/26/2009

8:36 AM

US Structure: 4848-406 10001 W 9TH ST N Date Insp: 6/30/2009 Basin: W06A
 DS Structure: 4848-405 10001 W 9TH ST N Dir Televised: Upstream To Downstream

Pipe Information

Shape: Round Length Status: Project No. : K-053
 Dia/Ht: 8 Material: VCP Index:
 Length: 82.0 Slope: 0.400 Surface: Rear Easement

Inspection Information

Crew: 692 Percent Full: Tape ID: DVD #0498

Obs. #	VTR Counter	Distance	Location	Description	Rating	Obsrvd (gpm)	Ratings		Remain (gpm)	
							Est. (gpm)	Struct Clean		
1		0.0		US Manhole	1	0.000	0	0	0.000	
10001 W 9TH ST N										
2		3.0		Roots	1	0.002	1	1	0.002	
3		8.0	E	Wye Service	1	0.000	0	0	0.000	
985 N CHIPPER LN										
4		11.7		Roots	1	0.002	1	1	0.002	
5		17.5		Roots	1	0.002	1	1	0.002	
6		23.5		Roots	1	0.002	1	1	0.002	
7		29.7		Roots	1	0.002	1	1	0.002	
8		38.5		Roots	1	0.002	1	1	0.002	
9		55.1		Sealed Off Wye	1	0.000	0	0	0.000	
10		58.6		Crack-Radial	1	0.001	1	0	0.001	
11		63.0		Sealed Off Wye	1	0.000	0	0	0.000	
12		65.7	E	Break-In Conn	2	0.002	0	0	0.002	
977 N CHIIPPER / rough & jagged tap										
13		75.9		DS Manhole	1	0.000	0	0	0.000	
10001 W 9TH ST N										

Television Inspection Master Report

10/26/2009

8:36 AM

US Structure: 4848-404
DS Structure: 4848-403

961 N CHIPPER LN
943 N CHIPPER LN

Date Insp: 6/30/2009
Dir Televised: Upstream To Downstream

Basin: W06A

Pipe Information

Shape:	Round	Length Status:		Project No. :	K-053
Dia/Ht:	8	Material:	VCP	Index:	
Length:	240.0	Slope:	0.400	Surface:	

Inspection Information

Crew: 692 Tape ID: DVD #0498

Obs. #	VTR Counter	Distance	Location	Description	Rating	Obsrvd (gpm)	Ratings			Remain (gpm)
							Est. (gpm)	Struct	Clean	
1		0.0		4848-404 / US Manhole	1		0.000	0	0	0.000
2		48.4		Sealed Off Wye	1		0.000	0	0	0.000
3		51.1	E	Break-In Conn	1		0.001	0	0	0.001
957 N CHIPPER LN										
4		56.0		Crack-Radial	2		0.002	2	0	0.002
5		72.8		Sealed Off Wye	1		0.000	0	0	0.000
6		92.8	W	Break-In Conn	1		0.001	0	0	0.001
944 N VALLEYVIEW										
7		106.6	Joint	Offset	3		0.010	20	0	0.010
ROOTS & CRACK										
8		118.8		Roots	1		0.002	1	1	0.002
9		120.0	E	Break-In Conn	2		0.002	0	0	0.002
951 N CHIPPER LN										
10		121.9		Roots	1		0.002	1	1	0.002
11		127.9		Roots	1		0.002	1	1	0.002
12		130.9		Roots	1		0.002	1	1	0.002
13		135.3		Sealed Off Wye	1		0.000	0	0	0.000
14		136.3		Roots	3		0.008	5	8	0.008
CRACKS										
15		141.9		Offset Joint / Roots	1		0.002	1	1	0.002
16		146.1		Offset Joint / Roots	1		0.002	1	1	0.002
17		149.1		Roots	1		0.002	1	1	0.002
18		151.6		Roots	2		0.004	2	4	0.004
19		154.2		Roots	1		0.002	1	1	0.002
20		160.8		Roots	1		0.002	1	1	0.002
21		172.5		Sealed Off Wye	1		0.000	0	0	0.000
22		173.5	W	Break-In Conn	1		0.001	0	0	0.001
932 N VALLEYVIEW LN										
23		184.3		Roots	1		0.002	1	1	0.002
24		199.3		Roots	1		0.002	1	1	0.002



Wichita Water Utilities – Connect With Us!

Television Inspection Master Report

10/26/2009

8:36 AM

US Structure: 4848-404
 DS Structure: 4848-403

961 N CHIPPER LN
 943 N CHIPPER LN

Date Insp: 6/30/2009 Basin: W06A
 Dir Televised: Upstream To Downstream

25	203.5		Roots	1	0.002	1	1	0.002
26	214.7		Roots	1	0.002	1	1	0.002
27	216.4	E	Break-In Conn	3	0.004	2	0	0.004
943 N CHIPPER LN								
28	218.3		Roots	1	0.002	1	1	0.002
29	218.7		Sealed Off Wye	1	0.000	0	0	0.000
30	222.2		Roots	1	0.002	1	1	0.002
31	228.6		Roots	1	0.002	1	1	0.002
32	239.2		4848-403 / DS Manhole	1	0.000	0	0	0.000



Television Inspection Master Report

10/26/2009

8:36 AM

US Structure: 4848-403 943 N CHIPPER LN Date Insp: 7/1/2009 Basin: W06A
 DS Structure: 4848-402 915 N CHIPPER LN Dir Televised: Upstream To Downstream

Pipe Information

Shape: Round Project No.: K-053 Dia: 8 Material: VCP Length: 355.0 Slope: 0.400

Inspection Information

Crew: 692 Tape ID: DVD #0498 Weather: Sunny Purpose: TV Existing Line

Obs. #	VTR Counter	Distance	Location	Description	Rating	Obsrvd (gpm)	Ratings			Remain (gpm)
							Est. (gpm)	Struct	Clean	
1		0.0		US Manhole 4848-403	1	0.000	0	0	0.000	
2		29.1		Sealed Off Wye	1	0.000	0	0	0.000	
3		33.3	W	Break-In Conn	1	0.001	0	0	0.001	
924 N VALLEYVIEW LN										
4		61.5	E	Wye Service	1	0.000	0	0	0.000	
935 N CHIPPER LN										
5		124.1		Sealed Off Wye	1	0.000	0	0	0.000	
6		128.3		Roots	1	0.002	1	1	0.002	
7		136.7		Roots	1	0.002	1	1	0.002	
8		138.6		Roots	1	0.002	1	1	0.002	
9		140.7	W	Break-In Conn	2	0.002	0	0	0.002	
914 N VALLEYVIEW LN										
10		143.7		Roots	1	0.002	1	1	0.002	
11		145.2	Roots	Sealed Off Wye	3	0.000	0	0	0.000	
12		146.5	E	Break-In Conn	2	0.002	0	0	0.002	
929 N CHIPPER LN										
13		169.0		Roots	1	0.002	1	1	0.002	
14		177.7		Roots	2	0.004	2	4	0.004	
15		184.0		Roots	1	0.002	1	1	0.002	
16		187.1		Roots	1	0.002	1	1	0.002	
17		193.2		Roots	1	0.002	1	1	0.002	
18		218.3		Sealed Off Wye	1	0.000	0	0	0.000	
19		219.9	E	Wye Service	1	0.000	0	0	0.000	
921 N CHIPPER LN										
20		228.0	W	Break-In Conn	2	0.002	0	0	0.002	
10000 W BRICH LN / PVC										
21		315.6		Crack-Horizontal	1	0.001	1	0	0.001	
22		335.0		Sealed Off Wye	1	0.000	0	0	0.000	
23		337.1		Sealed Off Wye	1	0.000	0	0	0.000	
28		361.4		4848-402 / DS Manhole					(invert of manhole may be a little high)	

SAGS:

24	337.2	Sag	4
25	339.9	Sag	4
26	348.9	Sag	1
27	349.2	Sag	1

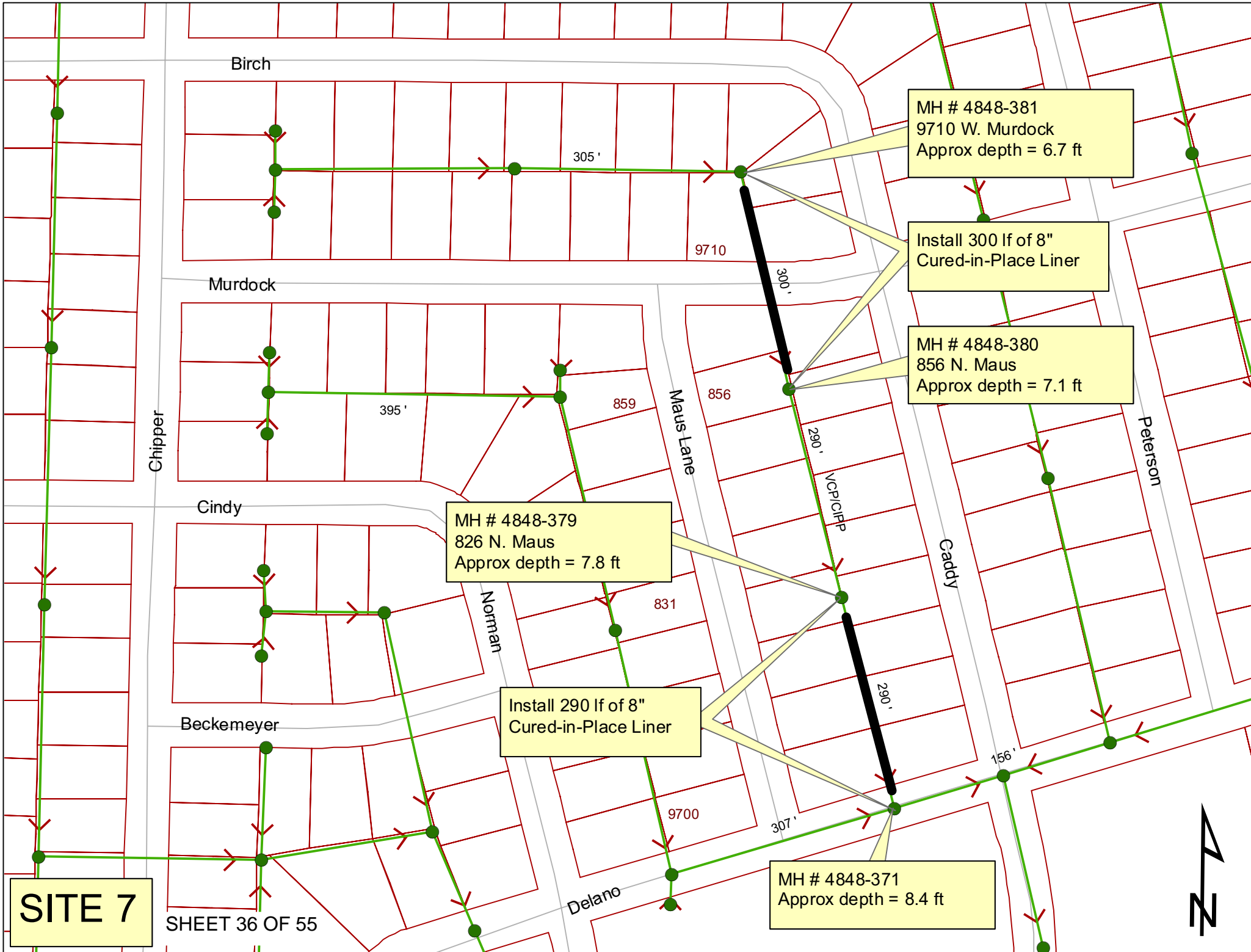

Birch

Murdock

Cindy

Beckemeyer

Chipper

Norman

Maus Lane

Delano

Gaddy

Peterson

MH # 4848-381
9710 W. Murdock
Approx depth = 6.7 ft

Install 300 lf of 8"
Cured-in-Place Liner

MH # 4848-380
856 N. Maus
Approx depth = 7.1 ft

MH # 4848-379
826 N. Maus
Approx depth = 7.8 ft

Install 290 lf of 8"
Cured-in-Place Liner

MH # 4848-371
Approx depth = 8.4 ft

305'

9710

300'

395'

859

856

290'
VCP/CRP

831

290'

156'

307'

9700

SITE 7

SHEET 36 OF 55





Video Inspection Master Report

2/24/2012

9:10 AM

US Structure: 4848-381 9710 W MURDOCK ST Date Insp: 7/8/2009 Basin: W06A
 DS Structure: 4848-380 856 N MAUS LN Dir Televised: Upstream To Downstream

Pipe Information

Shape: Round Length Status: Project No. : K-053
 Dia/Ht: 8 Material: VCP Index:
 Length: 300.0 Slope: 0.400 DVD #0500

Obs. #	VTR Counter	Distance	Location	Description	Rating	Obsrvd (gpm)	Ratings			Remain (gpm)
							Est. (gpm)	Struct	Clean	
1		0.6		US Manhole	1	0.000	0	0	0.000	
2		1.0	Joint	Offset	4	0.030	60	0	0.030	
3		12.1		Wye Service / seal broken - roots	2	0.000	0	0	0.000	
4		16.4	Joint	Offset	5	0.060	100	0	0.060	
5		28.6		Roots	2	0.004	2	4	0.004	
6		34.7		Roots	3	0.008	5	8	0.008	
7		36.1	9631 W BIRCH / heavy roots inside	Break-In Conn	3	0.004	2	0	0.004	
8		43.8		Roots	2	0.004	2	4	0.004	
9		46.8		Roots	3	0.008	5	8	0.008	
10		49.8		Roots	2	0.004	2	4	0.004	
11		52.9		Roots	2	0.004	2	4	0.004	
12		55.9		Roots	2	0.004	2	4	0.004	
13		71.1		Roots	2	0.004	2	4	0.004	
14		83.0	Joint	Offset	2	0.000	0	0	0.000	
15		92.2	Joint	Offset	3	0.010	20	0	0.010	
16		93.8	9625 W BIRCH	Wye Service	1	0.000	0	0	0.000	
17		95.3	Joint	Offset	2	0.000	0	0	0.000	
18		98.4	Joint	Offset	3	0.010	20	0	0.010	
19		104.3		Roots	2	0.004	2	4	0.004	
20		122.6		Roots	2	0.004	2	4	0.004	
21		128.7		Roots	2	0.004	2	4	0.004	
22		168.1	Joint	Offset	3	0.010	20	0	0.010	
23		186.3	Joint	Offset	3	0.010	20	0	0.010	
24		189.2	Joint	Offset	2	0.000	0	0	0.000	
25		204.4	Joint	Offset	3	0.010	20	0	0.010	
26		212.1		Wye Service	1	0.000	0	0	0.000	
27		212.4	9711 W MURDOCK	Break-In Conn	4	0.008	60	0	0.008	
28		215.4		Wye Service	1	0.000	0	0	0.000	
29		235.2		Roots	2	0.004	2	4	0.004	
30		237.4	861 N CADDY	Break-In Conn / protruding	3	0.004	2	0	0.004	
31		247.1		Roots	3	0.008	5	8	0.008	
32		256.7		Crack-Radial	3	0.004	5	0	0.004	



Video Inspection Master Report

2/24/2012

9:10 AM

US Structure: 4848-381 **9710 W MURDOCK ST** **Date Insp:** 7/8/2009 **Basin:** W06A
DS Structure: 4848-380 **856 N MAUS LN** **Dir Televised:** Upstream To Downstream

33	262.5		Roots	2	0.004	2	4	0.004
34	271.3	Joint	Offset	3	0.010	20	0	0.010
35	271.3		Roots	2	0.004	2	4	0.004
36	277.5		Roots	2	0.004	2	4	0.004
37	280.5		Roots	3	0.008	5	8	0.008
38	282.4	856 N MAUS	Break-In Conn / protruding	4	0.008	60	0	0.008
39	283.7		Roots	2	0.004	2	4	0.004
40	285.3		Wye Service	1	0.000	0	0	0.000
41	286.7		Roots	2	0.004	2	4	0.004
42	288.3		Wye Service	1	0.000	0	0	0.000
43	289.8		Crack-Radial / invert	4	0.008	10	0	0.008
44	295.8		Roots	2	0.004	2	4	0.004
45	299.0		Roots	2	0.004	2	4	0.004
46	303.0		4848-380 DS Manhole	1	0.000	0	0	0.000



Video Inspection Master Report

5/1/2012

9:13 AM

US Structure: 4848-379 826 N MAUS LN Date Insp: 7/8/2009 Basin: W06A
 DS Structure: 4848-371 9600 W DELANO ST Dir Televised: Upstream To Downstream

Pipe Information

Project No. : K-053 Dia: 8 Material: VCP Length: 290.0 Slope: 0.400 DVD #0500

Obs. #	VTR Counter	Distance	Location	Description	Rating	Obsrvd (gpm)	Ratings			Remain (gpm)
							Est. (gpm)	Struct	Clean	
1		0.0		4848-379 US Manhole	1					
2		10.8		Wye Service	1	0.000	0	0	0.000	
3		12.5		Other	2	0.000	0	0	0.000	
4		14.0	825 N CADDY	Break-In Conn	1	0.001	0	0	0.001	
5		14.8		Other	1	0.000	0	0	0.000	
6		24.6		Roots	2	0.004	2	4	0.004	
7		36.3		Other	1	0.000	0	0	0.000	
8		38.9		Other	1	0.000	0	0	0.000	
9		49.3	Joint	Offset	3	0.010	20	0	0.010	
10		85.5		Wye Service	1	0.000	0	0	0.000	
11		85.5	Joint	Offset	2	0.000	0	0	0.000	
12		86.5	817 N CADDY	Wye Service	2	0.000	0	0	0.000	
13		88.6	Joint	Offset	2	0.000	0	0	0.000	
14		96.1	818 N MAUS	Break-In Conn	1	0.001	0	0	0.001	
15		122.1	Joint	Offset	2	0.000	0	0	0.000	
16		140.7	810 N MAUS	Break-In Conn	1	0.001	0	0	0.001	
17		153.7	811 N CADDY	Break-In Conn	3	0.004	needs repair			
18		160.1		Wye Service	1	0.000	0	0	0.000	
19		162.4		Wye Service	1	0.000	0	0	0.000	
20		173.1	Joint	Offset	2	0.000	0	0	0.000	
21		179.1	Joint	Offset	2	0.000	0	0	0.000	
22		229.1		Wye Service	1	0.000	0	0	0.000	
23		232.7	9600 W DELANO	Wye Service	1	0.000	0	0	0.000	
24		244.1	800 N MAUS	Break-In Conn	4	0.008	needs repair			
25		276.3	Joint	Offset	4	0.030	60	0	0.030	
26		277.5		Broken Pipe	3	0.010	60	0	0.010	
27		290.7		4848-371 DS Manhole	1	0.000	0	0	0.000	