

**Riverside Area**  
Sanitary Sewer Improvements  
Sewer Reconstruction / Phase 1  
OCA 624103 / 468-84839

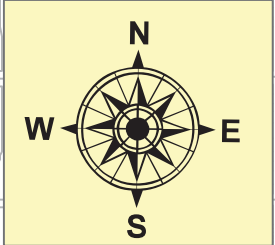
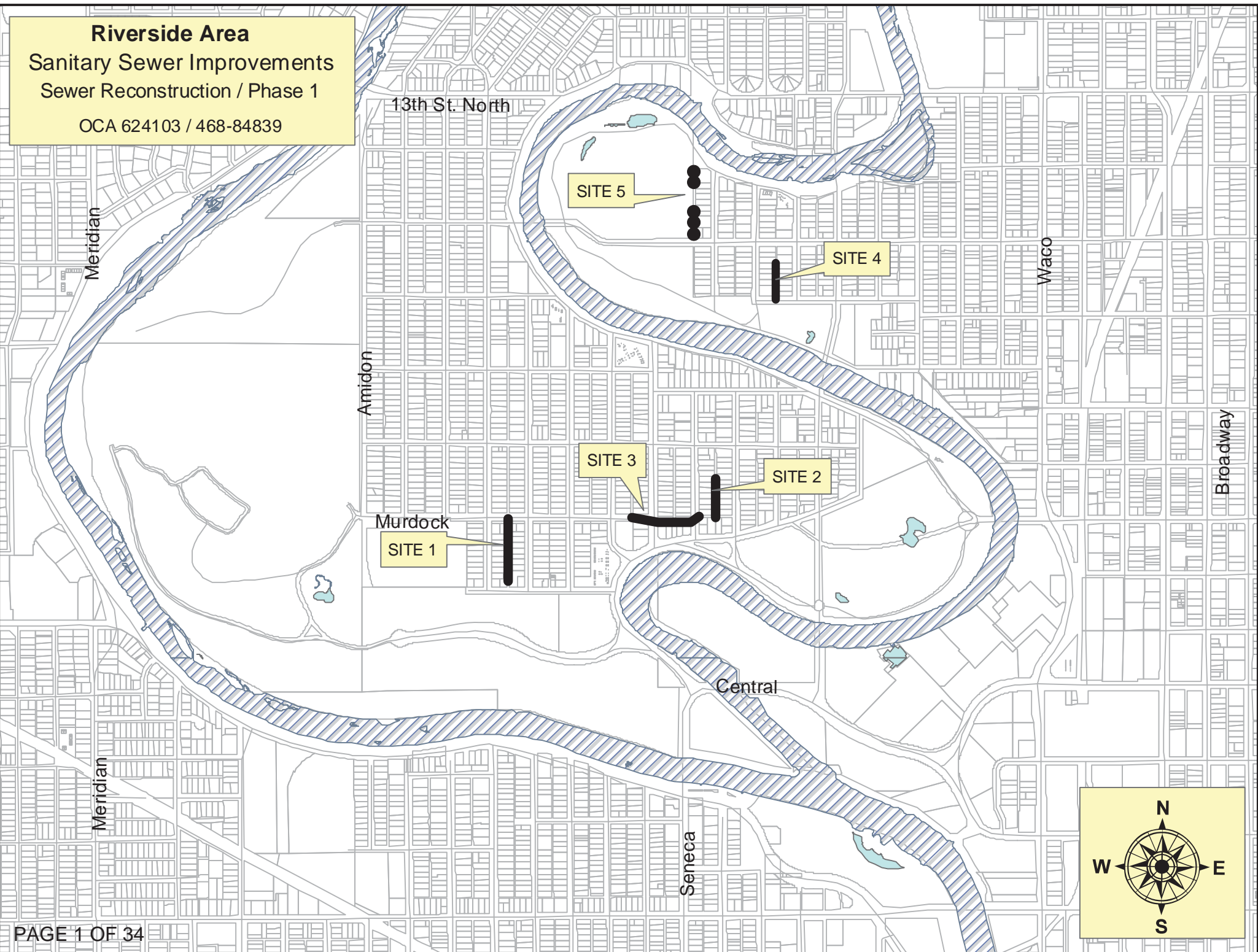

**Bid Items by Site Reference**

Riverside Area Sanitary Sewer Improvements Phase 1

<b><u>Item</u></b>	<b><u>Site 1</u></b>	<b><u>Site 2</u></b>	<b><u>Site 3</u></b>	<b><u>Site 4</u></b>	<b><u>Site 5</u></b>	<b><u>Totals</u></b>	
<b><u>LUMP SUM QUANTITIES:</u></b>							
Pipe, SS 8"	583	336		325		1244	lf
Pipe, SS 15"			623			623	lf
Pipe Removed (8")	583	336		325		1244	lf
Pipe Removed (15")			623			623	lf
Pipe Abandoned in Place					1	1	LS
Observation Hole Removed					2	2	ea
MH Frame & Cover, Replaced					3	3	ea
MH, Shallow SS (4')	1			2		3	ea
MH, Standard SS (4')	1					1	ea
MH, Standard SS (4') (Lined)			4			4	ea
MH Removed	3		4	2		9	ea
MH Bench & Invert, Removed & Replaced		1				1	ea
Fill, Flowable	42		321			363	lf
Pavement &/or Curb/Gutter Remov & Repl	25		248	13		286	lf
Concrete Sidewalk Removed & Replaced	5		8	4		17	lf
Concrete Approach Removed & Replaced	12		11	15		38	lf
AC Pavement Replaced (Permanent)			35			35	lf
Concrete Encasement (15"), Reinforced			20			20	lf
Concrete Encasement Removed (15")			20			20	lf
Site Clearing						1	LS
Site Restoration						1	LS
<b><u>MEASURED QUANTITIES:</u></b>							
Sewer Service Reconnection (4")	20	12	5	11		48	ea
Sewer Service Reconnection (6")	2					2	ea
BMP, Silt Fence	20					20	lf
BMP, Erosion Control Mat			16			16	sy
BMP, Back of Curb Protection			20			20	lf
BMP, Curb Inlet Protection	2		1	1		4	ea