

**COLLEGE HILL AREA**  
**SANITARY SEWER IMPROVEMENTS, PHASE A (CIPP)**  
**OCA # 624104 / 468-84836b**  
 ( North of Kellogg, East of Hillside )

| <u>SITE NO.</u>     | <u>GENERAL LOCATION</u>  | <u>PIPE SIZE</u> | <u>UPSTREAM MANHOLE</u> | <u>DOWNSTREAM MANHOLE</u> | <u>UPSTREAM INVERT ELEVATION</u> | <u>DOWNSTREAM INVERT ELEVATION</u> | <u>LENGTH (FT.)</u> |
|---------------------|--|------------------|-------------------------|---------------------------|----------------------------------|------------------------------------|---------------------|
| 1                   | Easement east of Rutan, from north of Mildred to south of Mildred  | 8"               | 5747-646                | 5747-644                  | 1332.93                          | 1329.02                            | 275                 |
| 2                   | Easement north of Mildred, from Clifton to west of Rutan   | 8"               | 5747-639                | 5747-637                  | 1340.63                          | 1332.18                            | 282                 |
|                     |  | 8"               | 5747-637                | 5747-635                  | 1332.18                          | 1328.65                            | 342                 |
|                     |  | 8"               | 5747-635                | 5747-633                  | 1328.65                          | 1326.41                            | 183                 |
| 3                   | Easement between Holyoke and Rutan, north of 1st Street  | 8"               | 5747-630                | 5747-065                  | 1322.75                          | 1320.58                            | 180                 |
| 4                   | Easement east of Hillside, from Chatfield to south of Central  | 8"               | 5747-692                | 5747-690                  | 1337.92                          | 1335.81                            | 302                 |
|                     |  | 8"               | 5747-690                | 5747-688                  | 1335.81                          | 1334.40                            | 202                 |
|                     |  | 8"               | 5747-688                | 5747-686                  | 1334.40                          | 1332.65                            | 250                 |
| 5                   | Easements between Lewis and Kellogg, from west of Bluff to east of Bluff   | 8"               | 5747-268                | 5747-266                  | 164.59                           | 164.30                             | 160                 |
|                     |  | 8"               | 5747-266                | 5747-265                  | 164.30                           | 164.06                             | 79                  |
|                     |  | 8"               | 5747-265                | 5747-263                  | 164.06                           | 163.31                             | 235                 |
| 6                   | Easement between Quentin & Roosevelt, south of 1st Street  | 8"               | 5747-146                | 5747-145                  | 1353.50                          | 1350.45                            | 198                 |
| 7                   | Easement between Terrace & Crestway, south of Central  | 8"               | 5747-057                | 5747-056                  | 1367.16                          | 1366.94                            | 235                 |
| 8                   | Easement between Terrace & Crestway, from 3rd Street to 2nd Street<br>(Interim manhole abandoned by CIPP sleeve) | 8"               | 5747-055                | 5747-054                  | 179.31                           | 179.17                             | 129                 |
|                     |  | 8"               | 5747-053                | <del>5747-052</del>       | 178.98                           | <del>178.76</del>                  | 203                 |
|                     |  | 8"               | <del>5747-052</del>     | 5747-051                  | <del>178.76</del>                | 178.53                             | 232                 |
| 9                   | Easement between Clifton & Circle Drive, south of Oakland  | 8"               | 5747-370                | 5747-366                  | N/A                              | N/A                                | 171                 |
| Total Linear Feet = |  |                  |                         |                           |                                  |                                    | 3658                |

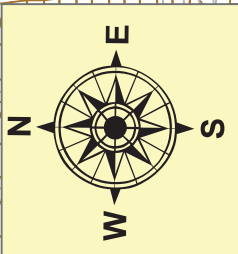
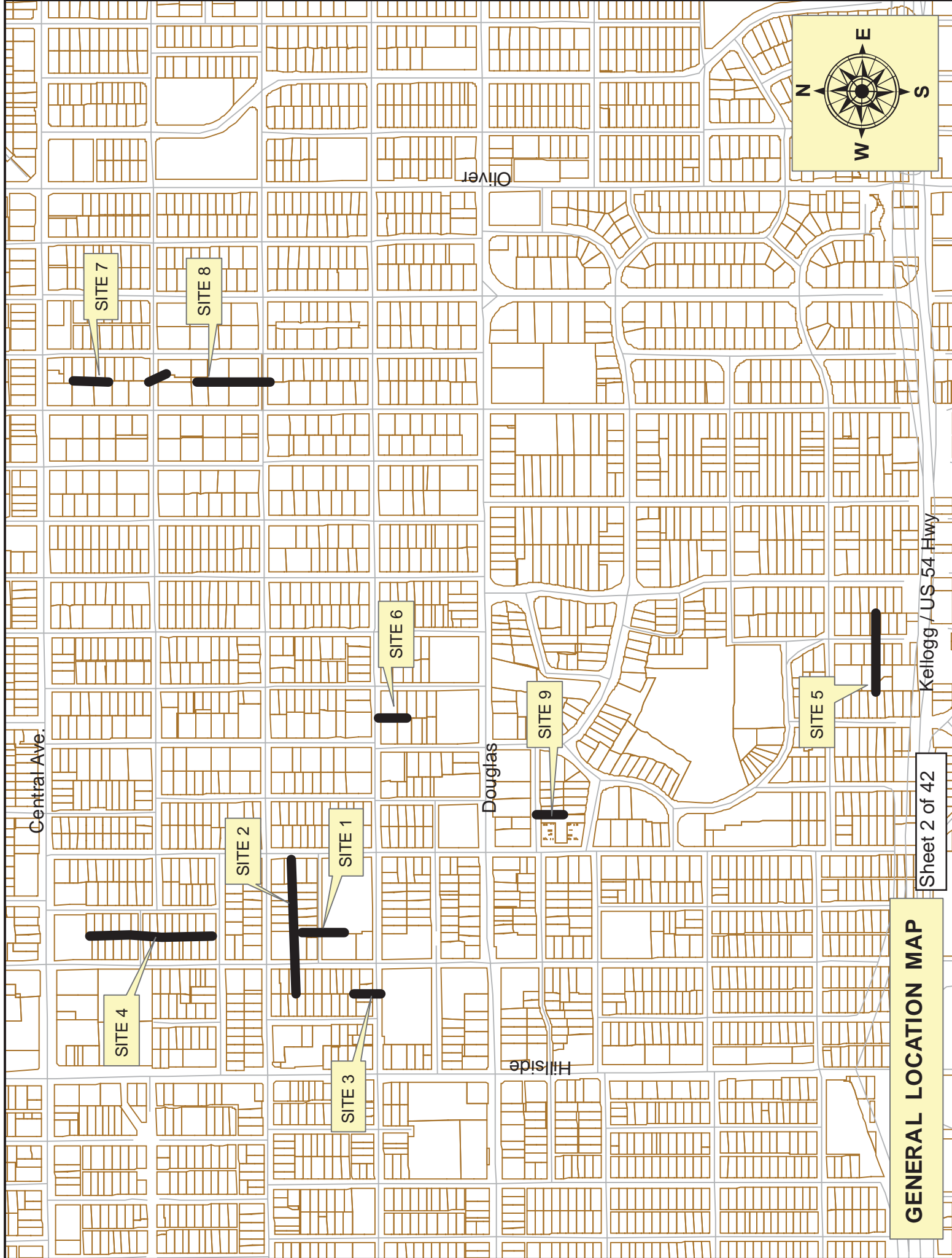

**GENERAL LOCATION MAP**