

STATE	PROJECT NO.	YEAR	SHEET NO.	TOTAL SHEETS
KANSAS	87 N-0519-01	2012	143	212

**MKEC**  
ENGINEERING  
CONSULTANTS, INC.

411 N. WEBB ROAD  
WICHITA, K.S. 67206  
316-684-9600

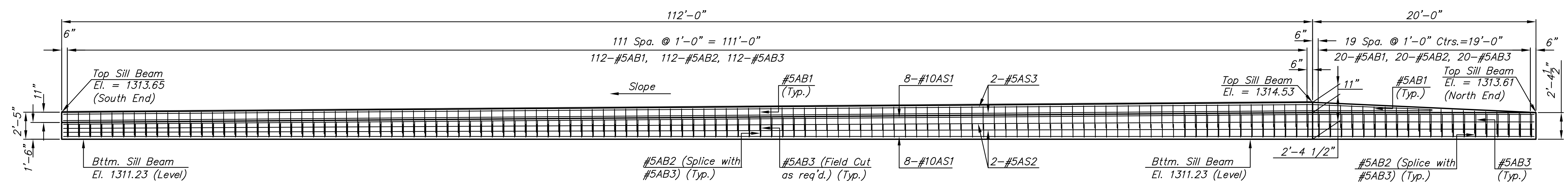
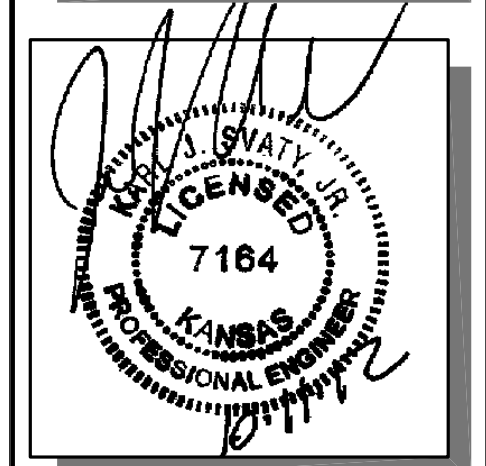

ELEVATION - SILL BEAM

NOTE: All sill beam elevations are based on existing plans and field survey. Contractor to verify proposed elevations for sill beam and GRS Abutment.

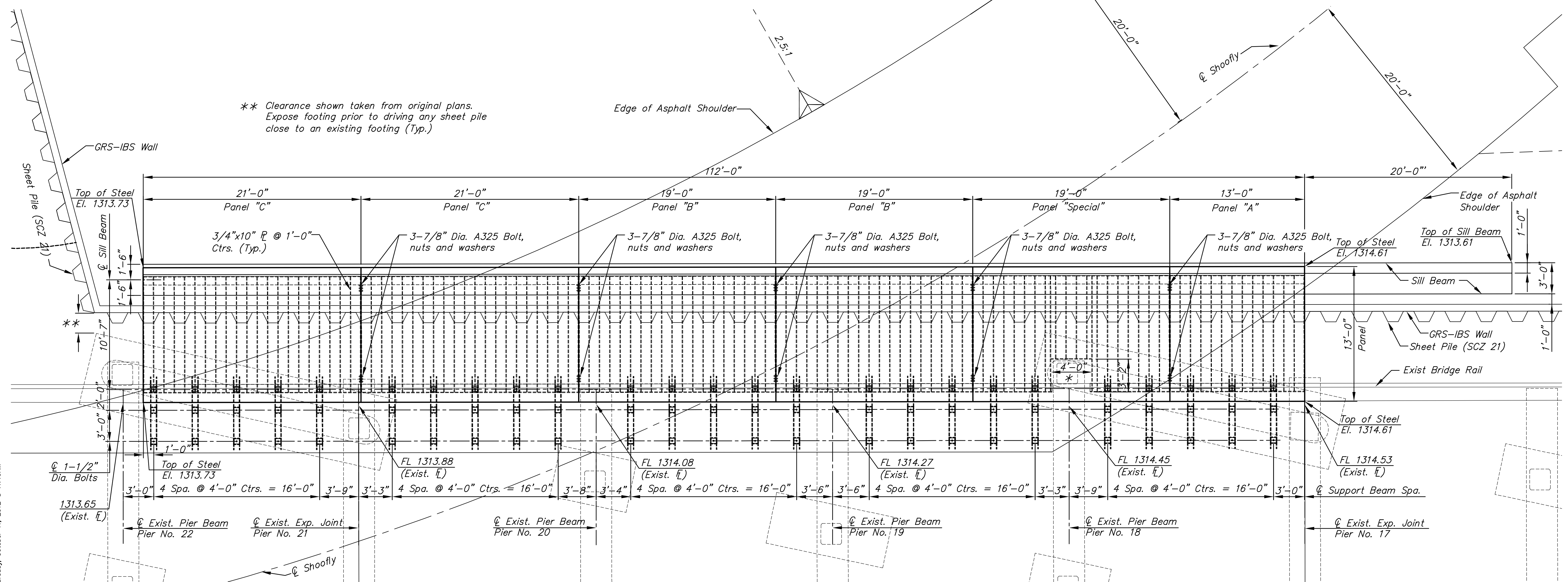
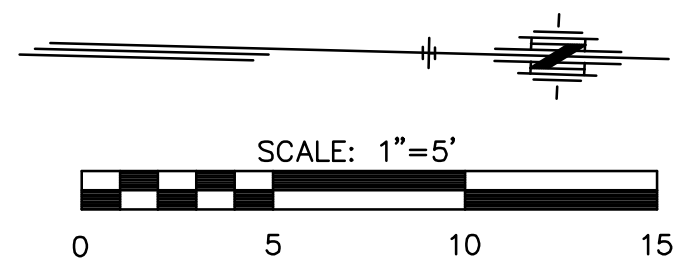

PLAN

\* Contractor to locate proposed steel framing to clear existing bridge pier.

**BROADWAY BRIDGE  
AT 34TH STREET SOUTH**

**SHOOFLY  
GRS-ABUTMENT  
PLAN**

SHEET TITLE

472-84830

PROJECT NUMBER

DESIGN BY: KJS

DRAWN BY: DPG

CHECKED BY: KJS

ISSUED: October 9, 2012

REVISED:

SHEET NO.  
**143 of 212**

PLOTED: Thursday, October 11, 2012 @ 11:16AM

J:\Civil\09081.dwg\09081-GRS Plan