

STATE	PROJECT NO.	YEAR	SHEET NO.	TOTAL SHEETS
KANSAS	87 N-0519-01	2012	147	212

MKEC
ENGINEERING
CONSULTANTS, INC.
411 N. WEBB ROAD
WICHITA, K.S. 67206
316-684-9600



BROADWAY BRIDGE AT 34TH STREET SOUTH

NO.	CONSTRUCTION ACTIVITY	TRAFFIC HANDLING	Flag Req'd.
1	The GRS abutment for the temporary shoofly will be constructed and the steel bridge to the existing South Broadway is installed	Traffic on existing South Broadway Bridge	Yes
2	The paving and the barrier for the temporary crossing will be placed. Pavement marking completed	Traffic on existing South Broadway Bridge	No
3	Demolition is begun on the North Section of the existing bridge. All bridge footings shown to be removed will also be demolished.	Traffic is now occupying the temporary shoofly	Yes
4	Excavate existing road embankment on the north of the bridge. Existing retaining wall to be removed		Yes
5	The fill material for the abutments will be placed and the piling for the abutments driven. Abutment construction		No
6	Pile driving for the piers, Pile Caps and pier walls are constructed		No
7	Pier Beam construction is completed		Yes
8	The structural steel to the midspan field splice will be placed on the north and south piers. (20 pieces)		Yes
9	The center portion of the main span will be placed. This will require close coordination with the UPRR to ensure that girders may be placed and secured prior to the approach of a train. (10 pieces)		Yes
10	The deck stay-in-place and conventional forms for the deck are placed. Bridge deck reinforcing is placed.		Yes
11	Bridge deck is cast. Casting bridge and pedestrian railing.		No
12	Traffic is directed on the the new South Broadway Bridge.	Traffic is directed on the the new South Broadway Bridge.	No
13	Remove the south half of the old South Broadway Bridge, including piers and footing as shown in details		Yes
14	Excavate existing road embankment on the south side of the old bridge		Yes
15	Remove shoofly detour, abutment and embankment		Yes

Definition of Flagging Not Req'd. -
Construction operations that occur off of UPRR Right-of-way.
Construction activities occurring outside of the fouling distance as shown here where if equipment fails it will not result in fouling of the track.

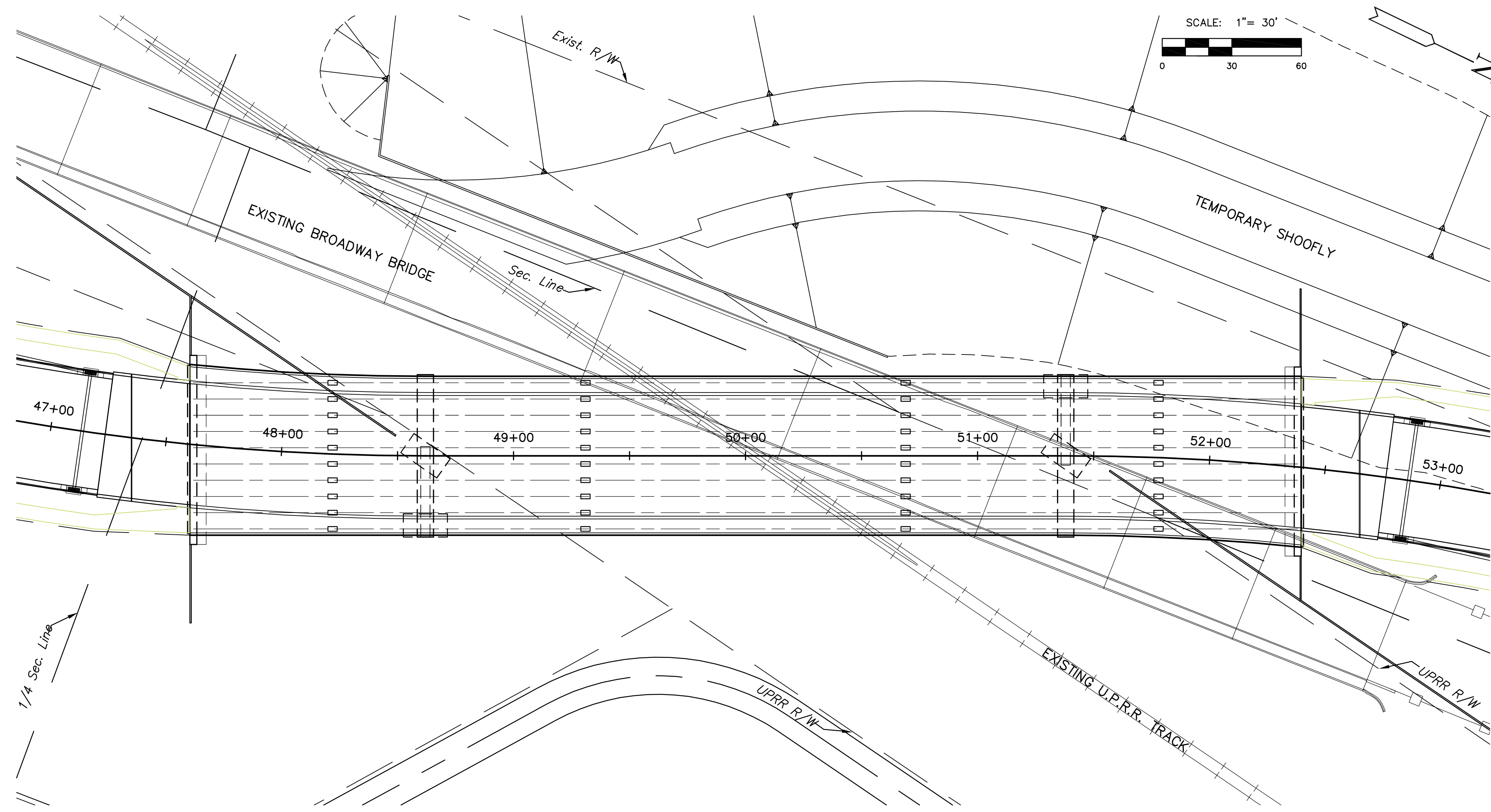

PLAN

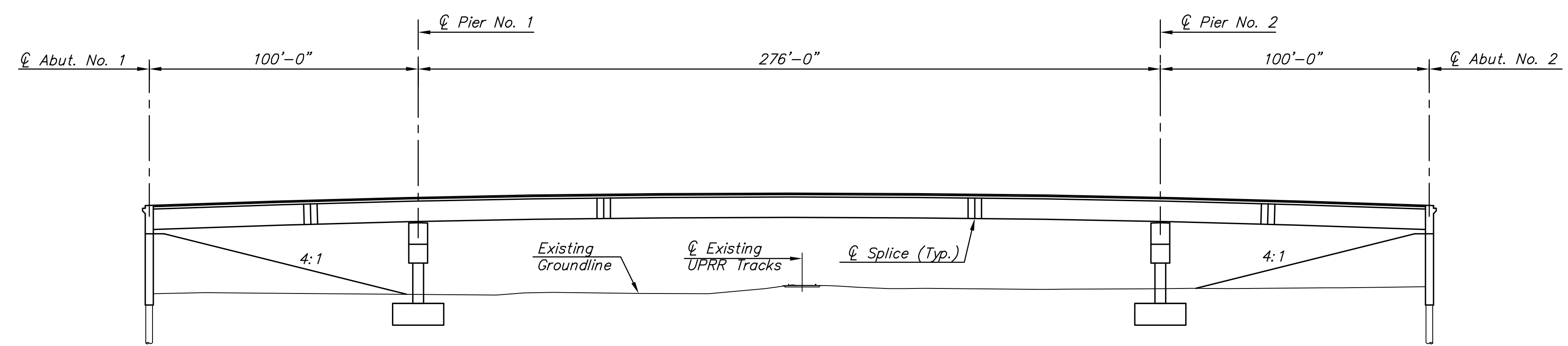

PROPOSED BRIDGE ERECTION SCHEME

CONSTRUCTION SEQUENCE NOTE:
The various bridge elements, piers, abutments, girders, etc., have been arranged in the design to allow most construction without the need to place temporary supports within railroad right-of-way. There will be the need to place construction equipment on the right-of-way for bridge erection. This is only a proposed construction method. Other methods may be proposed that require additional temporary supports on the UPRR right-of-way. These will be addressed by the contractor for the project prior to construction.

PLOTTED: Thursday, October 11, 2012 @ 11:18AM

J:\Civil\09081\dwg\BRIDGE\09081_SEQ

BRIDGE CONSTRUCTION SEQUENCE

SHEET TITLE	
PROJECT NUMBER	472-84830

DESIGN BY	KJS
DRAWN BY	DPG
CHECKED BY	JAG

ISSUED	October 9, 2012
REVISED	

SHEET NO.
147 of 212