

STATE	PROJECT NO.	YEAR	SHEET NO.	TOTAL SHEETS
KANSAS	87 N-0519-01	2012	153	212

MKEC
ENGINEERING
CONSULTANTS, INC.
411 N. WEBB ROAD
WICHITA, K.S. 67206
316-684-9600

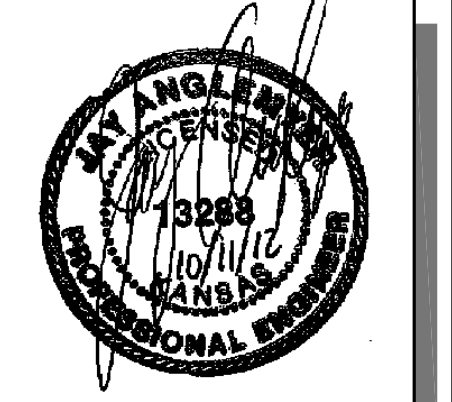

BROADWAY BRIDGE AT 34TH STREET SOUTH

TRAFFIC CONTROL PLAN SHOOFLY DETOUR PHASE 3
SHEET TITLE
472-84830
PROJECT NUMBER

JRA
DESIGN BY
WNJ
DRAWN BY
JRA
CHECKED BY

ISSUED
October 9, 2012

REVIS

SHEET NO.
153 of 212

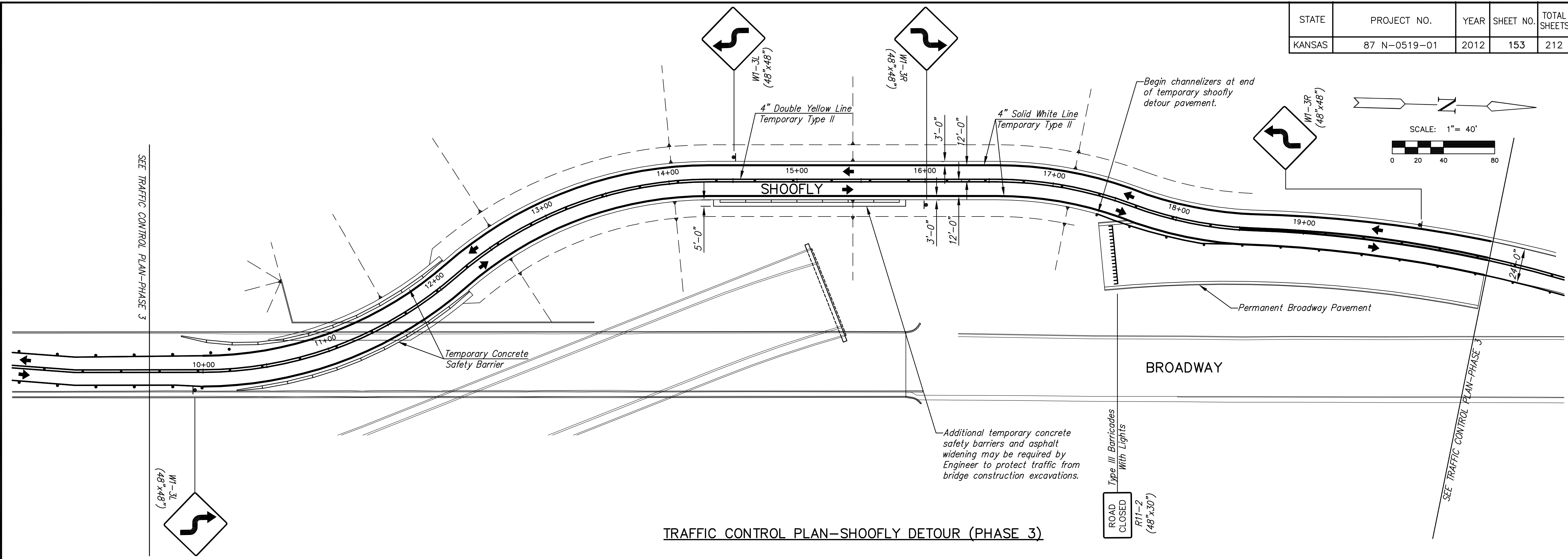

TRAFFIC CONTROL PLAN-SHOOFLY DETOUR (PHASE 3)

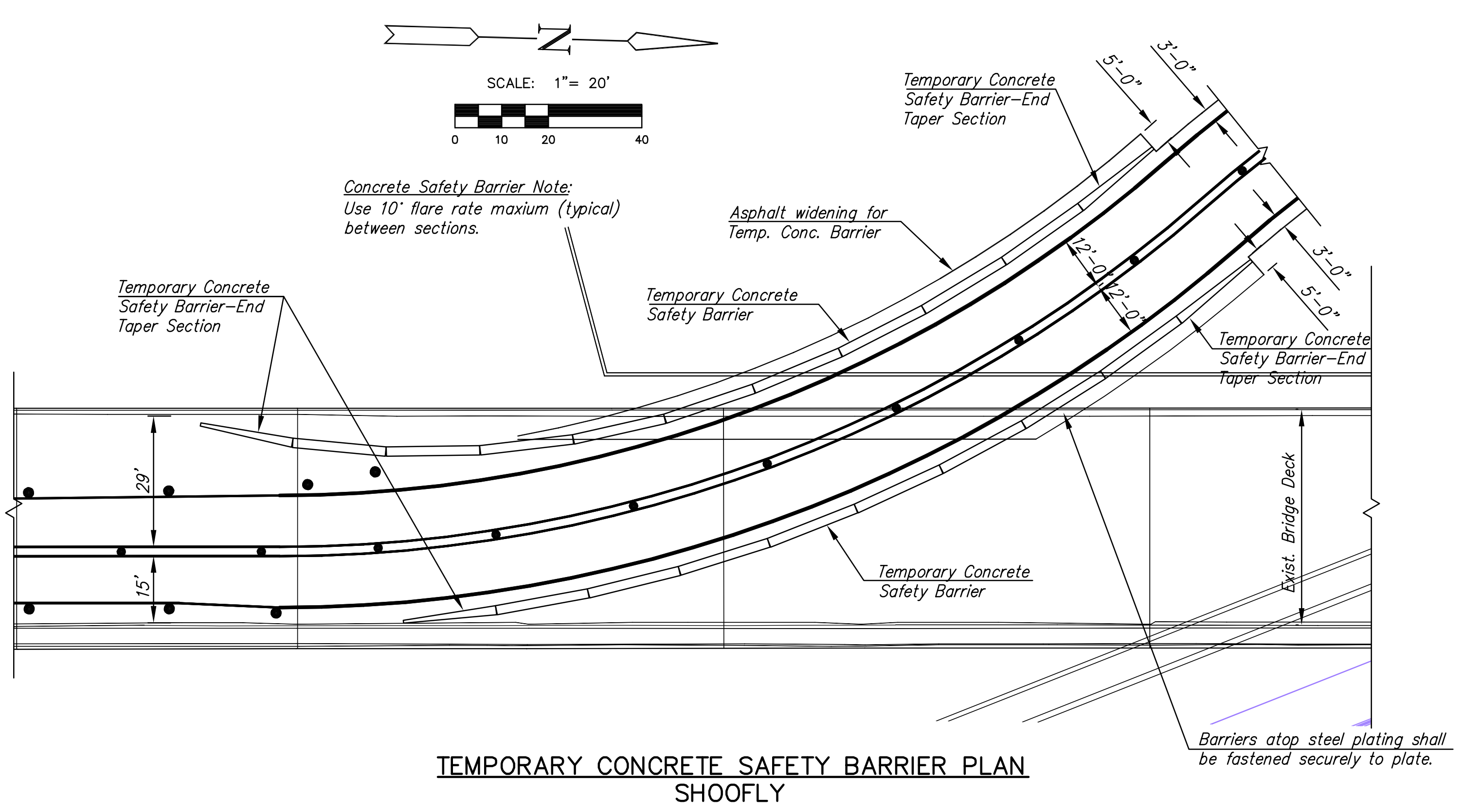

TEMPORARY CONCRETE SAFETY BARRIER PLAN SHOOFLY

Notes:
During construction of the shoofly detour, the contractor shall utilize temporary concrete safety barriers to protect traffic at any time existing bridge is removed.
Temporary Concrete Safety Barriers shall be fastened to surface in accordance with these plans.
Type II temporary pavement markings shall be used on temporary shoofly detour pavement.

- LEGEND**
- Type III Barricades with lights
 - Mount On Type III Barricade
 - One Post Sign
 - Two Post Sign
 - Traffic Flow
 - Work Space
 - Channelizing Device, See TE702
 - Temporary Asphalt Pavement

PLOTTED: Thursday, October 11, 2012 @ 11:24AM

J:\Civil\09081.dwg\Traffic\09081-T1