

Sta. 16+00.0 SWS Line No. 1A=
 @ Parkdale Cir. Sta. 15+48.24, 31.17' Lt.
 Std. Type 1A Curb Inlet
 L=10'-0", W=4'-0"
 Top Elev.=1353.50

Install 113 L.F.
 Excavatable Flowable
 Fill to Elev. 1351.7

Sta. 17+24.2 SWS Line No. 1A=
 @ Parkdale Cir. Sta. 16+72.40, 30.90' Lt.
 Const. Std. Type 1A Curb Inlet
 L=10'-0", W=4'-0"
 Top Elev.=1353.50
 Install 61.8 L.F. 18" RCP (E)
 See Sheet No. 14.

COORDINATE LIST		
POINT	NORTH	EAST
7103	25,751.3346	17,924.4636
7106	25,875.4727	17,922.2292
7107	25,875.4493	17,924.2357
7108	25,876.6077	17,982.0296
7109	25,876.7154	17,984.0300

7103 = COORDINATE POINT NO.
 SEE SHEET NO. 4 FOR PLAT COORDINATES

Install 58 L.F.
 Excavatable Flowable
 Fill to Elev. 1351.7

Prop. Top Valve Box Elev.=1353.7
 Prop. FH Bury Line Elev.=1353.7
 Prop. FH Bury Line Elev.=1353.7

Sta. 17+86.0 SWS Line No. 1A=
 @ Parkdale Cir. Sta. 16+72.40, 30.90' Rt.
 Const. Std. Type 1A Curb Inlet
 L=10'-0", W=4'-0"
 Top Elev.=1353.50
 See Sheet No. 14.

Sta. 20+00.0 SWS Line No. 1B=
 Sta. 12+15.9 SWS Line No. 1=
 @ Parkdale Cir. Sta. 13+79.80, 31.17' Lt.
 Std. Type 1A Curb Inlet
 L=10'-0", W=4'-0"
 Top Elev.=1355.30

Install 58 L.F.
 Excavatable Flowable
 Fill to Elev. 1353.5

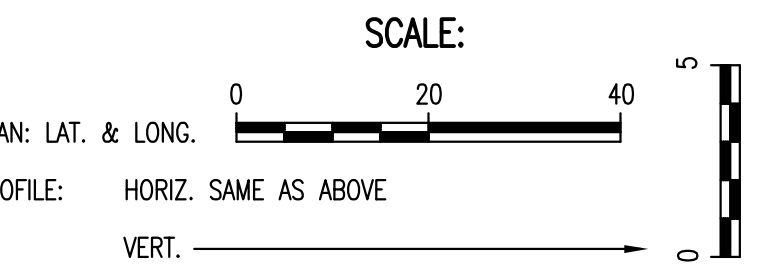

COORDINATE LIST		
POINT	NORTH	EAST
7104	25,599.2418	17,903.3052
7110	25,598.4491	17,905.1414
7111	25,575.3263	17,958.7035
7112	25,574.5336	17,960.5396

7104 = COORDINATE POINT NO.
 SEE SHEET NO. 4 FOR PLAT COORDINATES

Sta. 20+62.3 SWS Line No. 1B=
 @ Parkdale Cir. Sta. 13+79.80, 31.17' Rt.
 Const. Std. Type 1A Curb Inlet
 L=10'-0", W=4'-0"
 Top Elev.=1355.30
 See Sheet No. 14.

PLAN
 CHECKED
 BY
 DATE

PROFILE
 CHECKED
 BY
 DATE

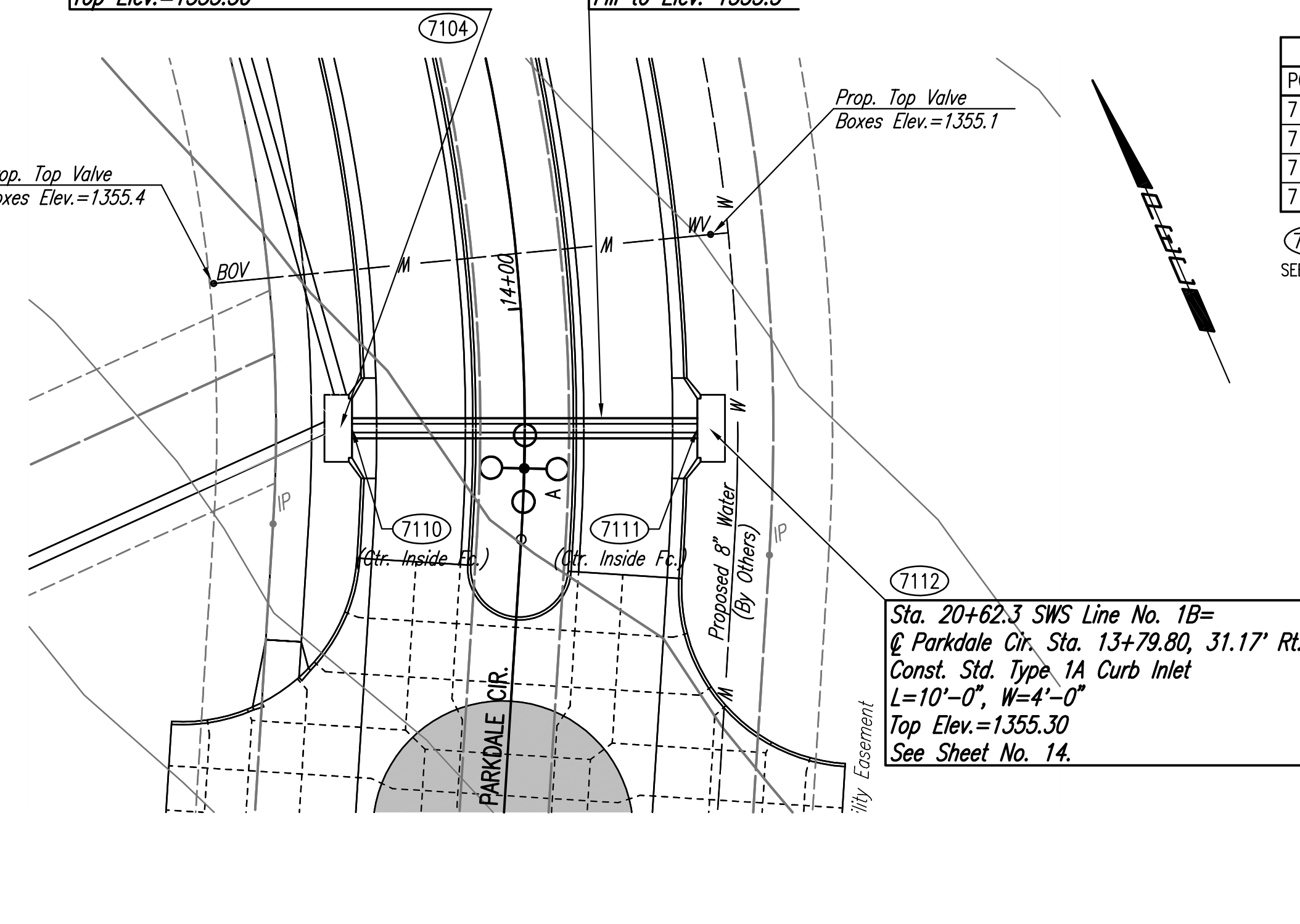
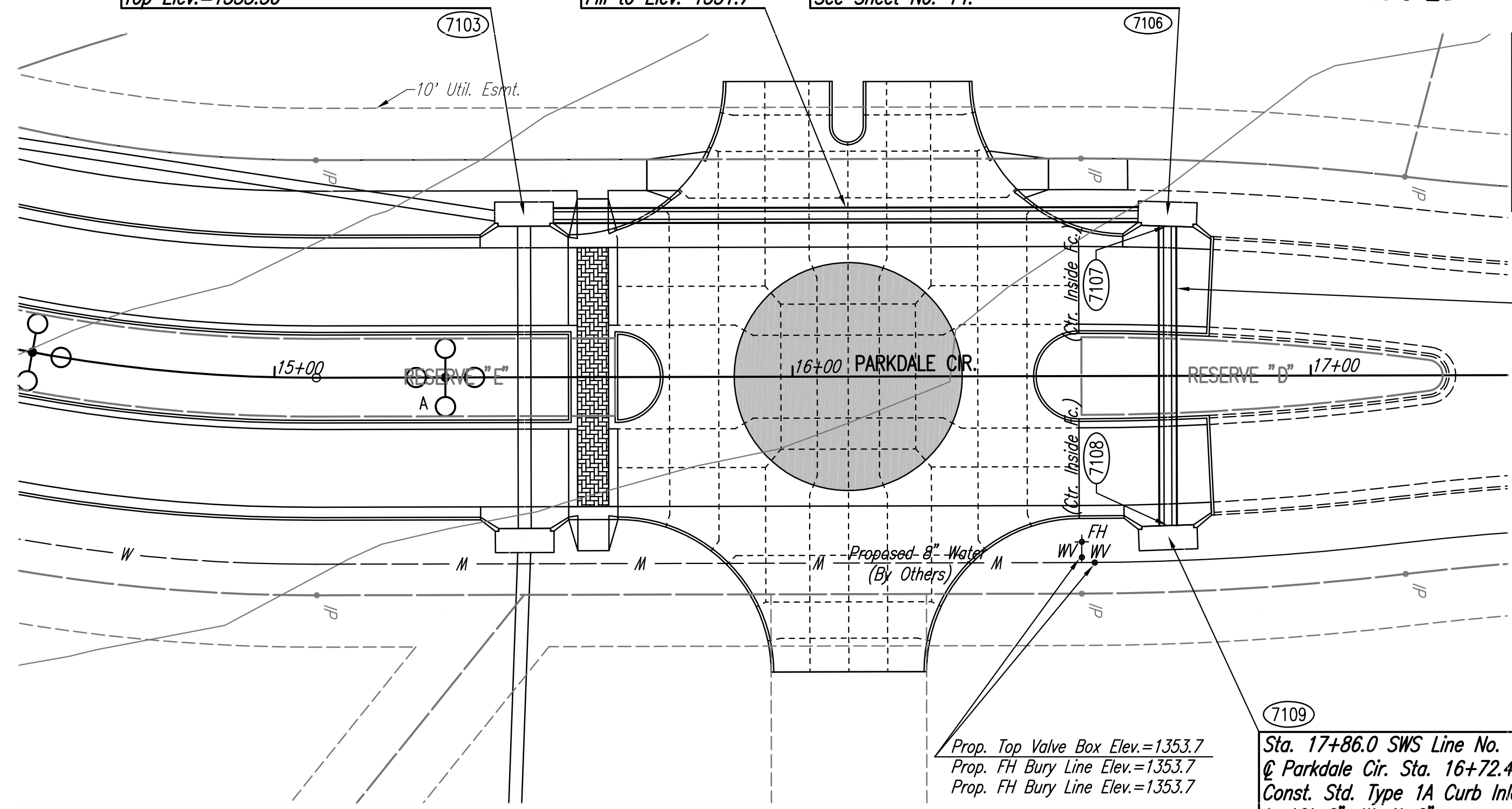

SWS LINE NO. 1A

SWS LINE NO. 1B

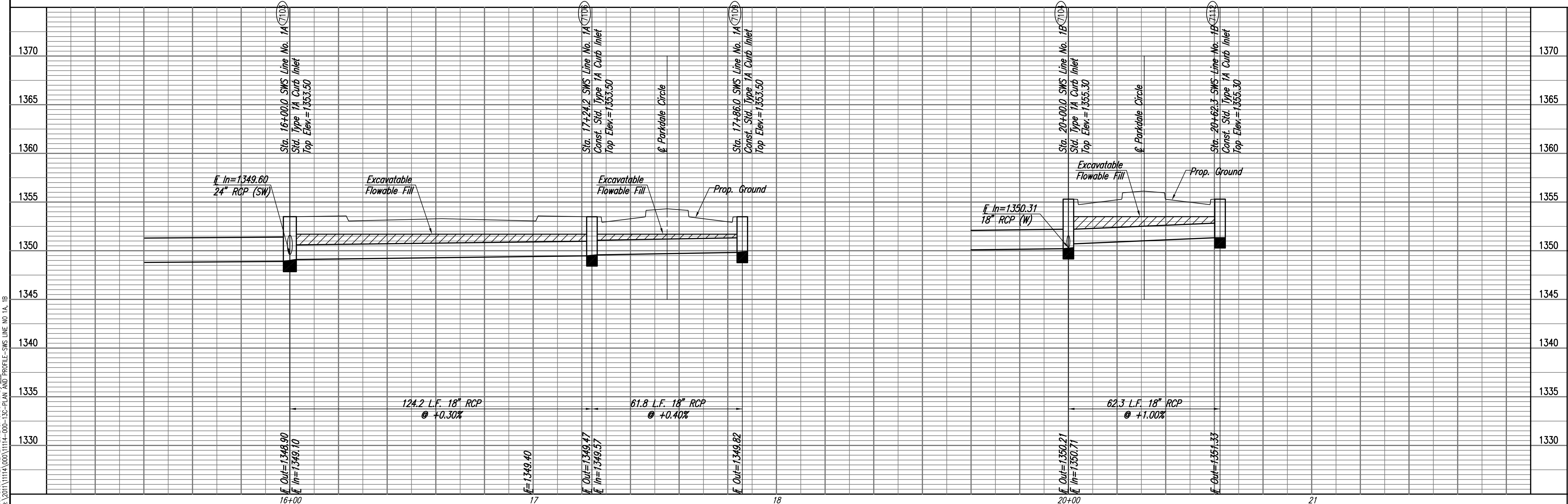

Saved 11-15-2012 2:08:49 PM by BUS
 Plot Scale 1:20 12-21-2012 5:48:30 PM by BUS
 G:\2011\1114\000\1114-000-13C-PLAN AND PROFILE-SWS LINE NO. 1A, 1B

NEWMARKET OFFICE 2ND
 PAVING AND INCIDENTAL DRAINAGE IMPROVEMENTS
SWS LINE NOS. 1A AND 1B

PROFESSIONAL ENGINEERING CONSULTANTS P.A.
 303 SOUTH TOPEKA WICHITA, KS 67202
 316-262-2691 www.pec.com
PEC
 Designed By BMM, JAG
 Drawn By BUS
 Job No. 35-11114
 Date January 2011
 GARY JANZEN, P.E. - CITY ENGINEER
 CITY OF WICHITA, PROJ. NO. 472-84690