

DETECTOR SUMMARY							
CAMERA NO.	DETECTION ZONE	MODE	SIZE (LxW)	PHASE CALLED	PHASE EXTENDED	DELAY/STRETCH TIMER	INITIAL SETTING (SEC.)
1	D4-1	Presence	60x6	4	4	-	-
1	D4-2	Pulse	6x6	4	4	S	2
1	D4-3	Pulse	6x6	4	4	S	2
1	D4-4	Pulse	6x6	4	4	S	2
1	D4-5	Presence	60x6	4	4	-	-
1	D4-6	Pulse	6x6	4	4	S	2
1	D4-7	Pulse	6x6	4	4	S	2
1	D4-8	Pulse	6x6	4	4	S	2
2	D2-1	Presence	60x6	2	2	-	-
2	D2-2	Pulse	6x6	2	2	S	2
2	D2-3	Pulse	6x6	2	2	S	2
2	D2-4	Pulse	6x6	2	2	S	2
2	D2-5	Presence	60x6	2	2	D	10
3	D8-1	Presence	60x6	8	8	-	-
3	D8-2	Pulse	6x6	8	8	S	2
3	D8-3	Pulse	6x6	8	8	S	2
3	D8-4	Pulse	6x6	8	8	S	2
3	D8-5	Presence	60x6	8	8	-	-
3	D8-6	Pulse	6x6	8	8	S	2
3	D8-7	Pulse	6x6	8	8	S	2
3	D8-8	Pulse	6x6	8	8	S	2
4	D6-1	Presence	60x6	6	6	-	-
4	D6-2	Presence	60x6	6	6	D	20

Detector Summary reflects initial operation.

FUNCTION	PHASE							
	1	2	3	4	5	6	7	8
VEHICLE RECALL	-	-	X	-	-	-	-	X
PED RECALL	-	-	-	-	-	-	-	-
RED LOCK	-	-	-	-	-	-	-	-
YELLOW LOCK	-	X	-	-	X	-	-	-
PERMIT	-	X	-	X	-	X	-	X
PED PHASES	-	X	-	X	-	-	-	X
LEAD PHASES	X	-	X	-	X	-	-	X
DUAL ENTRY	-	X	-	X	-	X	-	X
SEQUENTIAL TIMING	-	-	-	-	-	-	-	-
START-UP YELLOW	-	X	-	-	X	-	-	-
OVERLAP A	-	-	-	-	-	-	-	-
OVERLAP B	-	-	-	-	-	-	-	-
OVERLAP C	-	-	-	-	-	-	-	-
OVERLAP D	-	-	-	-	-	-	-	-
EXCLUSIVE	-	-	-	-	-	-	-	-
SIMULTANEOUS GAP	-	X	-	X	-	X	-	X

Function Table reflects initial operation.

FUNCTION	PHASE INTERVAL SETTINGS							
	1	2	3	4	5	6	7	8
MAX. I	-	19.5	-	44	-	19.5	-	44
MAX. II/HFDW	-	29.5	-	49	-	29.5	-	49
WALK	-	7	-	7	-	7	-	7
FLASH DW	-	16	-	16	-	16	-	16
MAX. INITIAL	-	-	-	-	-	-	-	-
MIN. GREEN	-	5	-	10	-	5	-	10
T B R	-	-	-	-	-	-	-	-
T T R	-	-	-	-	-	-	-	-
OBSERVE GAP	-	-	-	-	-	-	-	-
PASSAGE GAP	-	0	-	0	-	0	-	0
MIN. GAP	-	-	-	-	-	-	-	-
ADDED INITIAL	-	-	-	-	-	-	-	-
YELLOW	-	3.5	-	4	-	3.5	-	4
RED CLEAR	-	1	-	2	-	1	-	2
RED REVERT	-	-	-	-	-	-	-	-
WALK II	-	-	-	-	-	-	-	-

Phase Interval Settings reflect initial operation.

EQUIPMENT SPECIFICATIONS 2070 CONTROLLER

- A. Controller Unit: The 2070L controller supplied shall meet the requirements outlined in CalTrans TEES 2002 (latest revision), and the following requirements:
- The 2070L controller shall have a 19" EIA rack mountable chassis (mated to the 170 cabinet).
 - 2070-1B CPU module with RJ-45 Ethernet port.
 - 2070-2A CI field I/O module for compatibility with CalTrans style CI connector.
 - 2070-3B 8X40 front panel with LCD display.
 - 2070-4A 10 amp power supply.
 - 2070-7A asynchronous serial communications module (RS-232).
 - Any unused slot position shall have a cover plate.
- B. Conflict Monitor: The Conflict Monitor supplied shall be 2010 ECLIP conflict monitor.

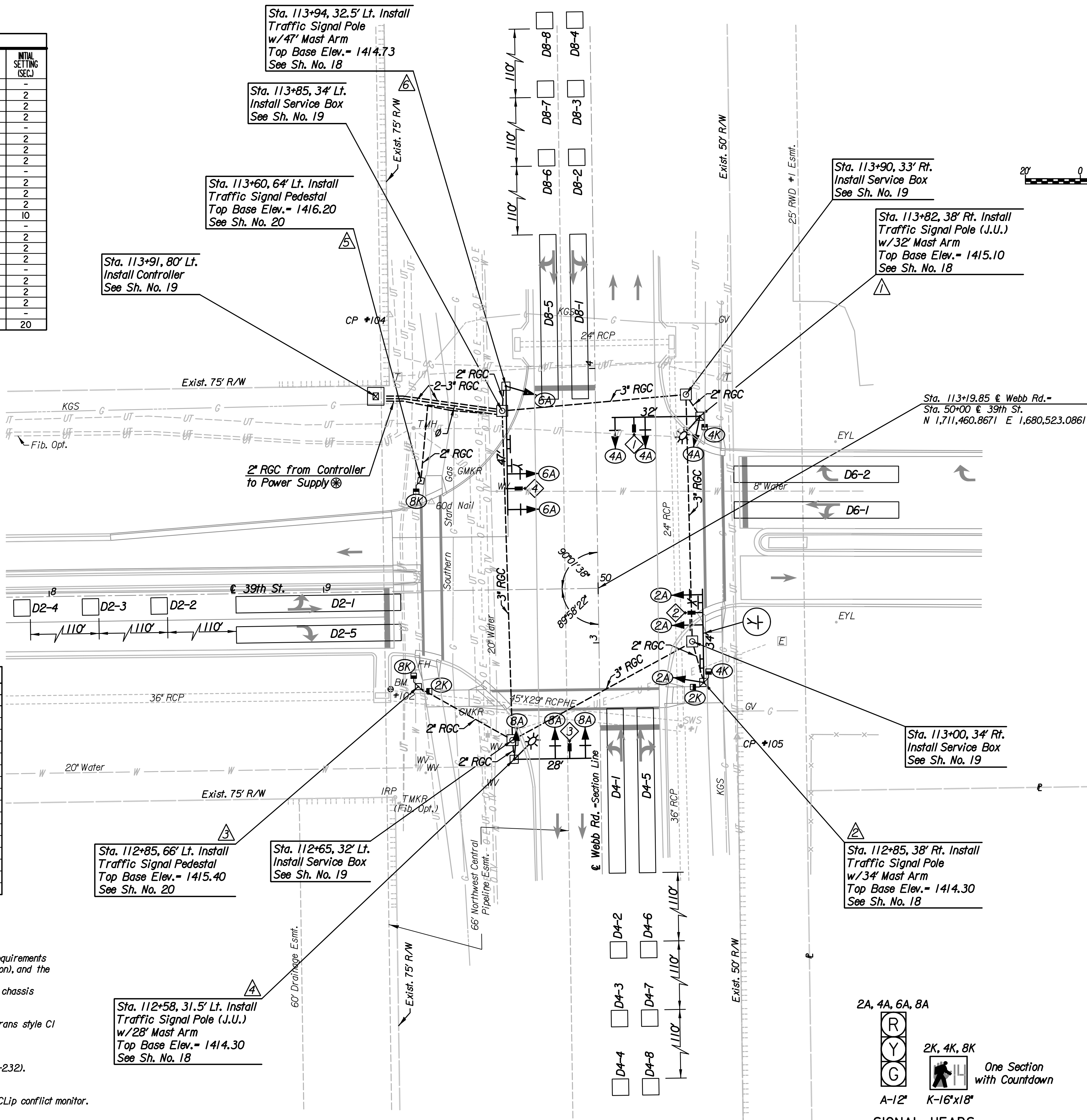

LEGEND

- 32' Traffic Signal Pole with Mast Arm & Length
- Traffic Signal Pedestal
- Traffic Signal Head
- Traffic Signal Head with Backplate
- Video Detection Camera
- Pedestrian Signal Head
- Controller with Pad
- Service Box (Pre-Fab)
- R3-5L Sign
- R3-5R Sign
- Conduit - Rigid Galvanized (RGC) or HDPE
- Signal Phase & Head Type
- Signal Pole Reference Number
- Video Detection Camera Reference Number
- Street Name Sign
- Luminaire with Arm
- Meter and Enclosure
- Lane Use Arrows
- (XPhase)- Detector Zone

Exact location to be determined by Westar Energy

Contractor shall run all four conduits indicated in a single trench through the area 10' either side of the Southern Star Central Gas line crossing as shown on these plans.

Utilities

- Gas: Kansas Gas Service
- Gas: Southern Star Central
- Power: Westar Energy
- Telephone: AT&T
- Television: Cox Communications
- Water: Wichita Water and Sanitary Sewer

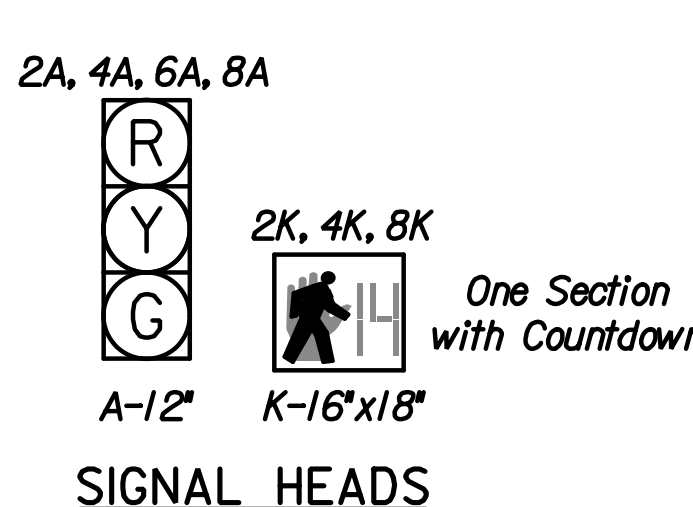
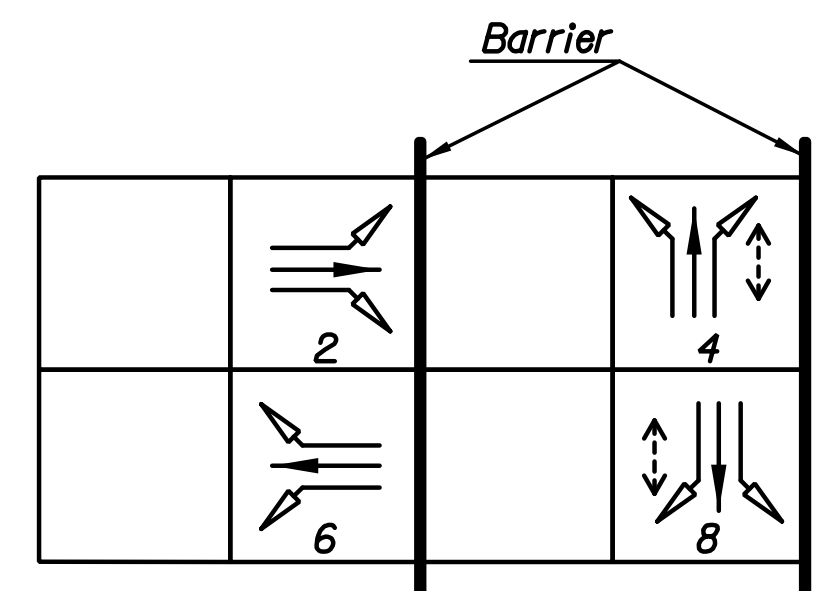

Plotted By: svb Date: 8/2/2011 1:28:14 PM
 FILE: I:\2010\0302\Signal\0302-SignalPlan.dgn

No.	Revision	By	Date
39TH STREET & WEBB RD.			
TRAFFIC SIGNAL PLAN			
JAMES L. ARMOUR, P.E. - CITY ENGINEER CITY OF WICHITA PROJECT NO. 472-84720			
Professional Engineering Consultants, P.A. 303 S. TOPEKA - WICHITA, KANSAS 67202 316-262-2691 • FAX 316-262-3003			
Designed by	DRM	Job No.	10312
Drawn by	SVB	Date	April 2011
			Sht. 16 of 31