

No.	Date	By	Approved	Revision

HARBOR ISLE JRD ADDITION  
 SANITARY SEWER IMPROVEMENTS  
 SEWERLINE NO. 2A, 2B, & 2C  
 CITY OF WICHITA, KANSAS  
 JAMES ARMOUR, P.E. - CITY ENGINEER  
 Proj.# 488-83106 O.C.A.# 744037

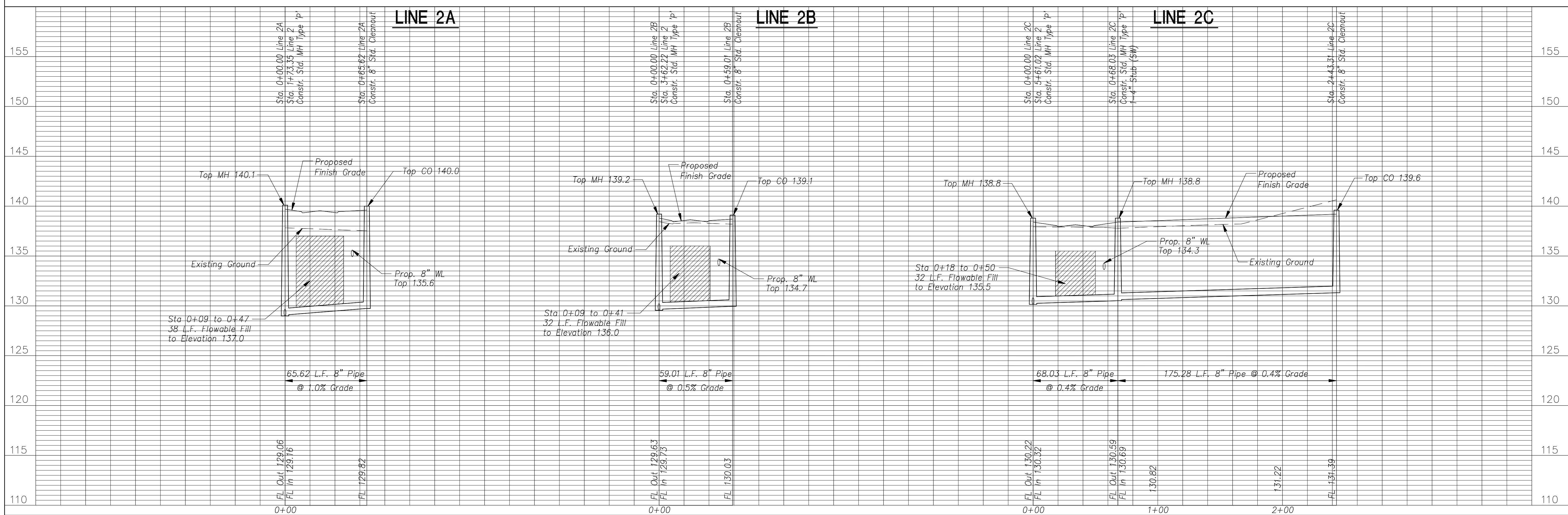

**POE & ASSOCIATES, INC.**  
**CONSULTING ENGINEERS**  
 5940 E. Central, Suite 200 • Wichita, KS 67206-4242  
 Phone 316/685-4114 • FAX 316/685-4444

**FINAL**

Designed By: J. Ubert / B. Kulla  
 Drawn By: B. Kulla  
 P.O. Job No.: 1786  
 Date: February 2004

Sheet  
 10 of 21