

# WATER DISTRIBUTION SYSTEM IMPROVEMENTS

TO SERVE

## TEXAS ROADHOUSE

6707 WEST KELLOGG

PRIVATE PROJECT NO. 1716 PPW (607853)

## CITY OF WICHITA, KANSAS

GARY JANZEN, P.E. - INTERIM CITY ENGINEER

NOT A AS BUILT  
NO AS BUILTS TURNED IN.

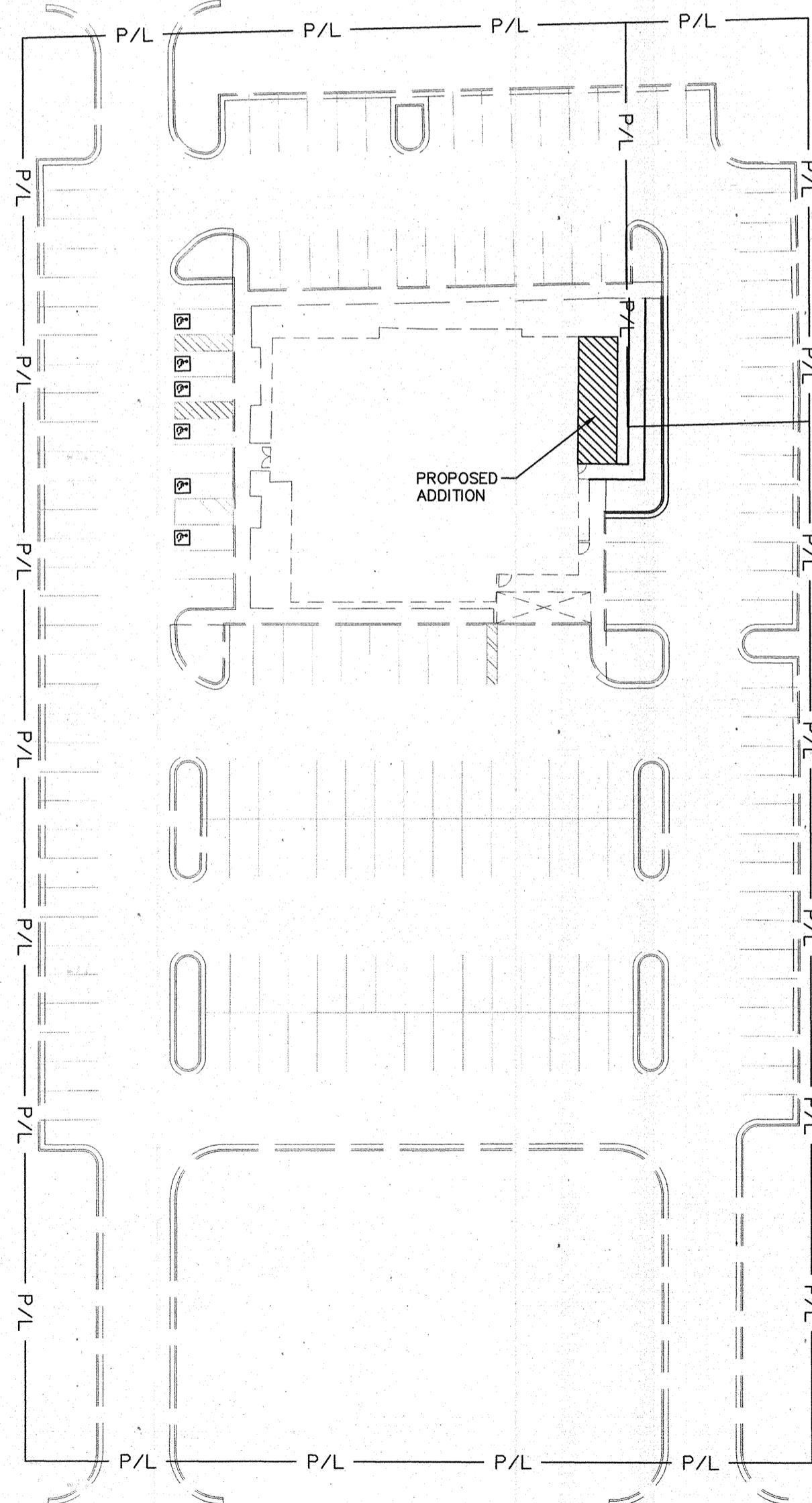

OVERALL SITE PLAN  
SCALE: 1"=40'

TOTAL PARKING: 178 STALLS  
ADA ACCESSIBLE SPACES: 6 STALLS

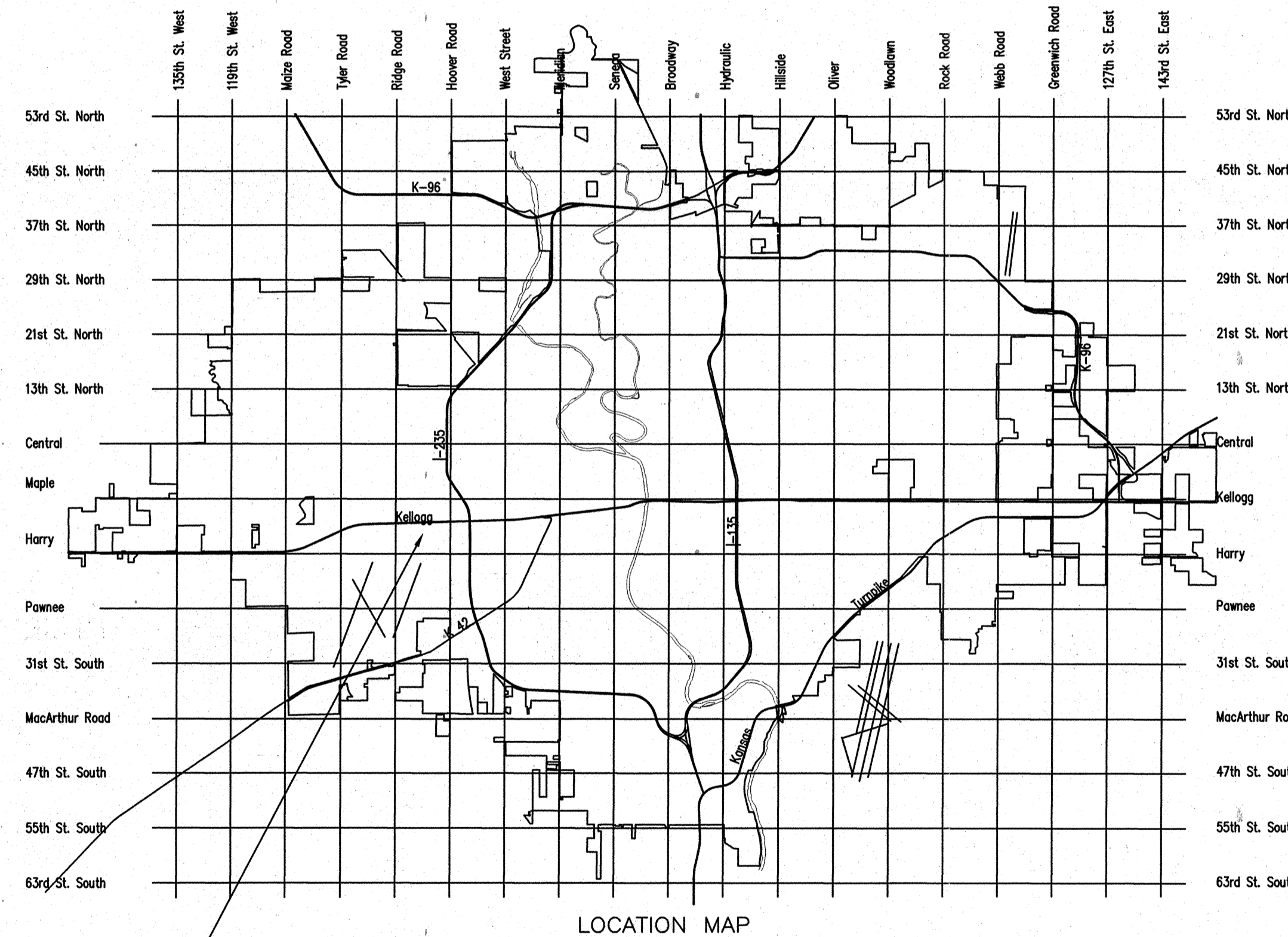

LOCATION MAP

PROJECT SITE  
TEXAS ROADHOUSE  
6707 WEST KELLOGG

# JANUARY 2013

PLANS PREPARED BY



INDEX OF SHEETS

SHEET NO. TS-1 TITLE SHEET  
SHEET NO. PP-1 WATERLINE PLAN AND PROFILE

APPROVED AS NOTED  
BY CITY ENGINEER OF WICHITA  
& BY WICHITA FIRE DEPARTMENT

Water Mains (Engineering) *Julianus Kollman* 2-15-13  
Water Mains (Water) *Greg Tolly* 2-19-13  
Fire Prot. Line *Bob Simpson* 2-20-2013

NOTE TO CONTRACTORS

**PUBLIC PROPERTY:**  
Inspection and testing for the waterline is to be provided by a Licensed Consulting Engineering Firm under contract with the Owner/Developer. Said inspection to be in accordance with the City of Wichita standard construction engineering practices and certified by a Licensed Professional Engineer licensed in the State of Kansas. No work shall be performed in dedicated easements or public right-of-way by the Contractor without such inspection nor shall any work be commenced without written authorization by the City Engineer. All Construction and Materials shall comply with the City of Wichita Specifications and Standards (on file and available in the City Engineer's Office).

**PRIVATE PROPERTY:**  
Installation and testing for the fire protection line is to be performed by a City of Wichita licensed fire protection contractor in accordance with the fire codes as adopted by the City of Wichita. All materials and construction practices for the fire protection line shall comply with the fire codes as adopted by the City of Wichita (available from the City of Wichita Fire Department). The Contractor shall not commence work without notification and approval of the Wichita Fire Department. Inspection of the fire protection line is to be provided by the City of Wichita Fire Department and by a licensed Consulting Engineering Firm under contract with the Owner/Developer. The contractor shall not start work until the project inspector is assigned to the project and present on the site. Any work done without inspection will be required to be uncovered for inspection.

REV.	DATE	DESCRIPTION

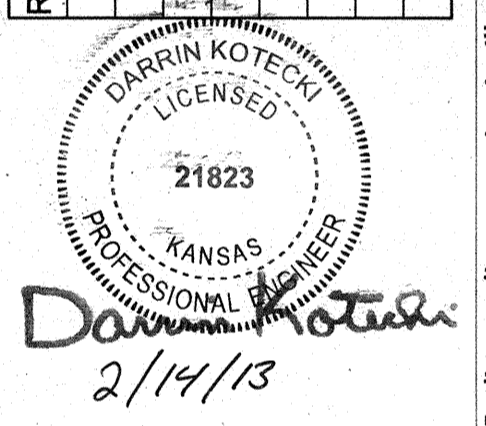

APPROVED AS NOTED  
BY CITY ENGINEER OF WICHITA  
& BY WICHITA FIRE DEPARTMENT

Water Mains (Engineering) *Julianus Kollman* 2-15-13  
Water Mains (Water) *Greg Tolly* 2-19-13  
Fire Prot. Line *Bob Simpson* 2-20-2013

NOTE TO CONTRACTORS

**PUBLIC PROPERTY:**  
Inspection and testing for the waterline is to be provided by a Licensed Consulting Engineering Firm under contract with the Owner/Developer. Said inspection to be in accordance with the City of Wichita standard construction engineering practices and certified by a Licensed Professional Engineer licensed in the State of Kansas. No work shall be performed in dedicated easements or public right-of-way by the Contractor without such inspection nor shall any work be commenced without written authorization by the City Engineer. All Construction and Materials shall comply with the City of Wichita Specifications and Standards (on file and available in the City Engineer's Office).

**PRIVATE PROPERTY:**  
Installation and testing for the fire protection line is to be performed by a City of Wichita licensed fire protection contractor in accordance with the fire codes as adopted by the City of Wichita. All materials and construction practices for the fire protection line shall comply with the fire codes as adopted by the City of Wichita (available from the City of Wichita Fire Department). The Contractor shall not commence work without notification and approval of the Wichita Fire Department. Inspection of the fire protection line is to be provided by the City of Wichita Fire Department and by a licensed Consulting Engineering Firm under contract with the Owner/Developer. The contractor shall not start work until the project inspector is assigned to the project and present on the site. Any work done without inspection will be required to be uncovered for inspection.

ISSUED FOR:	
PERMIT	1-18-13
BID	-
CONSTRUCTION	-
RECORD	-
PROJECT MANAGER	DESIGNER
BJT	TRS

JOB NO.  
**2012031.04**

**TS-1**

Drawing Name: C:\2012\201203104 Wichita KS\Dwg\Construction\Documents\201203104 Plan And Profile.dwg  
February 14, 2013 9:3 AM - teanier

Youngstown  
Seattle  
Phoenix  
Marion  
Louisville  
Indianapolis  
Columbus  
Cleveland  
Atlanta  
Akron

