

Sta 5+00.20, 24.9' Lt  
Install Traffic Signal Pole  
with 24.0' Mastarm and  
Signs. Reuse Existing Ped  
Signals and Controller.  
Relocate Existing Trashcan  
as Necessary

Construct ADA Compliant  
Wheelchair Ramp with  
Detectable Warnings.

Construct ADA Compliant  
Wheelchair Ramp with  
Detectable Warnings.

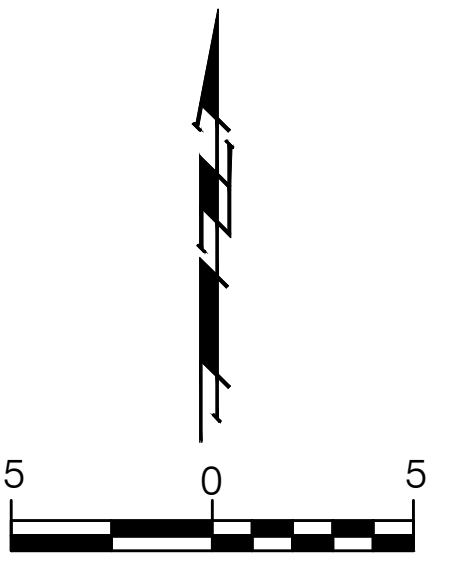

Remove Existing Lightpole,  
Base, and Hardware.  
Salvage Existing Pavers  
and Replace

Construct ADA Compliant  
Wheelchair Ramp with  
Detectable Warnings.

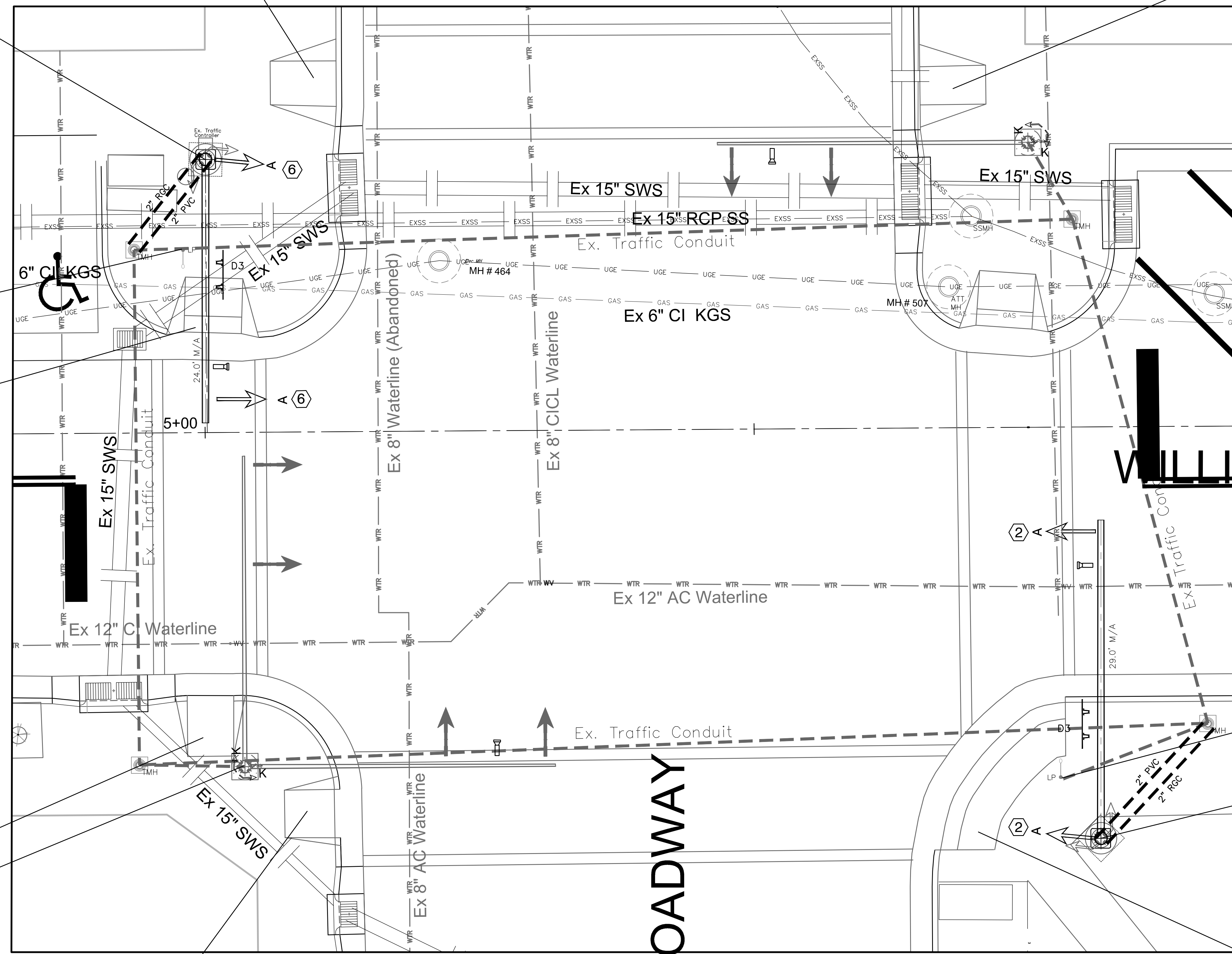
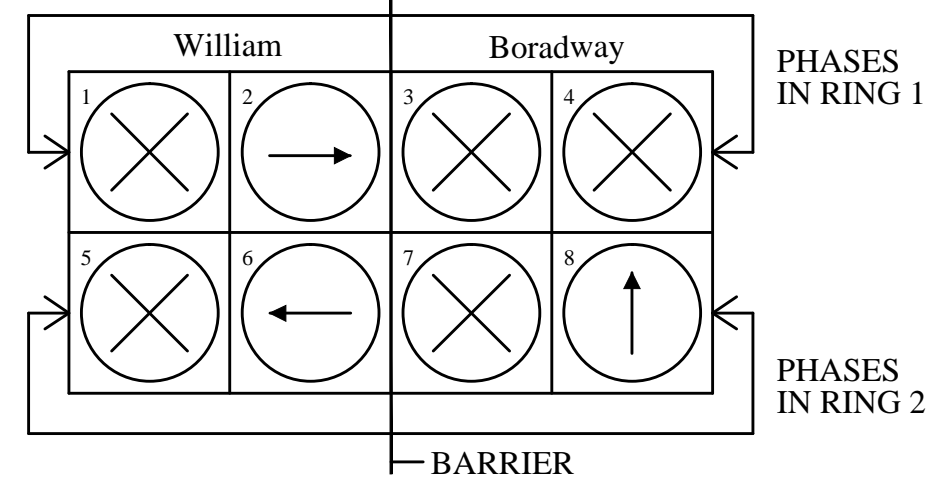

**WILLIAM ST**

**BROADWAY**

\* Install video detection  
and pedestrian  
pushbuttons (2) on each  
signal pole.

Remove Existing Lightpole,  
Base, and Hardware.

Sta 5+81.34, 37.5' Rt  
Install Traffic Signal Pole  
with 29.0' Mastarm and  
Signs. Reuse Existing Ped  
Signals.

Construct ADA Compliant  
Wheelchair Ramp with  
Detectable Warnings.

Construct ADA Compliant  
Wheelchair Ramp with  
Detectable Warnings.

Remove Existing  
Mastarm(N) and plate.

Construct ADA Compliant  
Wheelchair Ramp with  
Detectable Warnings.

Drawing File: E:\Projects\William Signalization  
Project No. 12-10-E822 CAPITAL IMPROVEMENT PROJECT  
Design: AZIERE  
Drawn: AZIERE  
Approved: AZIERE  
Scale: 1"=5'

Signalization Plan  
William and Broadway

**Baughman Company, P.A.**  
315 Ellis St. Wichita, KS 67211 P 316-262-7271 F 316-262-0149  
ENGINEERING | SURVEYING | PLANNING | LANDSCAPE ARCHITECTURE

JULY, 2013  
SHEET  
4  
OF  
10