

WILLIAM ST

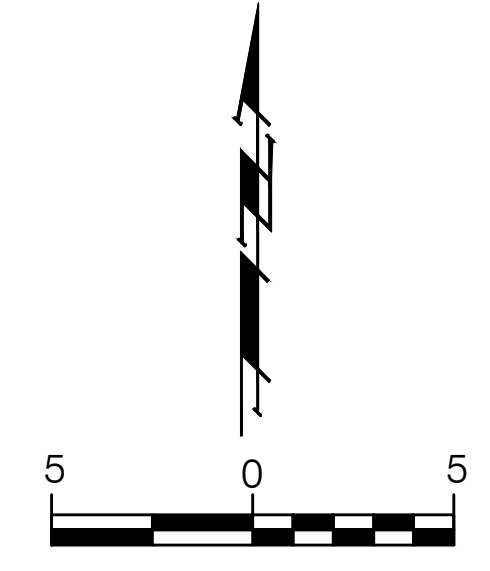
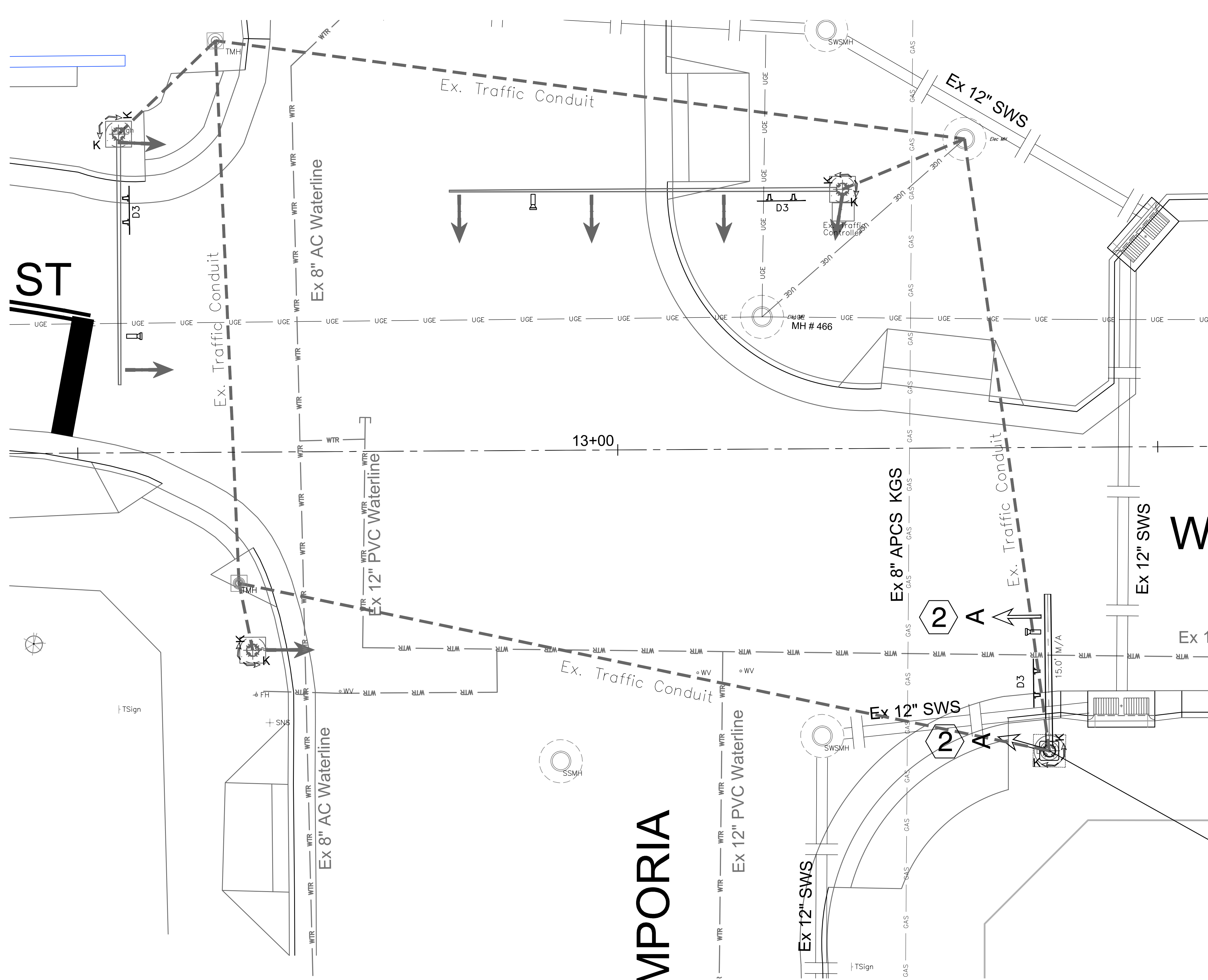

* Install video detection and pedestrian pushbuttons (2) on each signal pole.

WILLIAM ST

EMPORIA

Sta 13+39.80, 28.1' Rt
Remove Existing Light Pole and base.
Install Traffic Signal Pole with 15.0' Mastarm and Signs. Reuse Existing Ped Signals.

Drawing File: E:\Projects\William Signalization
Design: AZIERE
Drawn: AZIERE
Approved: AZIERE
Scale: 1"=5'

Project No. 12-10-E822 CAPITAL IMPROVEMENT PROJECT
Signalization Plan
William and Emporia

Baughman Company, P.A.
315 Ellis St. Wichita, KS 67211 P 316-262-7271 F 316-262-0149
ENGINEERING | SURVEYING | PLANNING | LANDSCAPE ARCHITECTURE

JULY, 2013
SHEET 8 OF 10