

Bellechase 3rd Addition

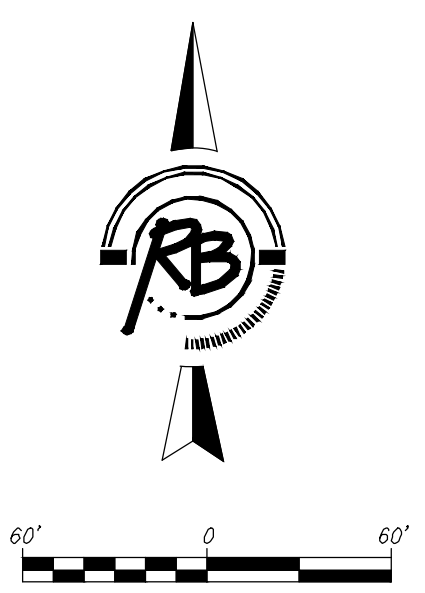
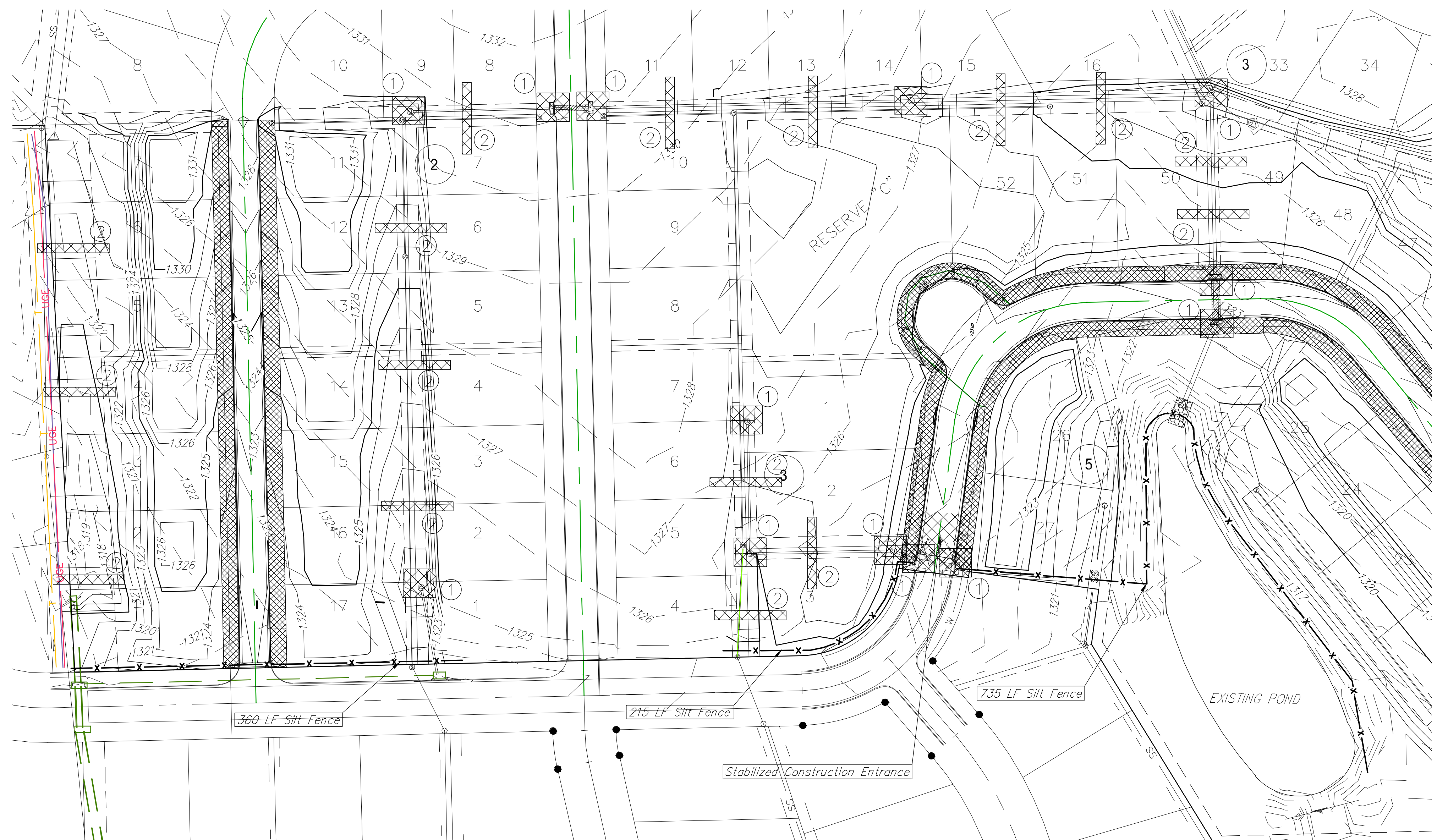

- x — Silt Fence
- ⊠ (2) Linear Sediment Barrier
- ⊠ (1) Inlet Sediment Barrier
- ▨ Erosion Control Blanket

All storm sewer and pond outlets will be maintained with rip-rap and/or erosion control fabric as necessary to prevent erosion transport.

BMP Quantities (Project Total):
 Stabilized Construction Entrance = 1 Ea.
 Linear Sediment Barrier = 24 Ea.
 Inlet Sediment Barrier = 24 Ea.
 Silt Fence = 3000 LF
 Erosion Control Blanket = 64551 SF
 (Curlex type II or approved equal)

Bellechase 2nd Addition

| | | | |
|---|--|--|---------------------|
| Bellechase 3rd Addition Erosion Control Plan WICHITA, KANSAS | | | |
| SEAL | RUGGLES & BOHM ENGINEERING SURVEYING LANDSCAPE ARCHITECTURE GOVERNMENT 824 NORTH MAIN WICHITA, KANSAS 67203 P (316) 264-8008 F (316) 264-4821 WWW.RUGGLESANDBOHM.COM | DATE: 04/17/13 DESIGN: E.J.G. DRAWN: E.J.G. REVIEW: | SHEET: 35 OF: 45 |
| PROJECT NUMBER: 472-85078 RUG JOB NO.: 4057E DWG. SCALE: 80 DRAWING FILE: Engg Base {Erosion Plan} | | | |

(c) Copyright 2013, Ruggles & Bohm, P.A.