

GENERAL NOTES:

- ALL SEWER MAINS SHALL BE INSTALLED IN ACCORDANCE WITH CITY OF WICHITA, KANSAS STANDARD SPECIFICATIONS FOR SEWER MAIN INSTALLATIONS.
- ALL WATER MAINS SHALL BE INSTALLED IN ACCORDANCE WITH CITY OF WICHITA, KANSAS STANDARD SPECIFICATIONS FOR WATER MAIN INSTALLATIONS.
- CONTRACTOR WILL BE REQUIRED TO PROVIDE A MINIMUM ADVANCE NOTICE OF SEVENTY-TWO (72) HOURS TO UTILITY COMPANIES PRIOR TO STARTING ANY EXCAVATION AS FOLLOWS:

KANSAS ONE-CALL 1-800-344-7233
OR LOCAL (WICHITA) 687-2470

THE CONTRACTOR MUST NOTIFY THE FOLLOWING IN THE EVENT OF AN EMERGENCY:

AT&T (COMMUNICATION)	268-2102
COX (COMMUNICATION)	260-7204
KANSAS GAS SERVICE (GAS)	832-3126
WESTAR ENERGY (ELECTRIC)	261-6512
WICHITA SEWER & WATER	262-6000

- SEWER MAIN SHALL BE CONSTRUCTED ON THE ALIGNMENT AND TO THE LINES, GRADE, AND SLOPE AS SHOWN ON THE PLANS.
- WATER MAIN RELOCATION SHALL BE CONSTRUCTED ON THE ALIGNMENT SHOWN ON THE PLANS AND MAINTAIN THE SPECIFIED SEPARATION DISTANCE FROM THE PROPOSED SANITARY SEWER MAIN AS DEPICTED ON THE PLANS AND DETAILS.
- TREES AND SHRUBS IN PUBLIC RIGHT-OF-WAY WHICH ARE IN DIRECT CONFLICT WITH PROPOSED CONSTRUCTION SHALL BE REMOVED AND DISPOSED OF BY THE CONTRACTOR WITH THE ENGINEER'S APPROVAL. TREES AND SHRUBS WHICH ARE NOT IN DIRECT CONFLICT WITH PROPOSED CONSTRUCTION SHALL BE SAVED AND PROTECTED FROM DAMAGE.
- PROJECT WASTE INCLUDING TREES, RUBBLE FROM MISCELLANEOUS STRUCTURES, ABANDONED PIPES, EXCESS EXCAVATION MATERIALS, ETC. SHALL BE DISPOSED OF ON SITES TO BE PROVIDED BY CONTRACTOR. THESE SITES SHALL BE APPROVED BY THE ENGINEER AS TO SUITABILITY, APPEARANCE AND SITE LOCATION. LOCATIONS THAT, IN THE OPINION OF THE ENGINEER, WILL LEAVE AN UNSIGHTLY APPEARANCE WILL NOT BE APPROVED. ALL DISPOSAL SITES MUST BE APPROVED BY THE KANSAS DEPARTMENT OF HEALTH AND ENVIRONMENT. MATERIAL EITHER STOCKPILED OR DISPOSED OF IN A FLOOD PLAIN WOULD REQUIRE A KANSAS STATE BOARD OF AGRICULTURE PERMIT. ANY MATERIAL PLACED IN WATERS OF THE UNITED STATES OR WETLANDS IS SUBJECT TO UNITED STATES ARMY CORPS OF ENGINEERS PERMITTING REGULATIONS. ANY MATERIAL BURIED OR STOCKPILED BEYOND APPROVED CONSTRUCTION LIMITS WOULD REQUIRE ADDITIONAL ARCHAEOLOGICAL INVESTIGATION UNLESS BURIED IN A PREVIOUSLY APPROVED BORROW LOCATION.
- OPENING AND CLOSING OF WATER VALVES SHALL BE PERFORMED SLOWLY TO PREVENT DAMAGE TO THE WATER DISTRIBUTION SYSTEM FROM WATER HAMMER. ALL VALVES CLOSED BY THE CONTRACTOR MUST BE REOPENED AS NEW CONSTRUCTION PERMITS. PROJECT INSPECTOR MUST ASCERTAIN THAT ANY VALVE CLOSED BY THE CONTRACTOR IS REOPENED. CONTRACTOR WILL BE PERMITTED TO OPERATE WATER VALVES ONLY WHEN THE PROJECT INSPECTOR ASSIGNED TO THE PROJECT IS PRESENT.
- CONTRACTOR SHALL NOT START WORK ON THE PROJECT UNTIL PROJECT INSPECTOR IS ASSIGNED TO THE PROJECT AND ON SITE. ANY WORK DONE WITHOUT INSPECTION WILL BE REQUIRED TO BE UNCOVERED FOR INSPECTION.
- CONTRACTOR SHALL GIVE PROPERTY OWNERS AND/OR TENANTS OF DEVELOPED PROPERTY ABUTTING THE PROJECT LIMITS A MINIMUM OF TEN (10) DAYS ADVANCE NOTICE PRIOR TO START OF CONSTRUCTION.
- CONTRACTOR SHALL BE RESPONSIBLE FOR REPLACING PROPERTY IRONS THAT ARE DAMAGED OR REMOVED DURING CONSTRUCTION. PROPERTY IRONS DISTURBED OR DAMAGED BY CONTRACTOR SHALL BE RE-ESTABLISHED BY A LICENSED SURVEYOR IN ACCORDANCE WITH STATE LAWS.
- CONTRACTOR SHALL RESTORE ALL DITCHES, SWALES, ROAD SHOULDERS, ENTRANCES AND BANK LINES TO THEIR ORIGINAL SLOPES AND GRADES UNLESS OTHERWISE SHOWN.
- ALL LAWN/TURF AREAS DISTURBED BY CONSTRUCTION OF THE PROPOSED IMPROVEMENTS SHALL BE RESTORED WITH THE SAME GRASS AS EXISTING. RESTORATION OF DISTURBED AREAS SHALL INCLUDE, BUT NOT BE LIMITED TO, TOP SOIL PREPARATION, SEEDING, MULCH (ALL SEEDING AREAS, OUTSIDE THE LIMITS OF EROSION MAT PLACEMENT), AND/OR RESEEDING, AND INSTALLATION OF EROSION CONTROL MAT. ALL SEEDING WORK SHALL BE IN ACCORDANCE WITH THE CITY OF WICHITA STANDARD SPECIFICATIONS AND THE CITY OF WICHITA ADMINISTRATIVE REGULATIONS NO. AR 6.5 WHICH GOVERNS CLEANUP AND RESTORATION OF REPLACEMENT FOLLOWING CONSTRUCTION. ALL COSTS FOR THE SOIL PREPARATION, SEEDING AND MULCHING (ALL SEEDING AREAS, OUTSIDE THE LIMITS OF EROSION MAT PLACEMENT) SHALL BE PAID FOR THROUGH THE LUMP SUM BID ITEM FOR "SEEDING". ALL SEEDING AREAS WITHIN EIGHT FEET OF THE BACK OF CURB SHALL BE COVERED WITH APPROVED EROSION MAT, WHICH SHALL BE PAID FOR BY THE MEASURED QUANTITY BID ITEM "BACK OF CURB PROTECTION (8' WIDE)".
- EXISTING TREE STUMPS WITHIN THE LIMITS OF CONSTRUCTION SHALL EITHER BE COMPLETELY REMOVED OR GROUND DOWN TO A MINIMUM 6 INCHES BELOW PROPOSED GRADE. COST TO BE SUBSIDIARY TO SITE CLEARING.
- CONTRACTOR SHALL BE MADE AWARE THAT HE WILL BE WORKING IN CLOSE PROXIMITY OF EXISTING UTILITIES. ANY CONFLICTS WITH SUCH UTILITIES SHALL BE REPORTED TO THE ENGINEER. CONTRACTOR SHALL COORDINATE THE CONSTRUCTION OF THIS PROJECT WITH RELOCATION OF ANY EXISTING UTILITIES BY THE UTILITY COMPANY. UTILITY SERVICE LINES, POLES, VALVE BOXES, GAS METERS, ETC. ARE TO BE ADJUSTED AS NECESSARY BY OTHERS PRIOR TO CONSTRUCTION UNLESS SPECIFICALLY IDENTIFIED ON THE PLANS TO BE ADJUSTED BY CONTRACTOR EXISTING UTILITIES AND THEIR LOCATION, AS SHOWN ON THE PLANS, REPRESENT THE BEST INFORMATION OBTAINABLE FOR DESIGN. LOCATION INFORMATION HAS BEEN OBTAINED FROM THE VARIOUS UTILITY COMPANIES AND IS EITHER FROM COMPANY RECORD DRAWINGS OR COMPANY PROVIDED FIELD LOCATIONS. CONTRACTOR WILL BE REQUIRED TO WORK AROUND EXISTING UTILITIES WITHIN THE LIMITS OF CONSTRUCTION THAT DO NOT CONFLICT WITH PROPOSED CONSTRUCTION.
- CONTRACTOR SHALL LAY TRACER WIRE AND SET TEST STATIONS ALONG ALL WATER LINE PIPE INSTALLED IN ACCORDANCE WITH CITY OF WICHITA SPECIFICATIONS AND TRACER WIRE DETAIL ON DETAIL SHEET. COST IS SUBSIDIARY TO WATER MAIN RELOCATION.
- CONTRACTOR SHALL SCHEDULE CONSTRUCTION ACTIVITIES SO AS TO LIMIT WATER SERVICE DOWN TIME TO RESIDENCES. CONTRACTOR WILL BE RESPONSIBLE FOR PROVIDING A COPY OF HIS CONSTRUCTION SCHEDULE TO THE PROJECT ENGINEER AND THE CITY OF WICHITA, KS FOR APPROVAL PRIOR TO THE START OF CONSTRUCTION.
- CONTRACTOR SHALL BE RESPONSIBLE FOR PRESERVING WATER VALVES, WATER VALVE BOXES OR FIRE HYDRANTS DURING CONSTRUCTION AND ANY DAMAGE OCCURRING DURING CONSTRUCTION SHALL BE REPAIRED BY CONTRACTOR AT HIS OWN EXPENSE.
- CONTRACTOR SHALL BE RESPONSIBLE FOR IMPLEMENTING EROSION CONTROL METHODS DURING CONSTRUCTION TO PREVENT UNNECESSARY SILT/SEDIMENT DISCHARGE THROUGH DOWNSTREAM PROPERTIES OR STORM SEWERS. CONTRACTOR SHALL INSTALL AND MAINTAIN EROSION CONTROLS AS DIRECTED BY THE ENGINEER.
- REMOVAL AND DISPOSAL OF EXISTING ASBESTOS-CEMENT WATER MAIN, REFERRED TO ON SHEET 7, SHALL BE PERFORMED IN ACCORDANCE WITH OSHA, LOCAL, STATE, AND FEDERAL REGULATIONS.

8-INCH SANITARY SEWER EXTENSION PLANS TO SERVE 1218 & 1226 WEST 33RD ST. NORTH LATERAL 171, S.S. NO. 22

PREPARED FOR
THE CITY OF WICHITA, KANSAS
GARY JANZEN, P.E., INTERIM CITY ENGINEER
NOVEMBER 2012
PROJECT NO. 468-84840
O.C.A. NO. 744339

DANCO - CONTRACTOR
S. DEGENHARDT - CITY OF WICHITA, FIELD PROJECT ENGINEER
G. STEINLE - CITY OF WICHITA, FIELD INSPECTOR
AS-BUILT
STUBS
RELEASE DATE: 06/12/2013
PDF: A. P. ROSAS 11/19/2013

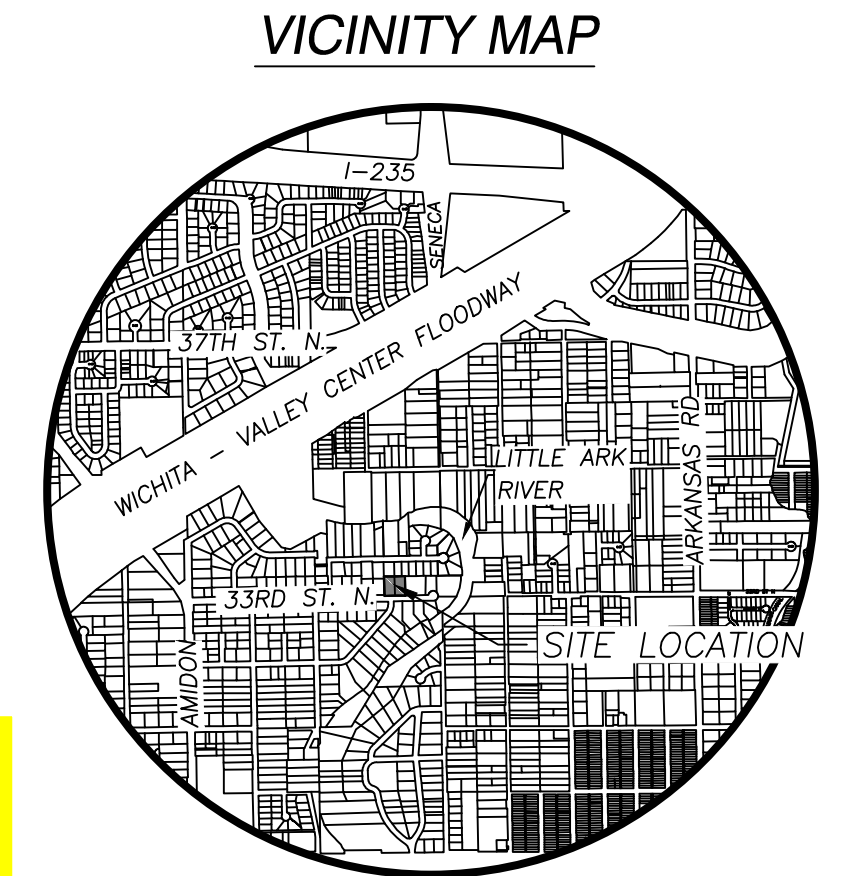

SHEET INDEX

- | | |
|--------|-----------------------|
| 1 | TITLE SHEET |
| 2 | SITE LAYOUT |
| 3 | PLAN & PROFILE |
| 4-7 | STANDARD DETAILS |
| 8 | PROJECT DETAILS |
| 9 - 13 | EROSION CONTROL BMP's |

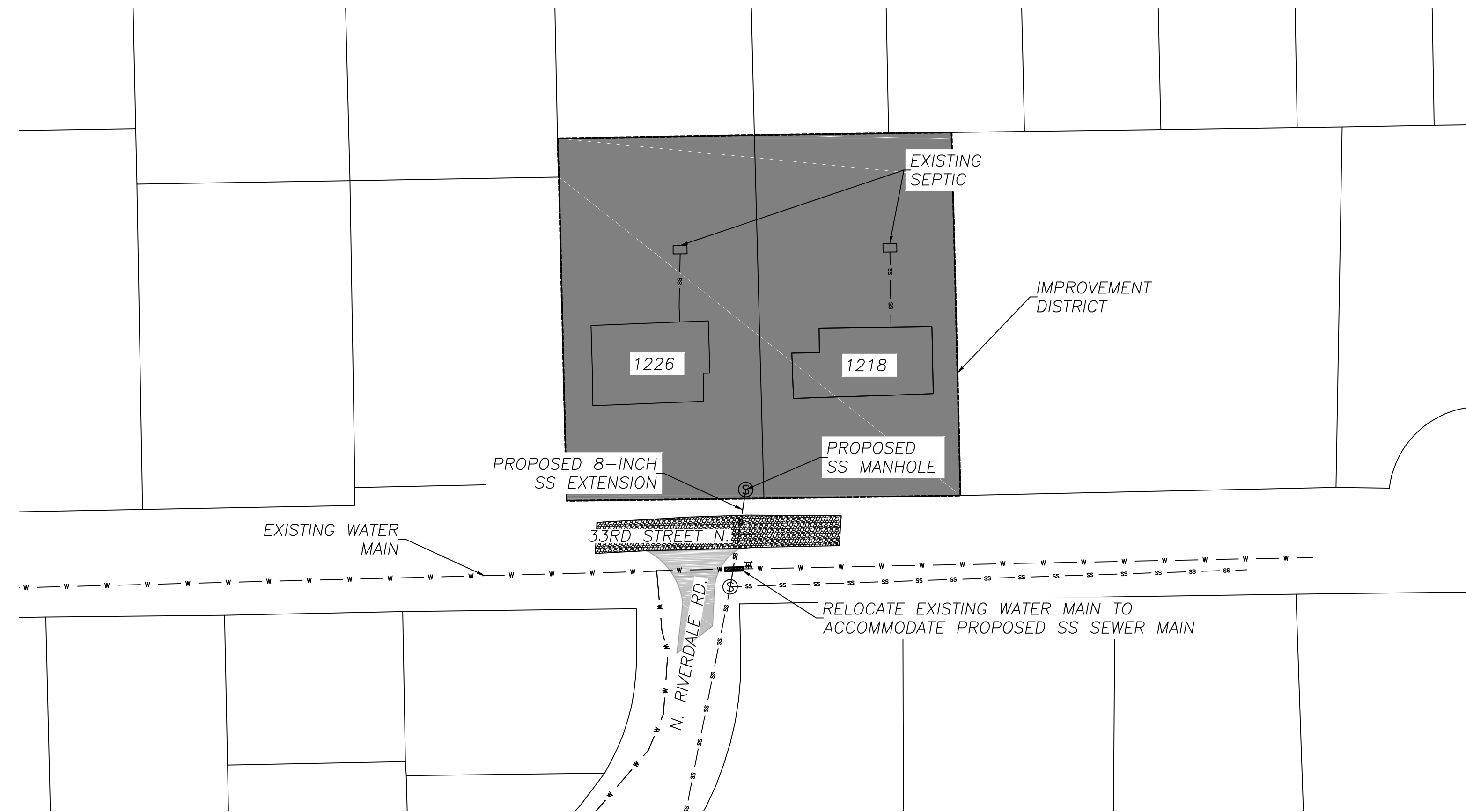

HORIZONTAL CONTROL

CP 100 - GPS BASE, STAMPED CONTROL POINT, SET 3/8" IRON BAR W/ CAP
N = 1706949.97, E = 1643172.54, ELEV = 1317.40

CP 103 - STAMPED CONTROL POINT, SET 3/8" IRON BAR W/ CAP
N = 1706948.79, E = 1643181.59, ELEV = 1317.53

CP 106 - STAMPED CONTROL POINT, SET 3/8" IRON BAR W/ CAP
N = 1706980.41, E = 1642972.48, ELEV = 1317.68

CP 109 - STAMPED CONTROL POINT, SET 3/8" IRON BAR W/ CAP
N = 1706989.17, E = 1643370.25, ELEV = 1317.85

HORIZONTAL COORDINATES ESTABLISHED USING CITY OF WICHITA GPS NETWORK WHICH IS BASED OFF OF US STATE PLANE COORDINATES, NAD1983 SOUTH ZONE (1502).

BENCHMARK

TEMPORARY BENCHMARK:
MARKED NORTH SIDE OF EXISTING MANHOLE WITH "X".
N = 1706944.63, E = 1643163.27, ELEV. = 1317.09

PERMANENT BENCHMARK:
APPROXIMATELY LOCATED AT 35TH STREET NORTH, SOUTHEAST CORNER OF BRIDGE, SOUTH END OF METAL GUARD RAIL.
N = 1707681.28, E = 1640456.90, ELEV. = 1334.22

VERTICAL CONTROL BASED OFF OF AN ESTABLISHED NETWORK BENCHMARK PROVIDED BY THE CITY.

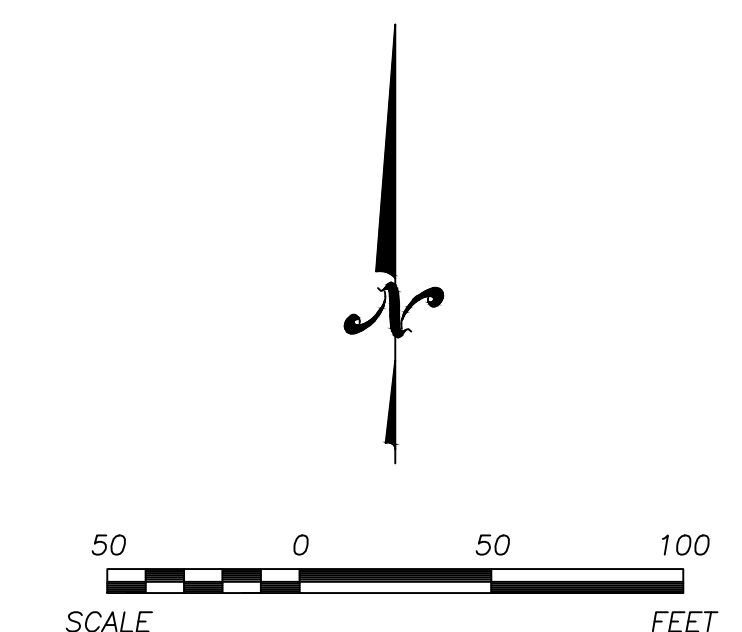

PREPARED BY

AQUATERRA
ENVIRONMENTAL SOLUTIONS, INC.
11120 E. 26TH ST. NORTH, STE 1100
WICHITA, KANSAS 67226
(316) 315-4501 FAX (316) 315-4505
KANSAS ENGINEERING CERTIFICATE NO. E-926