

P.I. @ Sta. 126+39.74  
 S 1/4 Cor. Sec. 28, T26S, R1E  
 Deflection  $\Delta$  = 0'28'37" Rt.  
 1. See References below

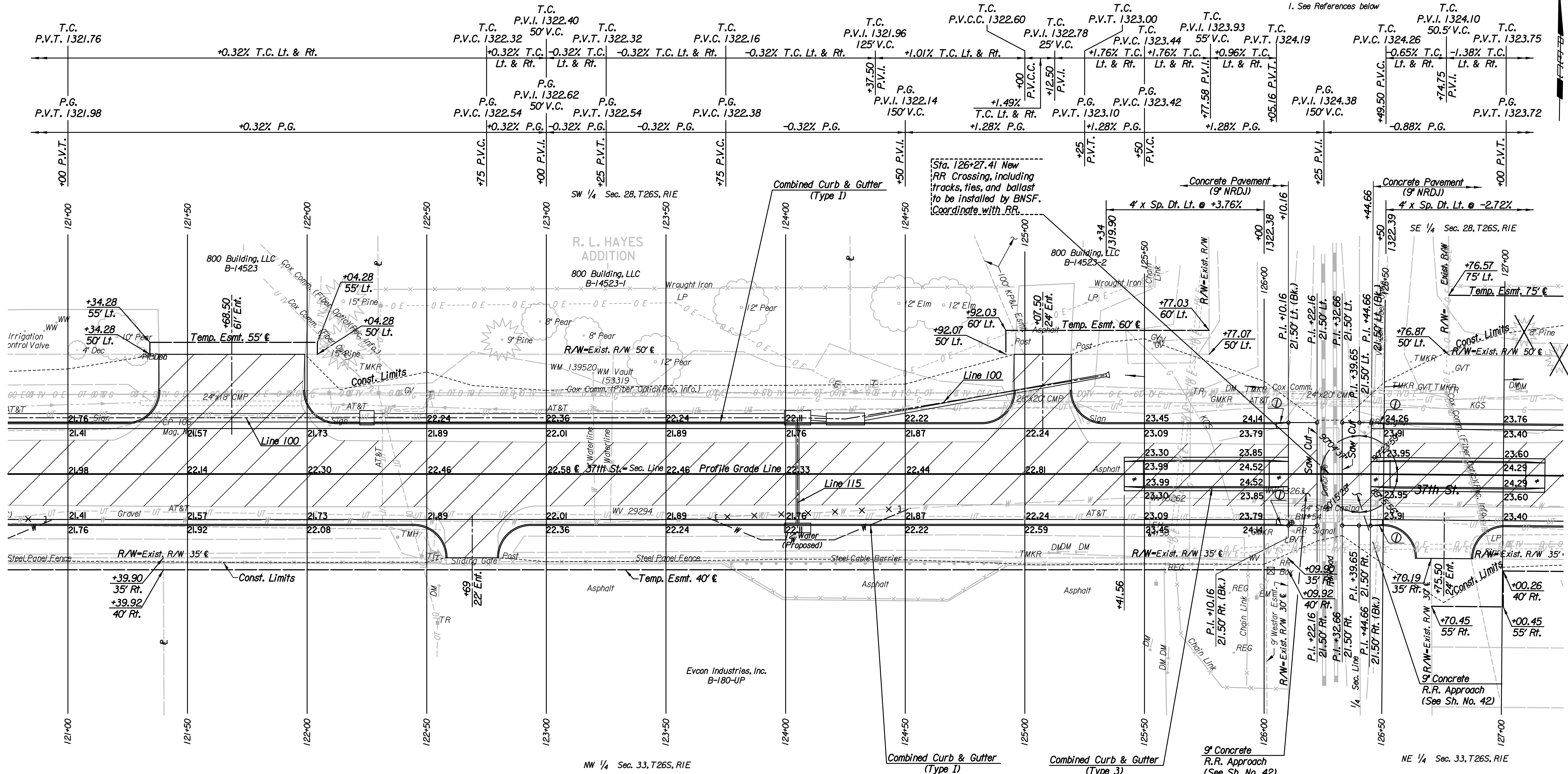

REMOVAL OF EXISTING STRUCTURES *		
STATION	SIDE	ITEM
121+10	Lt.	Sign
121+66	Lt.	24' x 18' CMP
122+10	Lt.	Sign
125+07	Lt.	28' x 20' CMP
125+26	Lt.	Sign
126+13	Rt.	Guard Rail
126+43	Lt.	Guard Rail
126+92	Rt.	Sign

\* For Information Only

- Utilities**
- Communications: Verizon, Kansas Gas Service, Westar Energy, AT&T, Wichita Central Unit, Cox Communications, Wichita Water Utilities
  - Gas: Kansas Gas Service
  - Power: Westar Energy
  - Telephone: AT&T, Wichita Central Unit
  - Television: Cox Communications
  - Water: Wichita Water Utilities

- S 1/4 Cor. Sec. 28, T26S, R1E
- Found 1/2" Iron Pipe in Thimble
  - N 1,709,740,437 E 1,651,559,8368
  - Nail and Washer in SE face of Electric Pole
  - Center of E Rail on RR Track
  - Nail and Washer in SW face of Light Pole
  - PK Nail in S face of Power Pole
  - City Bench Mark Disc at NW corner Concrete Base RR Signal

**LEGEND**

- Pavement Removal
- Denotes Trees to be Removed
- \* 8' Median Ramp Nose Section
- ⊙ 5' transition from Combined Curb & Gutter (Type I) to no curb.

BM#54 C.O.W. Disc on RR Signal Base on S side of 37th St. N. on W side of RR Track, half mile E of Broadway Ave. 20' Rt. @ Sta. 126+12 Elev. = 1324.48

37TH STREET NORTH

**PLAN**  
 STA. 121+00 TO STA. 127+00

GARY JANZEN, P.E.—CITY ENGINEER  
 CITY OF WICHITA PROJECT NO. 472-84692

**PEC**  
 PROFESSIONAL ENGINEERING CONSULTANTS, P.A.  
 303 SOUTH TOPEKA WICHITA, KS 67202  
 316-262-2691 www.pec1.com

Designed by	JPS	Job No.	08207	Sheet	9 of 193
Drawn by	SVB	Date	August, 2013		

Plotted By: svb Date: 8/2/2013  
 FILE: I:\2008\08207\Plan\08207-PL121.dgn