

Plotted By: svb Date: 8/15/2013 4:58:28 PM
 FILE: I:\2008\08207\Plan\08207-PL121.dgn

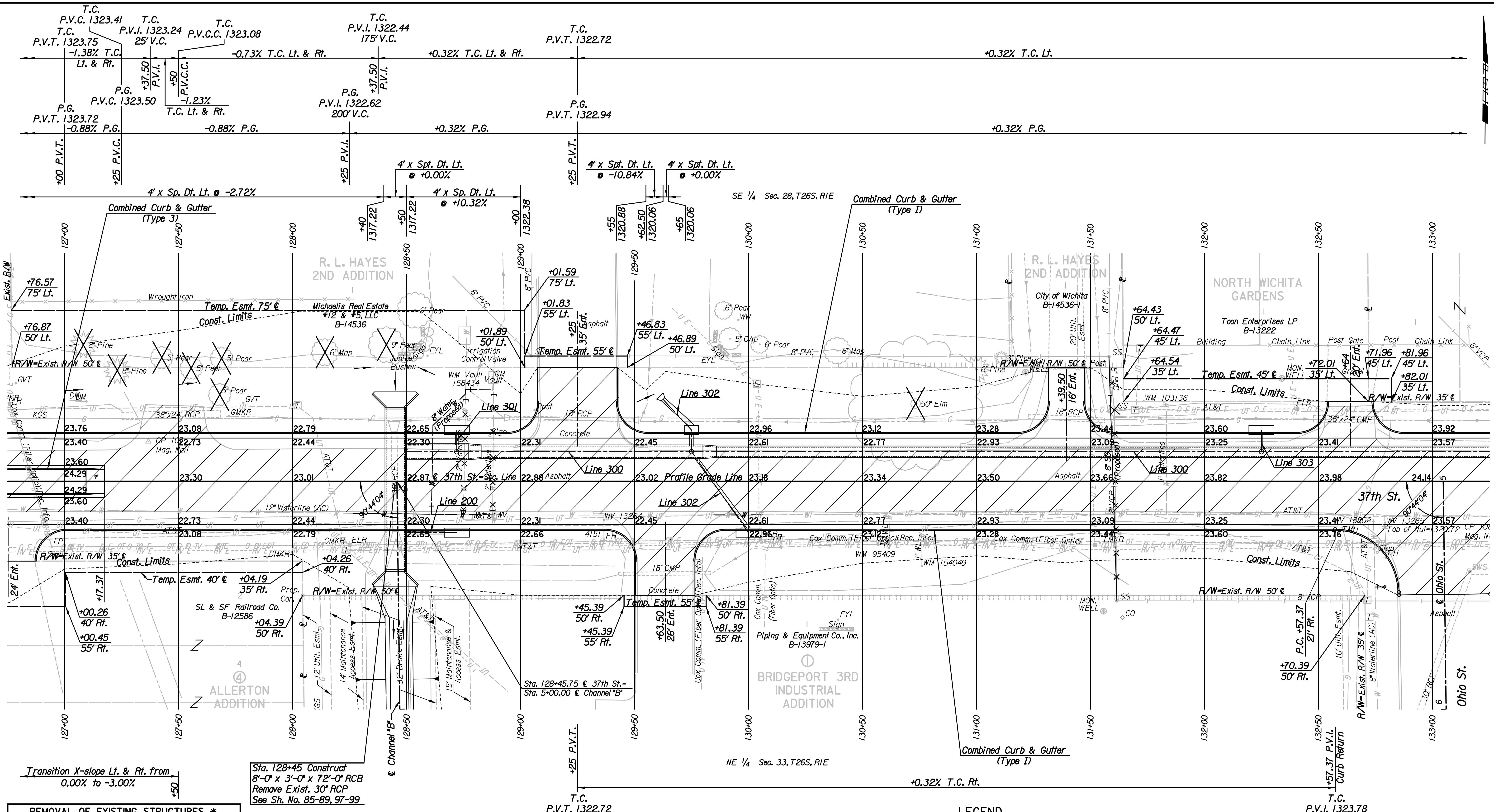

Transition X-slope Lt. & Rt. from
 0.00% to -3.00%

Sta. 128+45 Construct
 8'-0" x 3'-0" x 72'-0" RCB
 Remove Exist. 30" RCP
 See Sh. No. 85-89, 97-99

REMOVAL OF EXISTING STRUCTURES *		
STATION	SIDE	ITEM
127+47	Lt.	38" x 24" RCP
128+45	Cl.	30" RCP
128+55	Lt.	Monument Sign
128+87	Lt.	Sign
129+06	Lt.	Post
129+22	Lt.	18" RCP
129+63	Rt.	18" CMP
131+35	Lt.	18" RCP
132+63	Lt.	35" x 24" CMP
132+76	Rt.	Sign

* For Information Only

LEGEND

- Pavement Removal
- Denotes Trees to be Removed

- Utilities**
- Gas Kansas Gas Service
 - Power Westar Energy
 - Sanitary Sewer Wichita Water Utilities
 - Telephone AT&T, Wichita Central Unit
 - Television Cox Communications
 - Water Wichita Water Utilities

BM*55 Chiseled " on center of face of Inlet on W side of Ohio St. on S side of 37th St. N. 133' Rt. & Sta. 132+84 Elev. = 1322.63

Revision		By	Date
37TH STREET NORTH			
PLAN			
STA. 127+00 TO STA. 133+00			
GARY JANZEN, P.E.-CITY ENGINEER CITY OF WICHITA PROJECT NO. 472-84692			
PEC PROFESSIONAL ENGINEERING CONSULTANTS, P.A. 303 SOUTH TOPEKA WICHITA, KS 67202 316-262-2691 www.pec1.com			
Designed by	JPS	Job No.	08207
Drawn by	SVB	Date	August, 2013
			Sh. 10 of 193