

Plotted By: svb Date: 8/15/2013 7:06:09 PM
 FILE: I:\2008\08207\Plan\08207-PL151.dgn

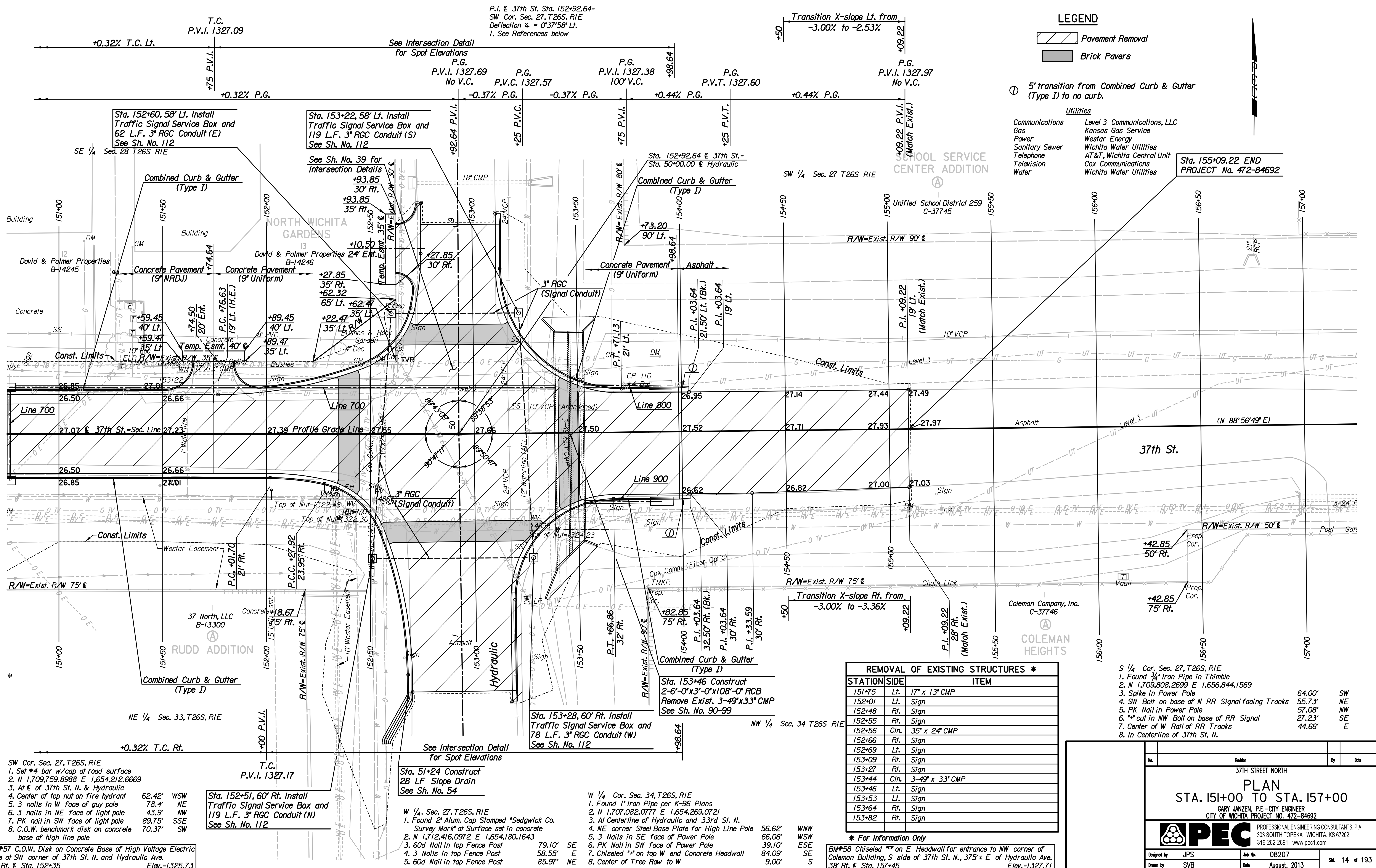

LEGEND

- Pavement Removal
- Brick Pavers

① 5' transition from Combined Curb & Gutter (Type I) to no curb.

Utilities

- Communications: Level 3 Communications, LLC
- Gas: Kansas Gas Service
- Power: Westar Energy
- Sanitary Sewer: Wichita Water Utilities
- Telephone: AT&T, Wichita Central Unit
- Television: Cox Communications
- Water: Wichita Water Utilities

REMOVAL OF EXISTING STRUCTURES *		
STATION	SIDE	ITEM
151+75	Lt.	17" x 13" CMP
152+01	Lt.	Sign
152+48	Rt.	Sign
152+55	Rt.	Sign
152+56	Cln.	35" x 24" CMP
152+66	Rt.	Sign
152+69	Lt.	Sign
153+09	Rt.	Sign
153+27	Rt.	Sign
153+44	Cln.	3-49" x 33" CMP
153+46	Lt.	Sign
153+53	Lt.	Sign
153+64	Rt.	Sign
153+82	Rt.	Sign

* For Information Only

BM*58 Chiseled " on E Headwall for entrance to NW corner of Coleman Building, S side of 37th St. N., 375'± E of Hydraulic Ave. 38' Rt. & Sta. 157+45 Elev.=1327.71

- S 1/4 Cor. Sec. 27, T26S, R1E
- Found 3/4" Iron Pipe in Thimble
 - N 1,709,808.2699 E 1,656,844.1569
 - Spike in Power Pole 64.00' SW
 - SW Bolt on base of N RR Signal facing Tracks 55.73' NE
 - PK Nail in Power Pole 57.08' NW
 - * cut in NW Bolt on base of RR Signal 27.23' SE
 - Center of W Rail of RR Tracks 44.66' E
 - In Centerline of 37th St. N.

37TH STREET NORTH		By	Date
PLAN			
STA. 151+00 TO STA. 157+00			
GARY JANZEN, P.E.—CITY ENGINEER CITY OF WICHITA PROJECT NO. 472-84692			
PEC		PROFESSIONAL ENGINEERING CONSULTANTS, P.A. 303 SOUTH TOPEKA WICHITA, KS 67202 316-262-2691 www.pec1.com	
Designed by	JPS	Job No.	08207
Drawn by	SVB	Date	August, 2013
			Sht. 14 of 193

- SW Cor. Sec. 27, T26S, R1E
- Set #4 bar w/cap at road surface
 - N 1,709,759.8988 E 1,654,212.6669
 - At E of 37th St. N. & Hydraulic
 - Center of top nut on fire hydrant 62.42' WSW
 - 3 nails in W face of guy pole 78.4' NE
 - 3 nails in NE face of light pole 43.9' NW
 - PK nail in SW face of light pole 89.75' SSE
 - C.O.W. benchmark disk on concrete base of high line pole 70.37' SW Elev.=1325.73

Sta. 152+51, 60' Rt. Install Traffic Signal Service Box and 119 L.F. 3" RGC Conduit (N) See Sh. No. 112

Sta. 51+24 Construct 28 LF Slope Drain See Sh. No. 54

- W 1/4 Sec. 27, T26S, R1E
- Found 2" Alum. Cap Stamped "Sedgwick Co. Survey Mark" at Surface set in concrete
 - N 1,712,416.0972 E 1,654,180.1643
 - 60d Nail in top Fence Post 79.10' SE
 - 3 Nails in top Fence Post 58.55' E
 - 60d Nail in top Fence Post 85.97' NE

- W 1/4 Cor. Sec. 34, T26S, R1E
- Found 1" Iron Pipe per K-96 Plans
 - N 1,707,082.0777 E 1,654,269.0721
 - At Centerline of Hydraulic and 33rd St. N.
 - NE corner Steel Base Plate for High Line Pole 56.62' WNW
 - 5 Nails in SE Face of Power Pole 66.06' WSW
 - PK Nail in SW Face of Power Pole 39.10' ESE
 - Chiseled " on top W end Concrete Headwall 84.09' SE
 - Center of Tree Row to W 9.00' S