

COORDINATE TABLE					
POINT NO.	NORTH COORDINATE	EAST COORDINATE	STATION	OFFSET	DESCRIPTION
7000	8,614.6667	5,048.3613	46+13.82	39.20' Lt.	Edge of Pavement/Edge of Curb
7001	8,637.6336	5,026.6423	46+36.24	61.48' Lt.	Edge of Pavement/Edge of Curb
7002	8,666.5721	5,027.7961	46+65.20	61.04' Lt.	Edge of Pavement/Edge of Curb
7003	8,686.1825	5,050.2461	46+85.36	39.08' Lt.	Edge of Pavement/Edge of Curb
7004	8,688.2822	5,050.3456	46+87.46	39.03' Lt.	Edge of Pavement/Edge of Curb
7500	8,390.1320	5,027.3469	43+88.83	54.69' Lt.	Back of Sidewalk
7501	8,440.1052	5,028.5337	44+38.82	54.73' Lt.	P.C. Back of Sidewalk
7502	8,446.5331	5,029.4991	44+45.27	53.92' Lt.	P.R.C. Back of Sidewalk
7503	8,449.9943	5,030.0189	44+48.74	53.49' Lt.	P.T. Back of Sidewalk
7504	8,589.0103	5,033.3203	45+87.80	53.61' Lt.	P.C. Back of Sidewalk
7505	8,592.1283	5,033.0443	45+90.91	53.96' Lt.	P.R.C. Back of Sidewalk
7506	8,597.9189	5,032.5318	45+96.69	54.62' Lt.	P.T. Back of Sidewalk
7507	8,624.7921	5,033.1700	46+23.57	54.64' Lt.	Back of Sidewalk/Wheelchair Ramp
7508	8,678.8611	5,034.3170	46+77.65	54.82' Lt.	Back of Sidewalk/Wheelchair Ramp
7509	8,751.1728	5,037.4492	47+50.00	53.50' Lt.	Back of Sidewalk/Retaining Wall
7020	8,684.5366	5,117.1973	46+85.36	27.89' Rt.	Edge of Pavement/Edge of Curb/Match Exist.

CURVE TABLE													
NO.	Δ	R	T	L	E	P.C. COORDINATES		P.I. COORDINATES		P.T. COORDINATES		R.P.T. COORDINATES	
						NORTH	EAST	NORTH	EAST	NORTH	EAST	NORTH	EAST
FC700	89° 43' 02"	20.00'	19.90'	31.32'	8.21'	8,615.8416	5,046.4334	8,635.7408	5,046.7378	8,636.1434	5,026.8403	8,616.1475	5,026.4357
FC701	88° 17' 17"	20.00'	19.41'	30.82'	7.87'	8,668.0636	5,027.8557	8,667.7299	5,047.2753	8,687.1253	5,048.1832	8,688.0605	5,028.2051

RETAINING WALL POINTS					
POINT NO.	NORTH COORDINATE	EAST COORDINATE	STATION	OFFSET	DESCRIPTION
8500	8,670.2352	5,017.7776	46+68.62	71.15' Lt.	Back of Retaining Wall
8501	8,673.8769	5,028.7656	46+72.53	60.25' Rt.	Back of Retaining Wall
8502	8,683.1231	5,033.0002	46+81.88	56.25' Lt.	Back of Retaining Wall
8503	8,751.2377	5,035.9506	47+50.00	55.00' Lt.	Back of Retaining Wall

CONTROL POINTS					
POINT NO.	NORTH COORDINATE	EAST COORDINATE	STATION	OFFSET	DESCRIPTION
6000	8,399.9469	5,082.2812	44+00.00	0.0000	@ Maize Road=Section Line
6001	8,685.2227	5,089.2905	46+85.36	0.0000	@ Maize Road=Section Line, Begin Pavement

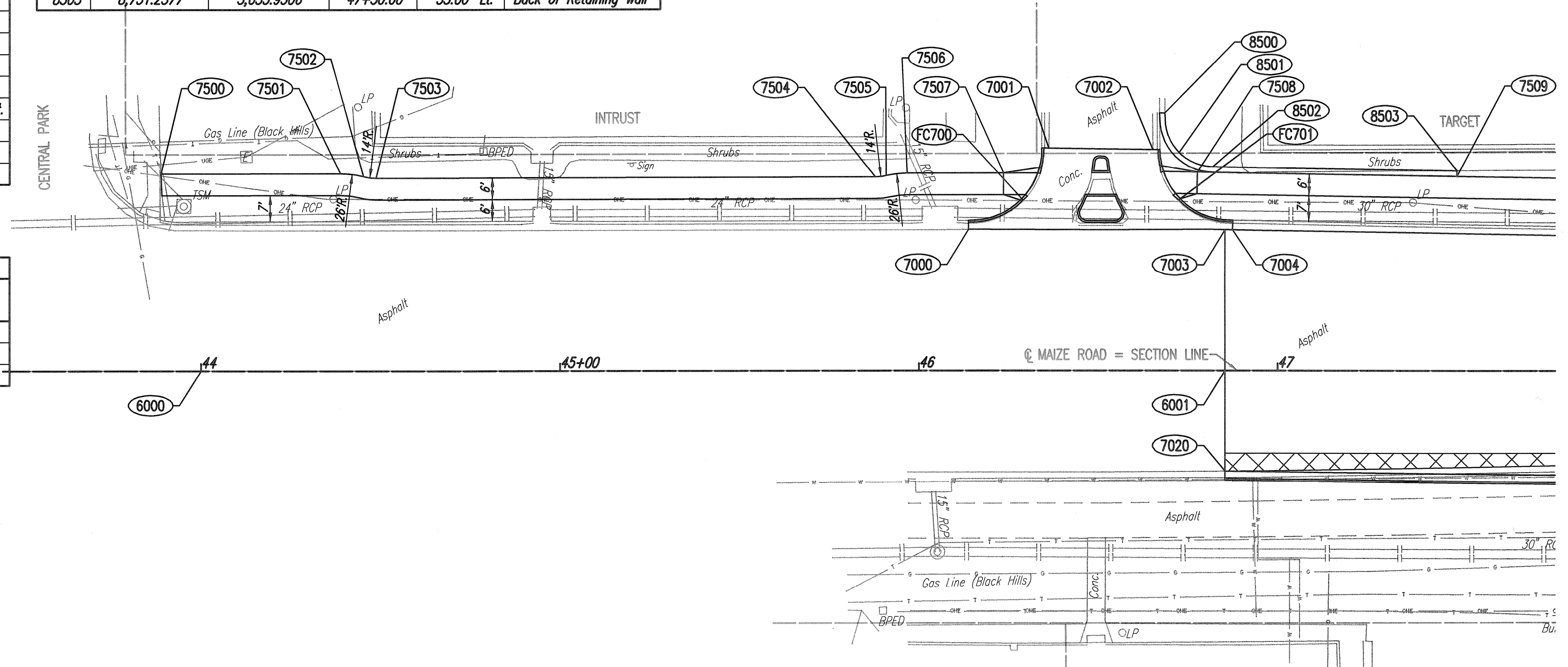

Curve No. FC700

POINT NO.	STATION	OFFSET	ON CURVE		8' OFFSET		COMMENT
			NORTH	EAST	NORTH	EAST	
8000	46+14.95	41.16' Lt.	8,615.8416	5,046.4334	8,615.9639	5,048.4343	P.C.
8001	46+29.00	47.11' Lt.	8,630.0362	5,040.8268	8,624.4807	5,035.0704	1/2 Pt.
8002	46+34.76	61.25' Lt.	8,636.1434	5,026.8403	8,628.1450	5,026.6785	P.T.

Curve No. FC701

POINT NO.	STATION	OFFSET	ON CURVE		8' OFFSET		COMMENT
			NORTH	EAST	NORTH	EAST	
8003	46+66.69	61.02' Lt.	8,668.0636	5,027.8557	8,676.0623	5,027.9954	P.C.
8004	46+72.45	47.12' Lt.	8,673.4714	5,041.8857	8,679.3071	5,036.4135	1/2 Pt.
8005	46+86.25	41.17' Lt.	8,687.1253	5,048.1832	8,687.4994	5,040.1920	P.T.

Solved 12-13-2013 4:27:22 PM by BJS
 Plot Scale 1/20 12-17-2013 11:33:35 PM by BJS
 C:\2013\1288\1288\001\1288-001-100-COORDINATE GEOMETRY-44

	Revision		By	Date	
	MAIZE ROAD PAVING AND DRAINAGE IMPROVEMENTS LOT 1, BLOCK 1, NEWMARKET V ADDITION COORDINATE GEOMETRY STA. 43+88.63 TO STA. 46+24.63 GARY JANZEN, P.E. - CITY ENGINEER CITY OF WICHITA PROJECT NO. 472-84607				
			PROFESSIONAL ENGINEERING CONSULTANTS, P.A. 303 SOUTH TOPEKA WICHITA, KS 67202 316-262-2891 www.pec1.com		
	Designed by	CSB	Job No.	35-12568-000/001	Sht.
Drawn by	BJS	Date	September 2013		