

BASE LEVELING PAD NOTES:

1. THE LEVELING PAD IS TO BE CONSTRUCTED OF CRUSHED STONE
2. THE BASE FOUNDATION SHALL BE COMPACTED TO 90% OF STANDARD PROCTOR (ASTM D-698) PRIOR TO PLACEMENT OF THE LEVELING PAD.

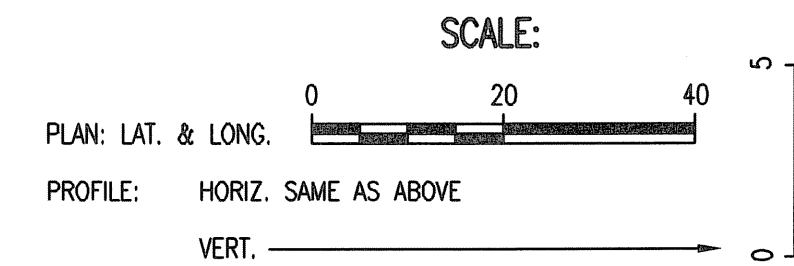
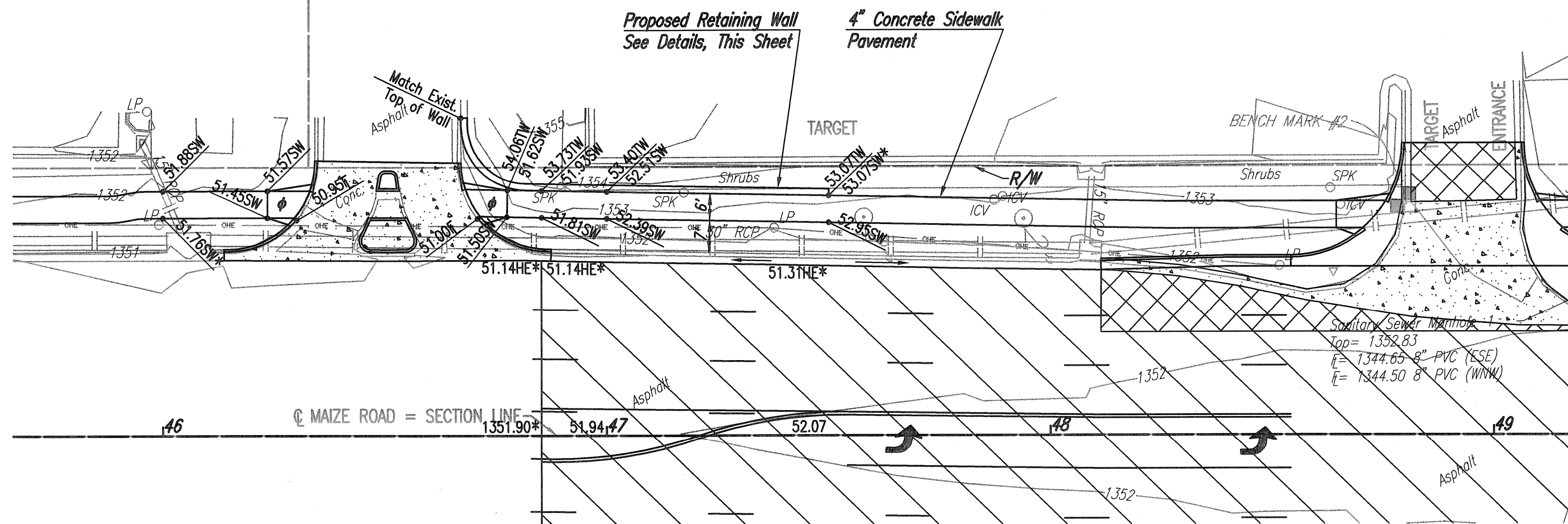

GENERAL NOTES

The Contractor shall provide and install the segmental retaining wall system from components supplied by Keystone, Mesa, Rockwood, or Versa-Lok, or an approved equal, in accordance with the supplier's recommendations and construction manual.

The wall units shall be beveled faced. The color shall be Tan, as approved by the Engineer.

Segmental Retaining Wall will be paid for at the contract unit price bid per square foot as measured from the top of wall to the top of leveling pad. This payment will be considered full compensation for erection of the wall including but not limited to: excavation, grading, and compaction of the wall foundation, general and local dewatering as required for proper execution of the work, construction of leveling pads, erection of the modular block wall elements, placement of geogrids and connectors and compaction of select backfill material within the reinforced soil volume, and providing and placing cap units as required.

The Contractor shall be responsible for locating all underground utilities prior to construction.

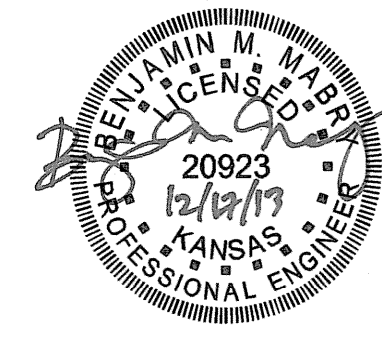

DATE	
BY	
CHECKED	CHECKED
PLAN	

DATE	
BY	
CHECKED	CHECKED
PROFILE	

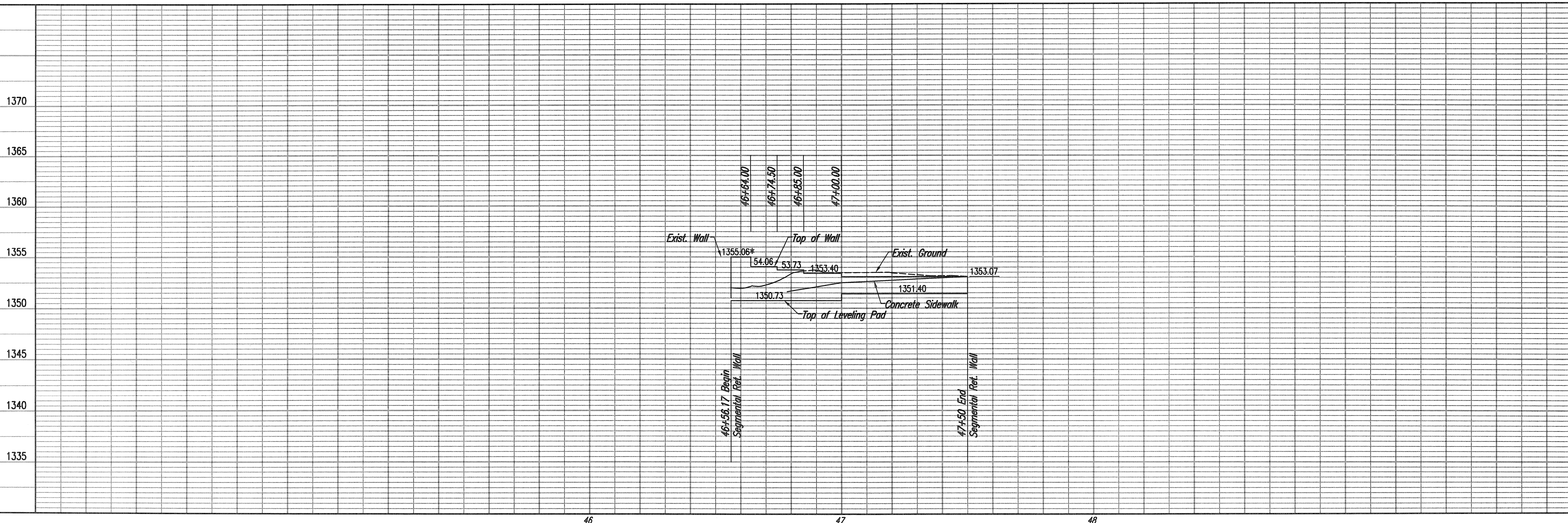

Saved 12-04-2013 4:08:05 PM by BJS
 Plot Scale 1:20 12-17-2013 1:19:24 PM by BJS
 C:\2012\1298\000_001\1298-001-17C-SEGMENTAL RETAINING WALL

MAIZE ROAD PAVING AND DRAINAGE IMPROVEMENTS
 LOT 1, BLOCK 1 NEWMARKET V ADDITION
SEGMENTAL RETAINING WALL
 STA. 46+78.53 TO STA. 47+50.00

PROFESSIONAL ENGINEERING CONSULTANTS P.A.
 303 SOUTH TOPEKA WICHITA, KS 67202
 316-262-2981 www.pec.com

Job No. 35-12568-000/001
 Date September 2013

Designed By CSB
 Drawn By BJS

GARY JANZEN, P.E. - CITY ENGINEER
 CITY OF WICHITA PROJECT NO. 472-84607