

DATE	
BY	
CHECKED	
CHECKED	
PLAN	

DATE	
BY	
CHECKED	
CHECKED	
PROFILE	

Saved 12-17-2013 1:38:04 PM by BJS
 NO. 00121.2558.0001.0011.2558-001.2558-001. AND PROFILE-RCB 3

Sta. 19+84.0 to Sta. 20+00.0 @ Prop. RCB
 Remove Existing Headwall
 Const. Cast-in-Place RC Transition.
 See Sheet Nos. 31 & 35.

COORDINATE LIST		
POINT	NORTH	EAST
8526	10,197.8104	5,103.9625
8527	10,203.8422	5,104.3127

N: 10,395.3795 E: 5,108.0335
 @ Maize Road Sta. 63+97.0, 61.0' Lt.
 Const. Sediment Tank
 See Sheet Nos. 37 & 38.

SCALE:
 PLAN: LAT. & LONG. 0 20 40
 PROFILE: HORIZ. SAME AS ABOVE
 VERT. 0 10 20

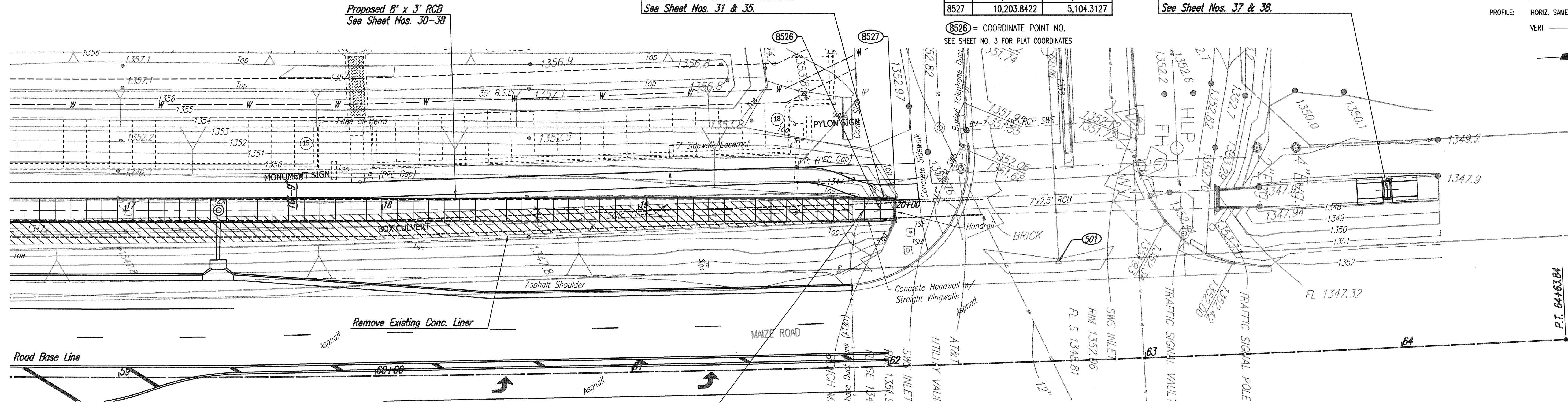

CAUTION !!!
 Buried Telephone
 (AT&T)

(501) NE Corner Sec. 6, T27S, R1W
 38.34' Lt. or W. of Maize Rd. Sta. 62+68.95=
 29th St. N. Sta. 50+00.00

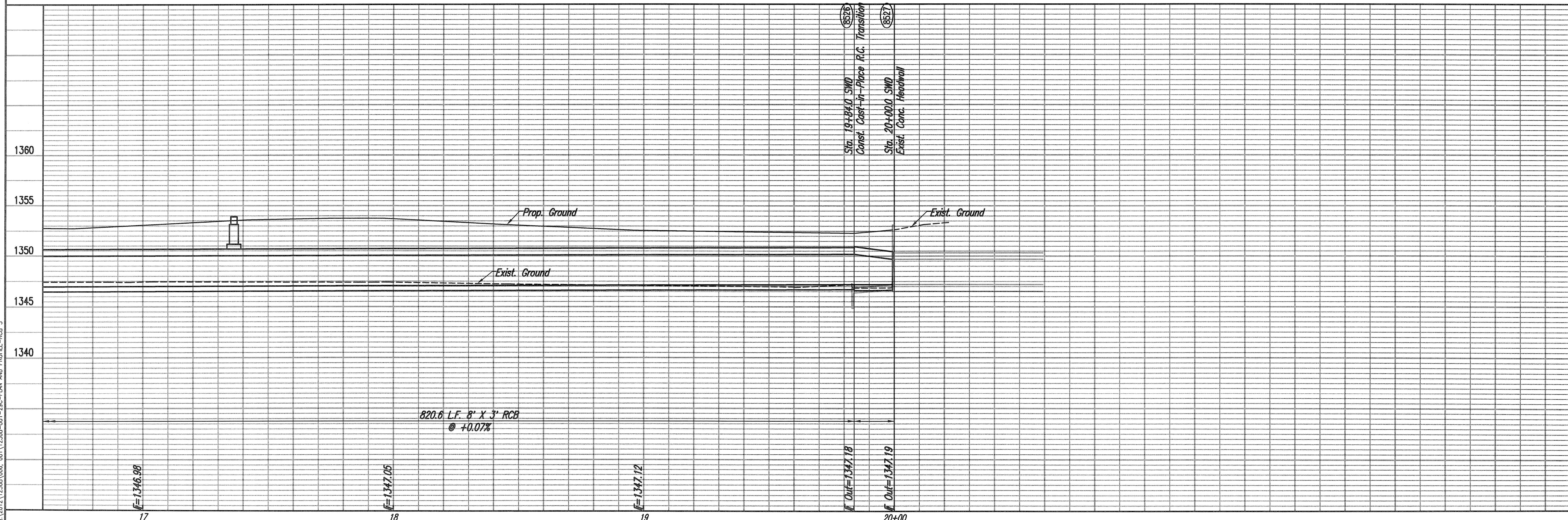
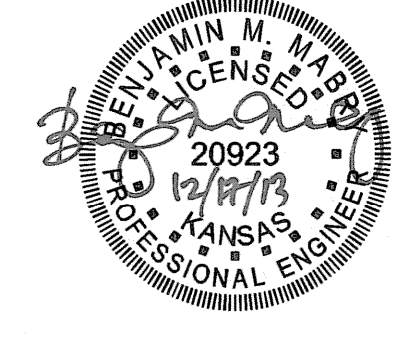

MAIZE ROAD PAVING AND DRAINAGE IMPROVEMENTS
 LOT 1, BLOCK 1 NEWMARKET V ADDITION
8' X 3' REINFC. CONC. BOX
 STA. 18+00.0 TO STA. 20+00.0
 GARY JANZEN, P.E. - CITY ENGINEER
 CITY OF WICHITA PROJ. NO. 472-84607

PROFESSIONAL ENGINEERING CONSULTANTS, P.A.
 303 SOUTH TOPEKA WICHITA, KS 67202
 316-262-2891 www.pec.com
IPEC
 Designed By BMM, JAG
 Drawn By BUS
 Job No. 35-12568-000/001
 Date September 2013