

Remove Broken White (10 Each) for Construction of Stage 1 Traffic Control. Replace Broken White (10 Each) upon Completion of Traffic Control Stage 2.

- LEGEND**
- × FIXED CHANNELIZING DEVICE AT 50' SPACING OR SPACING AS NOTED.
 - CHANNELIZING DEVICE AT 50' SPACING OR SPACING AS NOTED.
 - ▬▬▬ TYPE III BARRICADE WITH TYPE A LOW INTENSITY FLASHING WARNING LIGHTS.
 - * SIGN TO BE MOUNTED ON TYPE III BARRICADE
 - ▨ WORK AREA

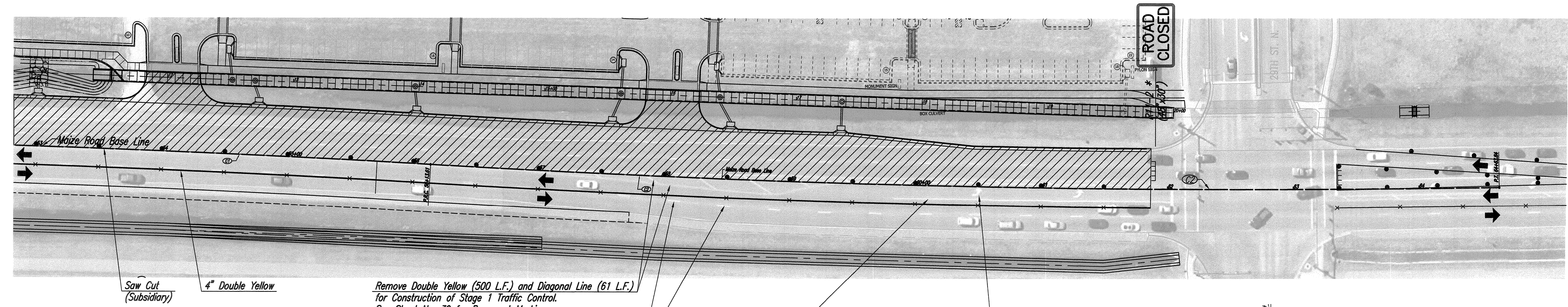

Remove Double Yellow (500 L.F.) and Diagonal Line (61 L.F.) for Construction of Stage 1 Traffic Control. See Sheet No. 39 for Pavement Marking upon Completion of Traffic Control Stage 2.

Remove Broken White (10 Each) for Construction of Stage 1 Traffic Control. See Sheet No. 39 for Pavement Marking upon Completion of Traffic Control Stage 2.

Remove Solid White (220 L.F.) for Construction of Stage 1 Traffic Control. See Sheet No. 39 for Pavement Marking upon Completion of Traffic Control Stage 2.

Remove Turn Arrows (2 Each) for Construction of Stage 1 Traffic Control. See Sheet No. 39 for Pavement Marking upon Completion of Traffic Control Stage 2.

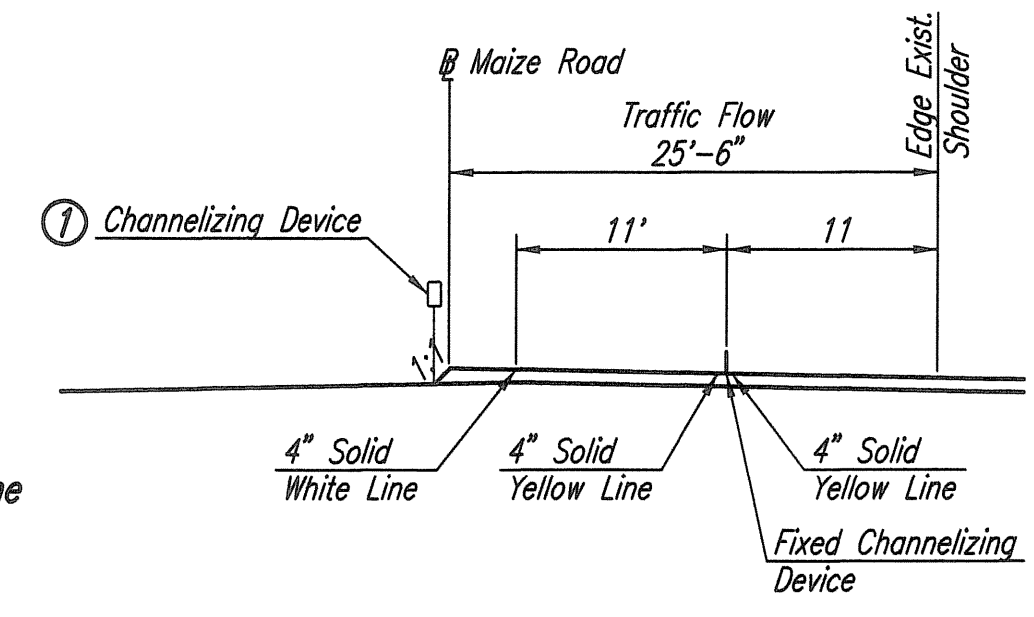

STAGE I TYPICAL TRAFFIC CONTROL SPACING

Served 12-17-2013 1:47:01 PM by BJS
 P:\Projects\48010\172013\121325\025.PLA by BJS
 02/20/12 12:58:00 PM 00112585F-001-11C-TRAFFIC CONTRL-STAGE 1

	Revision		By	Date
	MAIZE ROAD PAVING AND DRAINAGE IMPROVEMENTS LOT 1, BLOCK 1 NEWMARKET V ADDITION TRAFFIC CONTROL-STAGE 1 GARY JANZEN, P.E.-CITY ENGINEER CITY OF WICHITA PROJECT NO. 472-84607			
	PROFESSIONAL ENGINEERING CONSULTANTS, P.A. 303 SOUTH TOPEKA WICHITA, KS 67202 316-262-2691 www.pec1.com			
	Designed by	CSB	Job No.	35-12568-000/001
Drawn by	BJS	Date	September 2013	Sht. 41 of 65