

4" Yellow
 Channelizing Devices @ 35' Spacing
 4" Yellow

Remove Broken White (3 Each) for Construction of Stage 2 Traffic Control. Replace Broken White (3 Each) upon Completion of Traffic Control Stage 2.

Remove Double Yellow (924 L.F.) for Construction of Stage 2 Traffic Control. See Sheet No. 39 for Pavement Marking upon Completion of Traffic Control Stage 2.

Remove Broken White (22 Each) for Construction of Stage 2 Traffic Control. See Sheet No. 39 for Pavement Marking upon Completion of Traffic Control Stage 2.

Channelizing Devices @ 12' Spacing

Saw Cut (Subsidiary)

4" Double Yellow

Maize Road Base Line

Edge Prop Shoulder

R11-2* (48" x 30")

ROAD CLOSED

Remove Diagonal Line (70 L.F.) for Construction of Stage 2 Traffic Control. See Sheet No. 39 for Pavement Marking upon Completion of Traffic Control Stage 2.

- LEGEND**
- × FIXED CHANNELIZING DEVICE AT 50' SPACING OR SPACING AS NOTED.
 - CHANNELIZING DEVICE AT 50' SPACING OR SPACING AS NOTED.
 - |||| TYPE III BARRICADE WITH TYPE A LOW INTENSITY FLASHING WARNING LIGHTS.
 - * SIGN TO BE MOUNTED ON TYPE III BARRICADE
 - ▨ WORK AREA

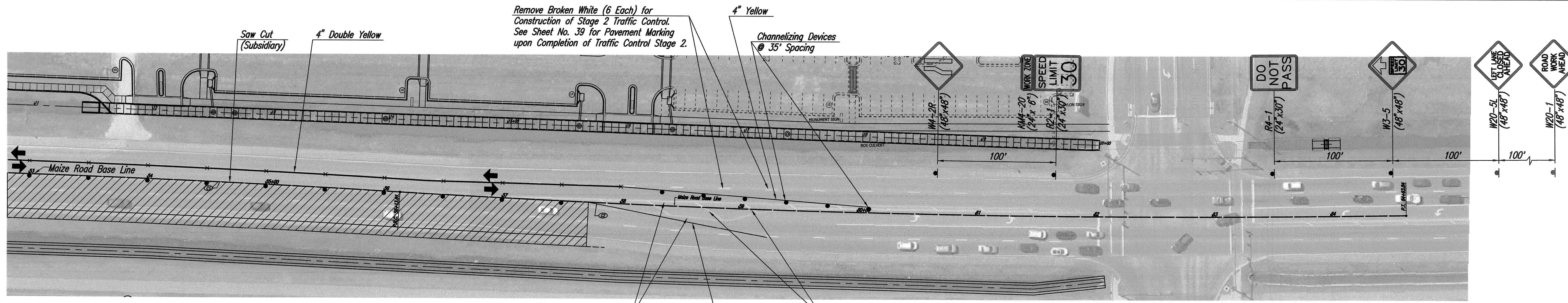

Saw Cut (Subsidiary)

4" Double Yellow

Remove Broken White (6 Each) for Construction of Stage 2 Traffic Control. See Sheet No. 39 for Pavement Marking upon Completion of Traffic Control Stage 2.

4" Yellow

Channelizing Devices @ 35' Spacing

Maize Road Base Line

Remove Double Yellow (1,092 L.F.) for Construction of Stage 2 Traffic Control. See Sheet No. 39 for Pavement Marking upon Completion of Traffic Control Stage 2.

4" White

Remove Diagonal Line (90 L.F.) for Construction of Stage 2 Traffic Control. See Sheet No. 39 for Pavement Marking upon Completion of Traffic Control Stage 2.

MA-2R (48" x 48")

W3-20 (24" x 8")

W2-1 (24" x 30")

W3-5 (48" x 48")

W20-5L (48" x 48")

W20-1 (48" x 48")

DO NOT PASS

WORK ZONE SPEED LIMIT 30

100'

100'

100'

100'

① Channelizing Devices are to be Relocated to the Solid White Line White Work is in Progress. At the Completion of Work and During Non-work Periods the Channelizing Devices Shall be in the Standard Location.

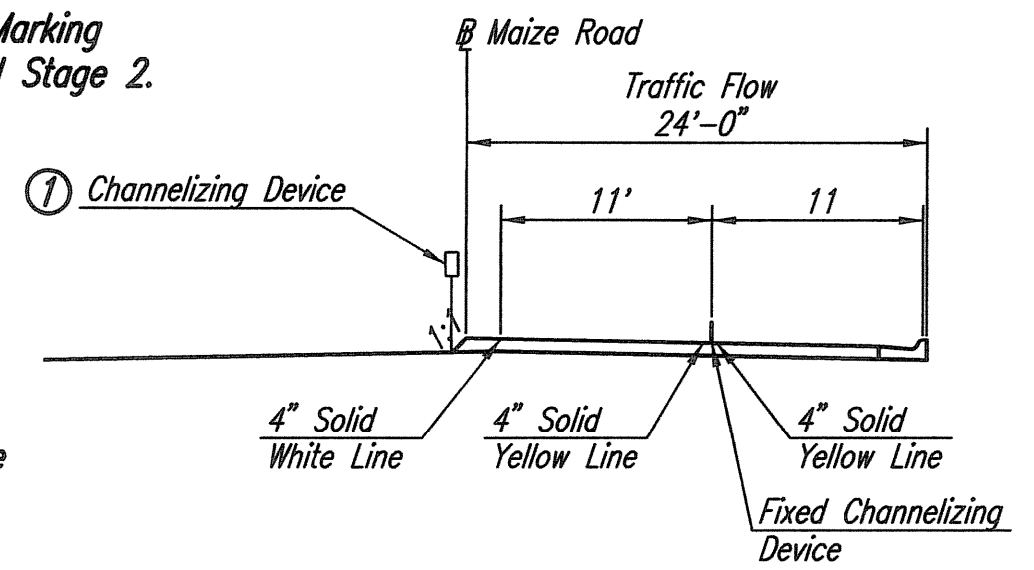

STAGE I TYPICAL TRAFFIC CONTROL SPACING

No.	Revision	By	Date
MAIZE ROAD PAVING AND DRAINAGE IMPROVEMENTS LOT 1, BLOCK 1 NEWMARKET V ADDITION TRAFFIC CONTROL-STAGE 2 GARY JANZEN, P.E.-CITY ENGINEER CITY OF WICHITA PROJECT NO. 472-84607			
Designed by	CSB	Job No.	35-12568-000/001
Drawn by	BJS	Date	September 2013
			Sht. 44 of 65

Saved 12-10-2013 4:16:15 PM by BJS
 Plot Scale 1:40 12-17-2013 2:07:57 PM by BJS
 C:\2012\12568\000_001\12568-001-44C-TRAFFIC CONTRL-STAGE 2