

COORDINATE TABLE					
POINT NO.	NORTH COORDINATE	EAST COORDINATE	STATION	OFFSET	DESCRIPTION
5035	1,701,746.2825	1,686,273.7732	119+50.79	80.95 Rt.	℄ Path / Wheelchair Ramp
5036	1,702,033.8291	1,686,243.1064	122+38.70	53.91 Rt.	℄ Sidewalk / Match Point
5037	1,701,975.3346	1,687,412.5412	476+44.40	143.75 Rt.	℄ Path / Corner Point
5038	1,701,969.6969	1,687,410.4878	476+44.58	149.75 Rt.	℄ Path / Corner Point
5039	1,701,966.2746	1,687,419.8839	476+55.42	149.45 Rt.	℄ Path / Corner Point
5040	1,701,971.9122	1,687,421.9373	476+55.21	143.46 Rt.	℄ Path / Corner Point
5041	1,701,839.0364	1,687,718.9892	480+05.35	126.21 Rt.	℄ Path / Match Point

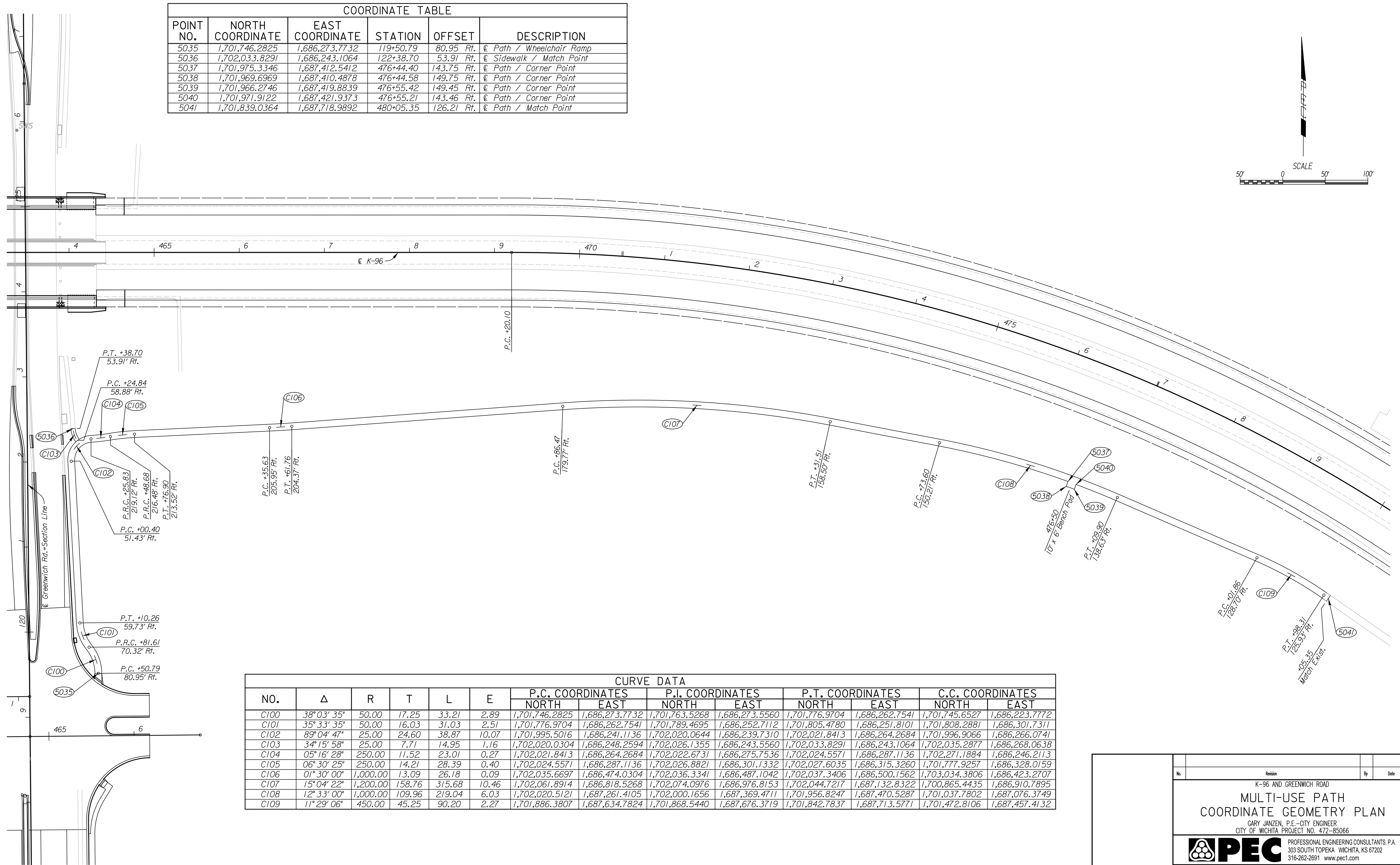
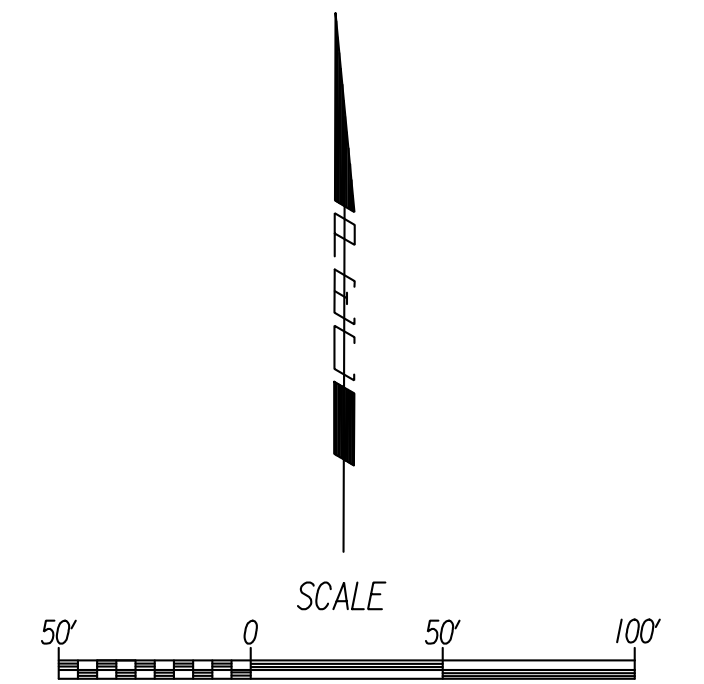

NO.	Δ	R	T	L	E	CURVE DATA							
						P.C. COORDINATES		P.I. COORDINATES		P.T. COORDINATES		C.C. COORDINATES	
						NORTH	EAST	NORTH	EAST	NORTH	EAST	NORTH	EAST
C100	38°03'35"	50.00	17.25	33.21	2.89	1,701,746.2825	1,686,273.7732	1,701,763.5268	1,686,273.5560	1,701,776.9704	1,686,262.7541	1,701,745.6527	1,686,223.7772
C101	35°33'35"	50.00	16.03	31.03	2.51	1,701,776.9704	1,686,262.7541	1,701,789.4695	1,686,252.7112	1,701,805.4780	1,686,251.8101	1,701,808.2881	1,686,301.7311
C102	89°04'47"	25.00	24.60	38.87	10.07	1,701,995.5016	1,686,241.1136	1,702,020.0644	1,686,239.7310	1,702,021.8413	1,686,264.2684	1,701,996.9066	1,686,266.0741
C103	34°15'58"	25.00	7.71	14.95	1.16	1,702,020.0304	1,686,248.2594	1,702,026.1355	1,686,243.5560	1,702,033.8291	1,686,243.1064	1,702,035.2877	1,686,268.0638
C104	05°16'28"	250.00	11.52	23.01	0.27	1,702,021.8413	1,686,264.2684	1,702,022.6731	1,686,275.7536	1,702,024.5571	1,686,287.1136	1,702,271.1884	1,686,246.2113
C105	06°30'25"	250.00	14.21	28.39	0.40	1,702,024.5571	1,686,287.1136	1,702,026.8821	1,686,301.1332	1,702,027.6035	1,686,315.3260	1,701,777.9257	1,686,328.0159
C106	01°30'00"	1,000.00	13.09	26.18	0.09	1,702,035.6697	1,686,474.0304	1,702,036.3341	1,686,487.1042	1,702,037.3406	1,686,500.1562	1,703,034.3806	1,686,423.2707
C107	15°04'22"	1,200.00	158.76	315.68	10.46	1,702,061.8914	1,686,818.5268	1,702,074.0976	1,686,976.8153	1,702,044.7217	1,687,132.8322	1,700,865.4435	1,686,910.7895
C108	12°33'00"	1,000.00	109.96	219.04	6.03	1,702,020.5121	1,687,261.4105	1,702,000.1656	1,687,369.4711	1,701,956.8247	1,687,470.5287	1,701,037.7802	1,687,076.3749
C109	11°29'06"	450.00	45.25	90.20	2.27	1,701,886.3807	1,687,634.7824	1,701,868.5440	1,687,676.3719	1,701,842.7837	1,687,713.5771	1,701,472.8106	1,687,457.4132

Plotted By: cp Date: 12/30/2013 11:34:19 AM  
 FILE: I:\2009\0952\Geometry\0952-Bikepath-Geo.dgn

No.	Revision	By	Date
K-96 AND GREENWICH ROAD			
<b>MULTI-USE PATH</b>			
<b>COORDINATE GEOMETRY PLAN</b>			
GARY JANZEN, P.E.—CITY ENGINEER CITY OF WICHITA PROJECT NO. 472-85066			
<b>PEC</b> PROFESSIONAL ENGINEERING CONSULTANTS, P.A. 303 SOUTH TOPEKA WICHITA, KS 67202 316-262-2691 www.pec1.com			
Designed by	JPS	Job No.	09521
Drawn by	DRP	Date	Jan., 2014
			Sht. 29 of 388