

NOTES

1. Contractor shall notify Traffic Engineering Department two weeks prior to start of construction.
2. Contractor shall contact all utility companies which may be affected by this construction prior to beginning of construction.
3. The traffic signal system shall be complete and the Contractor shall furnish and install all equipment necessary for the satisfactory operation of electrical apparatus and for the complete operation of traffic signal system whether specifically mentioned or not.
4. Signal equipment (mast arms, poles, cabinet, etc...) shall be black.

DETECTION ZONE

AREA NO.	SIZE	CAMERA	MOVEMENT CALLED
1	6' X 50'	1	1

FUNCTION	PHASE							
	1	2	3	4	5	6	7	8
MAX. I								
MAX. II/HFDW								
WALK								
FLASH DW								
MAX. INITIAL								
MIN. GREEN								
TBR								
TTR								
CITY OF WICHITA TO PROVIDE								
OBSERVE GAP								
PASSAGE								
MIN. GAP								
ADD ACTUATION								
YELLOW								
RED CLEAR								
RED REVERT								
WALK II								

FUNCTION	PHASE							
	1	2	3	4	5	6	7	8
VEHICLE RECALL								
PEDESTRIAN RECALL								
RED LOCK								
YELLOW LOCK								
Ø PERMIT								
PED. PHASES								
LEAD PHASES								
DOUBLE ENRTY								
SEQUENTIAL TIMING								
STARTUP YELLOW								
OVERLAP A								
OVERLAP B								
OVERLAP C								
OVERLAP D								
EXCLUSIVE								
SIMULTANEOUS GAP								

LEGEND

- Existing Video Detection Camera
- Proposed Street Name Sign with Designation
- Existing R10-12 (Left Turn Yield on Green)
- Proposed Detection Zone
- Existing 3" Conduit
- Existing Traffic Signal Pole with Mast Arm
- Existing Pad Mounted Controller
- Existing Pedestrian Signal and Push Button
- Existing Service Box
- Existing Power Supply
- Proposed Mast Arm Mounted Signal Head (with back plate)
- Existing Mast Arm Mounted Signal Head (with back plate)
- Existing Vertical Bracket Mounted Signal Head (with type designation)

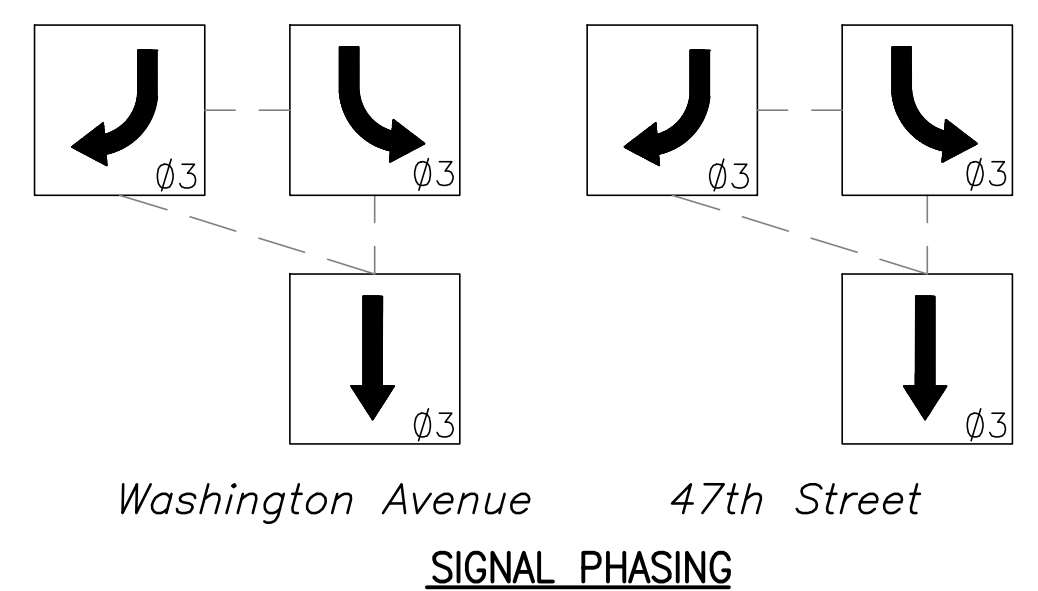
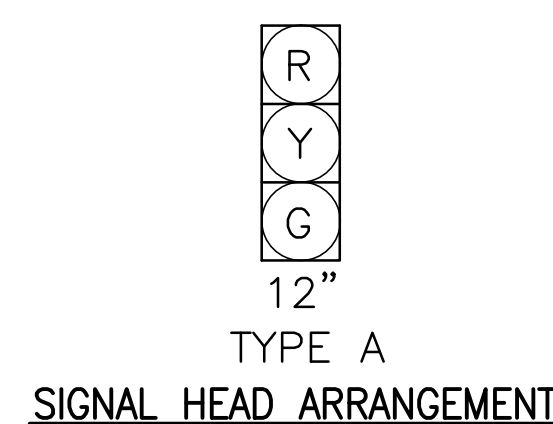
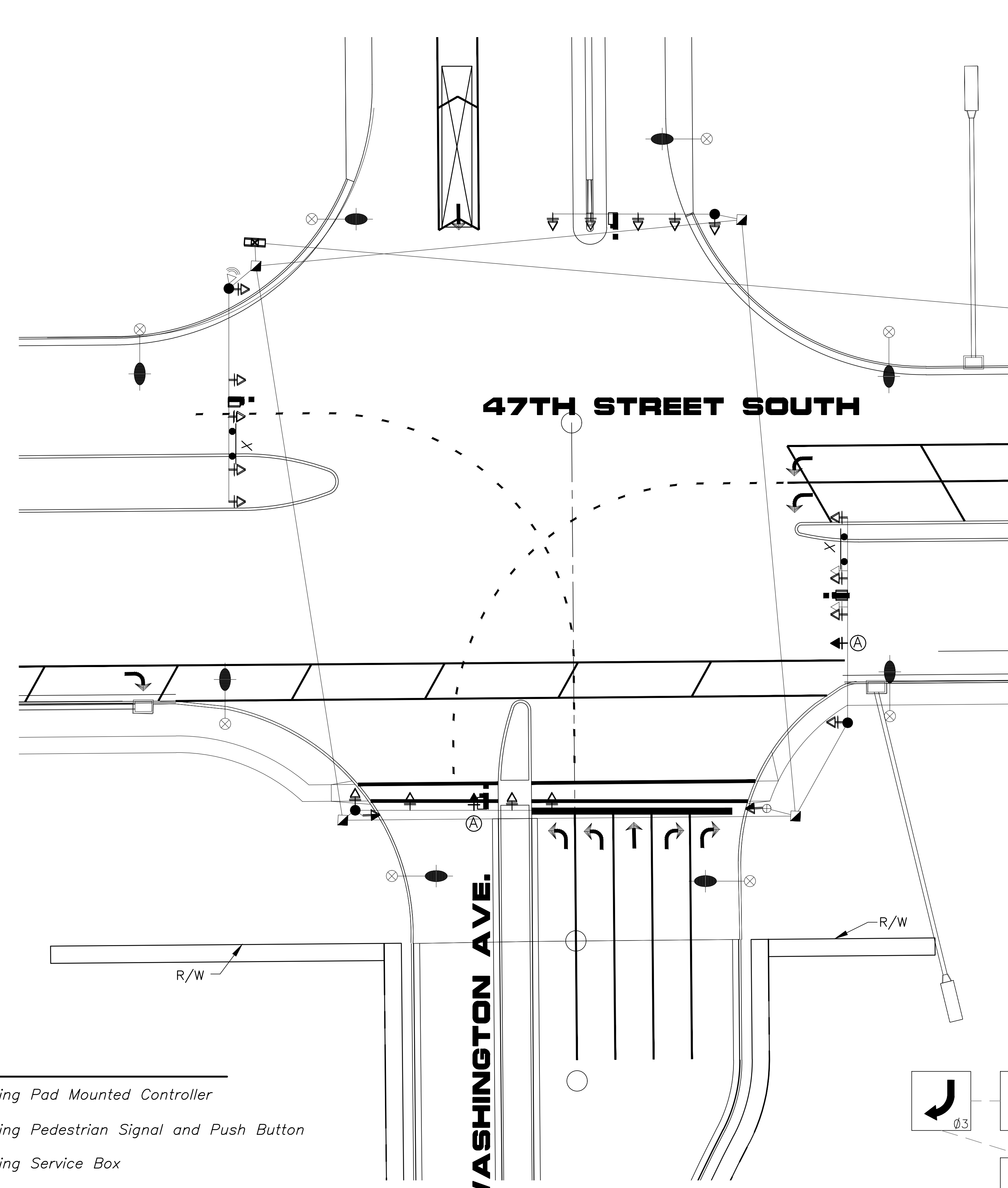

--- Indicates that Phases may Time Concurrently

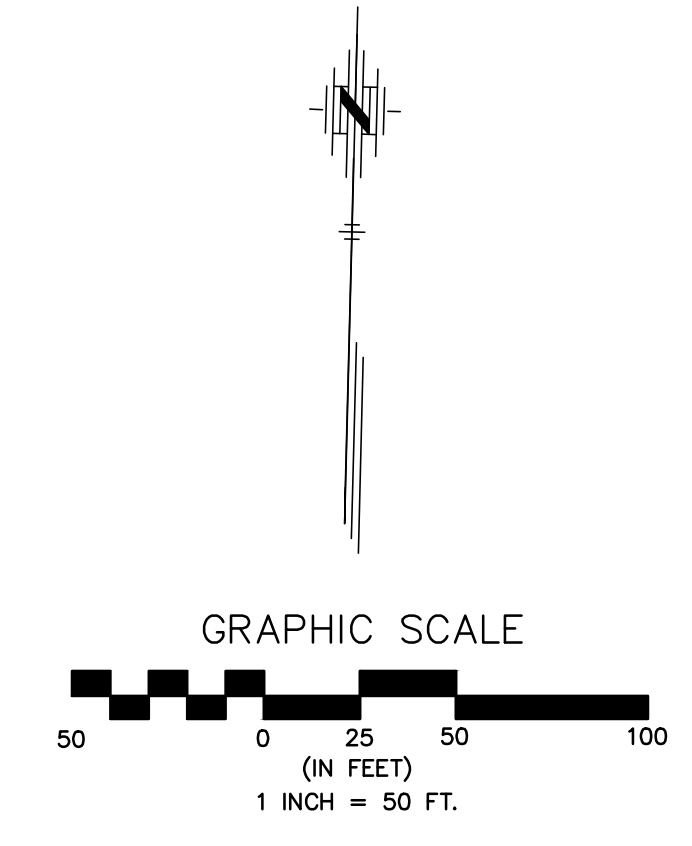

FINAL
 Engineer: T. AUSTIN
 Designer: M. TUCKER
 P.O. Job No.: 1858
 Date: JANUARY 2014
 Sheet 41 of 43

POE & ASSOCIATES, INC.
 CONSULTING ENGINEERS
 5940 E. Central, Suite 200 • Wichita, KS 67208-4242
 Phone 316.685-1111 • FAX 316.685-4444

PE

SOUTHFORK COMMERCIAL ADDITION
 PAVING & DRAINAGE IMPROVEMENTS
 TRAFFIC SIGNAL PLAN
CITY OF WICHITA, KANSAS
 GARY JANZEN, P.E. - CITY ENGINEER
 PROJECT NO. 468-84826 OCA NO. (751507)
 PROJECT NO. 472-85050 OCA NO. (766279)

Approved By: _____
 Date: _____
 No. _____
 Revision _____