

- NOTES:**
- Existing light pole is owned and maintained by general store.
 - The light pole shall be protected during construction or removed and replaced.
 - Cost shall be considered subsidiary to "Site Restoration."

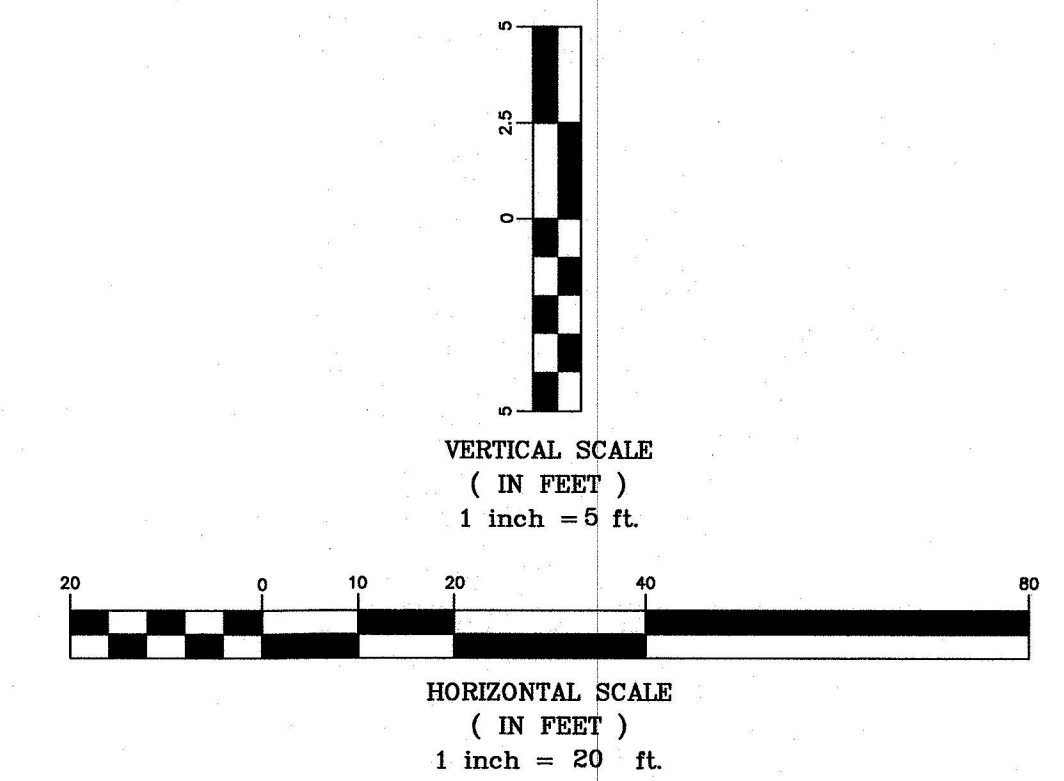
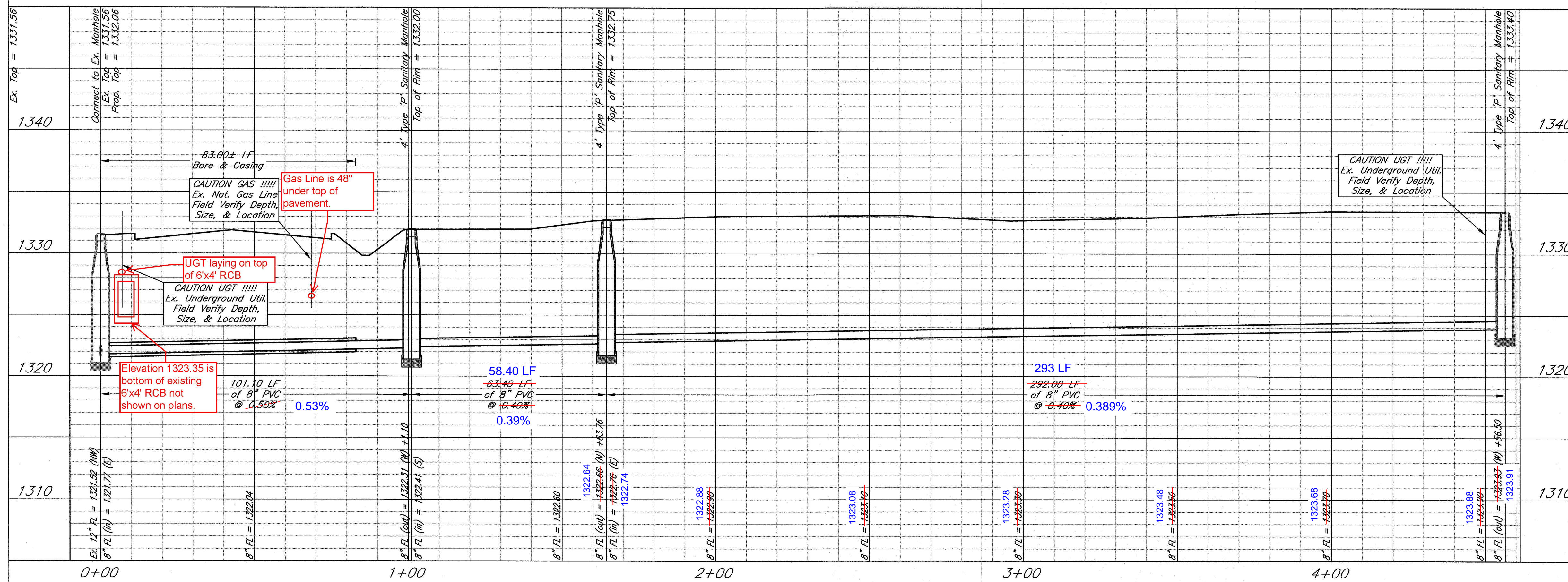

Northeast Corner of 53rd Street North & Meridian
Plan & Profile
 Wichita, Kansas

KEMILLER ENGINEERING PA <small>117 E. Lewis, Wichita, KS 67202 (316)264-0242</small>	PROJECT NUMBER 468-84761			SHEET 2.1
	KEM NO. 11071	FILE	DATE 12/09/2011	
DESIGN KM	DRAWN ME	REVISED 11/4/2013		